

Nathanael Stock

From: Joyce Christie
Sent: 10 April 2025 19:07
To: Nathanael Stock; Shona King
Cc: Enforcement Planning; DC Support
Subject: RE: 25/00527/DISC - Condition 9 of 24/01880/LB North Arms

Hi Shona and Nat

Queries:

P11D shows the whole floor plan. Drawings 12C and 13B were also submitted but these are not relevant to Condition 9 of 24/01880/LB.

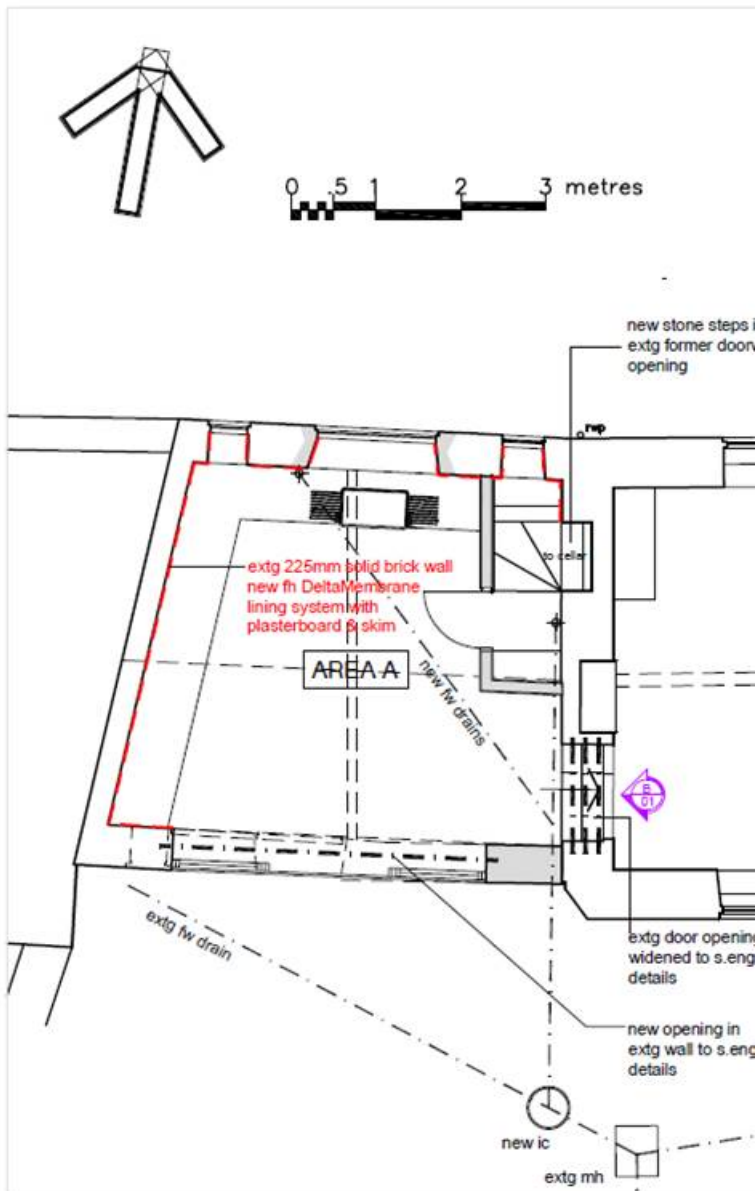

Extract P11D

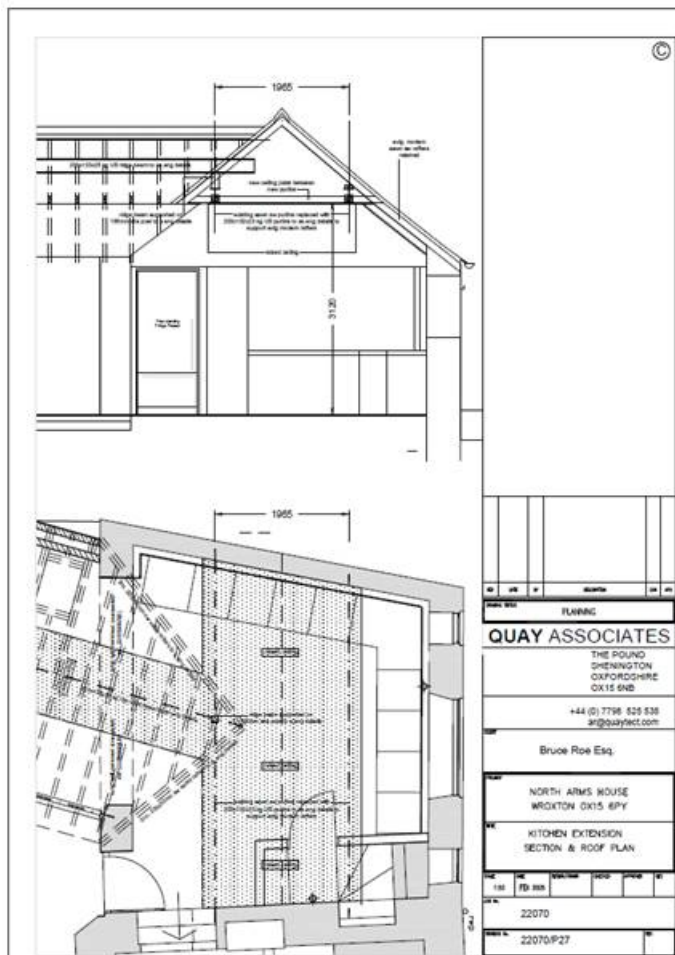

P27

Please ask for a bit more information on Drg P27 to show the existing floor slab junction with the new floor slab and how the ceiling finishes between the existing and proposed relate to one another. Please also confirm how the new steel that is to be inserted to support the ridge of the new roof will be embedded in the masonry. Can they supply further detail on the junction between the extension roof and the stone pier between the large opening and the door. Please note Drg P11D and P27 are different as P11 doesn't show a door and appears to show a wider opening?

Best wishes

Joyce Christie
Conservation Officer
Planning Policy and Conservation
Communities Directorate
Cherwell District Council
01295 227006
Direct Dial 01295 221608
joyce.christie@cherwell-dc.gov.uk

www.cherwell.gov.uk

39 Castle Quay, Banbury, OX16 5FD

[Facebook](#) | [LinkedIn](#) | [Instagram](#) | Subscribe to [Cherwell Link](#) | [Bluesky](#) | [Nextdoor](#)

You will appreciate that the above views are those of Council Officers and though given in good faith, cannot prejudice any decision which the Council, as the Local Planning Authority, may make.

Planning and Development services can be contacted as follows:

Development Management - planning@cherwell-dc.gov.uk

Building Control - building.control@cherwell-dc.gov.uk

Planning Policy - planning.policy@cherwell-dc.gov.uk

Conservation - design.conservation@cherwell-dc.gov.uk

For the latest information on Planning and Development please visit www.cherwell.gov.uk

From: Joyce Christie

Sent: 10 April 2025 18:56

To: Nathanael Stock <Nathanael.Stock@Cherwell-DC.gov.uk>; Shona King <Shona.King@Cherwell-DC.gov.uk>

Cc: Enforcement Planning <Enforcement.Planning@Cherwell-DC.gov.uk>; DC Support <DC.Support@cherwell-dc.gov.uk>

Subject: 25/00527/DISC - Condition 9 of 24/01880/LB North Arms

Hi Shona and Nat

Drgs tab includes Drg P11C – there is a later revision P11D which was received [31.03.2025@15:53](#) (you were both copied in). Should DEF be updated?

Best wishes

Joyce Christie
Conservation Officer
Planning Policy and Conservation
Communities Directorate
Cherwell District Council
01295 227006
Direct Dial 01295 221608
joyce.christie@cherwell-dc.gov.uk

www.cherwell.gov.uk

39 Castle Quay, Banbury, OX16 5FD

[Facebook](#) | [LinkedIn](#) | [Instagram](#) | Subscribe to [Cherwell Link](#) | [Bluesky](#) | [Nextdoor](#)

You will appreciate that the above views are those of Council Officers and though given in good faith, cannot prejudice any decision which the Council, as the Local Planning Authority, may make.

Planning and Development services can be contacted as follows:

Development Management - planning@cherwell-dc.gov.uk

Building Control - building.control@cherwell-dc.gov.uk

Planning Policy - planning.policy@cherwell-dc.gov.uk

Conservation - design.conservation@cherwell-dc.gov.uk

For the latest information on Planning and Development please visit www.cherwell.gov.uk