

PROPOSED 66 BED CARE HOME
 SITE AREA 9951m² (2.45 acres)
 BUILDING FOOTPRINT 1787m²
 AMENITY SPACE 7197m²
 25 No PARKING SPACES (INC. 6
 No ELECTRIC VEHICLE
 CHARGING POINTS & 2 No
 DISABLED SPACES)
 1 x 10 SPACE CYCLE STORE.
 3 x SHEFFIELD HOOPS.

LEGEND

ROADS

- ROADWAY
- PAVEMENT
- GRAVEL DRIVE

BOUNDARIES

- BOUNDARY
- BOUNDARY
- BOUNDARY

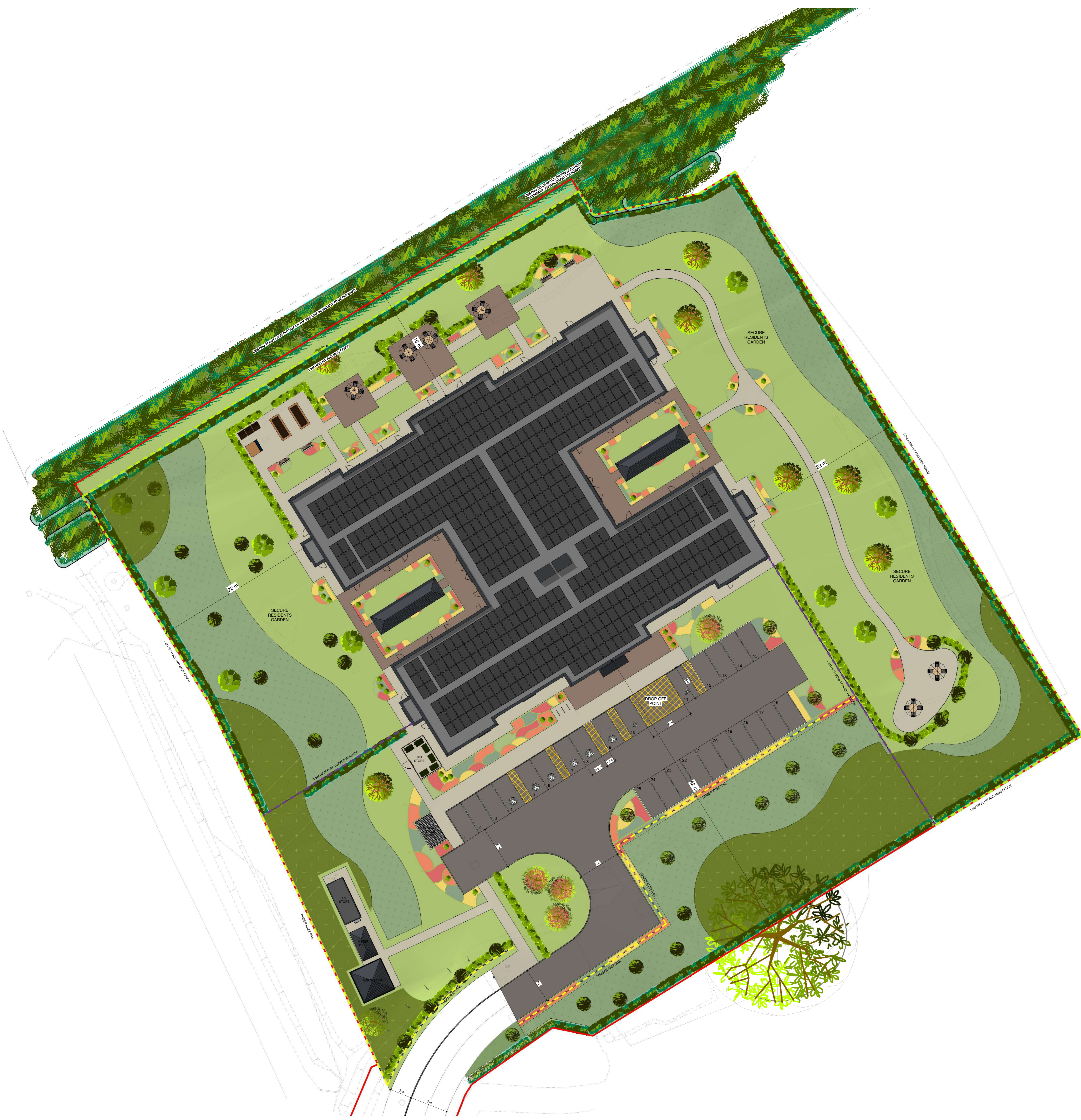

REV	DATE	DETAILS OF AMENDMENTS	DRAWN
B	19/11/2024	PARKING LAYOUT AMENDED IN LINE WITH PLANNING CONDITIONS. BOUNDARY TREATMENT LOCATION ON THE NORTH WESTERN BOUNDARY HAS BEEN AMENDED TO PROTECT EXISTING WATERCOURSE. LANDSCAPING UPDATED ACCORDINGLY. SITE LAYOUT UPDATED TO INCLUDE ADDITIONAL CYCLE SPACES. DIMENSIONS NOTING THE RADIUS OF THE CAR PARK KERBING & EXISTING ROADFOOTPATH WIDTH ADDED.	L-JL
A	1/10/2024		L-JL

REVISIONS



LNT CONSTRUCTION LTD
 UNIT 2, HELIOS 47
 ISABELLA ROAD
 GARFORTH
 LS25 2DY
 Tel: 0113 385 3858
 Fax: 0113 385 3859

CLIENT
 LNT CARE DEVELOPMENTS

SITE
 GRAVEN HILL
 BICESTER
 OX25 2BF

TITLE
 PROPOSED SITE PLAN

SCALE @A0	As indicated	DATE	27/11/2024 08:34:51
DRAWN	L-JL	DWG NO.	OX25 2BF A-03-B

FOR PLANNING APPROVAL

CHECKED BY		DATE	
APPROVED BY		DATE	

PROPOSED SITE PLAN
 1 : 200