

NOTES

- Contractors must check all dimensions on site. Only figured dimensions are to be worked from. Discrepancies must be reported to the Architect or Engineer before proceeding. © This drawing is copyright.
- All plans and drawings are drawn true to stated scales and can be used for the purpose of planning only. Responsibility is not accepted for errors made by others in scaling from this drawing.
- Reproduced from OS Sitemap © by permission of Ordnance Survey on behalf of The Controller of His Majesty's Stationery Office. © Crown copyright 2008. All rights reserved. Licence number 100007126.
- Until technical approval has been obtained from the relevant authorities, all drawings are issued as preliminary and not for construction. Should the Contractor commence site work prior to approval being given it is entirely at their own risk.
- Adoptable works and materials to comply with the Highways England 'Specification for Highway Works'.
- Drainage and Road designs subject to Water Company and Highway Authority approval.
- All existing covers being retained within the proposed carriageway extents are to be replaced with skid resistant type.

SAFETY, HEALTH AND ENVIRONMENTAL

- In addition to the hazards, risks normally associated with the type of work detailed on this drawing, note the following significant risks and information.
- Construction:
- Live services below and above ground.
  - Retention of pedestrian routes.
  - Works in vicinity of existing protected trees.
  - Location of survey controls within live Highway.
  - Slope stability of deep excavations.
  - Works to live sewers.
  - Possible presence of buried live explosives.

For information relating to end use, maintenance, demolition, see the health and safety file.

It is assumed that all works will be carried out by a competent Contractor, where appropriate, to an approved method statement.

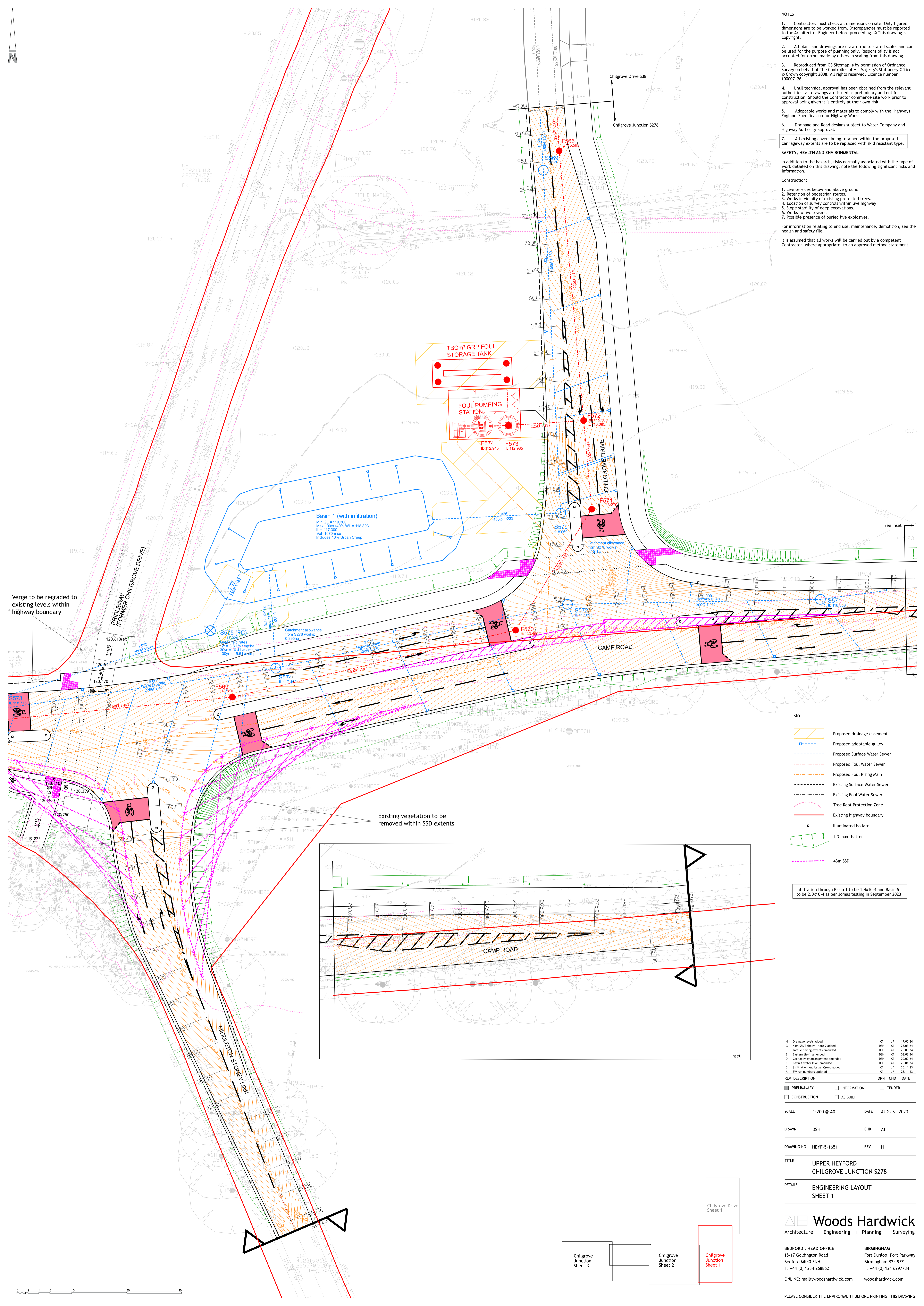

Verge to be regraded to existing levels within highway boundary

Existing vegetation to be removed within SSD extents

KEY

	Proposed drainage easement
	Proposed adoptable gully
	Proposed Surface Water Sewer
	Proposed Foul Water Sewer
	Proposed Foul Rising Main
	Existing Surface Water Sewer
	Existing Foul Water Sewer
	Tree Root Protection Zone
	Existing highway boundary
	Illuminated bollard
	1:3 max. batter
	43m SSD

Infiltration through Basin 1 to be 1.4x10<sup>-4</sup> and Basin 5 to be 2.0x10<sup>-4</sup> as per Jomas testing in September 2023

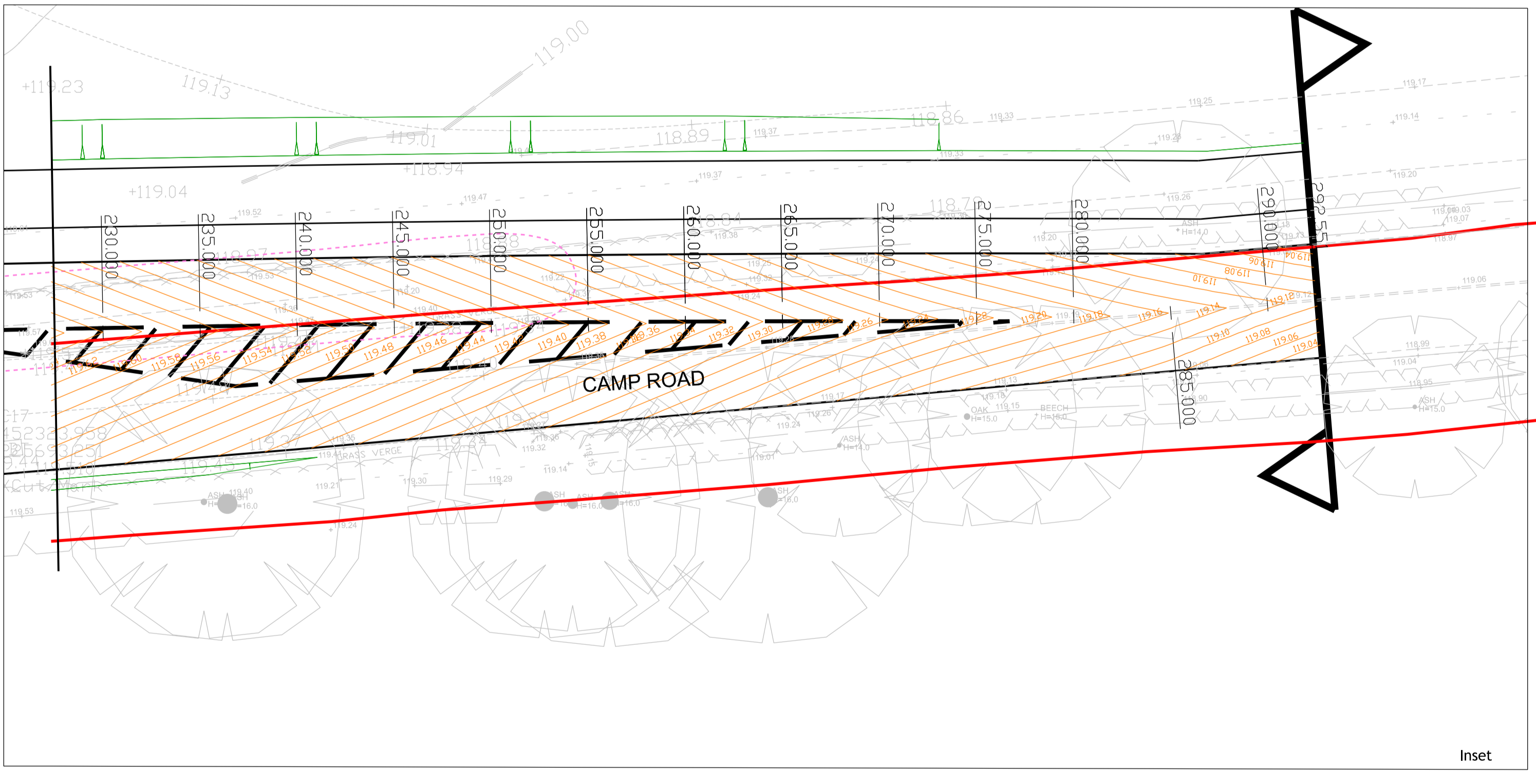

H	Drainage levels added	AT	JF	17.05.24
G	43m SSD shown, Note 2 added	DSH	AT	28.03.24
F	Tactile paving extents amended	DSH	AT	26.03.24
E	Eastern tie-in amended	DSH	AT	08.03.24
D	Carriageway arrangement amended	DSH	AT	20.02.24
C	Basin 1 water level amended	DSH	AT	26.01.24
B	Infiltration and Urban Creep added	AT	JF	20.11.23
A	10v run numbers updated	AT	JF	28.11.23

REV	DESCRIPTION	DRN	CHD	DATE	
<input type="checkbox"/>	PRELIMINARY	<input type="checkbox"/>	INFORMATION	<input type="checkbox"/>	TENDER
<input type="checkbox"/>	CONSTRUCTION	<input type="checkbox"/>	AS BUILT		

SCALE 1:200 @ A0 DATE AUGUST 2023

DRAWN DSH CHK AT

DRAWING NO. HEYF-5-1651 REV H

TITLE UPPER HEYFORD  
CHILGROVE JUNCTION S278

DETAILS ENGINEERING LAYOUT  
SHEET 1

Woods Hardwick  
Architecture | Engineering | Planning | Surveying

BEDFORD : HEAD OFFICE  
15-17 Goldington Road  
Bedford MK40 3NH  
T: +44 (0) 1234 268862

BIRMINGHAM  
Fort Dunlop, Fort Parkway  
Birmingham B24 9FE  
T: +44 (0) 121 6297784

ONLINE: mail@woodshardwick.com | woodshardwick.com

PLEASE CONSIDER THE ENVIRONMENT BEFORE PRINTING THIS DRAWING

