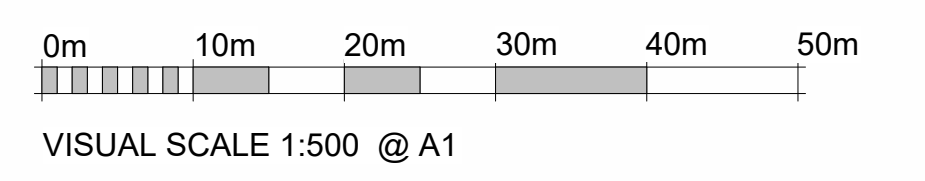

Figure 3.3 – Existing Sections



1 Existing Site Section E-W
1 : 500



2 Existing Site Section N-S
1 : 500

NOTES
All dimensions and levels to be checked on site
Any discrepancies are to be reported to the Architect before any work commences
This drawing shall not be scaled to ascertain any dimensions, work to figured dimensions only
This drawing shall not be reproduced without express written permission from AFL Architects Ltd.

DISCLAIMER
When this drawing is issued in CAD, it is an uncontrolled version issued for information only, to enable the recipient to prepare their own documents/drawings for which they are solely responsible.

SOFTWARE INTEROPERABILITY
AFL prepared this drawing using Autodesk REVIT Architecture.
AFL does not accept liability for any loss or degradation of any information held in the drawing resulting from the translation from the original file format to any other file format or from the recipient's reading of it in any other programme.

PO3	14/12/23	JA	Final Issue for Planning
REV NO.	REV DATE	REV BY	DESCRIPTION

client
Oxford United Football Club



AFL Architects
1st Floor, St Georges House
56 Peter Street, Manchester UK
M2 3NQ

t: +44(0)161 236 6263
f: +44(0)161 236 6484

w: www.afl-architects.com
e: mail@afl-uk.com
twitter.com/AFLArchitects

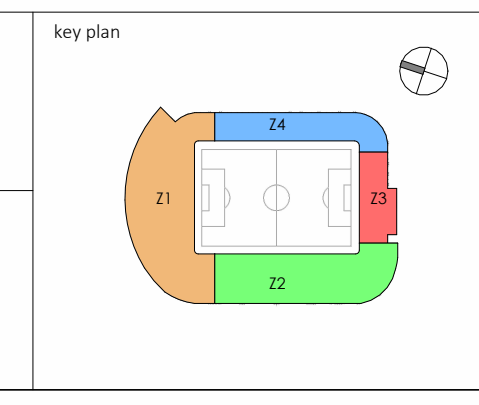
project
Oxford United Football Club

location
Oxford

drawing title
Site Sections - Existing

AFL job number	scale @ A1	drawn	JN	checked	DC
221524	1 : 500	rev date	14/12/23		
dwg purpose	status	rev			
PLANNING	S2	P03			
bim project	origin	zone	level	type	role
OUFC-AFL-ZZ-ZZ-DR-A-003000					