

Dimensions are not to be scaled from this drawing



Kingfisher Lighting

Part of the Luceco PLC group of companies **LUCECO**



Part of the Luceco PLC group of companies **LUCECO**

BREEAM New Construction 2018 (UK)

46581 - Oxford Technology Park, Unit 7

Qty	Range	Light Source	Lamp Lumens	Circuit Watts	Lm/W	LOR	Luminaire Lumens	ULOR	Upward Lumens	RA	ART Hour Per Day	CO2 Calculation for year	Wattour
8	Italo 1	S05 - 4000K 2 Module	8000	31	258.06	100.0%	25800	0.0%	0	70	12	0.25	308.72
5	Deco 2.0 HD	7.5w LED	930	8	116.25	100.0%	4650	31.3%	618	60	12	0.04	384.25
30	Quarto LED	7.5w LED Optic	826	8	113.25	100.0%	8300	0.0%	0	70	12	0.08	328.50
21	Zactis	160w LED Flood	21000	160	131.25	100.0%	21000	0.0%	0	60	12	0.35	700.80
1	Alfresco 2.0 Hood LED	20w LED Flood	2147	20	107.35	54.0%	1159	40.2%	466	60	12	0.02	87.60

Total Installation Lumens: 68009.38 Total LOR: 1.86%

Table 1 compliance

Environmental zone: 13

Sky Glow: Target 3.00%, Achieved 1.86%, Status Pass

Source Intensity (candelas): 10,000 Pass; Post outflow: 1,000 Pass

Light Trespass into windows (Lux): 10 Pass; Post outflow: 2 Pass

Compliance Status: Pass for all categories including reduction of night time light pollution, energy efficient external lighting, and internal and external lighting levels.

Note: BREEAM in this report only applies to exterior lighting

Total CO2 per year (Tonnes): 0.64

Total Electrical consumption (kWh): 0.64

Total Electrical consumption per year (kWh/m²): 1,348.87

Average luminance lumens per circuit Watt: 122.11

Kingfisher Lighting Ltd
Ratcliff Way, Crown Farm Business Park
Mansfield, Nottinghamshire
NG19 0FS

T: +44 (0)1623 415900
E: sales@kingfisherlighting.com
W: www.kingfisherlighting.com

Part of the Luceco plc group of companies **LUCECO**

VAT No. 509145848 Company No. 2236337

Symbol	Qty	Label	Arrangement	LLF	Description
1	4	EXT1A	SINGLE	0.900	40w LED 4000k (2 module) 700mA Italo 1 with S05 Optic Column Mounted 8m
2	2	EXT1B	BACK-BACK	0.900	2x 40w LED 4000k (2 module) 700mA Italo 1 with S05 Optic Column Mounted 8m
3	5	EXT2	SINGLE	0.900	7.5w LED 4000k Deco 2.0 1m high bollard
4	10	EXT3	SINGLE	0.900	7.5w LED 4000k Quarto 2.0 250mA bulkhead with cycle optic Wall Mounted 3.5m
5	1	EXT4	SINGLE	0.900	160w LED 4000k Zactis 808mA Floodlight with FW70 Optic Wall Mounted 8m
6	1	EXT6	SINGLE	0.900	20w LED 4000k Alfresco 2.0 bulkhead with hood Wall Mounted 2.8m

Label	CalcType	Units	Avg	Max	Min	Min/Avg	Min/Max
Bin Store	Illuminance	Lux	21.00	30	12	0.57	0.40
Car Park East	Illuminance	Lux	20.00	76	5	0.25	0.07
Car Park West	Illuminance	Lux	13.25	22	5	0.38	0.23
Loading Bay	Illuminance	Lux	55.61	65	40	0.72	0.62
Pedestrian Area	Illuminance	Lux	10.72	78	3	0.28	0.04
Perimeter Lighting	Illuminance	Lux	12.43	35	4	0.32	0.11

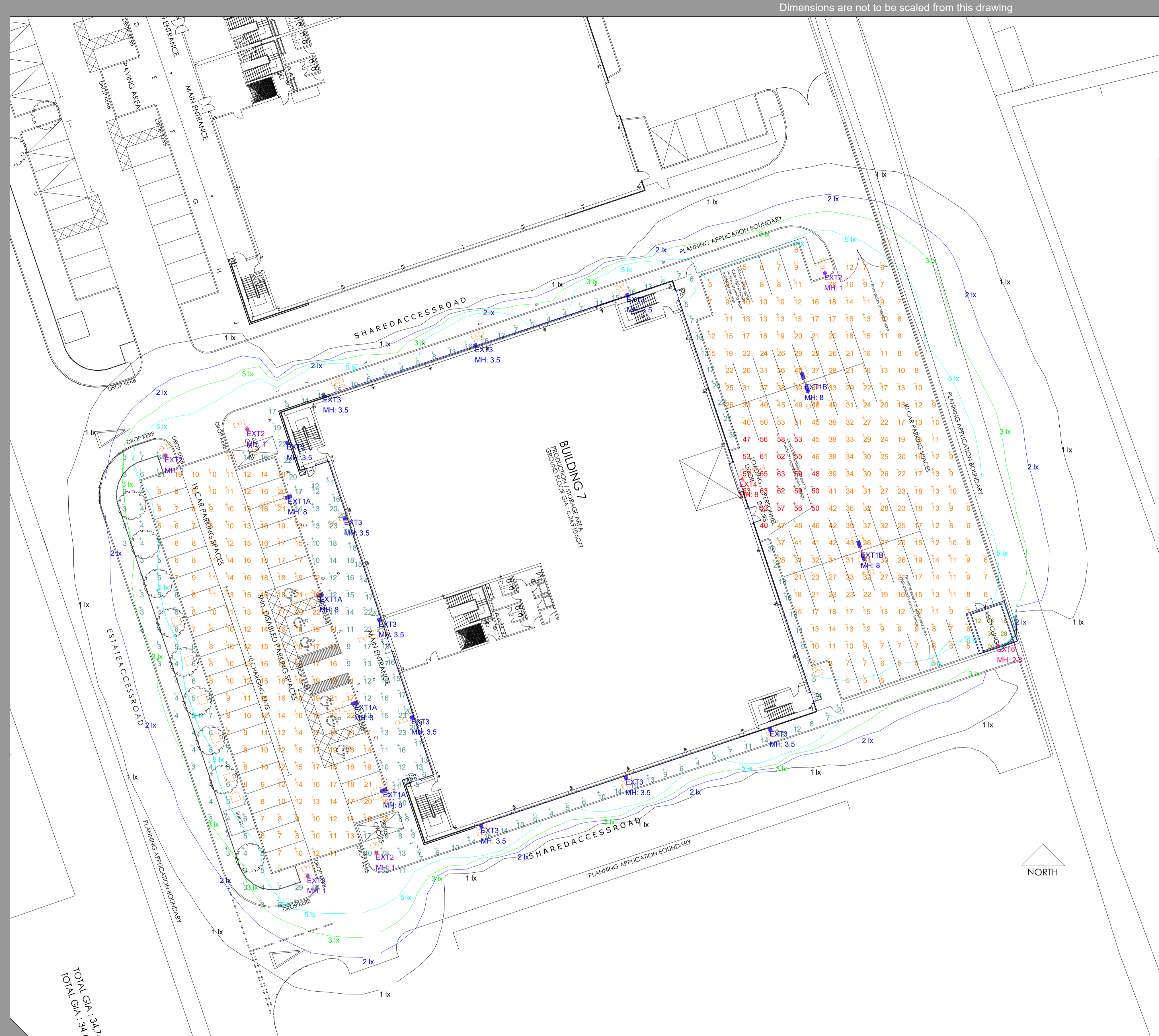

TOTAL GIA: 34,745 SQ FT (3,228 SQ M)
TOTAL GIA: 34,695 SQ FT (3,227 SQ M)

A1

Oxford Technology Park, Unit 7

Scale: 1:250 at A1 Project Number: D46581A

Date: 27 June 2022 Drawing No.: D46581/PMU/A

Lighting Designer: P.Murphy

HEA HEMSA ILLIP

For our LED lighting designs a 0.9m has been used. If this differs from the maintenance period for this project then you must advise us accordingly

A lighting applications design service is provided by us in good faith and without charge, relating to Kingfisher products only. As such, whilst every endeavor is made for accuracy from information provided by yourselves, the final responsibility for the suitability of the design lies with the client. The company cannot, therefore, accept any liability or consequential loss incurred.