

Station	Easting (m)	Northing (m)	Level (m)	Description
BT1	49688.988	22668.767	86.891	Met
BT2	49693.886	22669.328	86.184	Met
BT3	49678.471	22670.288	86.227	Met
BT4	49648.156	22669.025	86.272	Met
BT5	49644.125	22669.652	86.514	Met
BT6	49643.985	22670.288	86.860	Met
BT7	49644.125	22669.652	86.514	Met
BT8	49644.125	22669.652	86.514	Met
BT9	49644.125	22669.652	86.514	Met
BT10	49644.125	22669.652	86.514	Met
BT11	49644.125	22669.652	86.514	Met
BT12	49644.125	22669.652	86.514	Met
BT13	49644.125	22669.652	86.514	Met
BT14	49644.125	22669.652	86.514	Met
BT15	49644.125	22669.652	86.514	Met
BT16	49644.125	22669.652	86.514	Met
BT17	49644.125	22669.652	86.514	Met
BT18	49644.125	22669.652	86.514	Met
BT19	49644.125	22669.652	86.514	Met
BT20	49644.125	22669.652	86.514	Met

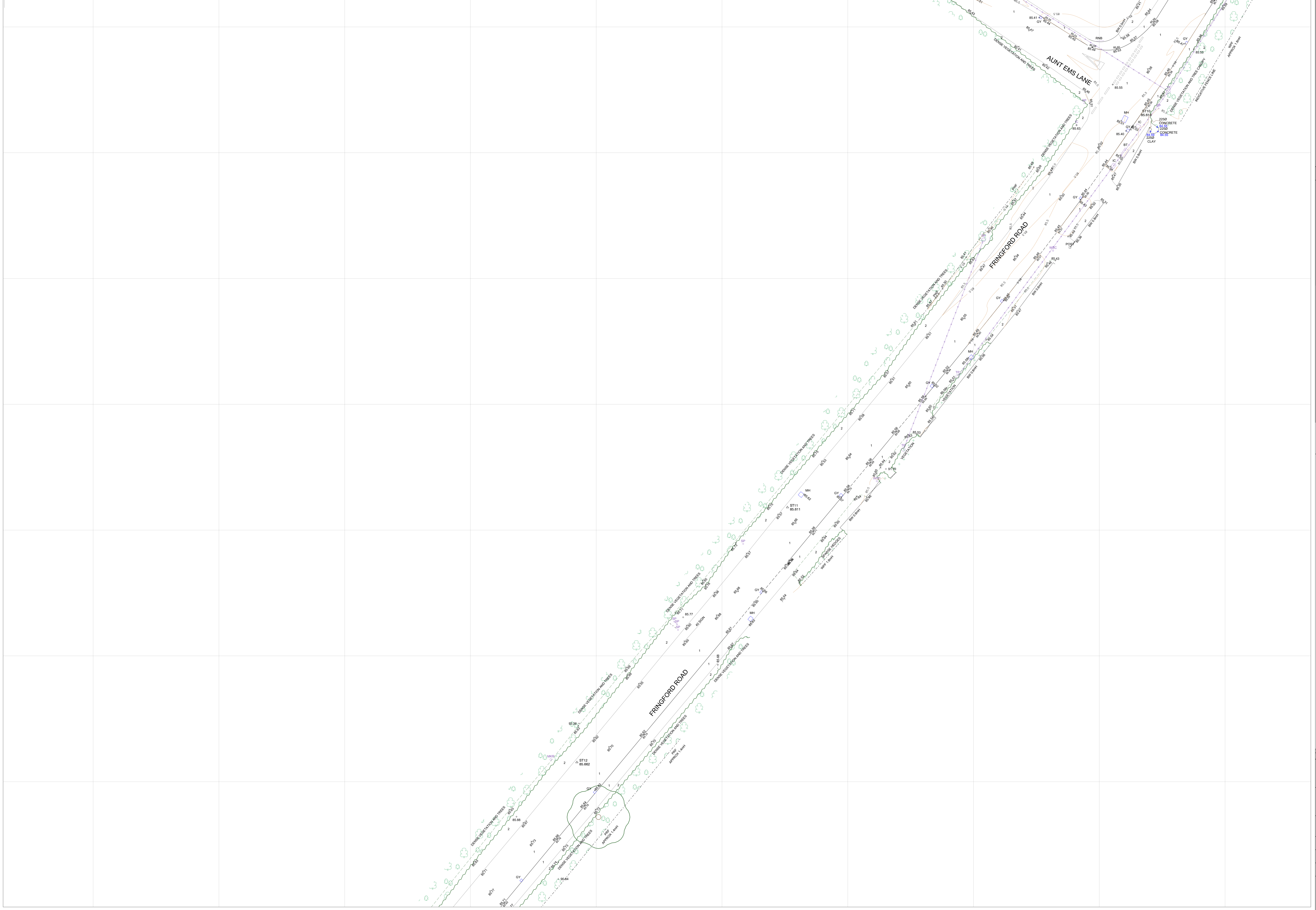

- SURVEY NOTES**
- THIS PLAN SHOULD BE USED FOR ITS ORIGINAL PURPOSE ONLY. M.E.C. ACCEPTS NO RESPONSIBILITY FOR ITS DRAWINGS IF THEY ARE SUPPLIED TO ANY OTHER PARTY OTHER THAN THE ORIGINAL CLIENT.
  - THE INFORMATION SHOWN HAS BEEN SURVEYED IN ACCORDANCE TO THE REQUIREMENTS AND ACCURACY BANDING OUTLINED WITHIN THE ORIGINAL SCOPE INTENDED. PLEASE CHECK WITH M.E.C. IF UNSURE.
  - BOUNDARIES SHOWN ARE PHYSICAL. SITE FEATURES AND MAY NOT REPRESENT LEGALLY CONVEYED OWNERSHIP.
  - ALL FEATURES SHOWN WERE CURRENT AT THE TIME OF SURVEY. SOME FEATURES MAY HAVE BEEN MISSED OR OMITTED DUE TO ACCESS, PARKED VEHICLES, TEMPORARY STRUCTURES OR DENSE VEGETATION OR DUE TO THE SCOPE OF THE PROJECT. PLEASE CHECK WITH M.E.C. IF CLARIFICATION IS REQUIRED.
  - ALL GLOBAL NAVIGATION AND SATELLITE SYSTEM (GNSS) DETAIL AND REFERENCE STATIONS HAVE BEEN CAPTURED AND TRANSFORMED ONTO ORDNANCE SURVEY NATIONAL GRID AND DATUM OSGB36 USING THE O.S. ACTIVE NETWORK (OS NET) TRANSFORMATION AND GEOID MODEL OSTN15 & OSBM15.
  - NO SCALE FACTOR HAS BEEN APPLIED TO THE SURVEY CONTROL STATIONS AND RELATED DETAIL. THEREFORE ALL THE APPLICABLE COORDINATES SHOWN ARE NOT ON TRUE OSGB36(S), AND HAVE BEEN GEOREFERENCED USING A PSEUDO-GEOCENTRIC COORDINATE THAT HAS BEEN ESTABLISHED IN A CENTRALISED LOCATION TO THE CAPTURED GNSS REFERENCE STATIONS WITHIN THE SITE, AND ROTATED ON A BEARING USING A GNSS REFERENCE STATION AT SURVEY CONTROL STATION 072.
  - THE LEVELS SHOWN ARE RELATIVE TO THE OSGB REFERENCE STATION LEVELS CAPTURED AND THE DIFFERENCE AVERAGED BETWEEN THEM.
  - ALL LEVELS ARE REPRESENTATIVE TO METRES ABOVE ORDNANCE DATUM.
  - PLEASE NOTE THAT THE 3D TOPOGRAPHICAL SURVEY CAN BE ACCESSED BY TURNING ON 3D LAYERS VIA THE LAYER FILTER IN THE LAYER MANAGER.
  - ALL UNITS ARE IN METRES UNLESS OTHERWISE SPECIFIED.
  - SURVEY SHOWN UNDERTAKEN BY M.E.C. IN AUGUST 2023 WITH THE ADDITIONAL DATA CAPTURED IN SEPTEMBER 2023.
  - NOT ALL LEGEND DETAIL MAY BE APPLICABLE IN THIS DRAWING. IF ANY CLARIFICATION IS REQUIRED PLEASE INFORM M.E.C.
  - ANY MEASUREMENTS TAKEN OFF THE INFORMATION PROVIDED SHOULD BE CHECKED ON SITE BEFORE BEING ACTIONED OR DISTRIBUTED TO THIRD PARTIES IF NOT THE ORIGINAL CLIENT.

**TOPOGRAPHICAL LEGEND**

	<b>BUILDING</b>		<b>FLOODLIGHT</b>
	<b>BOTTOM OF BANK</b>		<b>FLAGPOLE</b>
	<b>BENCH</b>		<b>GAS</b>
	<b>CHANNEL</b>		<b>GAS PIPE INLET</b>
	<b>CENTER LINE</b>		<b>ILLUMINOUS BOLLARD</b>
	<b>LINE MARKING</b>		<b>JUNCTION BOX</b>
	<b>CHANGE IN SURFACE</b>		<b>LITTER BIN</b>
	<b>TOP OF KERB</b>		<b>LAMP POST</b>
	<b>EDGE OF TREES</b>		<b>LAMP POST</b>
	<b>EDGE OF VEGETATION</b>		<b>MARKER POST</b>
	<b>FENCE</b>		<b>MANHOLE COVER</b>
	<b>GATE</b>		<b>MARKER POST</b>
	<b>OVERHEAD LINES</b>		<b>PARKING METER</b>
	<b>RIVER EMBANKMENT</b>		<b>ROAD NAME BOARD</b>
	<b>ROOTLINE</b>		<b>SERVICE MARKER</b>
	<b>STEPS</b>		<b>SIGN POST</b>
	<b>TOP OF BANK</b>		<b>STOP TAP</b>
	<b>TOP OF WALL</b>		<b>STYLE</b>
	<b>VERGE</b>		<b>TELEPHONE CALL BOX</b>
	<b>WALL</b>		<b>TRAFFIC LIGHT</b>
	<b>WATER LINE</b>		<b>UTILITY POST</b>
	<b>PIPELINE</b>		<b>WATER SERVICE MARKER</b>
	<b>CHAMBER</b>		<b>WATER METER</b>
	<b>GATE</b>		<b>WASH OUT</b>
	<b>TREE BURIAL SPILING</b>		<b>WATER PIPE INLET</b>
	<b>BOREHOLE</b>		
	<b>TRIAL PIT</b>		
	<b>STAKEOUT</b>		

**ABBREVIATIONS**

	<b>BED LEVEL</b>		<b>CHAMBER</b>
	<b>INVERT LEVEL</b>		<b>GATE</b>
	<b>WATER LEVEL</b>		<b>TREE BURIAL SPILING</b>
	<b>FENCE LEVEL</b>		<b>BOREHOLE</b>
	<b>FLOOR LEVEL</b>		<b>TRIAL PIT</b>
	<b>THRESHOLD LEVEL</b>		<b>STAKEOUT</b>
	<b>WALL LEVEL</b>		
	<b>AVE TOP OF VEG</b>		
	<b>AVE TOP OF TREES</b>		
	<b>TREE LEVEL</b>		
	<b>LEVEL LEVEL</b>		
	<b> RIDGE LEVEL</b>		
	<b>RETAINING WALL</b>		
	<b>ARCHED BARRIER</b>		
	<b>BARBED WIRE</b>		
	<b>CORRUGATED IRON</b>		
	<b>CHAIN LINK</b>		
	<b>CHESTNUT PAVING</b>		
	<b>CONCRETE PANEL</b>		
	<b>IRON RAILING</b>		
	<b>INTERWOVEN METAL FENCE</b>		
	<b>POST &amp; CHAIN</b>		
	<b>POST &amp; IRON RAIL</b>		
	<b>POST AND RAIL</b>		
	<b>POST &amp; WIRE</b>		
	<b>STEEL PALISADE</b>		
	<b>WIRE MESH FENCE</b>		
	<b>WOOD PANEL FENCE</b>		
	<b>AIR WALL</b>		
	<b>BOLLARD</b>		
	<b>BUS STOP</b>		
	<b>CABLE MARKER</b>		
	<b>CLOSED CIRCUIT CAMERA</b>		
	<b>CONTROL BOX</b>		
	<b>CABLE TELEVISION</b>		
	<b>ELECTRIC EARTH ROD</b>		
	<b>FIRE HYDRANT</b>		

**SYMBOLS**

	<b>CHAMBER</b>		<b>PIPE DIAMETER (mm)</b>
	<b>GATE</b>		<b>BACK GULLY</b>
	<b>TREE BURIAL SPILING</b>		<b>COVER LEVEL</b>
	<b>BOREHOLE</b>		<b>DOWN PIPE</b>
	<b>TRIAL PIT</b>		<b>GULLY</b>
	<b>STAKEOUT</b>		<b>INSPECTION CHAMBER</b>
			<b>INVERT LEVEL</b>
			<b>MANHOLE</b>
			<b>SOFT LEVEL</b>
			<b>SURFACE SEWAGE SYSTEM</b>
			<b>FOUL SEWAGE SYSTEM</b>
			<b>UNKNOWN SEWAGE SYSTEM</b>

**SURFACE KEY**

	<b>ASPHALT</b>		<b>GRASS</b>
	<b>CONCRETE</b>		<b>UNMADE GROUND</b>
	<b>CONCRETE SLAB</b>		<b>VEGETATED GROUND</b>
	<b>BLOCK PAVING</b>		<b>CONCRETE SLAB</b>
	<b>CONCRETE SLAB</b>		<b>TARMAC</b>

**STATIONS**

	<b>STATION LEVEL</b>
	<b>STATION AND NAME</b>

REV	AMENDMENTS:	SS	JO	AB	02/10/24
REV	AMENDMENTS:	DRN	CHK	APP	DATE
PROJECT:					
<b>AUNT EMS LANE CAVERSFIELD</b>					
DRAWING TITLE:					
<b>TOPOGRAPHICAL SURVEY SHEET 7 OF 9</b>					
CLIENT:					
<b>RICHBOROUGH ESTATES LTD</b>					
DRAWING NUMBER:					
<b>27877_06_170_01.7</b>					
REVISION:	SHEET SIZE:	SCALE:			
-	A0	1:200			
STATUS:					
<b>FOR INFORMATION</b>					
<b>M.E.C GEOMATICS</b>					
Telephone: 01332 394 733 Email: g.m@me-ec.co.uk Website: www.me-ec.co.uk					
ORDNANCE SURVEY © CROWN COPYRIGHT 2015. ALL RIGHTS RESERVED. LICENSE NUMBER 10005666.					