

Dimensions are not to be scaled from this drawing

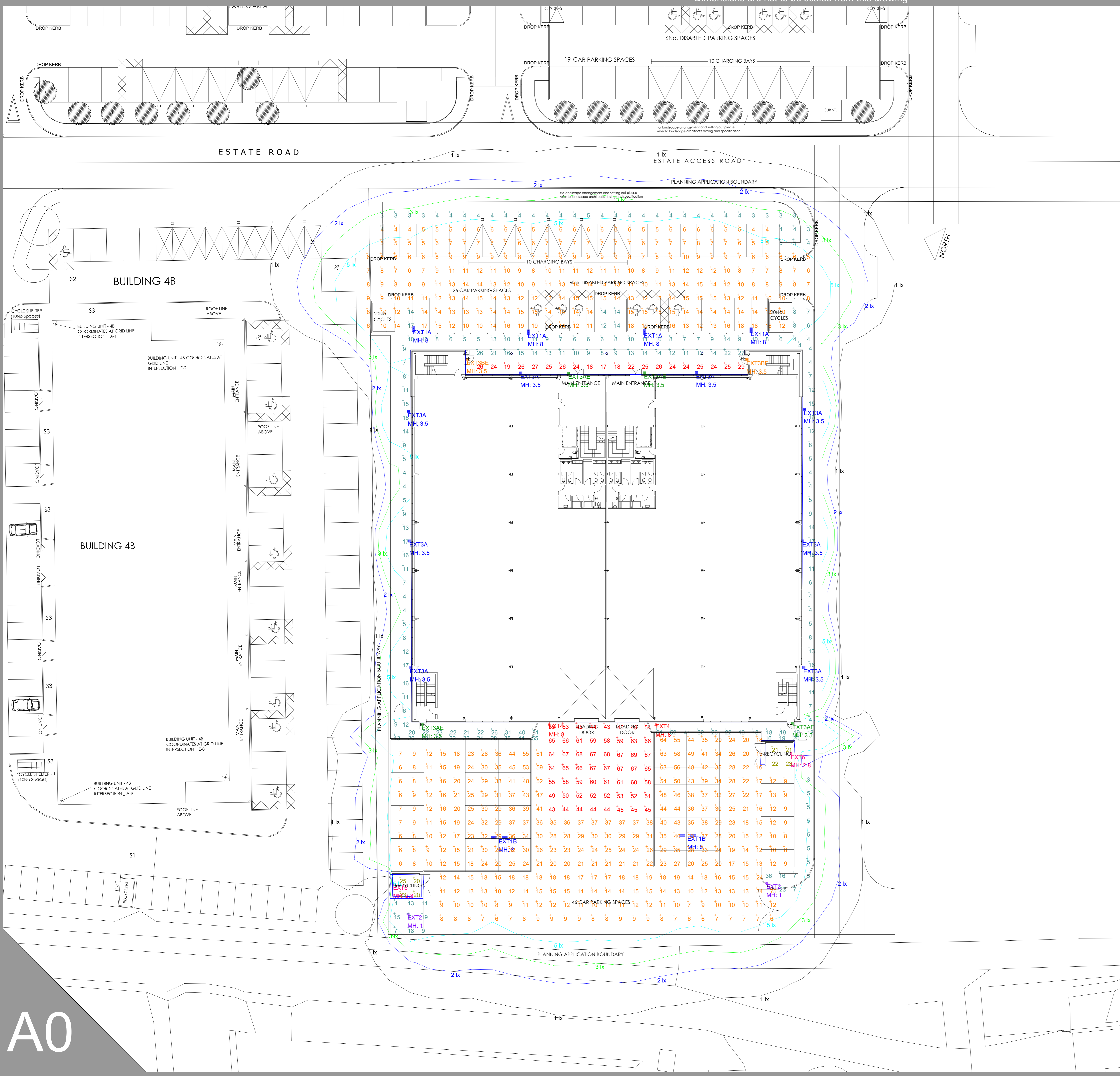

BREEAM New Construction 2018 (UK)

Oxford Technology Park Unit 6 & 6B

Qty	Range	Light Source	Lamp Lumens	Circuit Watts	Leak%	LOB	Luminaire Lumens	ULOR	Upward Lumens	BA	ART Hour Day	CO2 Calculation for year	
8	1000	3000	3000	3000	3000	3000	3000	3000	3000	3000	3000	3000	
2	1000	3000	3000	3000	3000	3000	3000	3000	3000	3000	3000	3000	
12	1000	3000	3000	3000	3000	3000	3000	3000	3000	3000	3000	3000	
2	1000	3000	3000	3000	3000	3000	3000	3000	3000	3000	3000	3000	
2	1000	3000	3000	3000	3000	3000	3000	3000	3000	3000	3000	3000	
2	1000	3000	3000	3000	3000	3000	3000	3000	3000	3000	3000	3000	
Total Installation Lumens											8102.76	Total Usr	1.822

Compliance Status	Pass	Fail
Table 1 compliance	Pass	Fail
Environmental page	Pass	Fail
Daylight	Pass	Fail
Source intensity (ambience)	Pass	Fail
Light trespass into windows (Lx)	Pass	Fail
Building Luminaire (color)	Pass	Fail

Symbol	Qty	Label	Arrangement	LLF	Description
1	4	EXT1A	SINGLE	0.900	40w LED 4000K (2 medium) 700mA lobe 1 with 500 Optic Column mounted 8m
2	2	EXT1B	BACK-TO-BACK	0.900	2x 40w LED 4000K (2 medium) 700mA lobe 1 with 500 Optic Column mounted 8m
3	2	EXT1C	SINGLE	0.900	7.5w LED 4000K Deco 2.0 1m high bollard
4	8	EXT1A	SINGLE	0.900	7.5w LED 4000K Quarto 2.0 250mA bulbhead with cycle optic & emergency. Wall mounted 3.5m
5	4	EXT1A	SINGLE	0.900	7.5w LED 4000K Quarto 2.0 250mA bulbhead with cycle optic & emergency. Wall mounted 3.5m
6	2	EXT1B	SINGLE	0.900	7.5w LED 4000K Quarto 2.0 250mA bulbhead with cycle optic & emergency. Wall mounted 3.5m
7	2	EXT1C	SINGLE	0.900	100w LED 4000K Zavis 500mA Floodlight with F170 Optic Wall mounted 8m
8	2	EXT1D	SINGLE	0.900	20w LED 4000K Address 2.0 50mA bulbhead with hood Wall mounted 2.8m

Label	CalcType	Units	Avg	Max	Min	Min/Avg	Min/Max
Car Park 1	Illuminance	Lux	22.11	75	6	0.27	0.08
Car Park 2	Illuminance	Lux	19.08	19	4	0.40	0.21
Entrance Area	Illuminance	Lux	23.70	29	17	0.72	0.59
Loading Bay 1	Illuminance	Lux	56.63	66	43	0.76	0.63
Loading Bay 2	Illuminance	Lux	57.52	69	45	0.78	0.65
Perimeter Lighting	Illuminance	Lux	14.67	61	4	0.27	0.07
Production Areas	Illuminance	Lux	19.30	16	3	0.29	0.05
Bin Store	Illuminance	Lux	21.75	23	21	0.97	0.91
Bin Store 2	Illuminance	Lux	22.00	25	20	0.91	0.80



A0

Oxford Technology Park Unit 6 & 6B

Scale: 1:200 at A0 | Project Number: D47309A

Date: 22 September 2022 | Drawing No.: D47309/PMU/A

Lighting Designer: P. Murphy

For our LED lighting designs a 0.9mf has been used. If this differs from the maintenance period for this project then you must advise us accordingly.

A lighting applications design service is provided by us in good faith and without charge, relating to Kingfisher products only. As such, whilst every endeavor is made for accuracy from information provided by yourselves, the final responsibility for the suitability of the design lies with the client. The company cannot, therefore, accept any liability or consequential loss incurred.