

BICESTER MOTION - INNOVATION QUARTER LANDSCAPE DESIGN STRATEGIES - PLANTING

Macgregor Smith

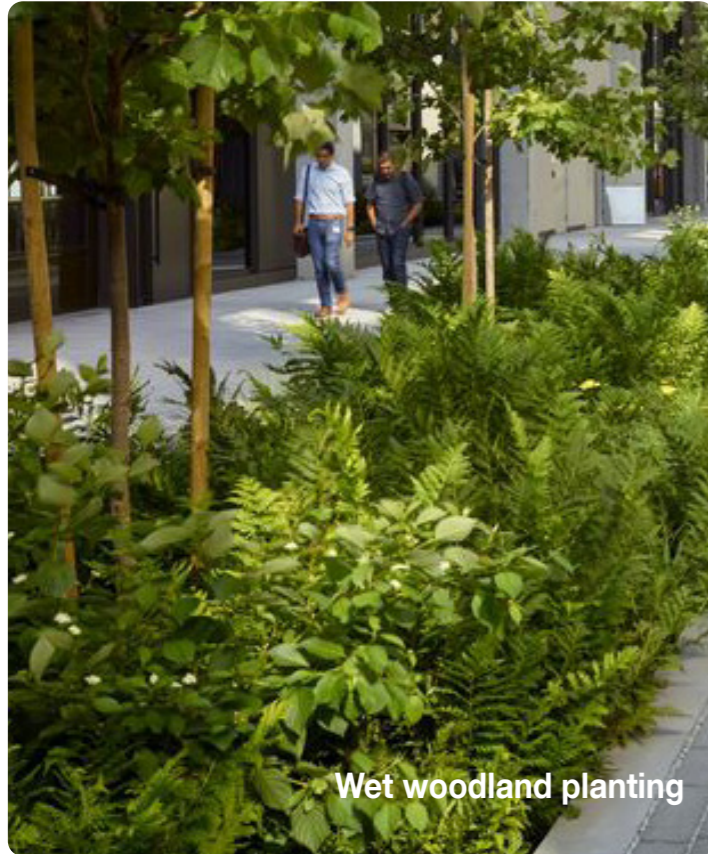

Wet woodland planting



Mown paths



Amenity lawns



Enhanced species-rich grassland



Wetland planting to attenuation basins

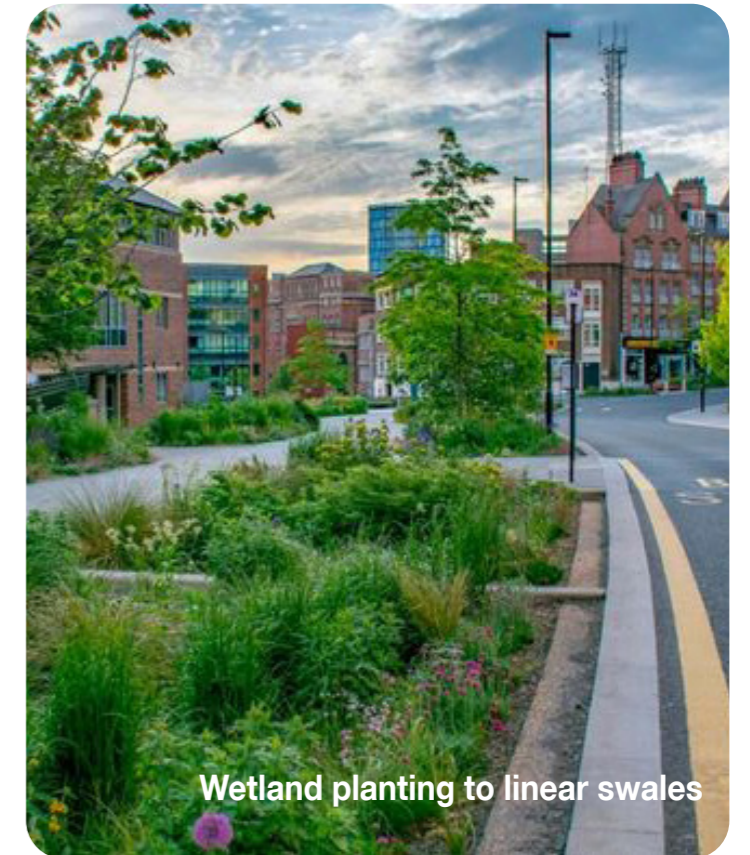

Wetland planting to linear swales

BICESTER MOTION - INNOVATION QUARTER

LANDSCAPE DESIGN STRATEGIES - MATERIALS

Macgregor Smith

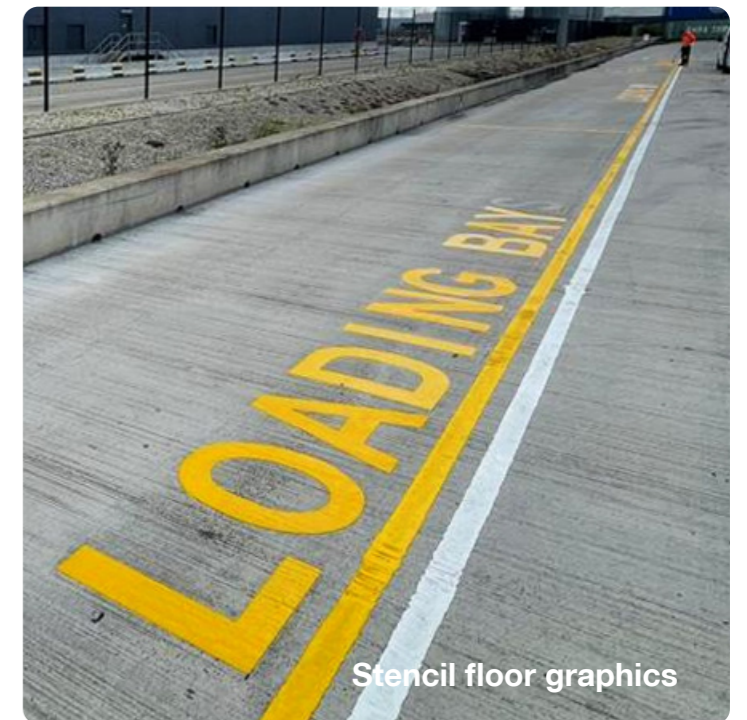
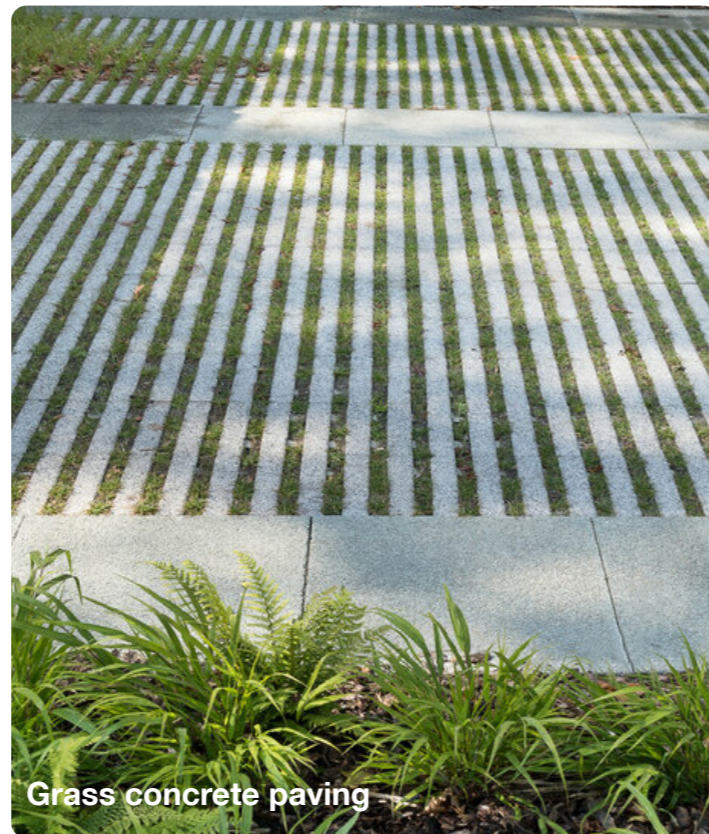

BICESTER MOTION - INNOVATION QUARTER

PARKING STRATEGY

3DReid

KEY:

- Accessible Car Parking
- Entry/Exit car route
- Cycle parking
- Standard parking spaces
- Pedestrian route

**25% will be EV charging spaces*

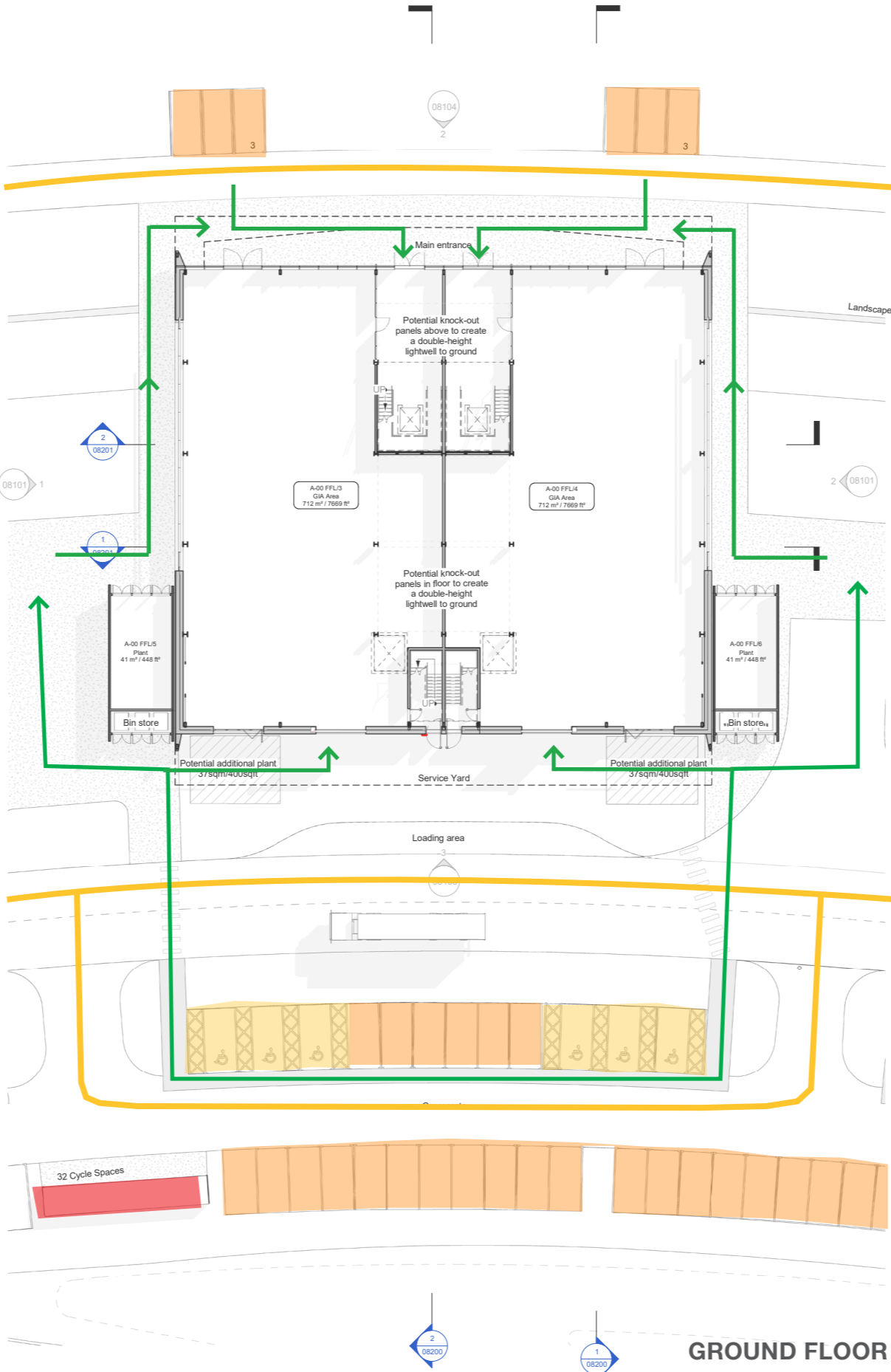

BICESTER MOTION - INNOVATION QUARTER

SERVICING STRATEGY

3DReid

KEY:

- Delivery bay
- Servicing and deliveries
- Bin Store
- Plant 41sqm/447sqft
- Potential additional plant 37sqm/400sqft
- Maintenance & Fire vehicle route

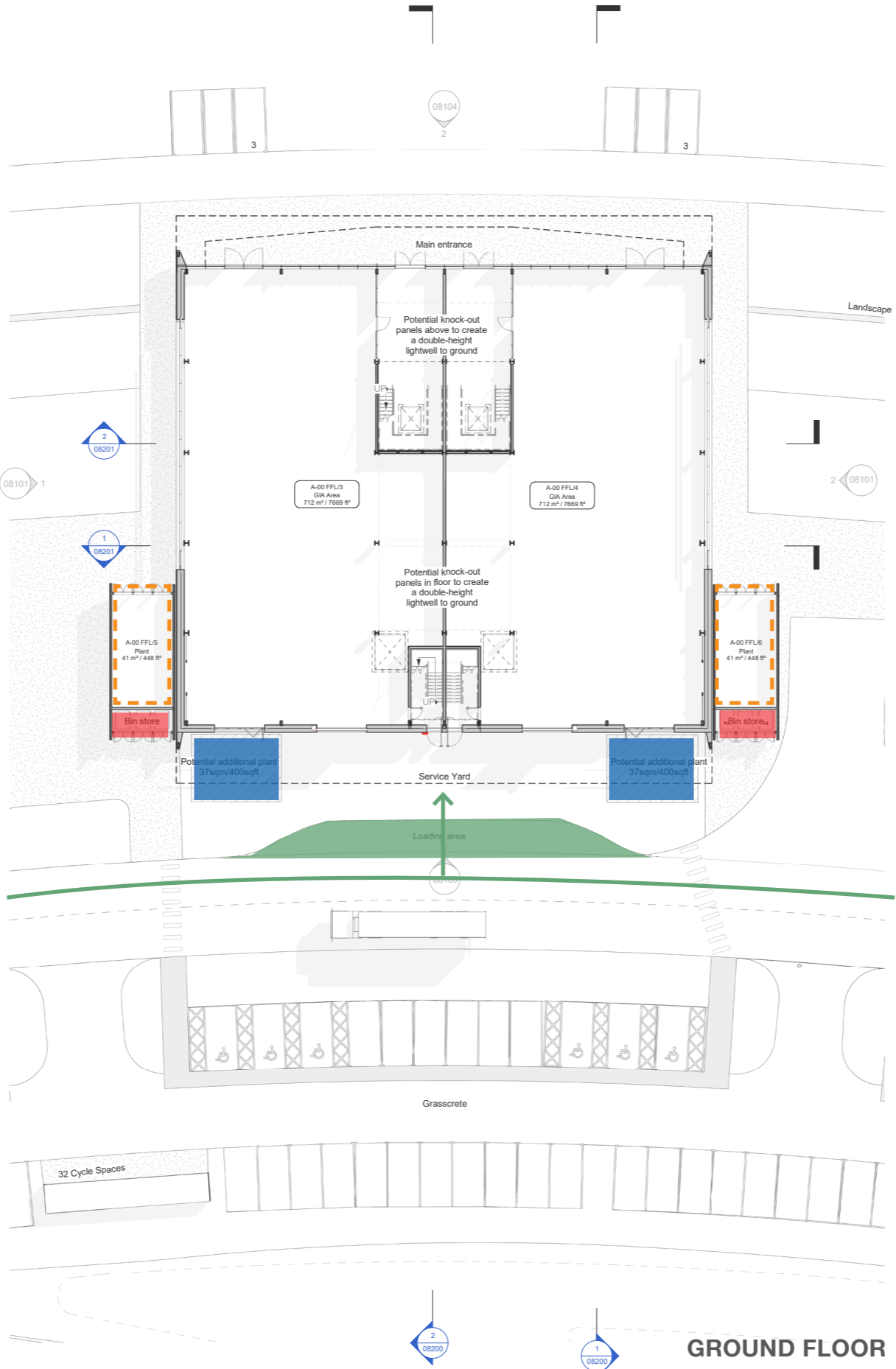

GROUND FLOOR

BICESTER MOTION - INNOVATION QUARTER SUSTAINABILITY STRATEGY

3DReid

1. Capturing benefits from site orientation

- Strategic positioning of buildings to ensure maximised north-facing glazing

2. Efficient envelope design

- A target has been set for an EPC rating of 90+ (or 10 as per the diagram on the right)

3. Excellent air tightness

- A target of maximum 3m³/hr/m²@50Pa has been set

4. Good daylighting

- Generous glazing which is strategically positioned to avoid overheating

5. Demand driven energy consumption

- Mechanical ventilation and smart heating systems to be installed

6. De-carbonisation through renewable technology

- PV provision on the roofs

7. Enhanced biodiversity

- Meadows and green roofs would be provided where possible

Be lean, Be clean, Be green

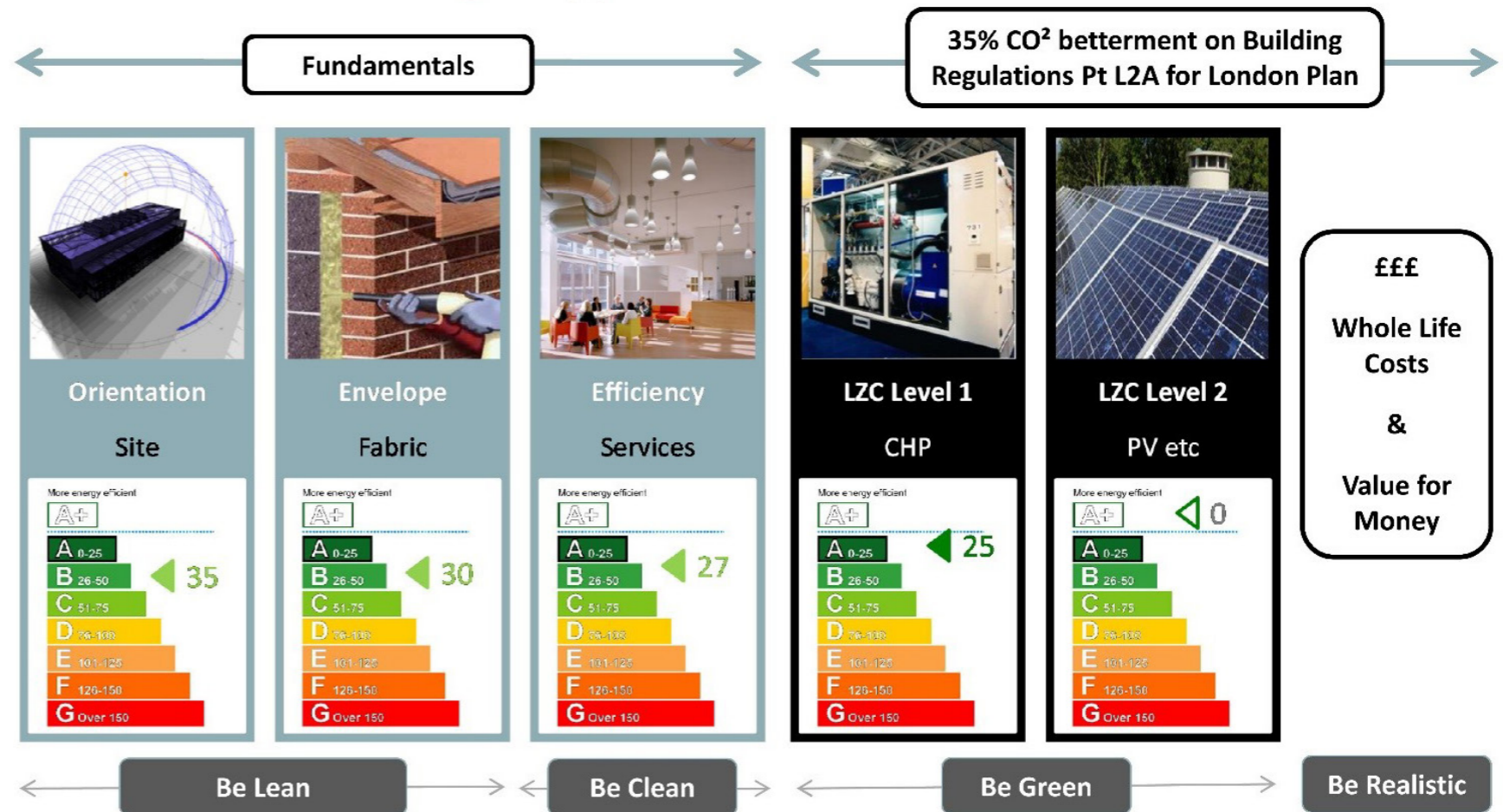

Energy Hierarchy (GLA London Plan)



On Target for BREEAM Very Good
Aiming for Excellent Rating



Sustainable Construction



PV Panels

For more details, please, refer to 24223-HYD-XX-XX-RP-Y-5002 Energy Strategy & Part L report

Birmingham
12 Caroline Street
Birmingham
B3 1TR
t +44 (0)345 271 6200

Edinburgh
36 North Castle Street
Edinburgh
EH2 3BN
t +44 (0)345 271 6300

Glasgow
45 West Nile Street
Glasgow
G1 2PT
t +44 (0)345 271 6350

London
1 Hills Place
London
W1F 7SA
t +44 (0)345 271 6100

Manchester
26 Cross Street
Manchester
M2 7AQ
t +44 (0)345 271 6250

3DReid