

Do not scale from this drawing. Use figured dimensions only

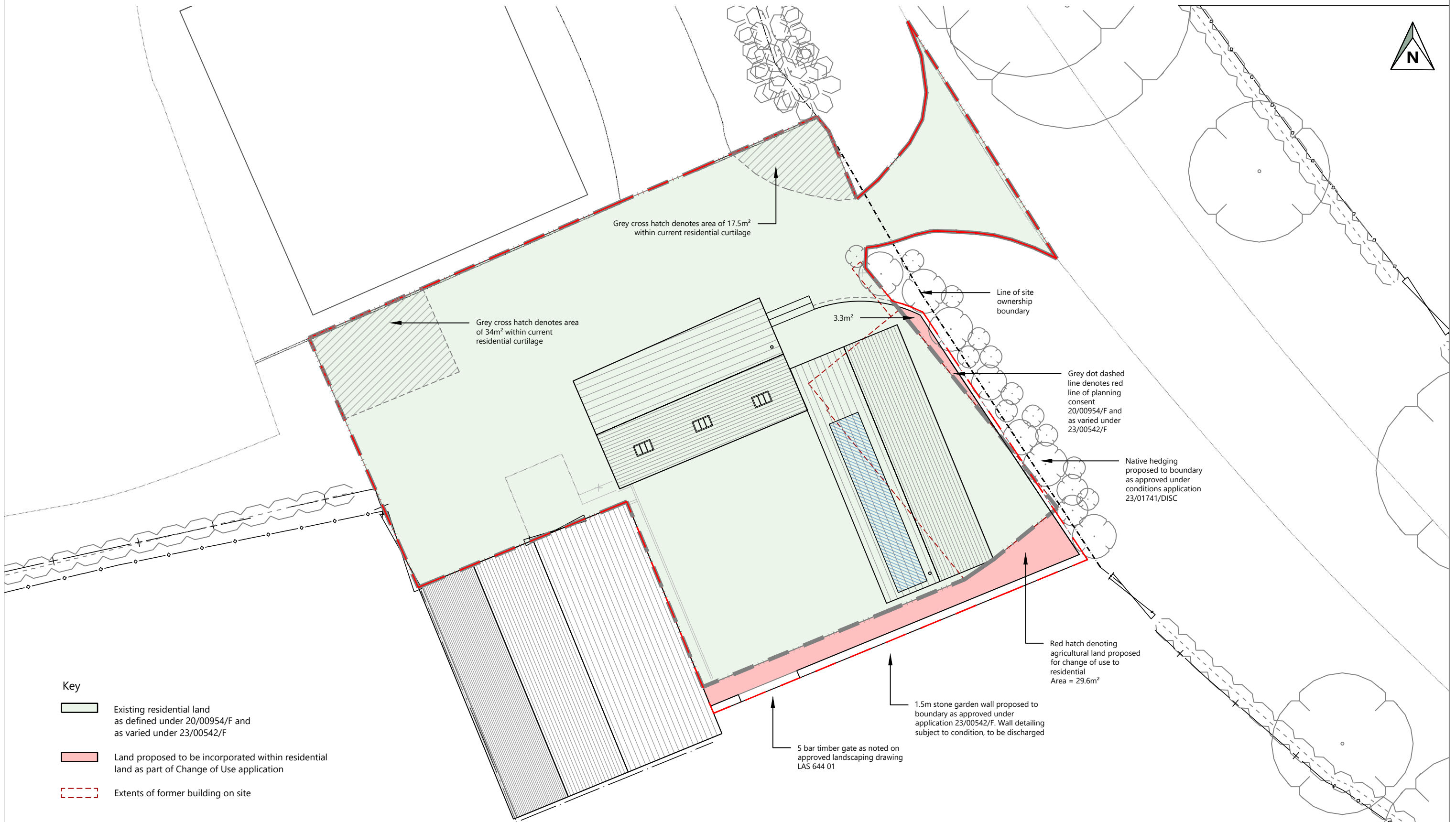

Grey cross hatch denotes area of 17.5m² within current residential curtilage

Grey cross hatch denotes area of 34m² within current residential curtilage

3.3m²

Line of site ownership boundary

Grey dot dashed line denotes red line of planning consent 20/00954/F and as varied under 23/00542/F



Native hedging proposed to boundary as approved under conditions application 23/01741/DISC

Red hatch denoting agricultural land proposed for change of use to residential Area = 29.6m²

1.5m stone garden wall proposed to boundary as approved under application 23/00542/F. Wall detailing subject to condition, to be discharged

5 bar timber gate as noted on approved landscaping drawing LAS 644 01

Key

-  Existing residential land as defined under 20/00954/F and as varied under 23/00542/F
-  Land proposed to be incorporated within residential land as part of Change of Use application
-  Extents of former building on site



Revision	Details	First Issue	18.12.23
/			Date

TE Architecture
Architecture & Design

The Studio @
Appletree Cottage
Sibford Gower
Oxfordshire
OX15 5RS

Email: info@tearchitecture.co.uk Tel: 01295 236200 / 07500 465555

Project:
Top Barn Farm, Sibford Gower

Drawing Title:
Proposed Block Plan

Drawing Scale: 1:200	Paper Size: A3
Job No: 23_061_	Drawing No: 102
Revision: /	