

DO NOT SCALE

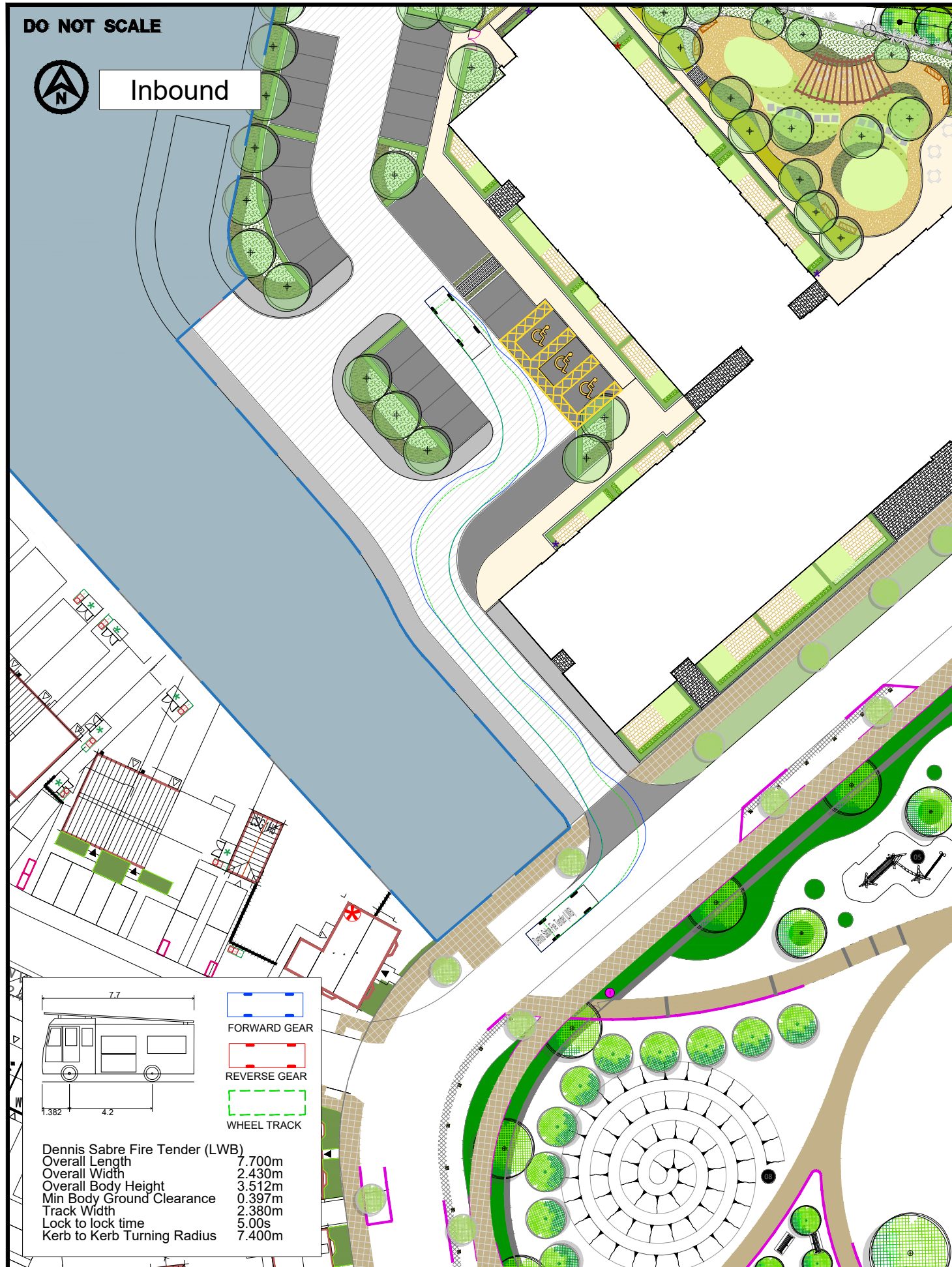

Inbound



Outbound

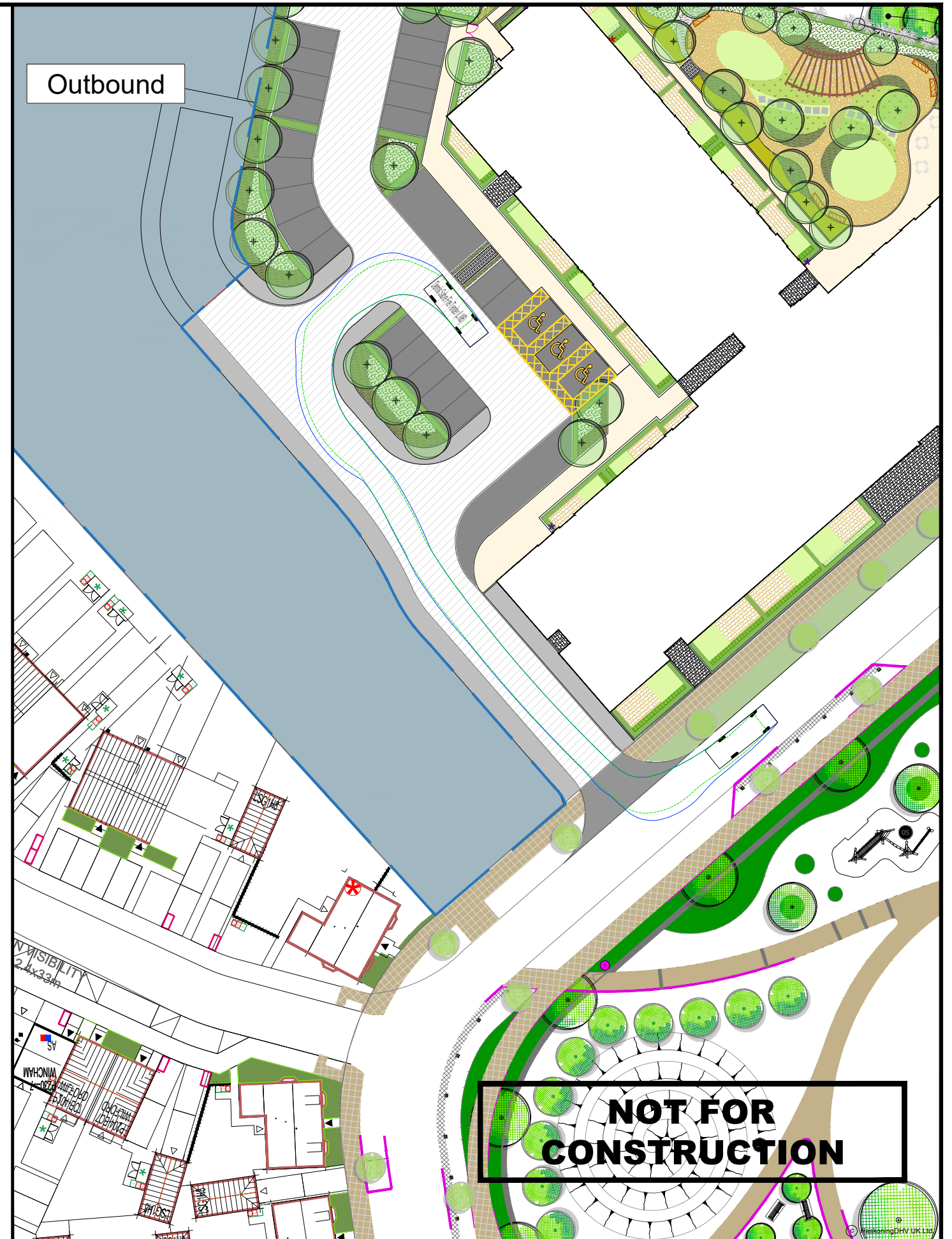

Dennis Sabre Fire Tender (LWB)  
 Overall Length 7.700m  
 Overall Width 2.430m  
 Overall Body Height 3.512m  
 Min Body Ground Clearance 0.397m  
 Track Width 2.380m  
 Lock to lock time 5.00s  
 Kerb to Kerb Turning Radius 7.400m

FORWARD GEAR  
 REVERSE GEAR  
 WHEEL TRACK

**NOT FOR CONSTRUCTION**

TITLE  
**VEHICLE SWEEP PATH ANALYSIS -  
FIRE TENDER**

PROJECT  
**KINGSMERE, BICESTER**

Royal HaskoningDHV  
 Enhancing Society Together

JOB No. PC5143  
 DATE 26.10.2023  
 SCALE 1:500 AT A3

DRAWN SW  
 REV P04  
 SUIT S3

CHECKED AW  
 PASSED AW  
 AUTOCAD REF PC5143-0052  
 DRG No PC5143-RHD-GE-SW-DR-R-0052