

DO NOT SCALE

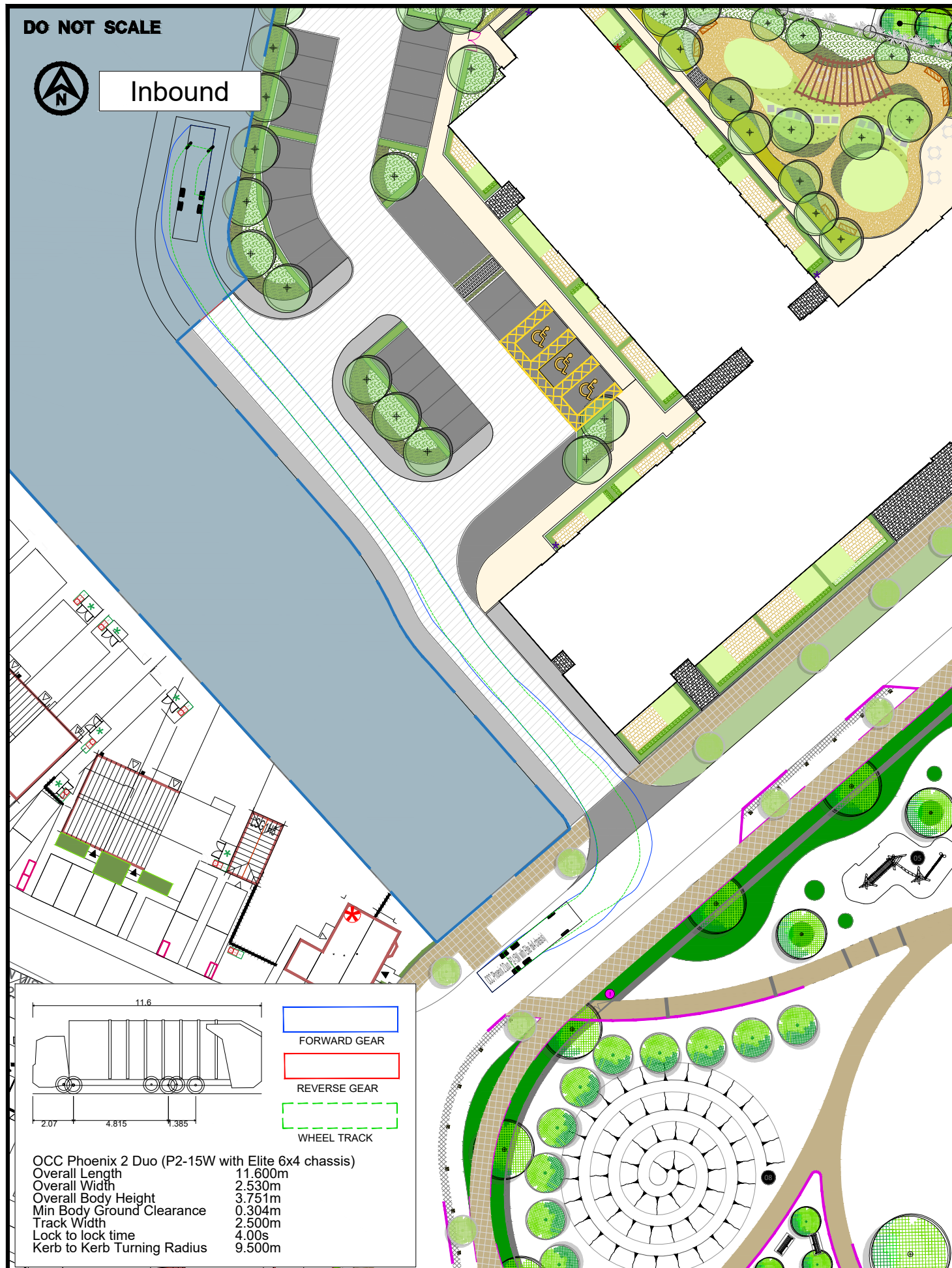

Inbound



Outbound

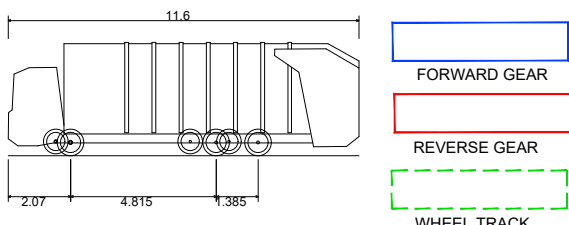
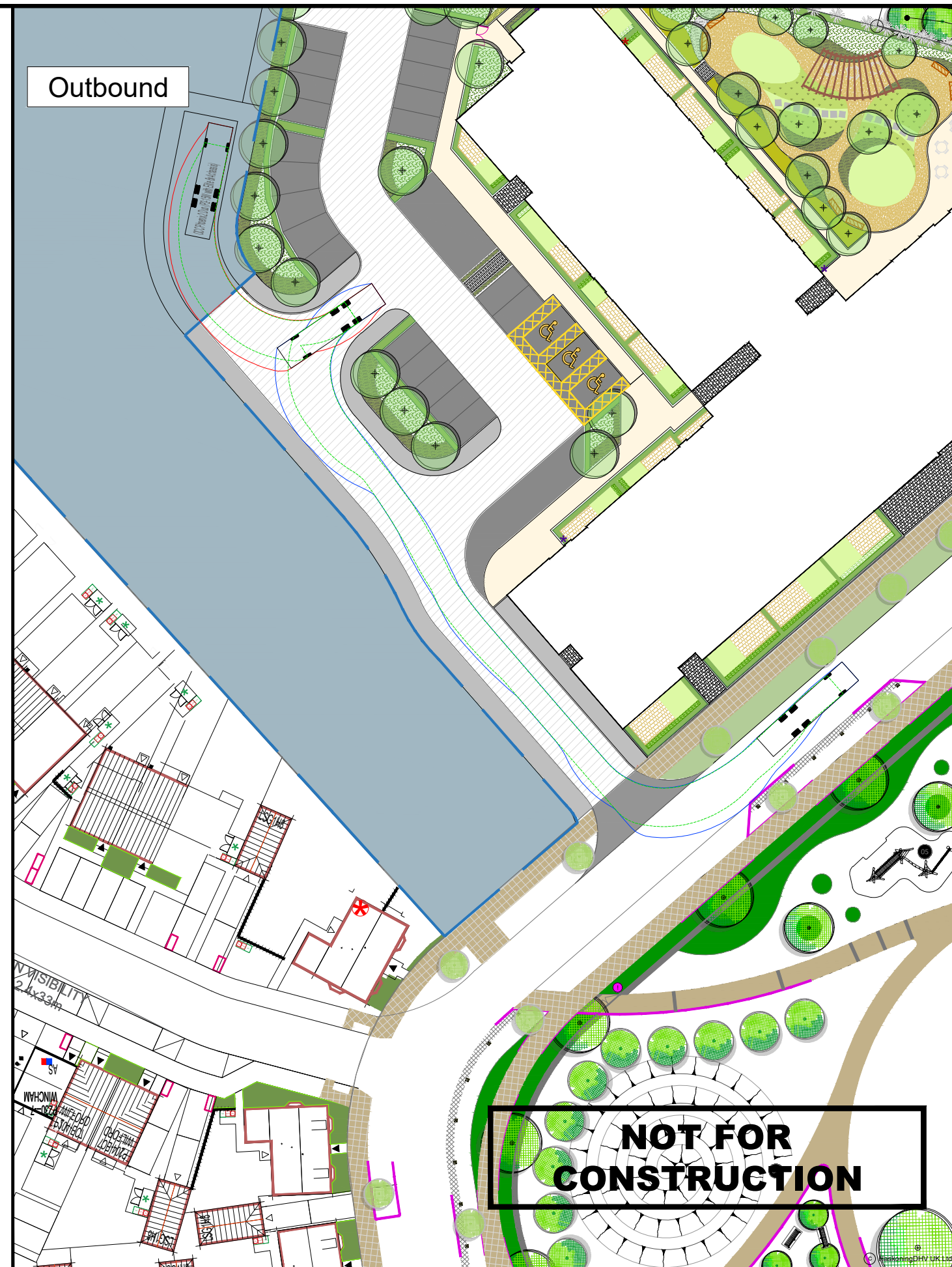

OCC Phoenix 2 Duo (P2-15W with Elite 6x4 chassis)  
 Overall Length 11.600m  
 Overall Width 2.530m  
 Overall Body Height 3.751m  
 Min Body Ground Clearance 0.304m  
 Track Width 2.500m  
 Lock to lock time 4.00s  
 Kerb to Kerb Turning Radius 9.500m

**NOT FOR CONSTRUCTION**

TITLE  
**VEHICLE SWEEP PATH ANALYSIS -  
 11.6M REFUSE VEHICLE**

PROJECT  
**KINGSMERE, BICESTER**

  
 2 Abbey Gardens  
 Great College Street, Westminster  
 London, SW1P 3NL  
 Tel +44(0)207 222 2115  
 www.royalhaskoningdhv.com

JOB No. PC5143  
 DATE 26.10.2023  
 SCALE 1:500 AT A3

DRAWN SW  
 REV P05  
 SUIT S3

CHECKED AW  
 PASSED AW  
 AUTOCAD REF PC5143-0051  
 DRG No PC5143-RHD-GE-SW-DR-R-0051