

DO NOT SCALE

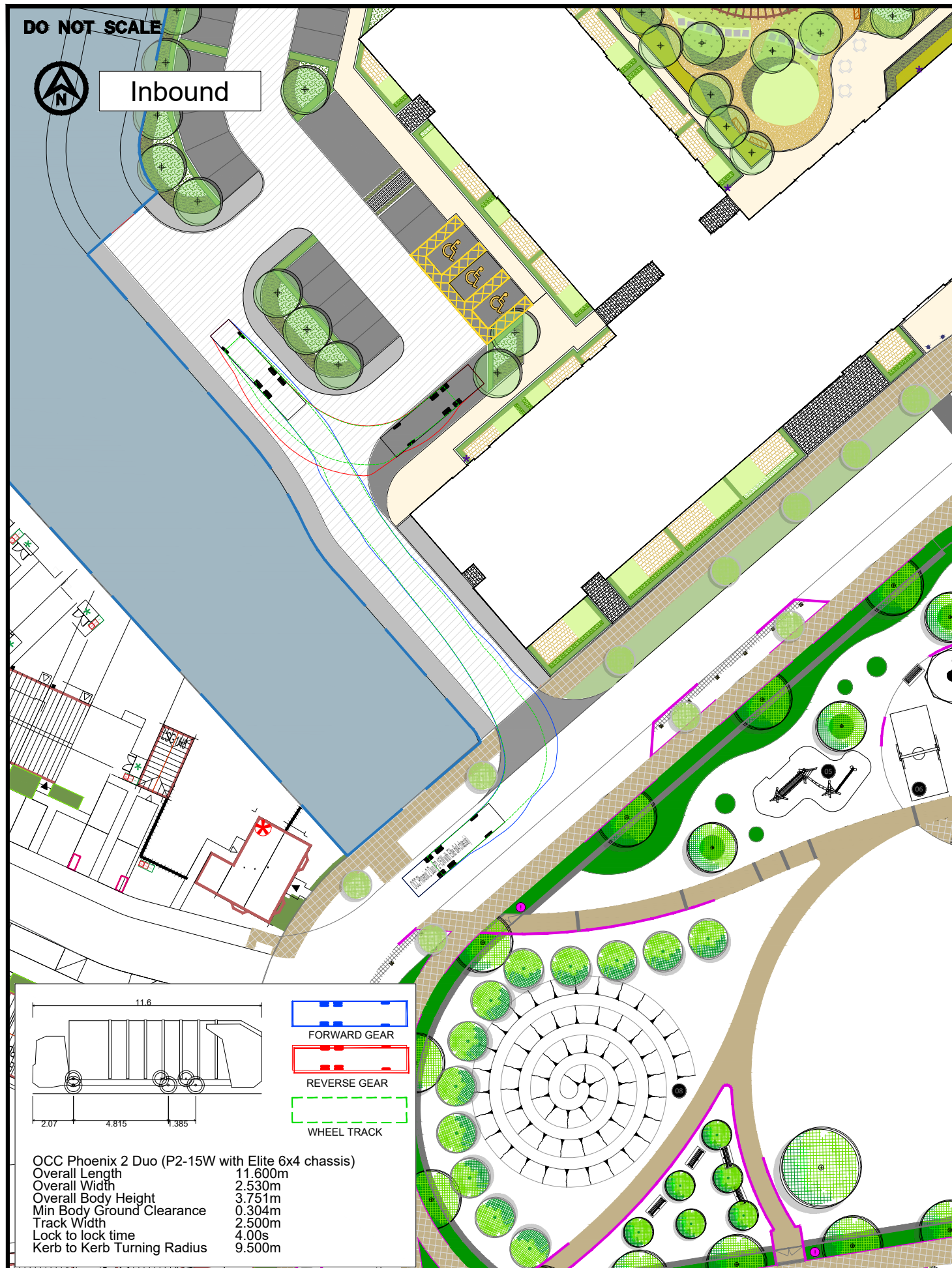

Inbound



Outbound

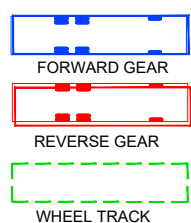
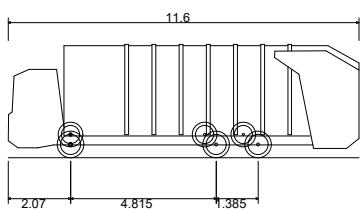

OCC Phoenix 2 Duo (P2-15W with Elite 6x4 chassis)
 Overall Length 11.600m
 Overall Width 2.530m
 Overall Body Height 3.751m
 Min Body Ground Clearance 0.304m
 Track Width 2.500m
 Lock to lock time 4.00s
 Kerb to Kerb Turning Radius 9.500m

NOT FOR CONSTRUCTION

TITLE
**VEHICLE SWEEP PATH ANALYSIS -
 11.6M REFUSE VEHICLE**

PROJECT
KINGSMERE, BICESTER



JOB No. PC5143
 DATE 26.10.2023
 SCALE 1:500 AT A3

DRAWN SW
 REV P05
 SUIT S3

CHECKED AW
 PASSED AW
 AUTOCAD REF PC5143-0050
 DRG No PC5143-RHD-GE-SW-DR-R-0050