

FIRST FLOOR

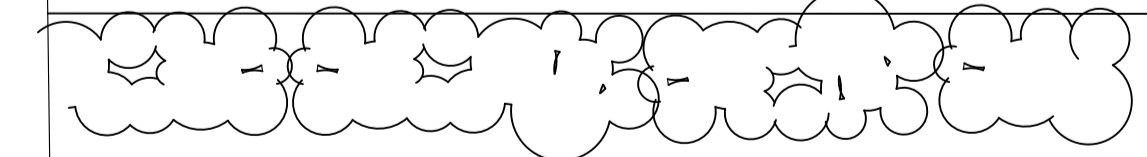

GROUND FLOOR

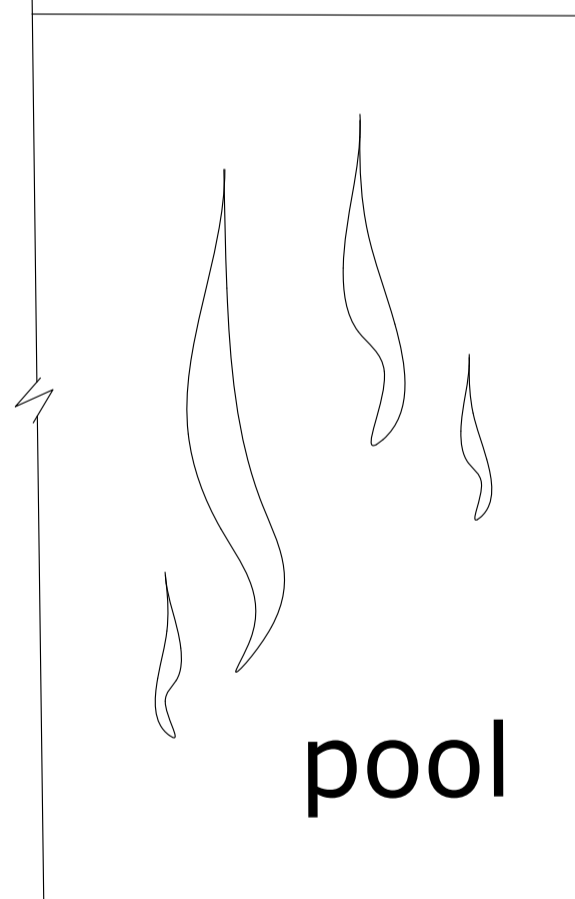
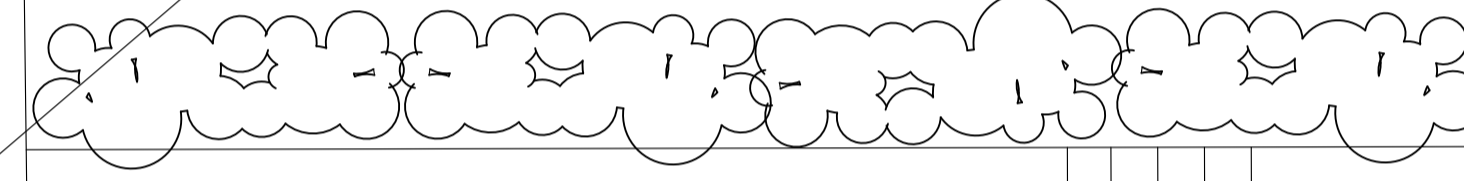
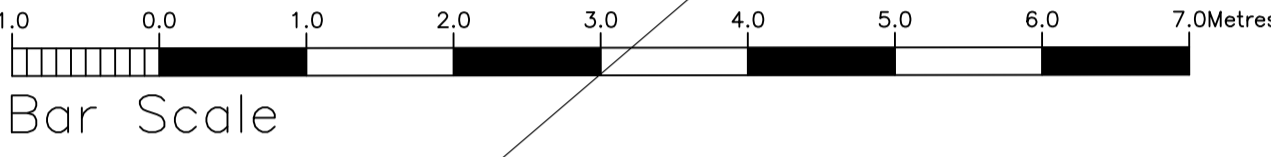
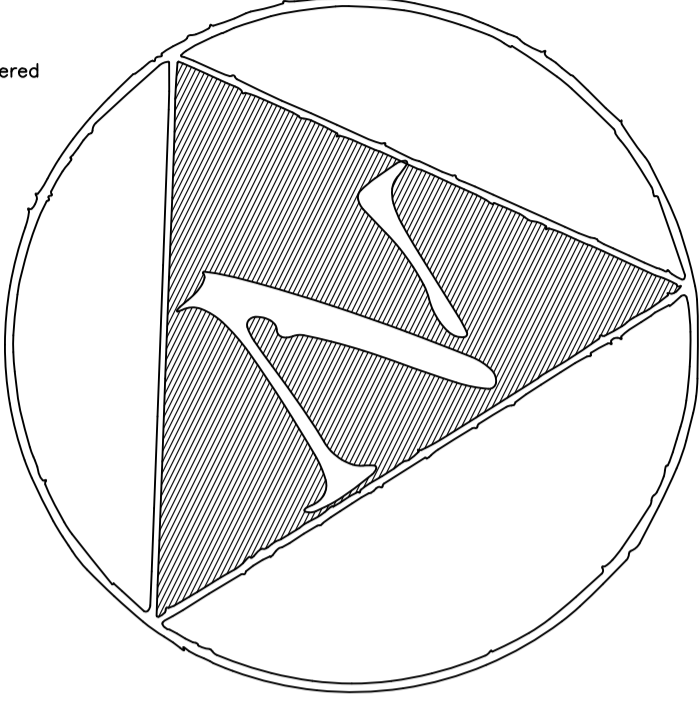
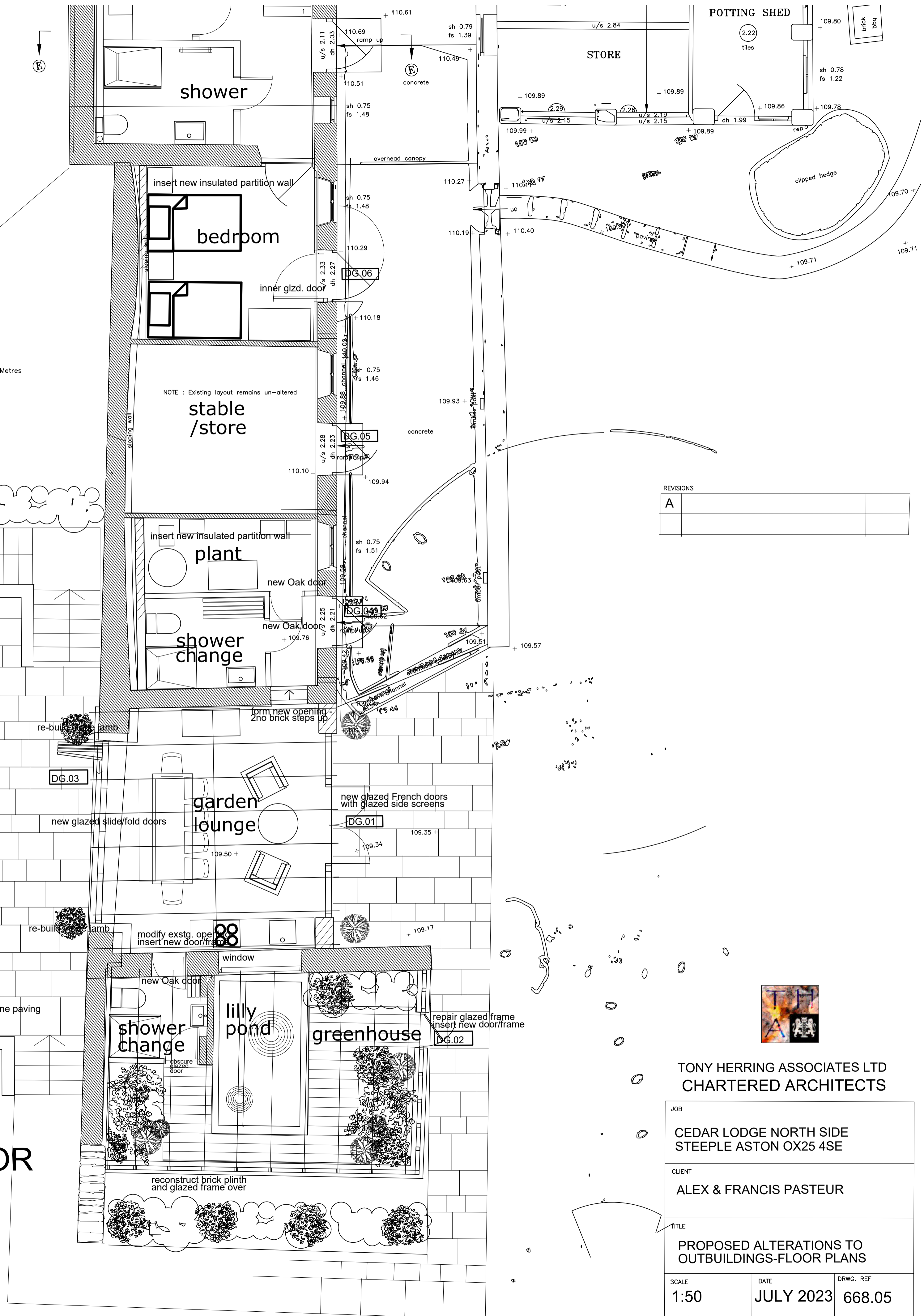

REVISIONS

A		
---	--	--

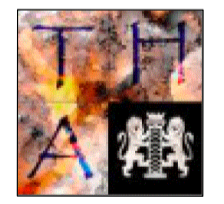

TONY HERRING ASSOCIATES LTD
CHARTERED ARCHITECTS

JOB
CEDAR LODGE NORTH SIDE
STEEPLE ASTON OX25 4SE

CLIENT
ALEX & FRANCIS PASTEUR

TITLE
PROPOSED ALTERATIONS TO
OUTBUILDINGS-FLOOR PLANS

SCALE 1:50	DATE JULY 2023	DRWG. REF 668.05
---------------	-------------------	---------------------

exstg slate roof repaired

new zinc roof over
reconstructed store