

REVISIONS	
A	

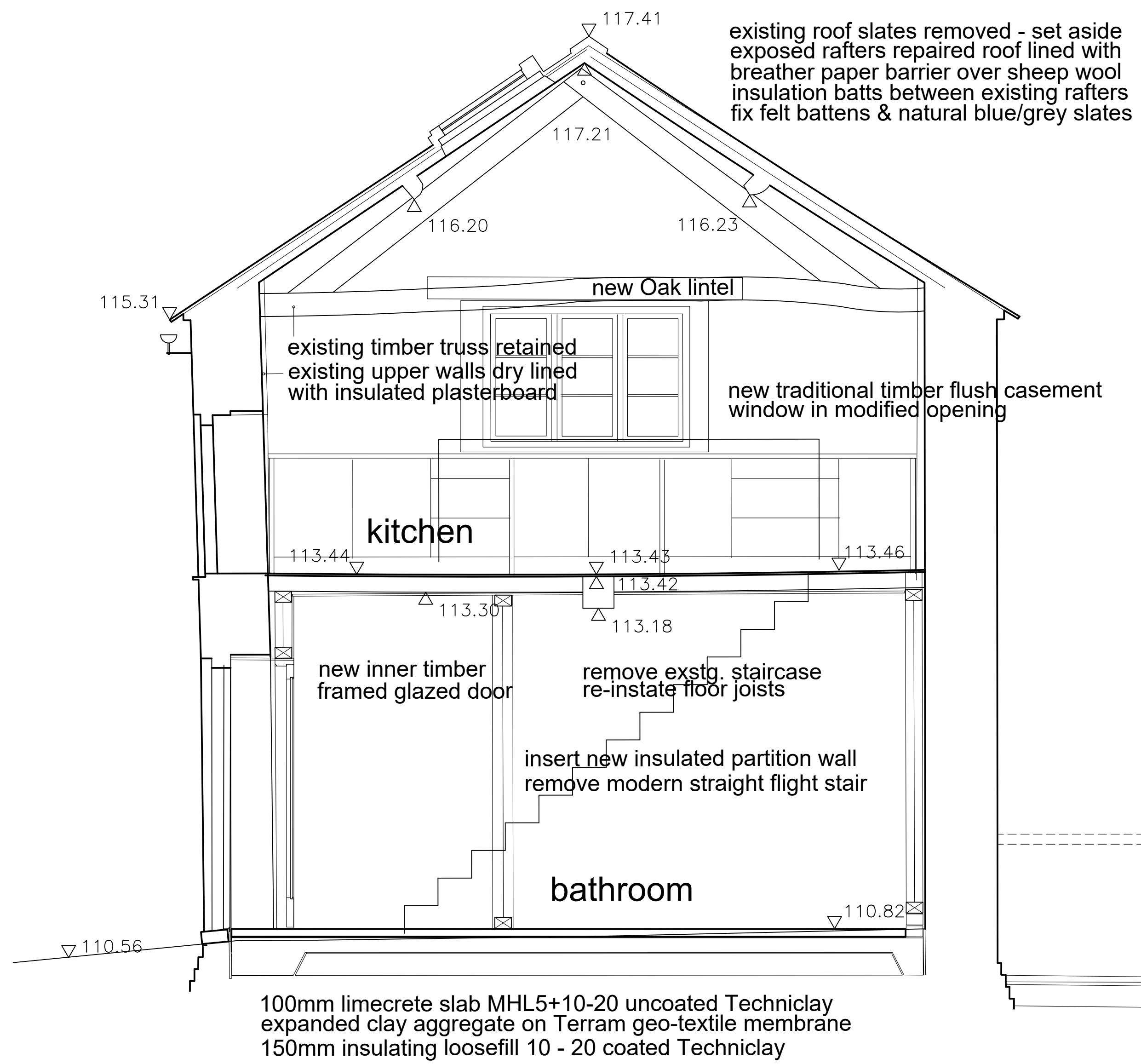

SECTION E : PROPOSED

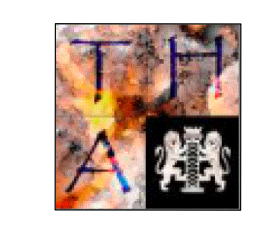
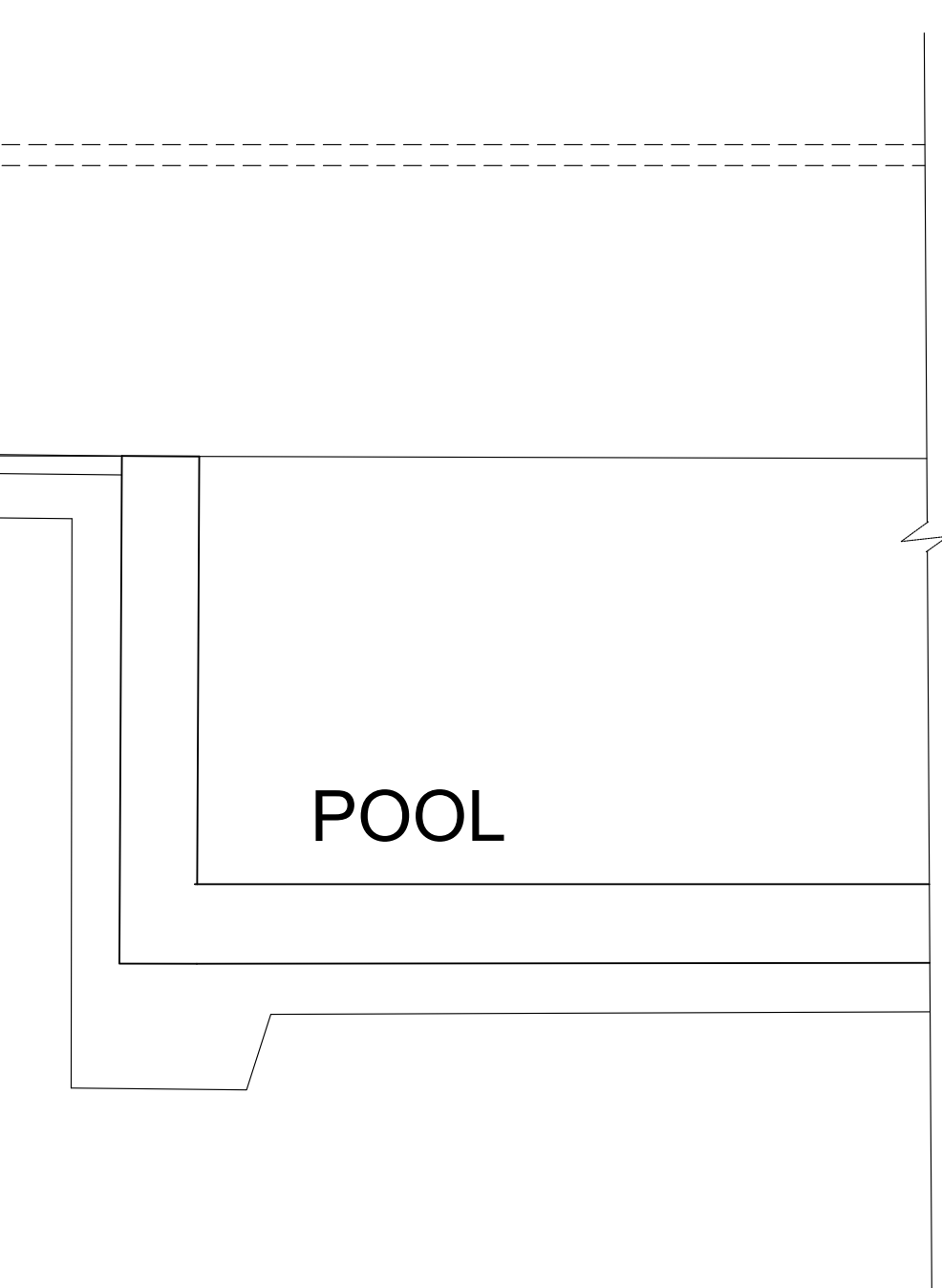
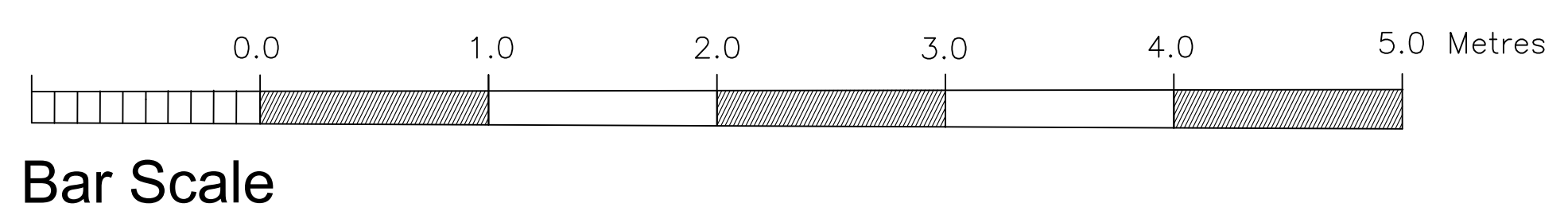

TONY HERRING ASSOCIATES LTD  
CHARTERED ARCHITECTS

JOB		
CEDAR LODGE NORTH SIDE STEEPLE ASTON OX25 4SE		
CLIENT		
ALEX & FRANCIS PASTEUR		
TITLE		
PROPOSED ALTERATIONS TO OUTBUILDINGS- SECTION E		
SCALE	DATE	DRWG. REF
1:25	SEPT 2023	668.07