

NB Based on plans prepared in 2019 by On-Centre Surveys Ltd.

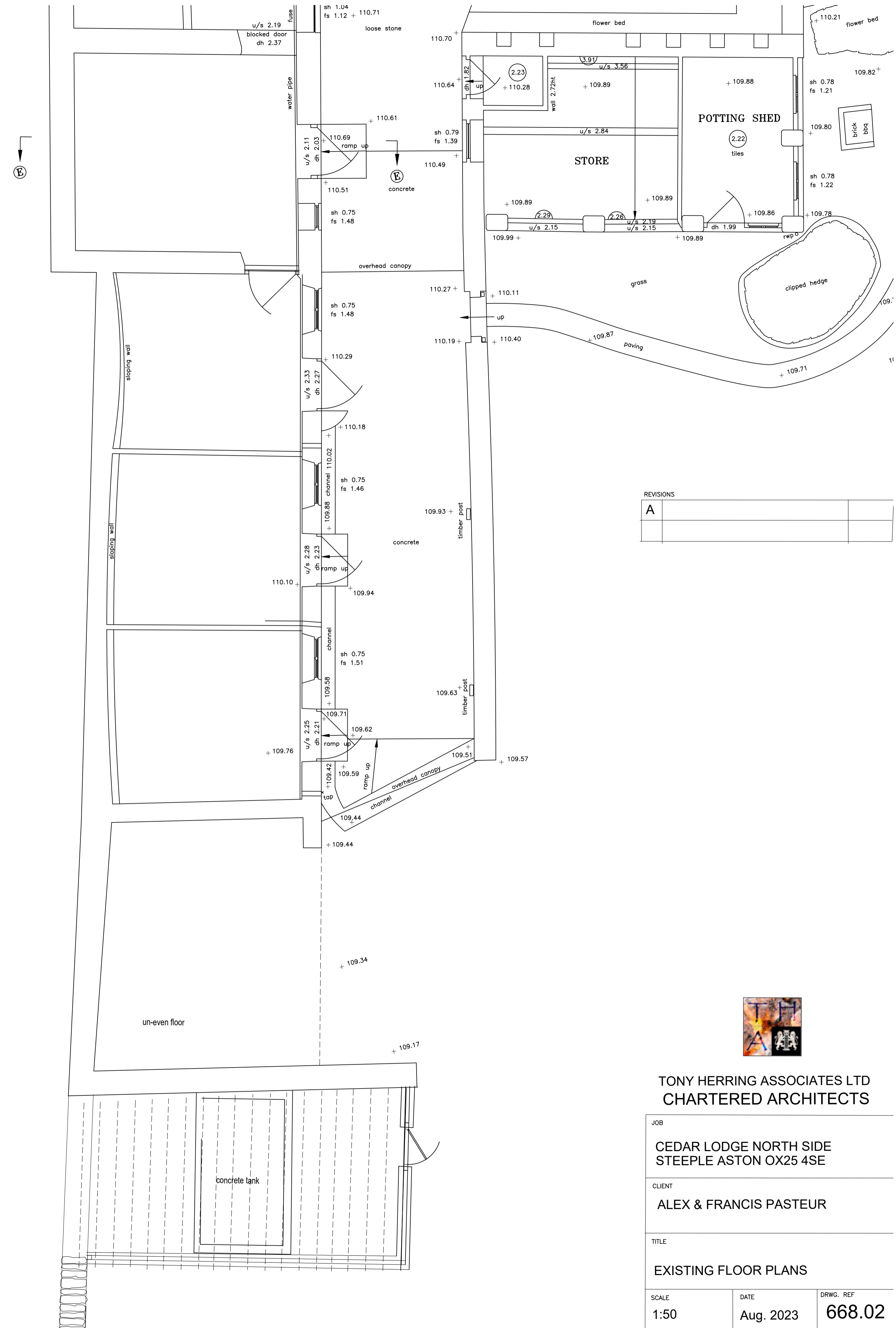

REVISIONS	
A	

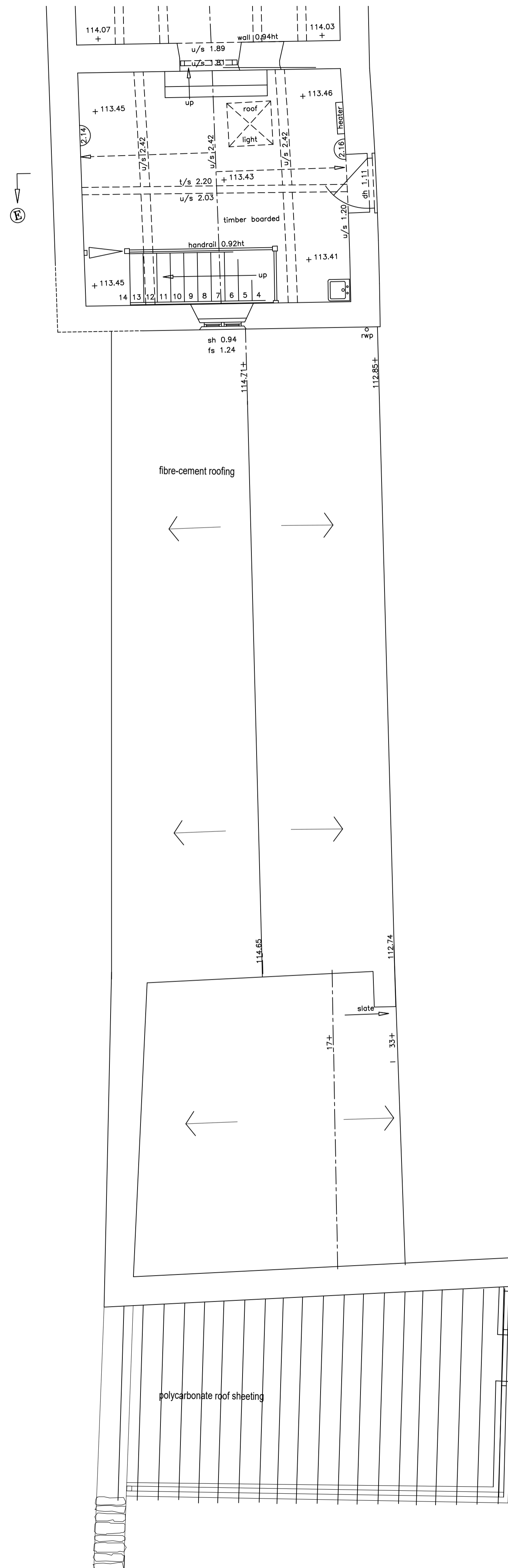

TONY HERRING ASSOCIATES LTD
CHARTERED ARCHITECTS

JOB		
CEDAR LODGE NORTH SIDE STEEPLE ASTON OX25 4SE		
CLIENT		
ALEX & FRANCIS PASTEUR		
TITLE		
EXISTING FLOOR PLANS		
SCALE	DATE	DRWG. REF
1:50	Aug. 2023	668.02