

Hatched areas represents a total of approx 60m<sup>2</sup> of required pv panels on roof

Rooflights total 10% of floor area

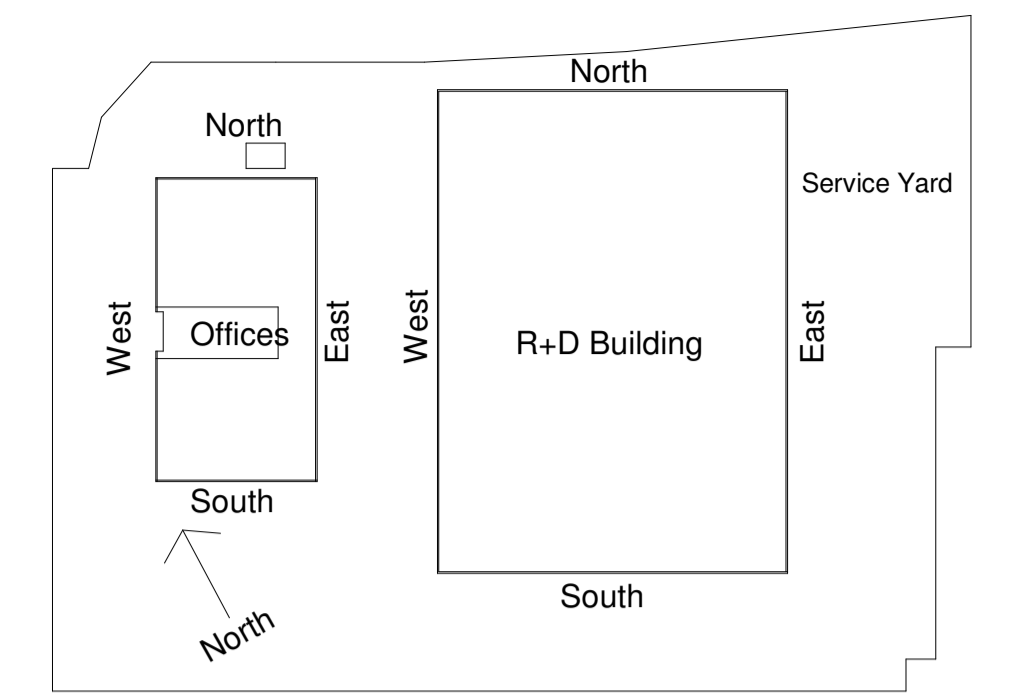

PROJECT Bicester Arc - YASA - R&D
TITLE ROOF PLAN

CLIENT Peveril Securities			
Drawn by SM	Checked by DW	Approved by SJ	DATE 15.01.2024
SCALE (@ A1) 1 : 200		PROJECT NUMBER 16SK109	
DRAWING NUMBER B103			REV C