

- Contractors must check all dimensions on site. Only figured dimensions are to be worked from. Discrepancies must be reported to the Architect or Engineer before proceeding. © This drawing is copyright
- Reproduced from OS Sitemap @ by permission of Ordnance Survey® on behalf of The Controller of Her Majesty's Stationery Office. © Crown copyright 2008. All rights reserved. Licence number 100007126.

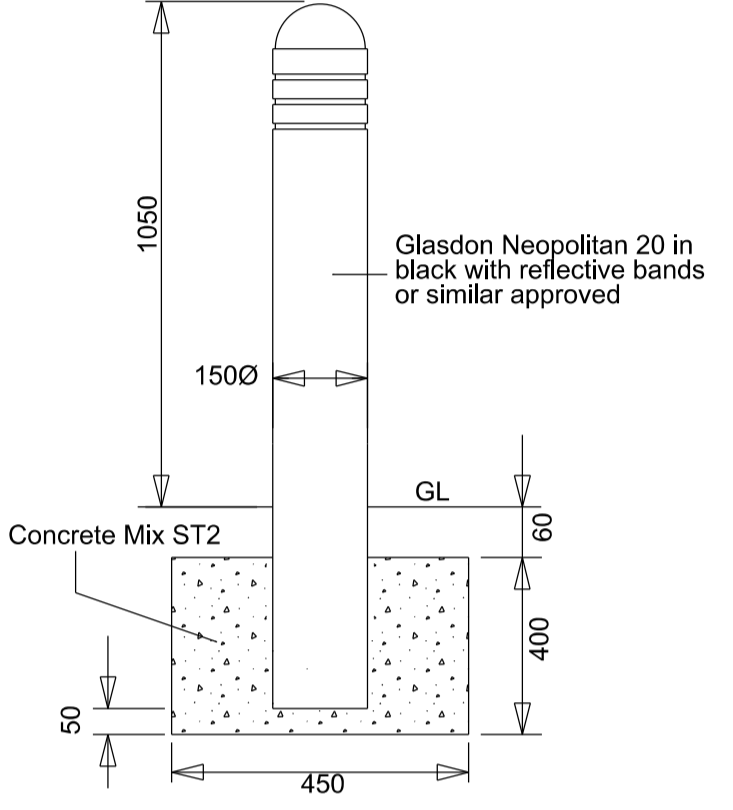
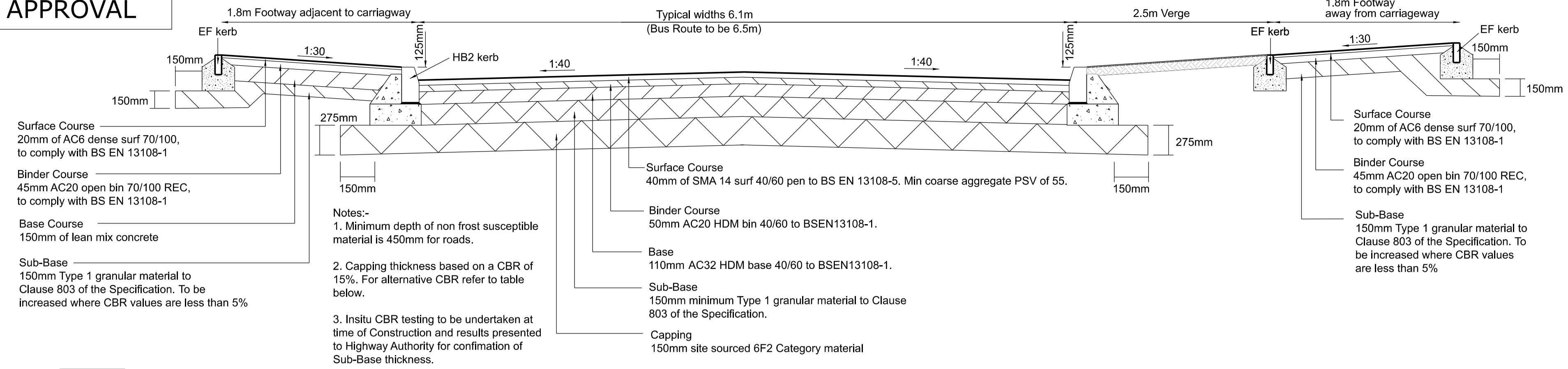

FIXED BOLLARD DETAIL
For use on all buildouts/ road narrowings. For roundabout bollard signage refer to drawing 1018

CBR	Capping thickness
2%	600mm
2.5%	400mm
3%	360mm
4%	300mm
5%	250mm
6%	240mm
7%	220mm
8%	210mm
9%	200mm
10%	190mm
11%	175mm
15% or more	150mm

- Notes:-**
- Minimum depth of non frost susceptible material is 450mm for roads.
 - Capping thickness based on a CBR of 15%. For alternative CBR refer to table below.
 - In situ CBR testing to be undertaken at time of Construction and results presented to Highway Authority for confirmation of Sub-Base thickness.
 - If CBRs of less than 2.5% are encountered, ground stabilisation to be carried out.

BLACKTOP CONSTRUCTION DETAIL

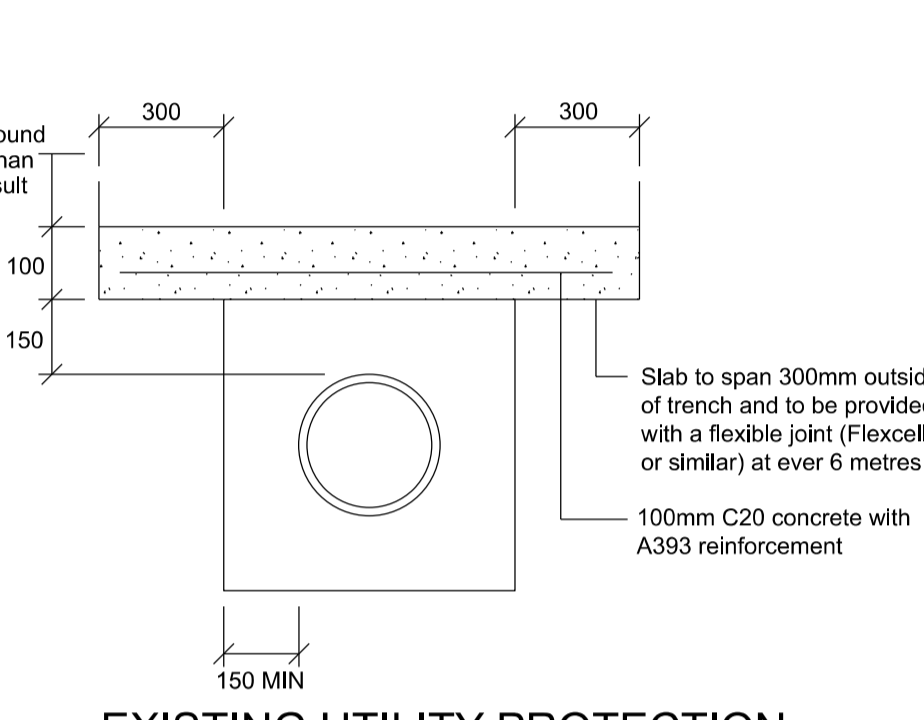

EXISTING UTILITY PROTECTION

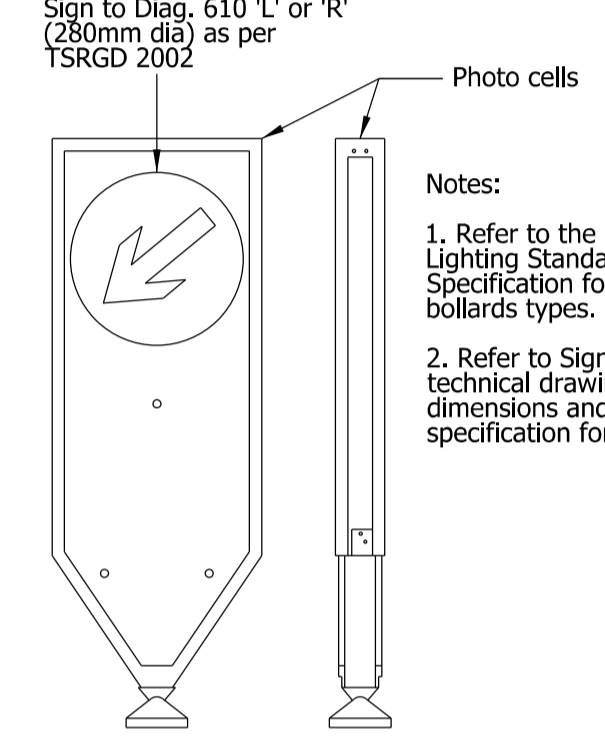

"KEEP LEFT" BOLLARD (RETRO REFLECTIVE SPS35IXTY OR SIMILAR APPROVED)

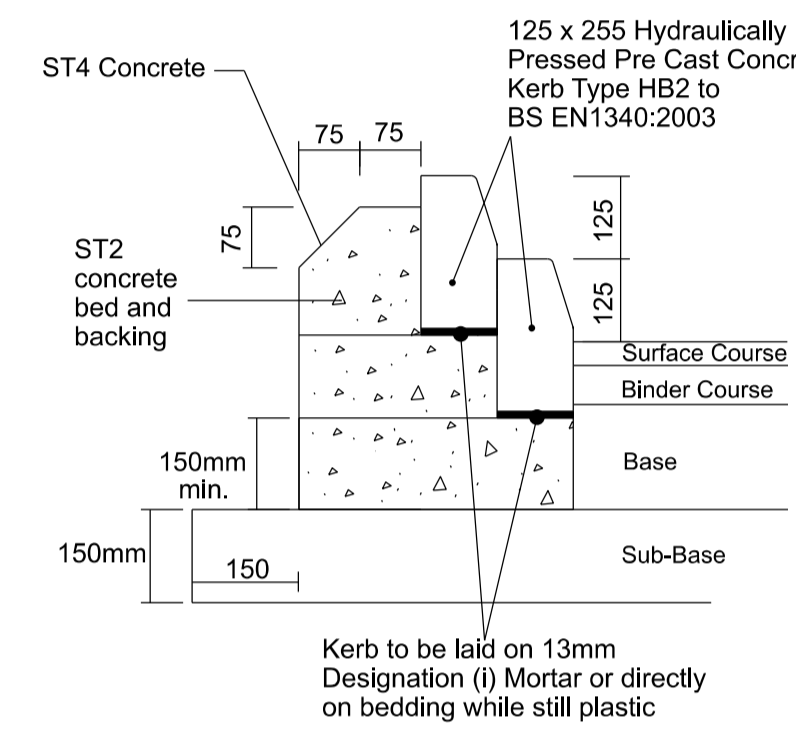

DOUBLE KERB DETAIL

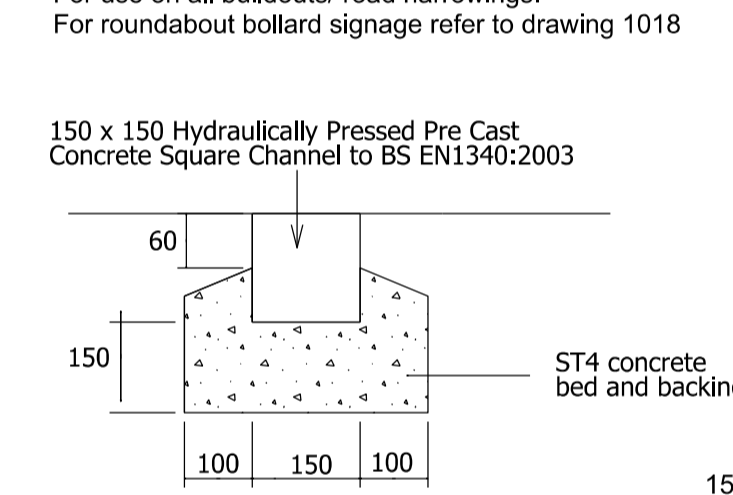

CHANNEL KERB

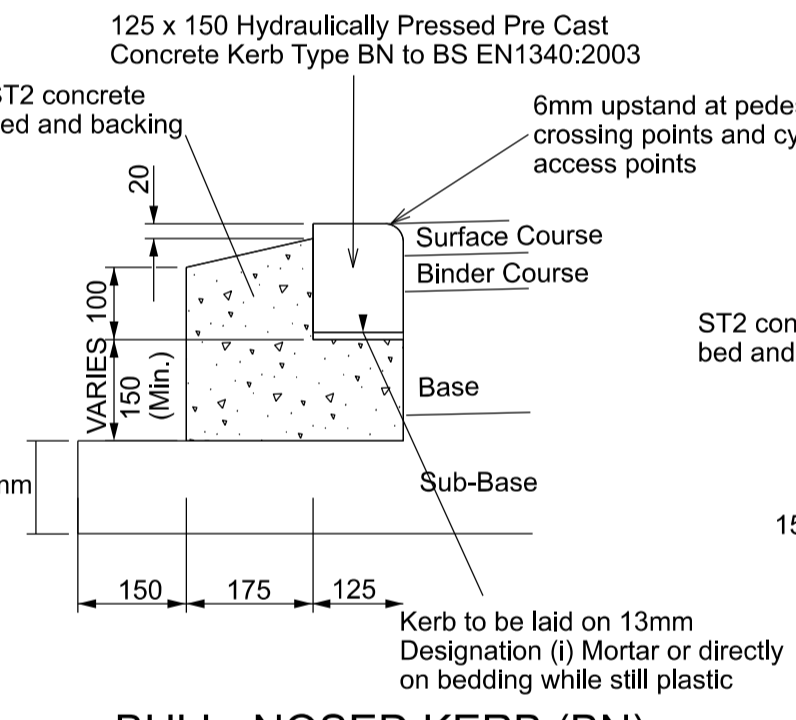

BULL- NOSED KERB (BN)

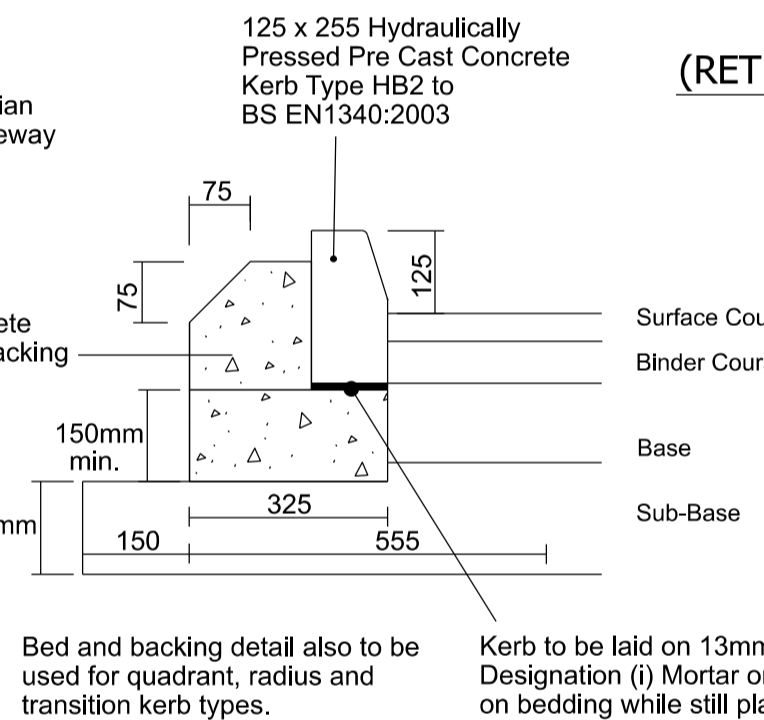

HALF BATTERED KERB (HB2)

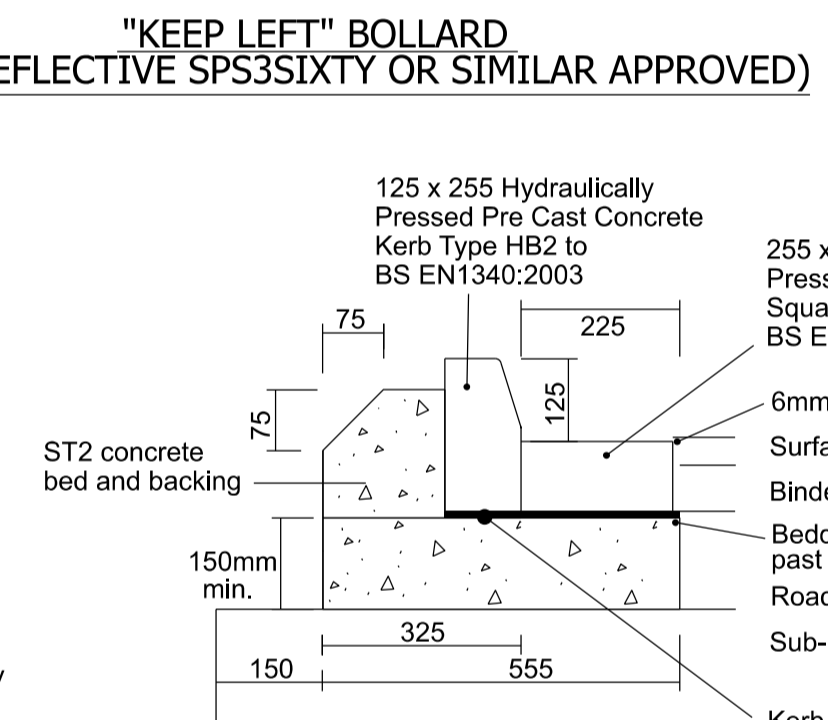

HALF BATTERED KERB (HB2)

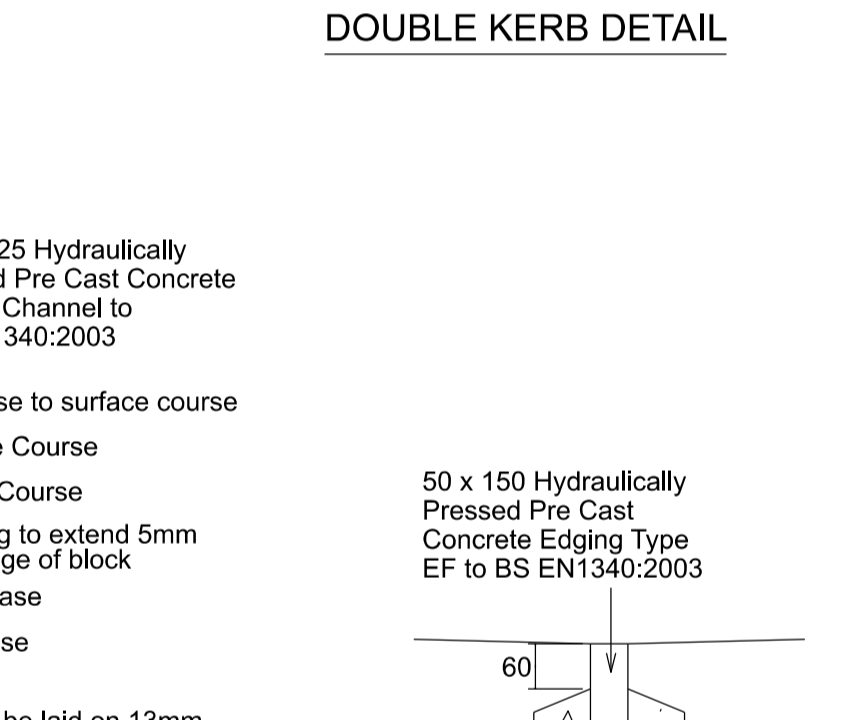

EDGING (EF)

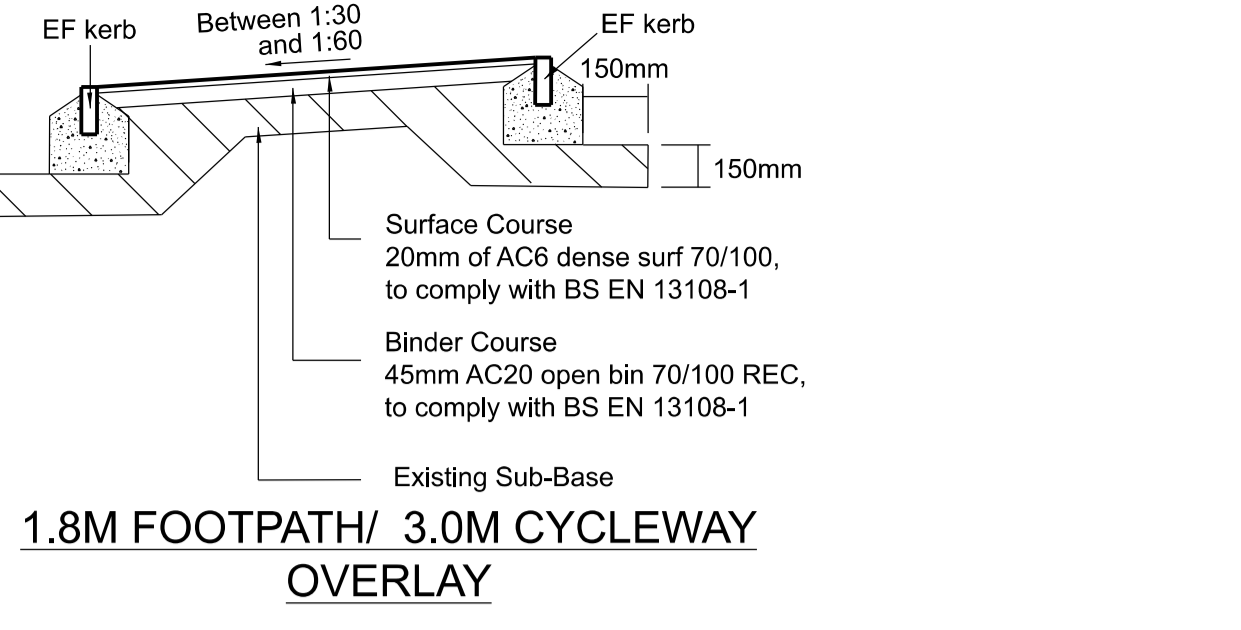

1.8M FOOTPATH/ 3.0M CYCLEWAY OVERLAY

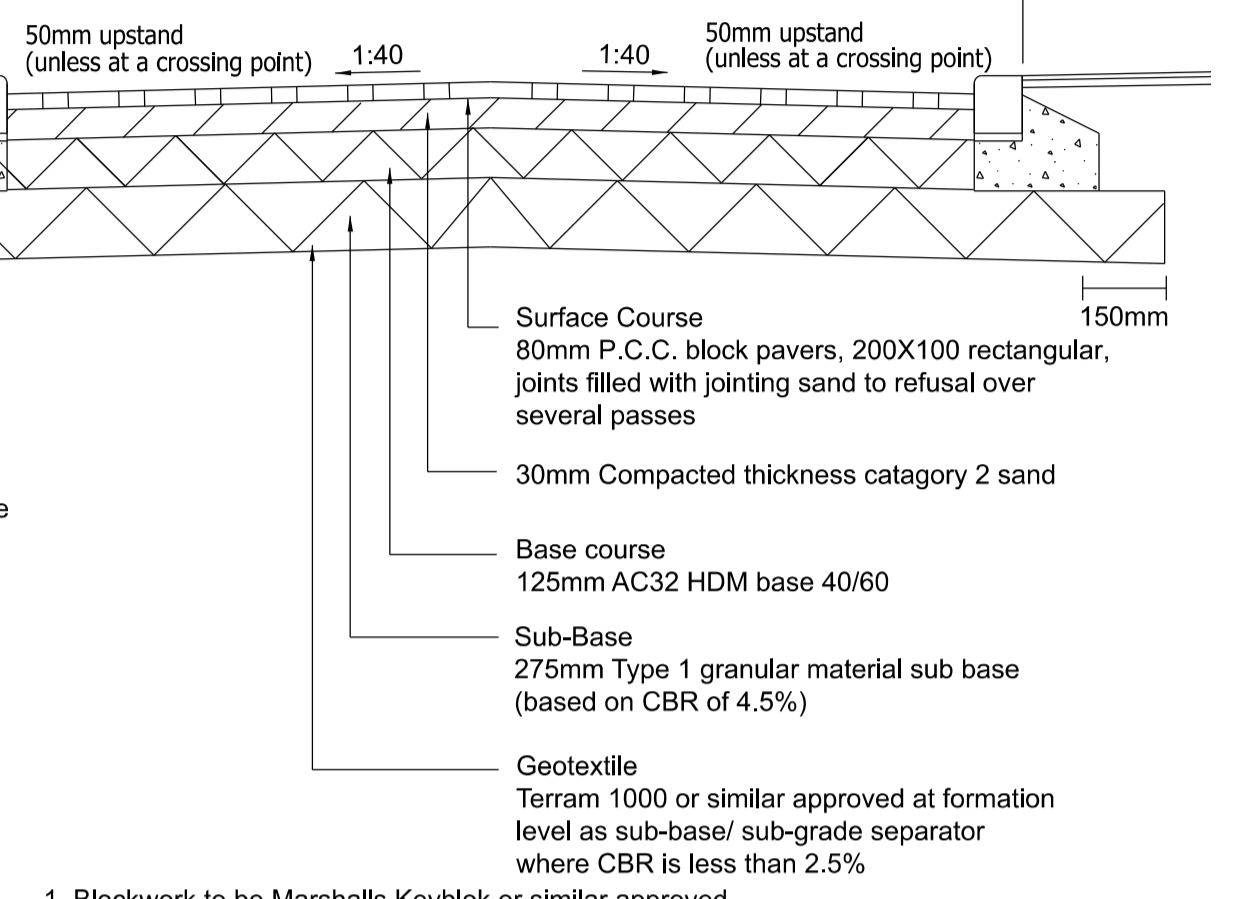

TYPICAL ADOPTABLE BLOCK PAVING RAISED TABLE

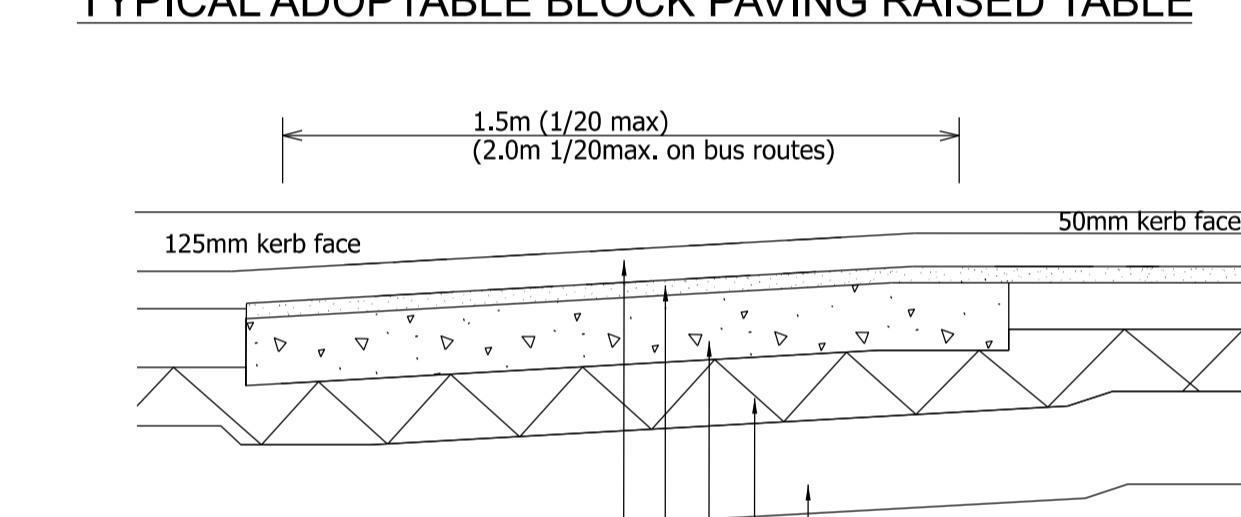

TREE PIT WITHOUT GRILLE

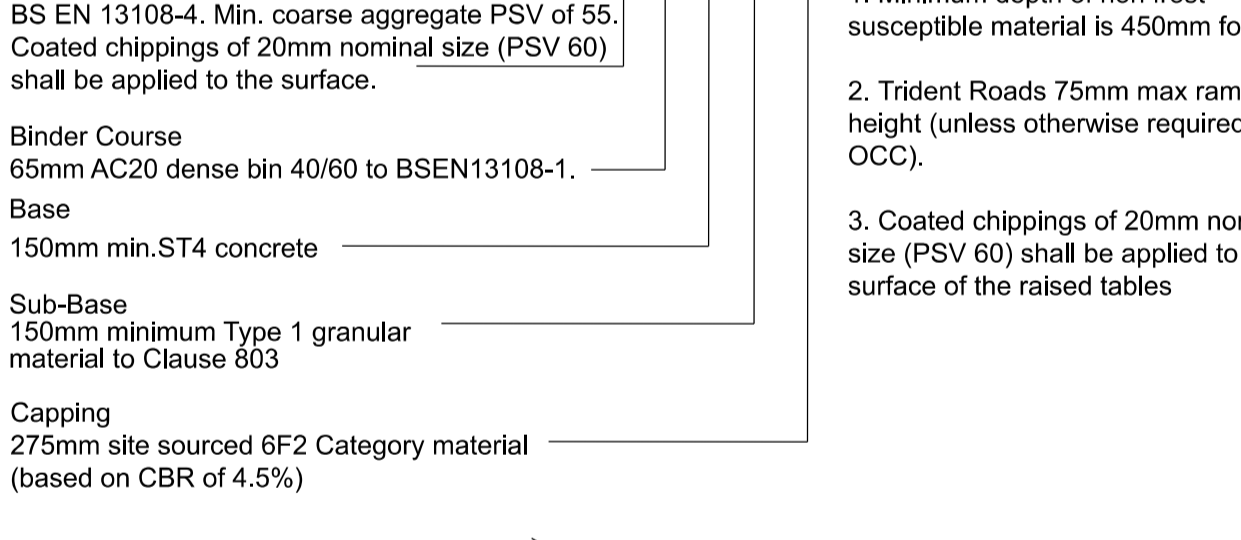

RC05 - HIGHWAY BOUNDARY MARKER DETAIL

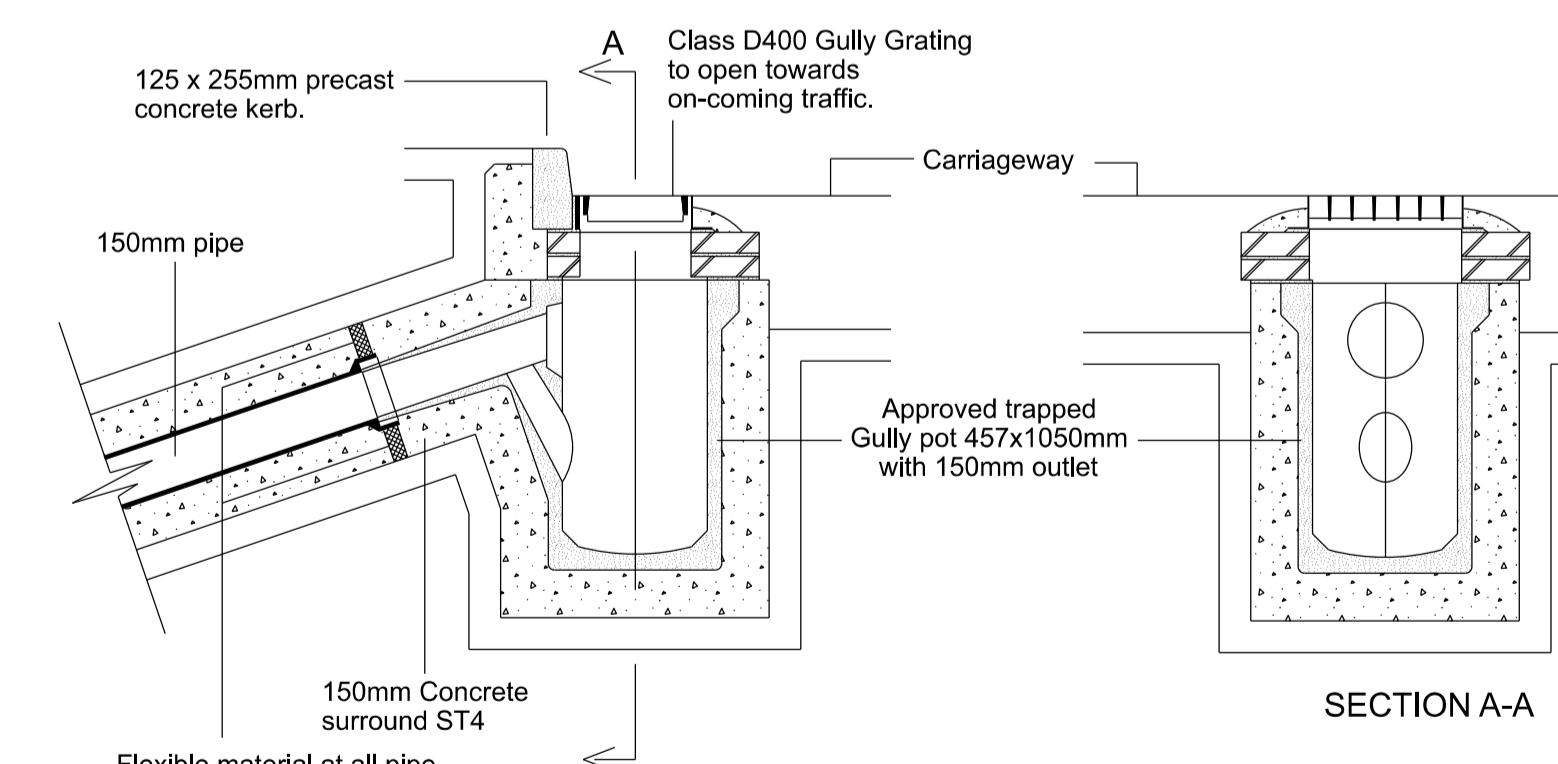

GULLY DETAIL

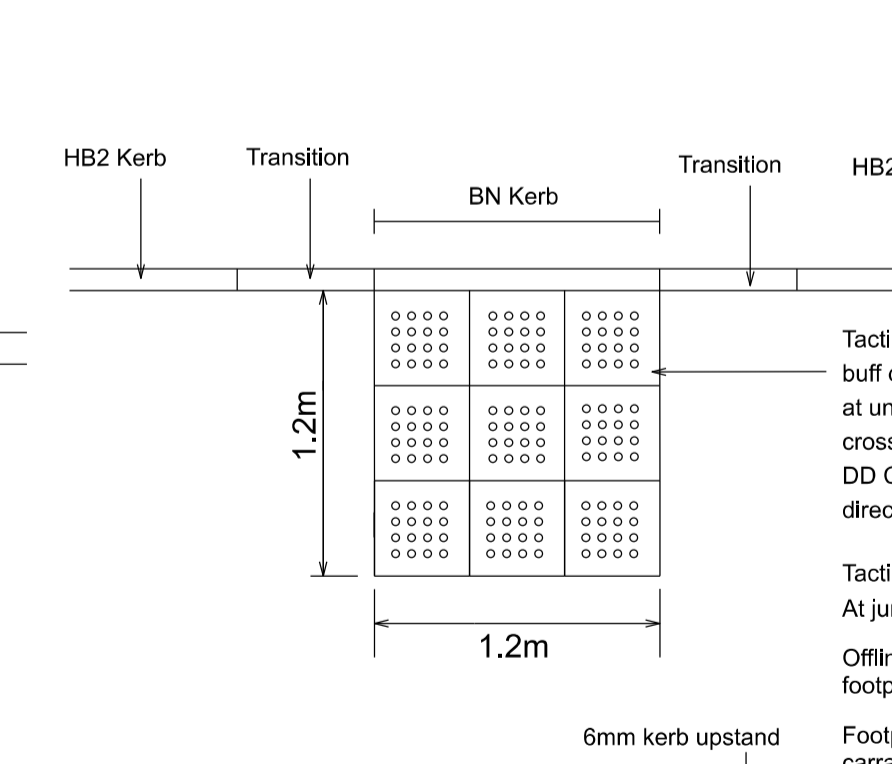

TACTILE CROSSING DETAIL

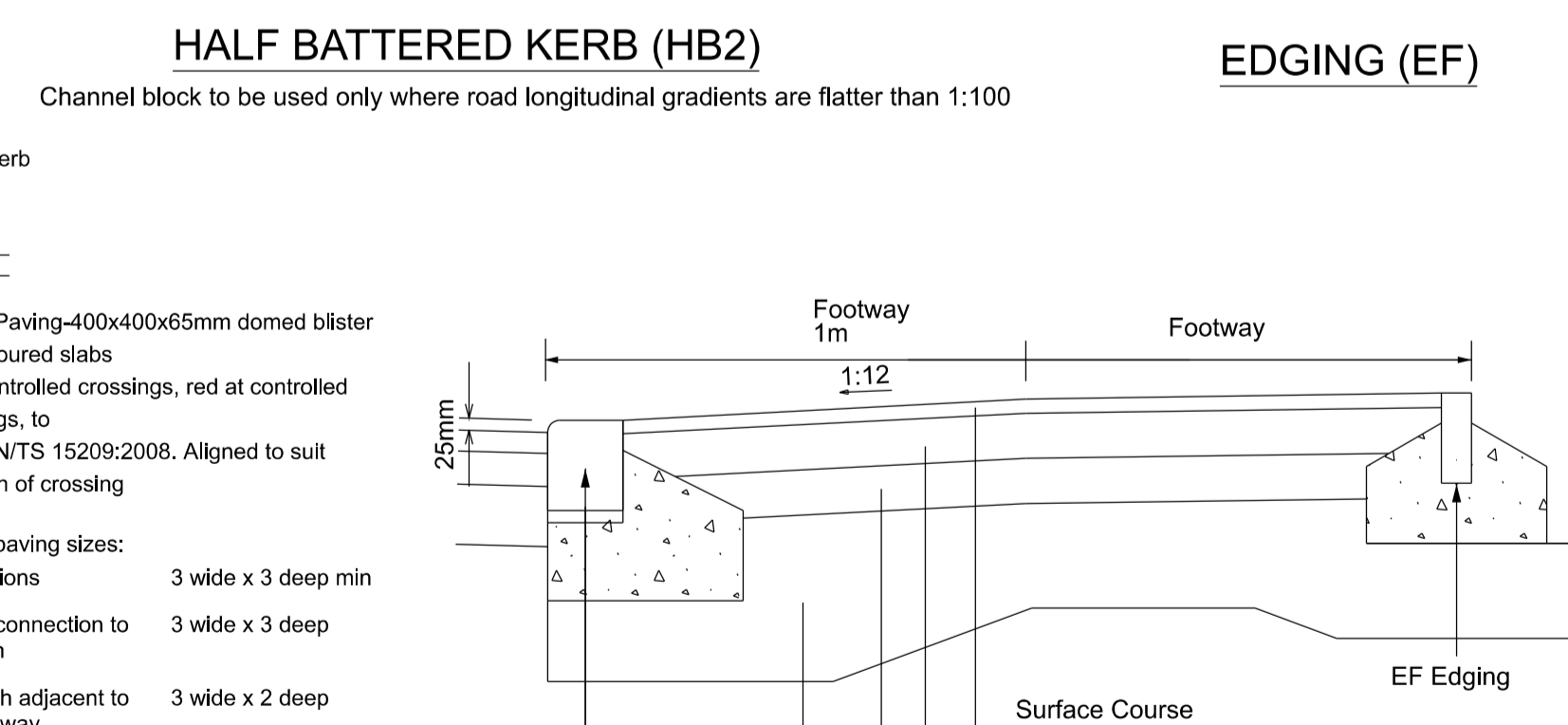

VEHICULAR CROSSING DETAIL

Flexible material at all pipe joints in concrete surround.

All gully pots to BS 5911 Pt 2. All grates and frames to comply with BSEN124 450mm in width. They shall be straight bar pattern. Gully grating and frames in access ways to be 325mm in width.

The gratings and frames shall be bedded using Designation (j) mortar and set on minimum two courses and a maximum of 4 courses of Class B engineering bricks so that the top of the frames is below the finished channel level within the tolerance of -5mm to -10mm where measured adjacent to the kerbing. The gully frames shall be set to the carriageway gradient. Where the carriageway is constructed to the base course level for use as builders road, the gully frames should initially be set to base course level.

Class D400 gully grating and frame to open towards on-coming vehicles and be single piece, hinged, non-rock type to BS EN 124 (size 370 x 450mm) minimum waterway area 1000sqcm with straight bar pattern

Gully pots shall be 450mm internal diameter by 1050mm deep with 150mm diameter trapped outlet and rodding eye with C.1 stopper and chain. They shall be of an approved manufacture in precast concrete to BS 5911, salt glazed ware or Clayware to BS 65 and shall be laid with 150mm thickness of ST4 concrete. Connections to the sewer shall be by 150mm diameter clay or concrete pipes bedded on 150mm concrete and surrounded with ST4 concrete to a thickness of 150mm when the cover to the pipes is less than 1.2m.

Gullies should preferably connect directly into manholes, but, if this is not appropriate, they shall be connected to the main pipe by means of 45 degree oblique angled junctions, and surrounded by ST4 concrete to a thickness of 150mm. Gully connections shall not be longer than 20m.

Tactile paving shall be in accordance with "Guidance on the use of Tactile Paving Surfaces" (1998) Issued by DETR.

Notes:-

- Blockwork to be Marshalls Keyblok or similar approved.
- Minimum depth of non frost susceptible material is 450mm.
- Blockwork pattern to be herringbone orientated to suit white dipped block junction arrangement. Bond breakers will be required at changes in direction.
- Shared surface blockwork colour to be Burnt Ochre as shown on the planning layout.

Notes:-

- Minimum depth of non frost susceptible material is 450mm for roads.
- Trident Roads 75mm max ramp height (unless otherwise required by OCC).
- Coated chippings of 20mm nominal size (PSV 60) shall be applied to the surface.

Within grassed areas the limit of adoptable highway is to be indicated on site by means of concrete highway boundary markers positioned at intervals of 1 every 5m.

The markers are to be concreted in position in grade ST4 concrete so that the top is flush with the verge in accordance with manufacturers recommendations.

Where the highway limits are not readily identifiable in ungrassed areas i.e. where the highway boundary meets with a private drive and there is no change in surface material, a marker should be placed in a central position on the highway boundary.

Revision	Description	Drawn	Checked	Date
1	Preliminary			
2	Information			
3	Tender			
4	Construction			
5	As Built			

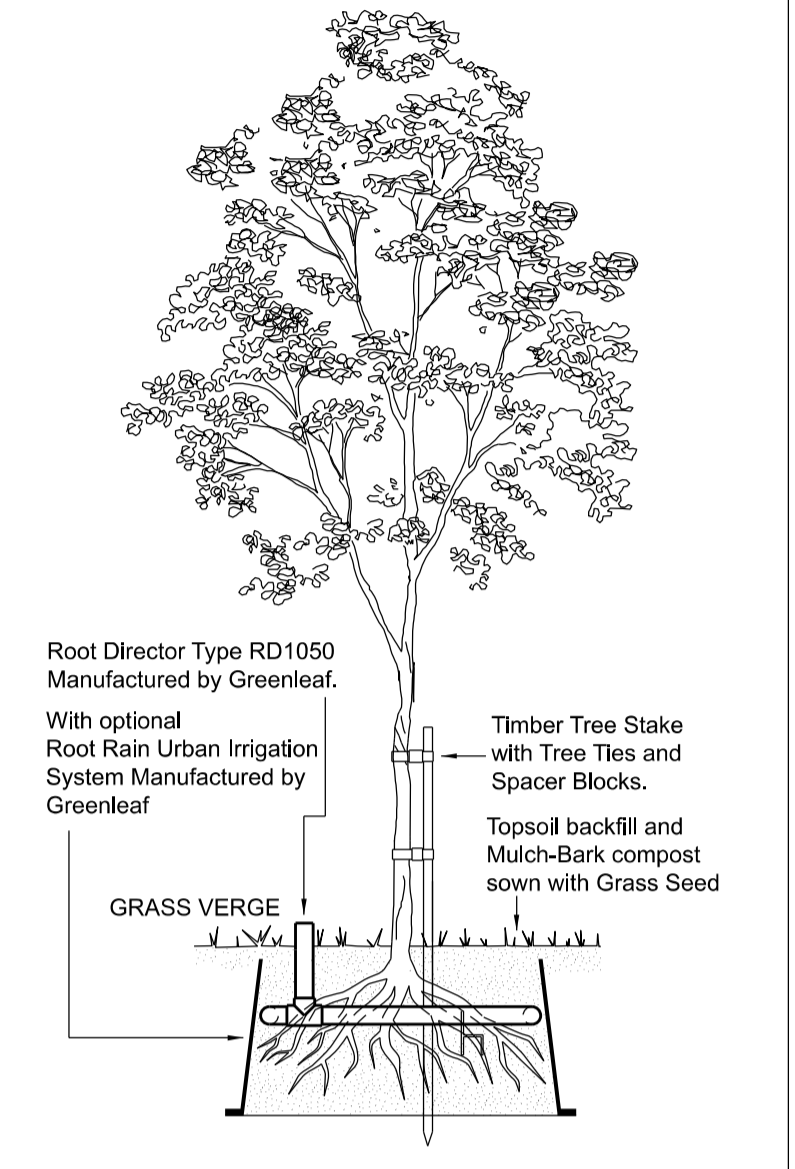

TREE PIT WITH GRILLE

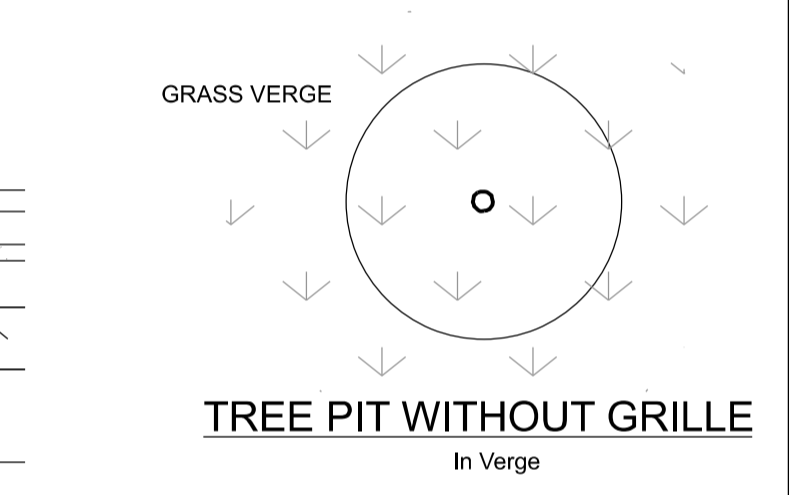

TREE PIT WITHOUT GRILLE

Notes:-

- Minimum depth of non frost susceptible material is 450mm for roads.
- Trident Roads 75mm max ramp height (unless otherwise required by OCC).
- Coated chippings of 20mm nominal size (PSV 60) shall be applied to the surface of the raised tables.

Notes:-

- Minimum depth of non frost susceptible material is 450mm for roads.
- Trident Roads 75mm max ramp height (unless otherwise required by OCC).
- Coated chippings of 20mm nominal size (PSV 60) shall be applied to the surface of the raised tables.

Woods Hardwick
Architects, Engineers and Development Consultants

15-17 Goldington Road Bedford MK40 3JH United Kingdom
T. +44 (0)1234 268862 F. +44 (0)1234 353034 mail@woodshardwick.com www.woodshardwick.com