

DATE: 13 October 2022
DESIGNER: DFL
PROJECT No: 2543
PROJECT NAME: Fewcott Road, Frittwell



Location: Fewcott Road, Frittwell
Environmental Zone: E2

Bollard locations do not conform to a given lighting class and are intended for wayfinding purposes only.

Maintenance Factor is 0.64, derived from the tables in BS5489-1:2020 and manufacturers data.

2543-DFL-HLG-XX-CA-EO-13001-S3-P02

PREPARED BY: Connor MacDonald
Lighting Designer
+44 (0)1962 855080
17-18 City Business Centre,
Winchester Hants,
SO23 7TA.
e-mail: connor.macdonald@dfi-uk.com
website: www.dfi-uk.com

Layout Report

General Data

Dimensions in Metres Angles in Degrees

Calculation Grids

ID	Grid Name	X	Y	X' Length	Y' Length	X' Spacing	Y' Spacing
1	Grid 1 - Wayfinding	492377.82	162736.77	48.19	7.33	1.46	1.47
2	Grid 2 - Wayfinding	492387.36	162670.37	15.26	48.35	1.39	1.47
3	Grid 3 - Wayfinding	492347.25	162627.90	11.40	54.59	1.43	1.48
4	Grid 4 - Wayfinding	492309.95	162639.99	47.02	24.51	1.47	1.44
5	Grid 5 - Wayfinding	492296.61	162695.72	36.75	30.28	1.47	1.44

Luminaires

Luminaire B Data

Supplier	
Type	Pharola Dark Sky -2.7k- 700mA- rear Shield-22W
Lamp(s)	9 x 2.7k LED
Lamp Flux (klm)	0.32
File Name	Pharola Dark Sky -2.7k- 700mA- rear Shield-22W.ies
Maintenance Factor	0.64
Imax70,80,90(cd/klm)	270.1, 131.5, 63.6
No. in Project	10

Layout

ID	Type	X	Y	Height	Angle	Tilt	Cant	Out-reach	Target X	Target Y	Target Z
2	B	492399.80	162729.48	1.00	232.00	0.00	0.00	0.00			
3	B	492385.79	162738.76	1.00	236.00	0.00	0.00	0.00			
4	B	492415.06	162717.27	1.00	230.00	0.00	0.00	0.00			
6	B	492426.16	162686.77	1.00	123.00	0.00	0.00	0.00			
5	B	492401.61	162670.03	1.00	126.00	0.00	0.00	0.00			
12	B	492337.27	162642.88	1.00	238.00	0.00	0.00	0.00			
7	B	492371.53	162649.09	1.00	315.00	0.00	0.00	0.00			
8	B	492357.90	162633.59	1.00	307.00	0.00	0.00	0.00			
9	B	492345.39	162637.76	1.00	237.00	0.00	0.00	0.00			
10	B	492309.09	162717.68	1.00	241.00	0.00	0.00	0.00			

Horizontal Illuminance (lux)

Grid 1 - Wayfinding



Results

Eav	2.34
Emin	0.01
Emax	28.84
Emin/Emax	0.00
Emin/Eav	0.00

Horizontal Illuminance (lux)

Grid 2 - Wayfinding

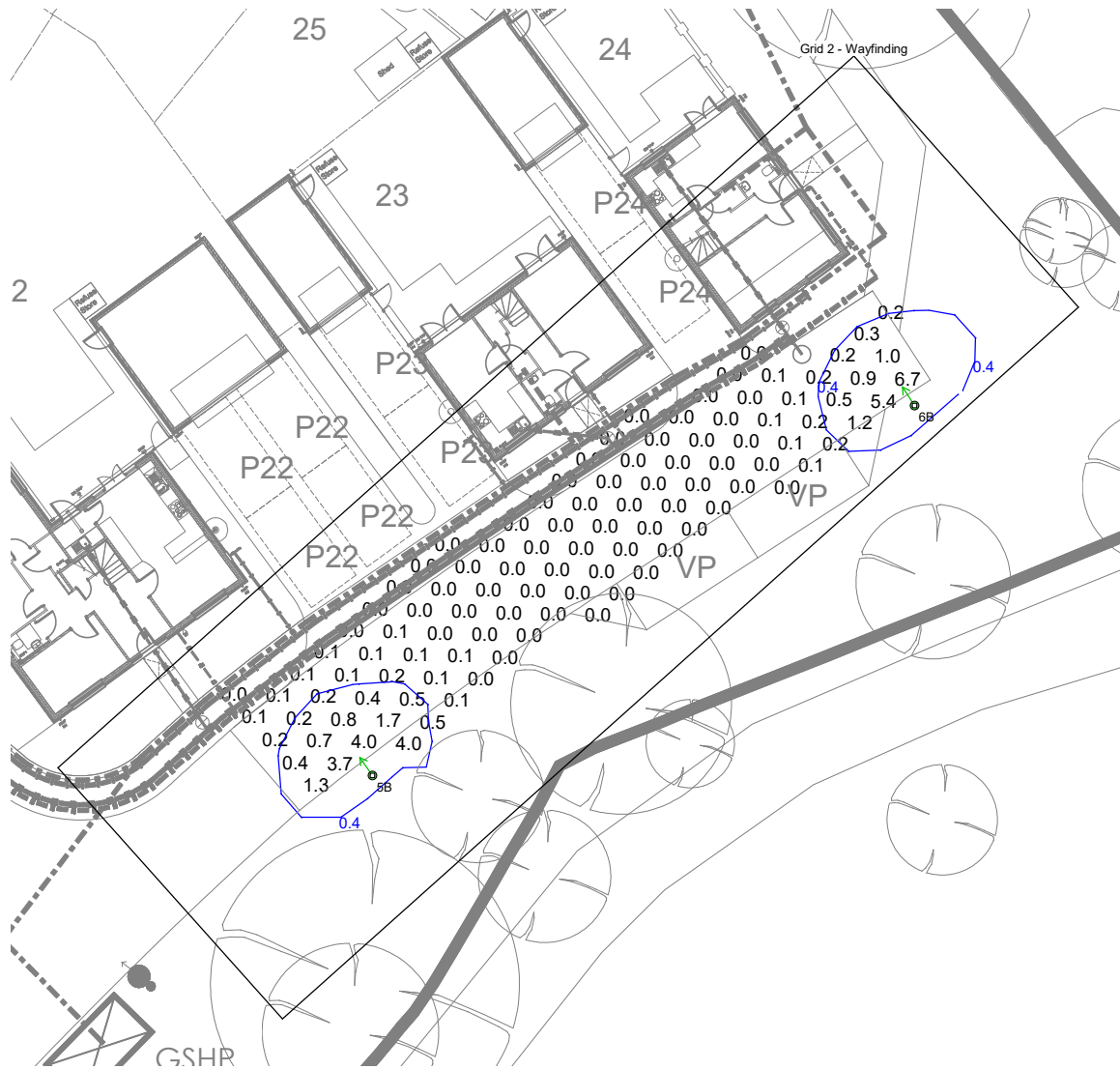

Results

Eav	0.36
Emin	0.00
Emax	6.72
Emin/Emax	0.00
Emin/Eav	0.01

Horizontal Illuminance (lux)

Grid 3 - Wayfinding

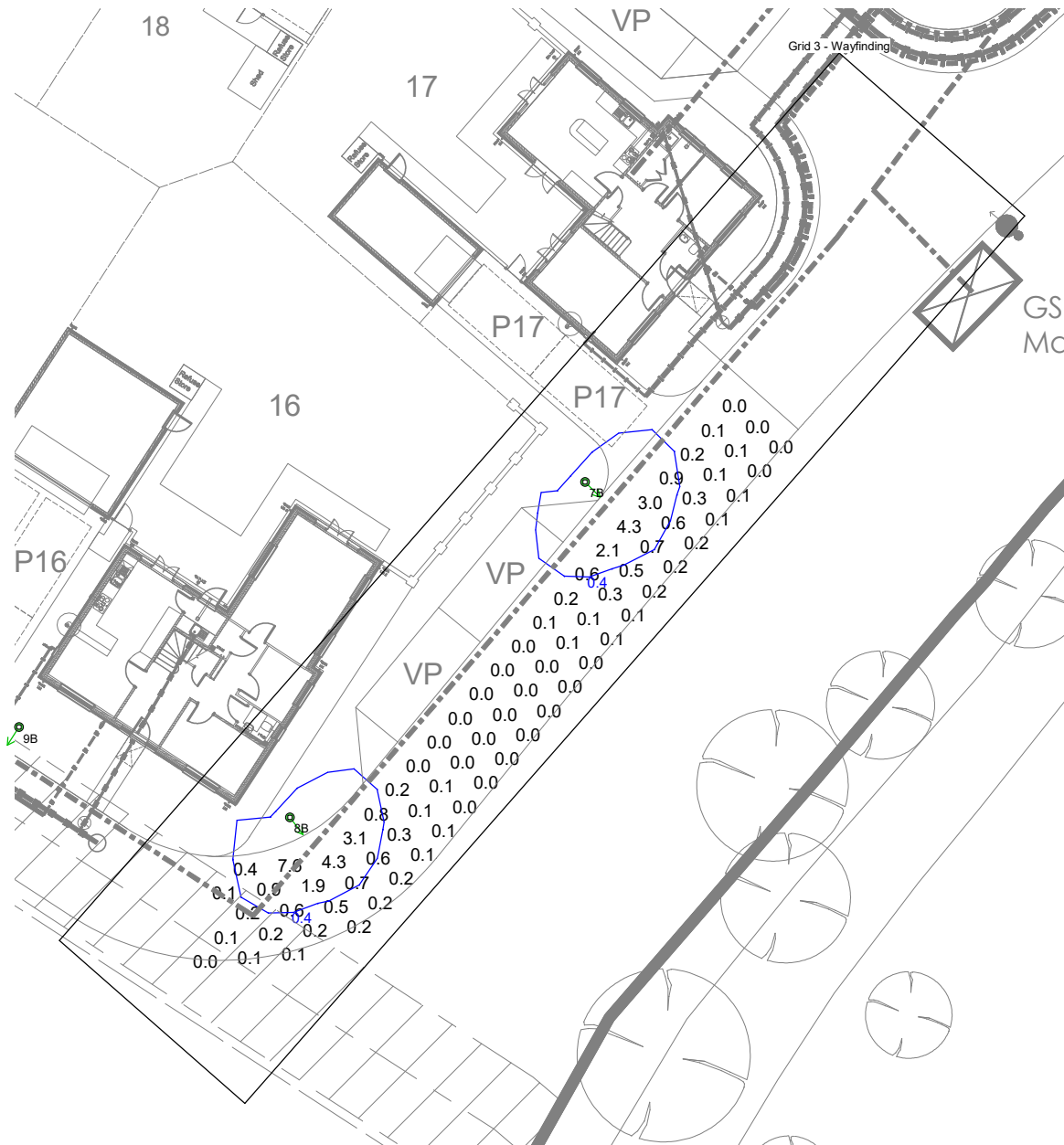

Results

Eav	0.53
Emin	0.01
Emax	7.58
Emin/Emax	0.00
Emin/Eav	0.02

Horizontal Illuminance (lux)

Grid 4 - Wayfinding



Results

Eav	0.77
Emin	0.00
Emax	28.44
Emin/Emax	0.00
Emin/Eav	0.00

Horizontal Illuminance (lux)

Grid 5 - Wayfinding

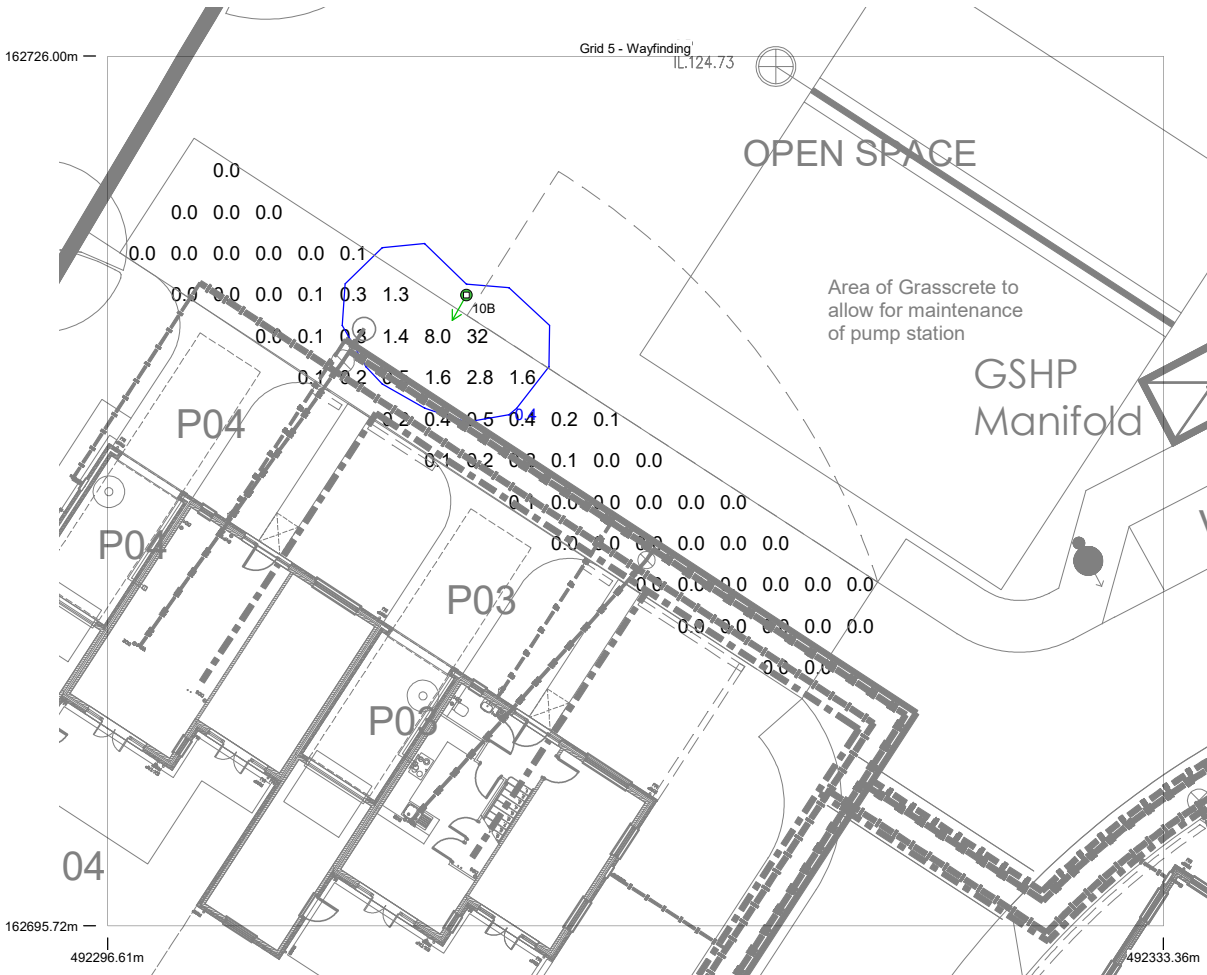

Results

Eav	0.82
Emin	0.00
Emax	32.05
Emin/Emax	0.00
Emin/Eav	0.00