

**External Levels Layout**

**Drawing key**

- Site boundary (Taken from site planning layout)
- 131.25 Finished Floor Level
- Exposed Brickwork - starting 150mm below DPC. 4C = No. of course exposed
- TANK 0.430m
- DPC 0.125m
- Double damp proof course - up to 150mm above DPC
- Double damp proof course - up to 150mm above DPC
- DPC 0.15m
- Split between plot FFL's
- M Part M level access
- Banking works (Maximum 1 in 3)
- 1:10 Gradient
- R/W 0.7M
- R/W 1.6M
- S/E 0.3M
- G/B 0.3M
- 147.785 Proposed level
- 131.65 Back of footway level
- +30.05 Existing level (shown on topographical survey)
- 2s Steps (max 150mm rise) (min 280mm going)
- G Private trapped pot gully
- Private linear drainage channel

- General Notes:**
- All dimensions in metres unless otherwise stated
  - All levels are in metres
  - This drawing is to be read in conjunction with all relevant Engineer's and Architect's drawings, specification, Reports and Engineering Details.
  - Do not scale from this drawing
  - Any discrepancies found on this drawing are to be reported to Persimmon Homes South Midlands Technical Department immediately.

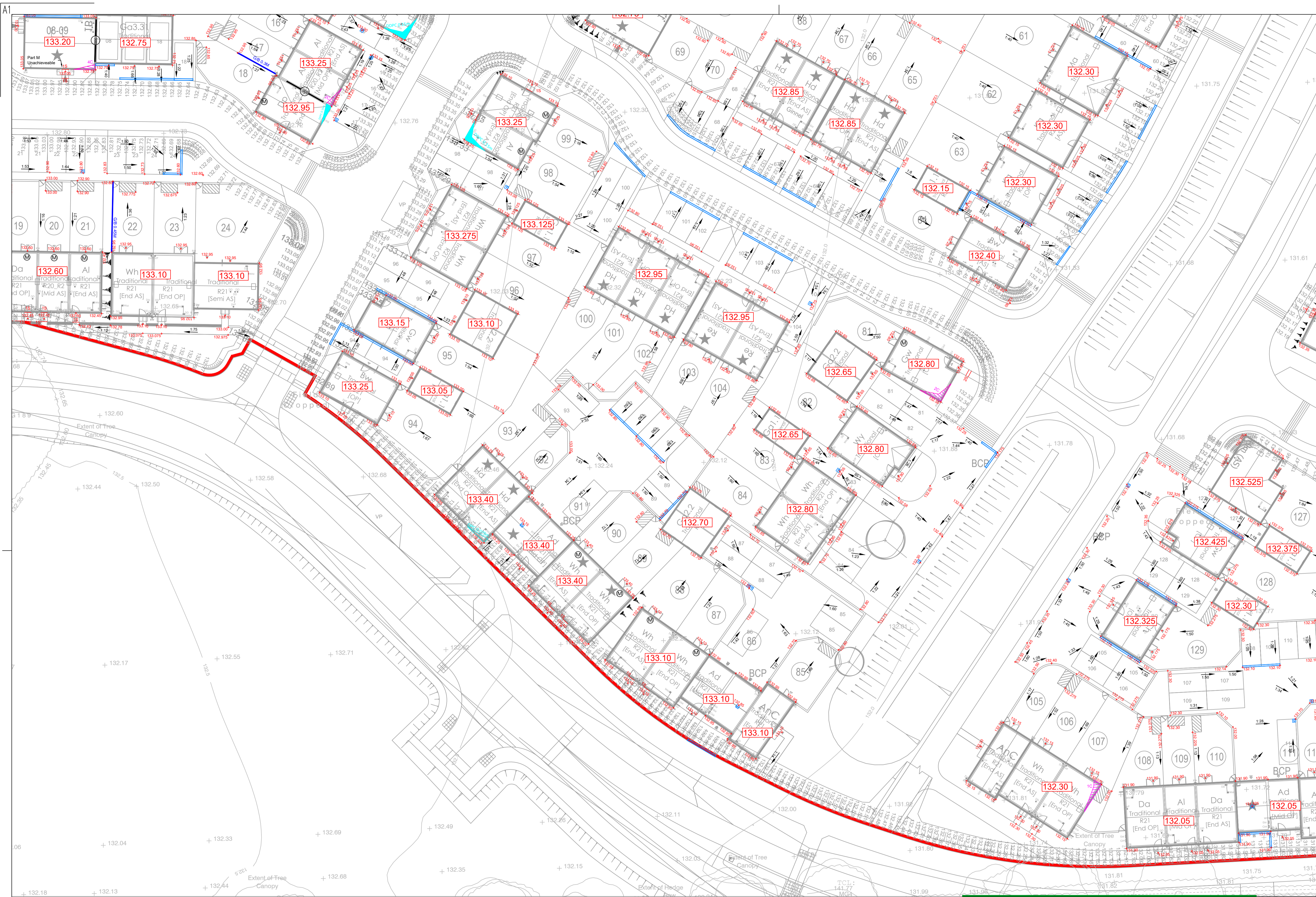

Development  
 Wykham Park Farm,  
 Banbury,  
 Oxfordshire

Drawing Title	Date	Scale	Drawn by
External Levels Sheet 4/7	02/23	1/250@A1	KM/RW
Drawing Status	Drawing Ref	Rev	
Tender	385 - Ext - 104	-	