

2.0 Staff Cycle Parking

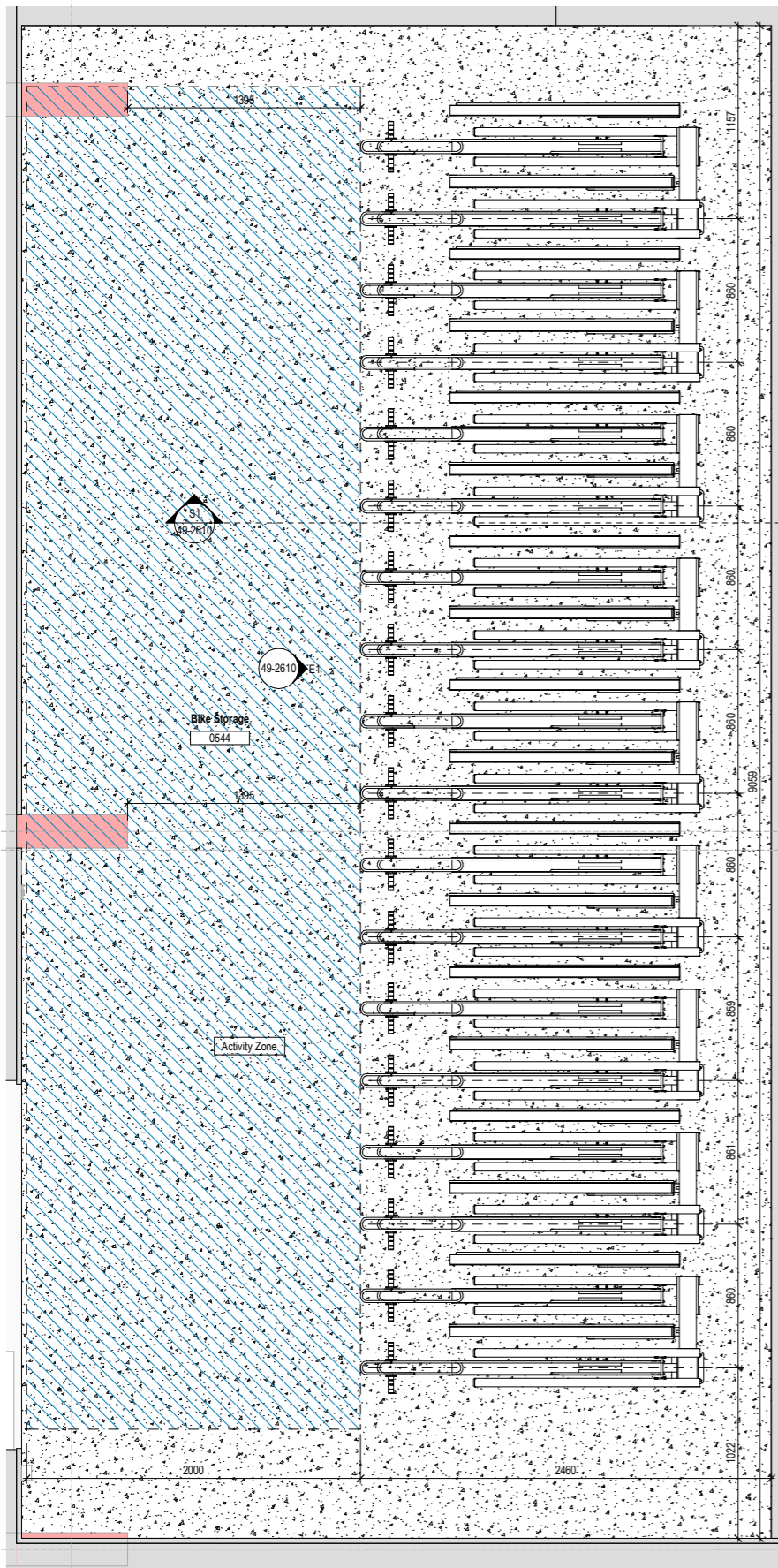

1 AM-XX-AA-001 - Plan - GF
1:20

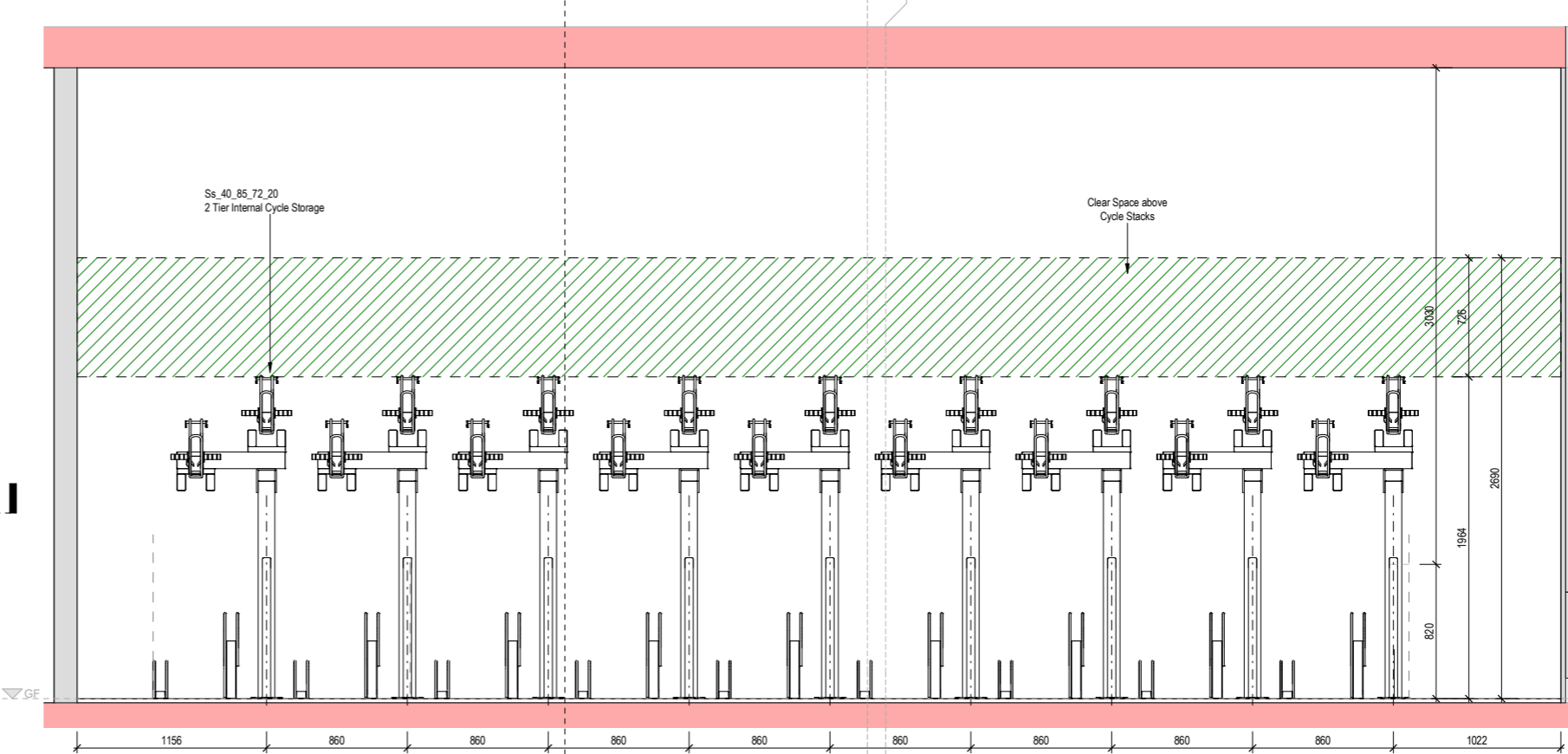

E1 AM-XX-AA-001 - Front Elevation
1:20

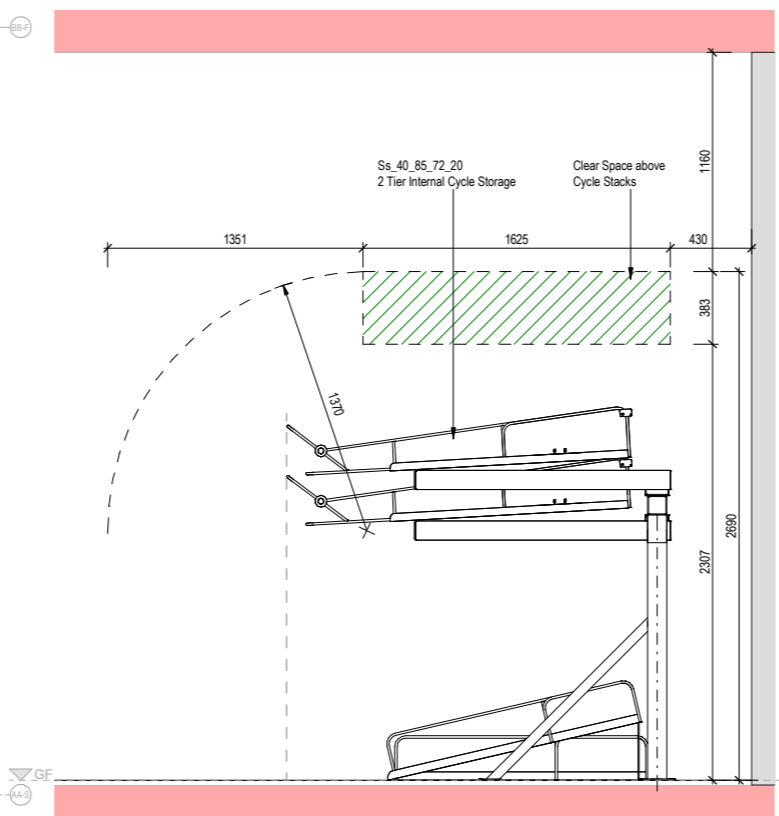

S1 AM-XX-AA-001 - Section 1
1:20

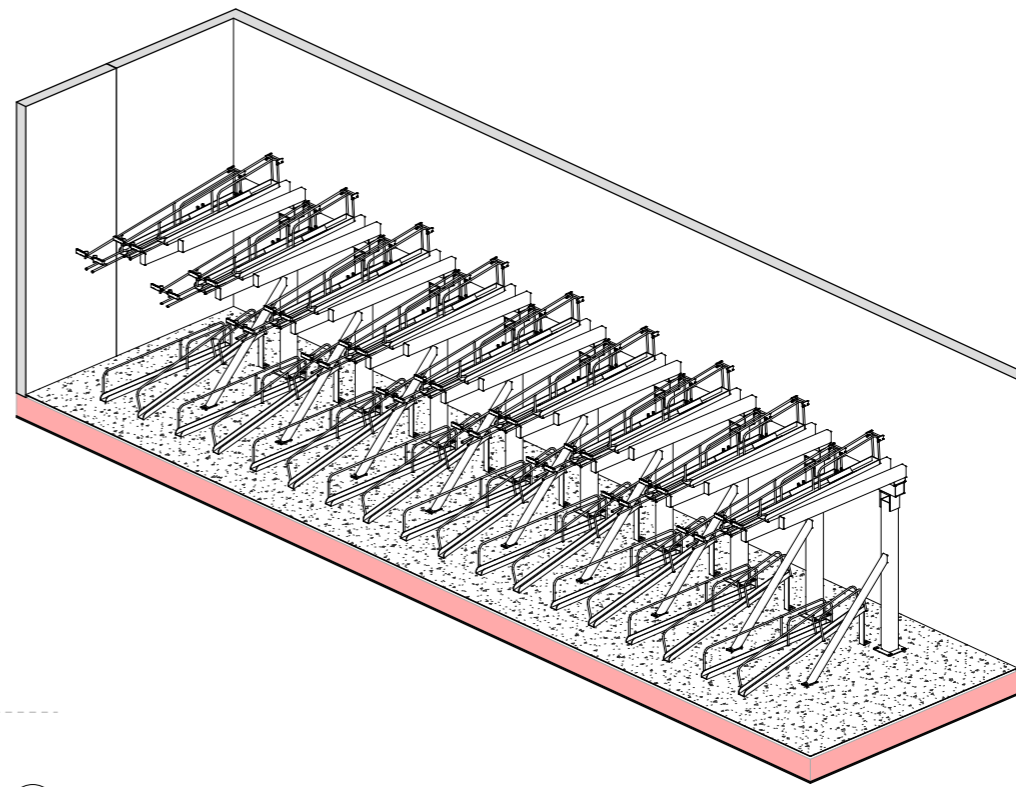

3D AM-XX-AA-001 - 3D View
1:20

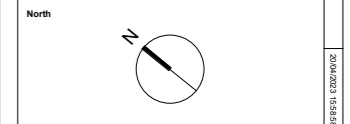
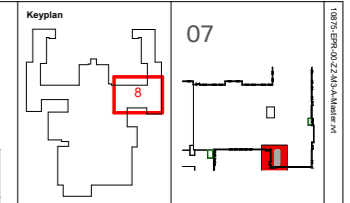

Notes:
Do not scale off this document/drawing/model for any purposes other than those required in connection with the application for planning consent for the project. This document/drawing/model is prepared for the sole use of EPR Architects employer and the benefit of the employer's permitted licensees. No liability to any other persons is accepted by EPR Architects.
EPR Architects accepts no liability for any use of this document/drawing/model by parties other than the party for whom it was prepared or for purposes other than those for which it was prepared.
Copyright in the design contained in this document/drawing/model remains vested in EPR Architects.
The area information contained in this document/drawing/model/schedule reflects the anticipated approximate areas of the project based on the current state of the design. The area dimensions have been calculated generally in accordance with the RICS Code of Measuring Practice, 6th Edition and have been calculated in metric units and expressed in both metric and imperial units. Where there is a discrepancy, the metric units take precedence.

Current Revision Description (Post Final Stage 4 Submission)

Key Legend For 49 - Architectural Metalwork Package:

- Drawing to be read in conjunction with all relevant sections of the architects specifications, drawings and schedules, including Fire strategy report and drawings, Access Statement, Access Strategy and Security Strategy
- These drawings should be read in conjunction with all manufacturers' current system literature.
- Due to the nature of the contract and building tolerances the contractor/sub-contractor will be responsible for all site investigations, checks and surveys etc - main contractor to provide level survey of base build structures prior to works commencing on site.
- If finishes not shown on drawings, refer to finishes schedule, architects schedule, specification and drawings.
- Finishes to be confirmed by interior theming designer.
- Furniture to be Heavy-duty for hotel and commercial usage.

Plant Screens:

- Metal Louvre construction
- Aluminum material
- PPC Finish - Dark Grey
- Frame sizing and spacing as per manufacturers standard details
- All fixings and hinges to be on the plant equipment side of the screen
- Door panels inset within screen to match the finish and layout of the adjacent fixed panels
- All ironmongery to be Satin Stainless Steel
- Door panels to allow for lever handle to both sides

Structural solution for plant screen is intended to be structural stub posts fixed back to main structural slab through roofing finish. Final design, number and location of stubs are to be coordinated with S.Eng during Stage 4 in coordination with supplier of the plant screen. Plant screen is intended to be a proprietary system.

Watermark Entrance

Entrance Finings BY OTHERS, Turnstile and railing Design as part of the theming Design. Drawing for spatial setting out only

Associated Packages:

- Please also refer to the below drawing packages for information or details that relate to Architecture elements:
- GA = 02 series
 - Stair-Ramps = 24 series
 - Handrail-Handrails = 34 series
 - Demountable / Secondary Partitions / Internal Windows = 36 series
 - Refer to 10875-EPR-ZZ-XX-SP-A-49-0890 Metalwork Specification

No.	Revision	Date	Initial	Chk'd
P04	Planning Condition 14 - Cycle Parking	20.04.23	AJ	SH
P03	RIBA STAGE 4 ISSUE	30.09.22	SH	SB
P02	RIBA Stage 3 - Final Issue	30.03.22	DB	AJ
P01	S2 - Issued for Information	14.12.21	CM	AJ

EPR ARCHITECTS
+44 20 7932 7000
www.epr.co.uk

Proposed Great Wolf Lodge - Chesterton, Bicester, Oxfordshire EPR Project No 10875

Cycle Stands - AM-XX-AA-001

Scale @A1 Purpose of Issue Status code Revision
As indicated For Information S2 - P04

Project Code Originator Zone Level Type Role Class Number
10875 - EPR-AA-ZZ-DR-A - 49-2610

Staff Cycle Route

Plan illustrating the prominence of the location of staff cycle spaces.

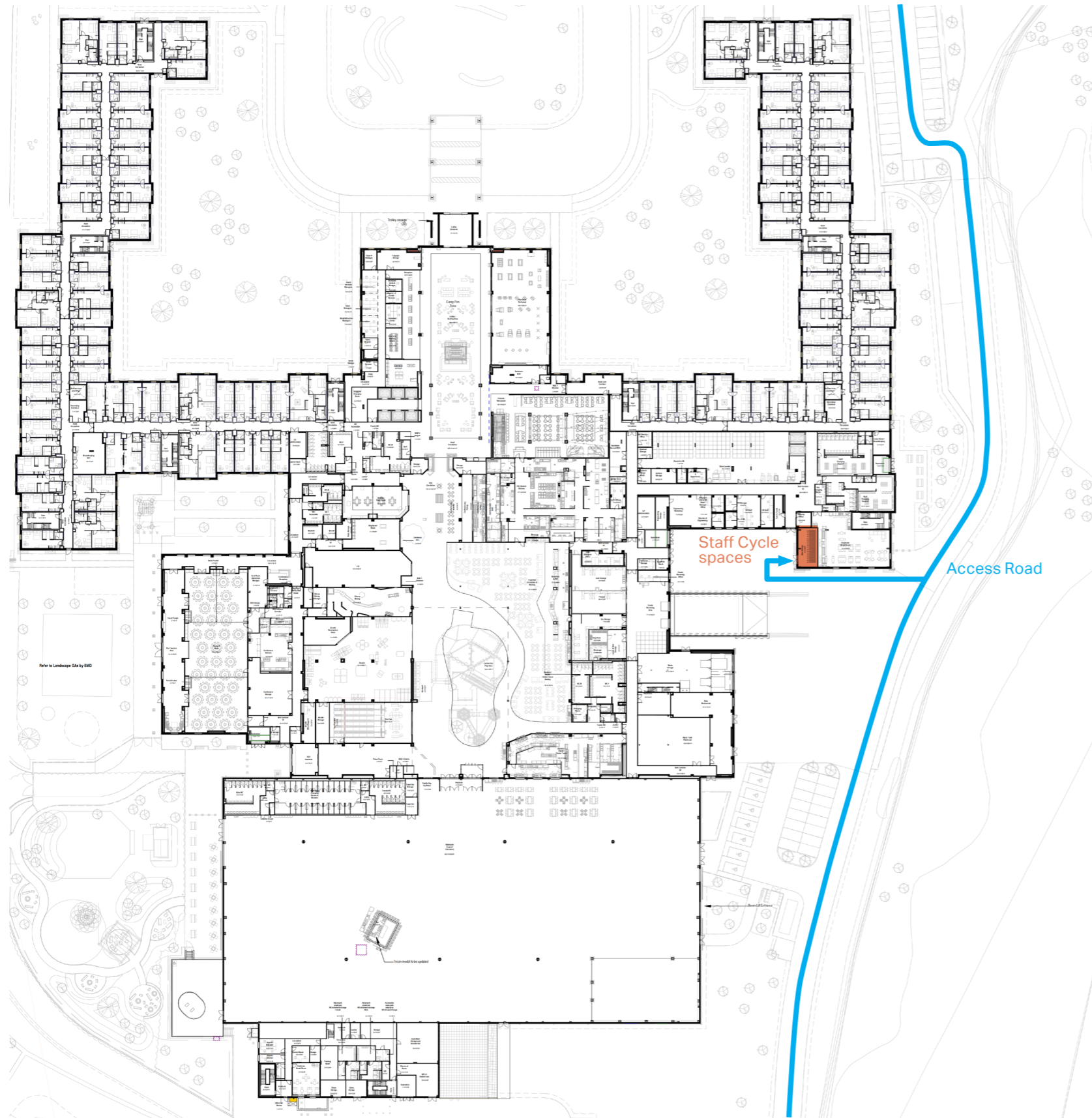

London Studio

EPR Architects
All Saints, Austral Street
London
SE11 4SJ
+44 20 7932 7600
architects@epr.co.uk
www.epr.co.uk

Wrocław Studio

EPR Architects Poland Sp. z o.o.
pl. Tadeusza Kościuszki 7-8
50-028, Wrocław
Poland
+48 71 330 77 28
wroclaw@epr.co.uk
www.epr.co.uk

Manchester Studio

EPR Architects
York House, 20 York Street
Manchester
M2 3BB
+44 161 519 4910
manchester@epr.co.uk
www.epr.co.uk

EPR ARCHITECTS

