

MANHOLE / INSPECTION CHAMBER SCHEDULE

MH REF	CL	IL	DEPTH	DIA	OPENING	COVER	COMMENTS
S1	83.600	81.875*	2025	1800	2/600x600	D400	300mm Catchpit (IL 81.875) + Hydrobrake 5 l/sec
S2	83.500	81.900*	1900	1500	600x600	D400	300mm Catchpit (IL 81.600)
S3	83.300	81.970*	1630	1200	600x600	D400	300mm Catchpit (IL 81.670)
S4	83.775	82.260*	1815	1200	600x600	D400	300mm Catchpit (IL 81.960)
S5	83.300	81.985*	1615	1350	600x600	D400	300mm Catchpit (IL 81.685)
S6	83.700	82.185*	1815	1200	600x600	D400	300mm Catchpit (IL 81.885)
S7	84.125	82.400*	2025	1200	600x600	D400	300mm Catchpit (IL 82.100)
S8	83.200	82.150*	1350	1200	600x600	D400	300mm Catchpit (IL 81.850)
S9	83.100	82.050*	1350	1200	600x600	D400	300mm Catchpit (IL 81.750)
S10	83.575	82.235*	1640	1200	600x600	D400	300mm Catchpit (IL 81.935)
S11	83.950	82.450*	1800	1200	600x600	D400	300mm Catchpit (IL 82.150)
S12	83.900	82.415*	1875	1200	600x600	D400	300mm Catchpit (IL 82.115)
S13	83.150	82.000	1450	1200	600x600	D400	300mm Catchpit (IL 81.700)
S14	83.300	81.900*	1700	1200	600x600	D400	300mm Catchpit (IL 81.600)
S15	83.600	81.725*	2175	1800	2/600x600	D400	300mm Catchpit (IL 81.425) + Hydrobrake 3.5 l/sec
S16	84.100	82.300*	2100	1200	600x600	D400	300mm Catchpit (IL 82.000)

*Note: - IL is to depth of lowest outgoing pipe. See catchpit IL for true depth of manhole

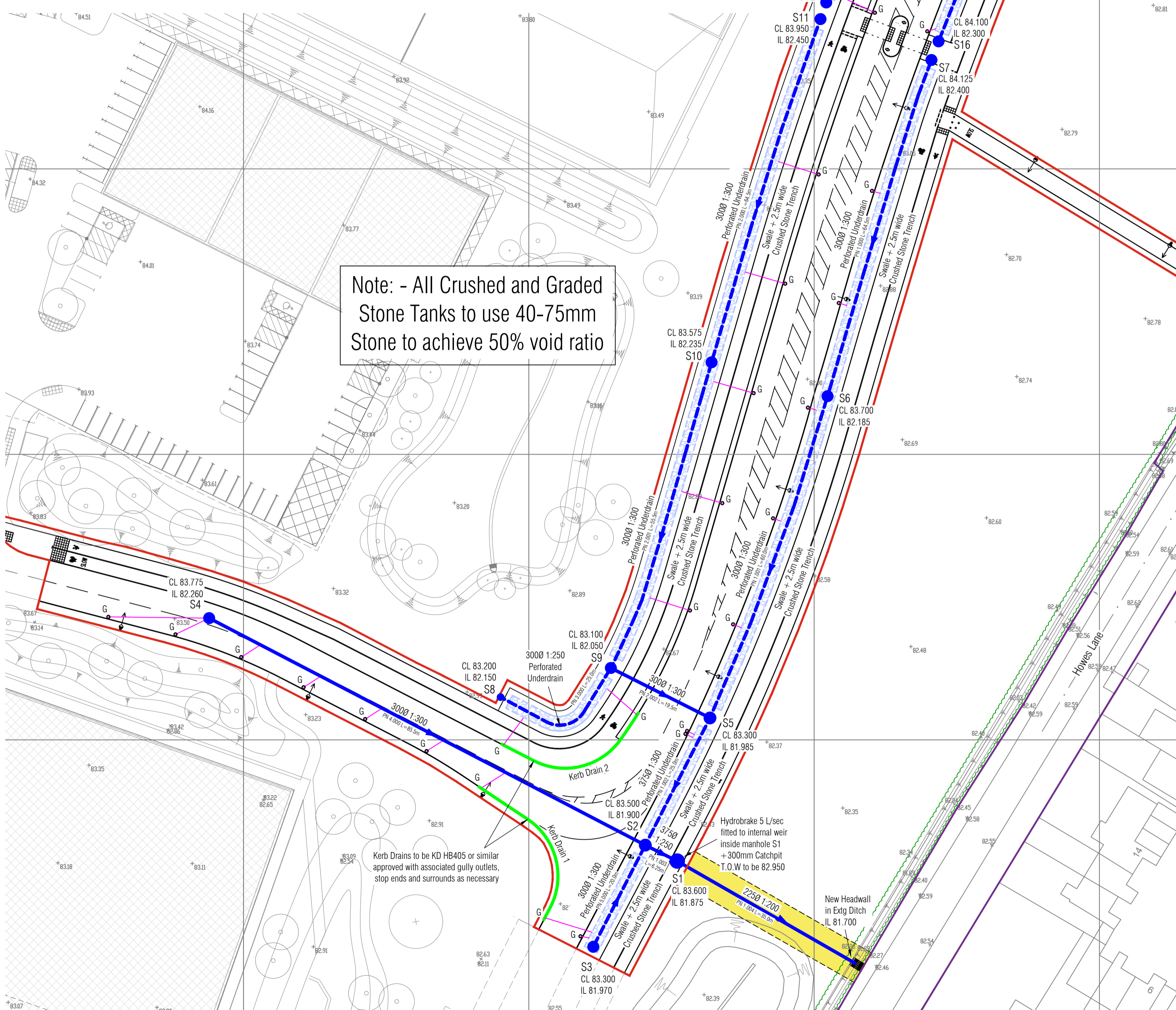

SW Drainage Plan 1:500

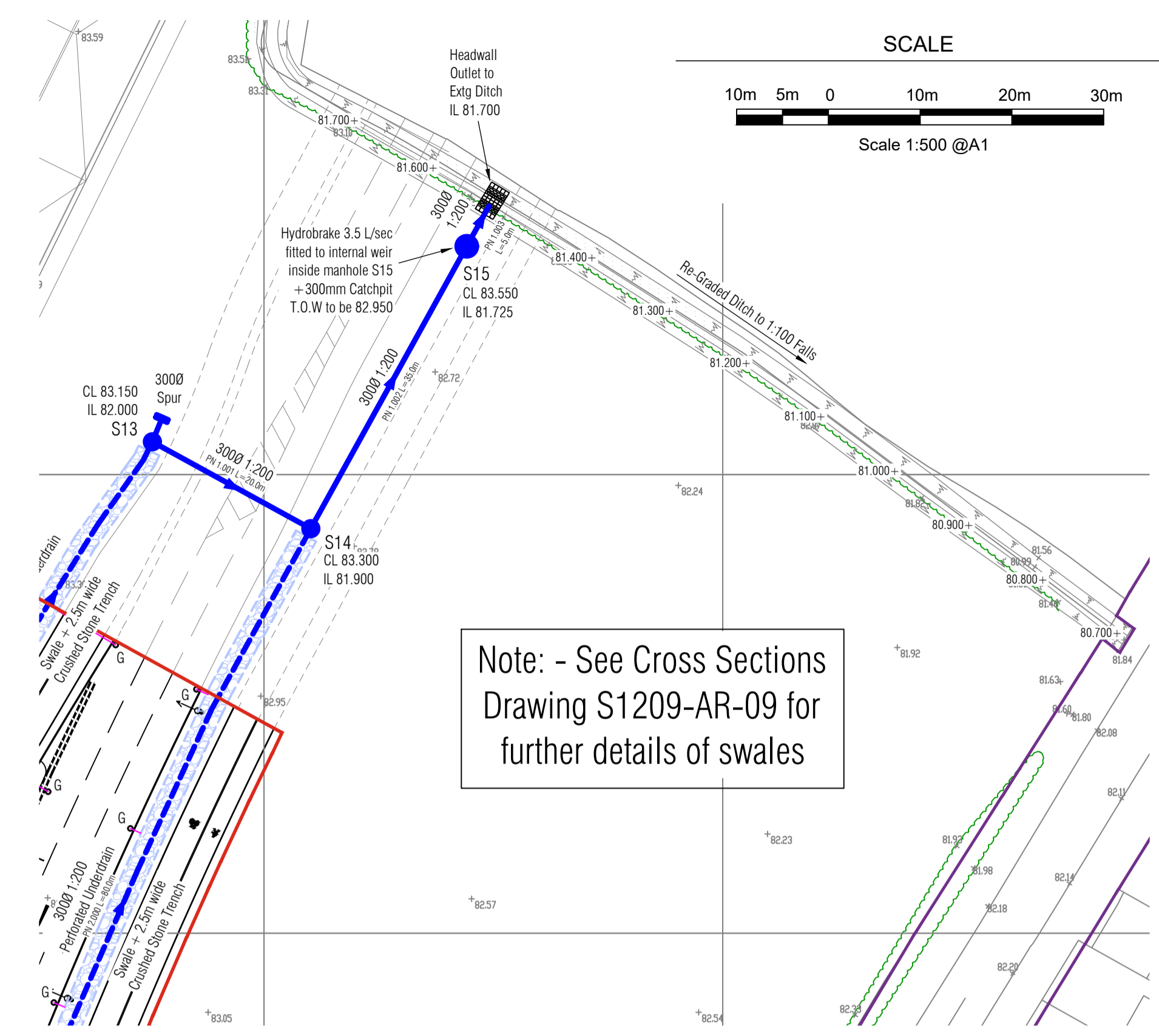

SW Drainage Cont'd 1:500

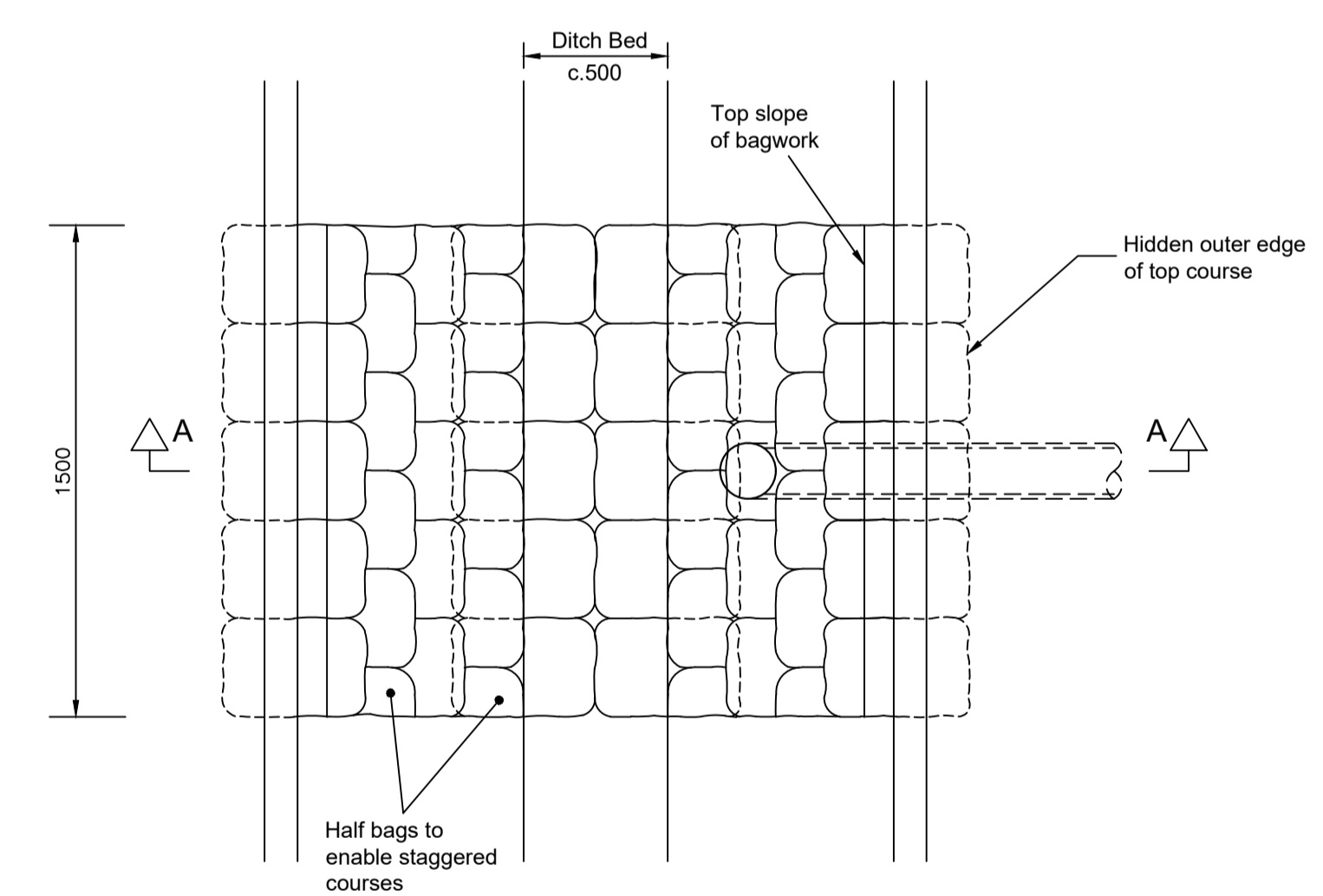

Concrete Bag Headwall Detail 1:20

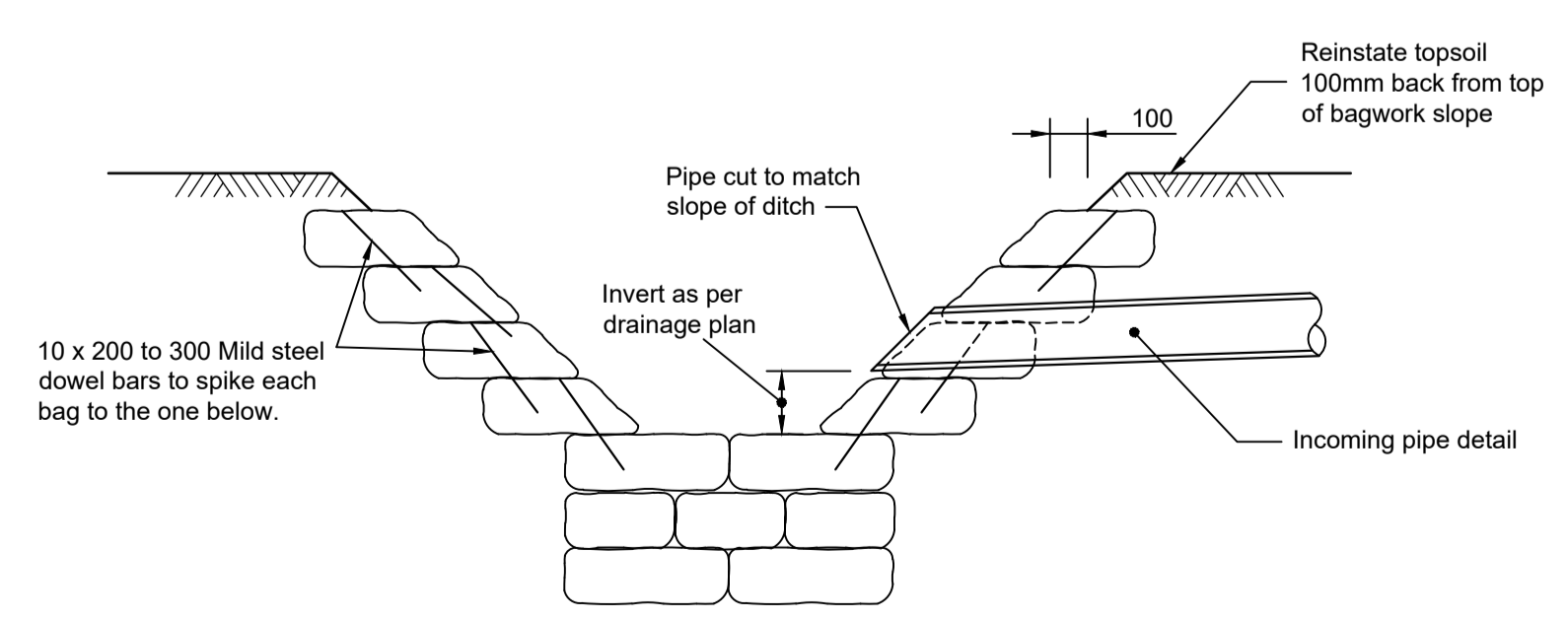

Section A-A 1:20

DRAINAGE NOTES

- This drawing is to be read in conjunction with all relevant Architects and Bailey Johnson Hayes drawings and specifications.
- Do not scale. Work only to figured dimensions.
- All dimensions and condition of existing drainage features to have invert levels confirmed on site prior to commencement of work.
- All works to Adopted Sewers to be carried out in accordance with the requirements of Sewers for Adoption in the Sewerage Sector Guidance v2.2 (2022) and the Adopting authority requirements.
- All works subject to agreement by Oxfordshire County Council (OCC) Road Agreements department.
- All Concrete pipes and fittings shall comply with the relevant provisions in BS EN 1916 and BS 5911-1 and should be constructed in a manner suitable for adoption.
- All Thermoplastic structured wall pipes shall comply with the relevant provisions of BS EN 13476-3 and WIS 4-35-01 and BS EN 13476-2 or BS EN 13476-3. Pipes shall be BSI kitemarked or have relevant 3rd party certification. Not suitable for construction of 450mm diameter or above.
- All pipework to have Class S granular bed and surround, except where:
 - Cover beneath roads or roadside footways is less than 1200mm to Pipe Crown or,
 - Cover beneath isolated footways and landscaping is less than 900mm in which case Class Z (Concrete) bedding / surround is required with flexible joints or concrete slab protection, see drainage details for further information.
- All Manholes to be constructed in Precast Concrete Rings to BS EN 1917 and BS 5911-3 shall be constructed with a Design Chemical Class DC-4 unless a lower class can be derived from soil testing. Rings to be bedded in sealant strips unless otherwise noted in Manhole Schedule.
- Manholes in landscaped areas to be backfilled with 40mm down graded stone fill, compacted in layers not exceeding 150mm thick. All manholes beneath roads and parking areas to be cased in minimum 150mm concrete surround.
- As a minimum, Class D400 frame and covers shall be used in carriageways of roads (including pedestrian streets), hard shoulders and parking areas. Minimum frame depth 150mm.
- Class B125 shall be used in footways, pedestrian areas, driveways serving a single house and comparable locations.
- All road gullies to be Hepworth Road Gullies, Ref 213 with 150mm diameter outlets or similar approved. Gullies to be encased in minimum 150mm concrete.
- Kerb drainage to be ACO kerb drains, designed and supplied by specialist manufacturer or similar approved.
- All Pipes to enter manhole with Soffits Level unless otherwise stated. See manhole details drawings for further clarity of connections.

KEY

- INDICATES NEW GULLIES
- INDICATES NEW SURFACE WATER MANHOLES
- INDICATES NEW PIPE RUNS
- INDICATES NEW KERB DRAIN RUNS
- INDICATES NEW FILTER TRENCH

SLR CONTRIBUTION AGREEMENT

E	03.11.23	Updated to latest Street Lighting Layout
D	29.08.23	Revised to Technical Audit 1 comments
Rev	Date	Revision Description

Revision Schedule

Project Title	Axis J9 - Bicester
---------------	--------------------



Drawing Title
Access Road (Phase 3)
SW Drainage Plan

BAILEY JOHNSON HAYES
Consulting Engineers

ST.ALBANS: Suite 4, Phoenix House, 63 Campfield Rd, ST.ALBANS, Herts AL1 5FL

Scale	1:500, 20 @A1	Drawing Number	S1209-AR-04 E
Date	06.04.23		
Drawn	JNG		