

DESIGNERS CDM NOTE - RESIDUAL RISKS IDENTIFIED

The design Engineer(s) have analysed this design as the scheme has been developed, in order to identify if there are any significant residual risk hazards (i.e. unusual, unexpected, abnormal or difficult).

Residual risks **HAVE** been identified and are therefore shown on this drawing. These risks have not been possible to remove by design.

This statement assumes that a competent Contractor with the appropriate qualified staff will be employed for the work, and that they will be familiar with site wide construction risks and hazards that they can reasonably be expected to encounter as part of their work.

BURIED UTILITIES RISK NOTE

- Buried utilities are present on and in the vicinity of the site.
- The Contractor must satisfy themselves that they have seen utility returns for the area and that appropriate Risk Assessment Method Statement (RAMS) are in place and implemented to ensure that buried and/or overhead services are located prior to any works taking place.
- Any RAMS shall address safe procedures for protection and working in the proximity of services.

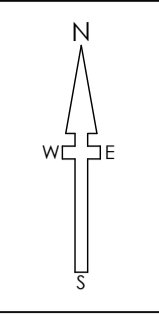
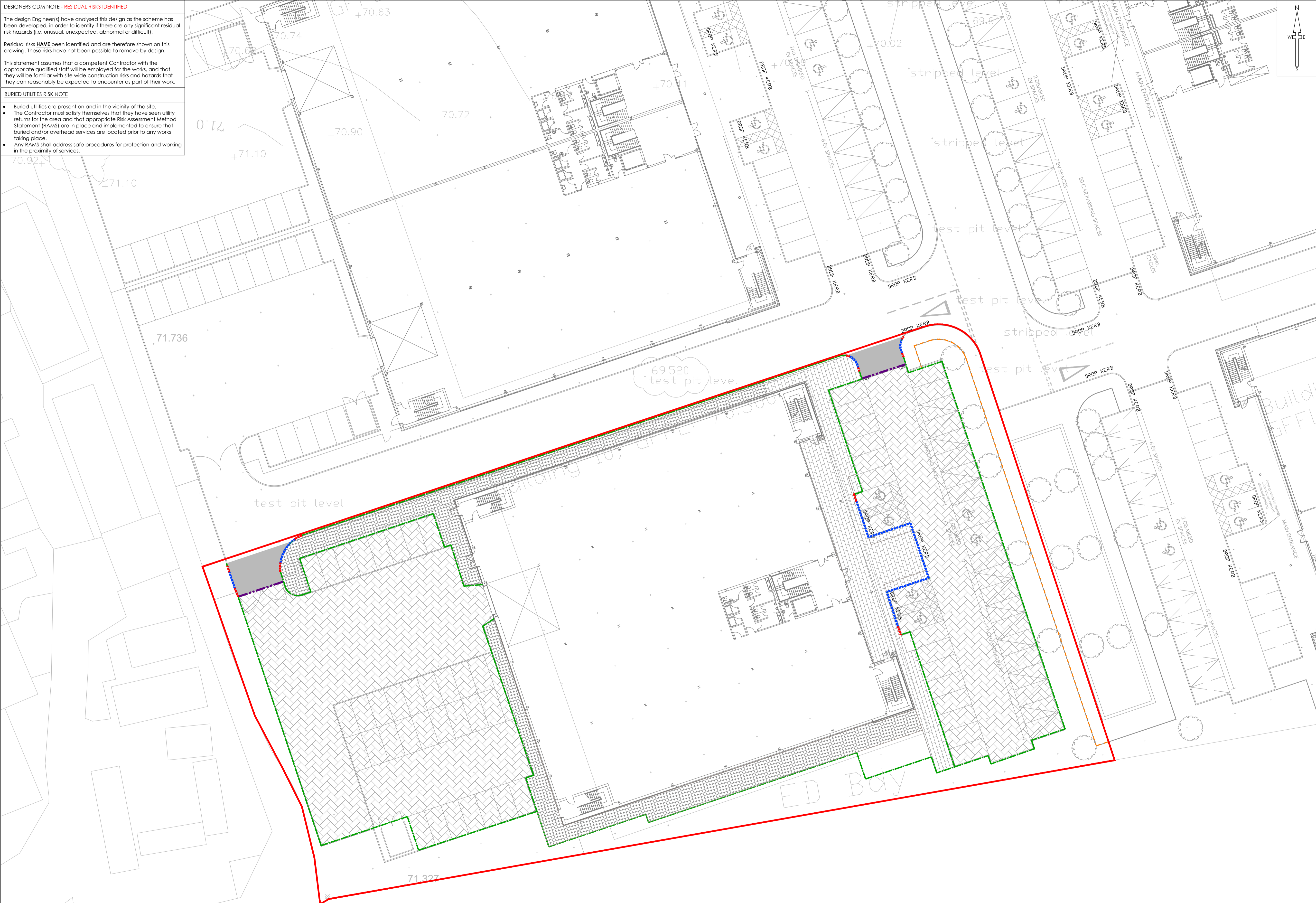

- NOTES**
- All dimensions and levels are in metres unless otherwise noted
 - This drawing is to be read in conjunction with the relevant Architect's/Engineer's drawings, specifications and CDM documentation
 - This drawing has been produced electronically and may have been photo reduced/ or enlarged when copied. Work to figured dimensions only (DO NOT SCALE - EXCEPT FOR PLANNING PURPOSES). All dimensions to be checked on site. Any errors or omissions to be reported to the engineer immediately.
 - This drawing contains coloured lines / information that may not be clear if reproduced in black and white.
 - Digital copies of this plan can only be considered accurate if supplied directly by Infrastruct CS Ltd.

Kerbing Legend

| Kerb Ref | Type | Dimension | Notes |
|----------|----------|-----------|---|
| HB2 | HB2 | 125x255 | 125mm upstand |
| BN | BN | 125x150 | 0-4mm upstand eg dropped kerbing to dwelling primary access crossover |
| HB to BN | HB to BN | 125x255 | Transition kerb either left or right drop as required |
| EF | EF | 50x150 | Square edged path edging laid flush unless otherwise stated |
| CS2 | CS2 | 125x150 | Flush kerb laid with slight fall to channel eg Pedestrian crossings |

Surface Finishes Legend

| | |
|-----------|--|
| [Pattern] | Asphalt Construction |
| [Pattern] | 240mm x 120mm x 80mm thick Tobermore Permeable paving concrete block paviours to BS EN 1338:2003 Colour: Charcoal, demarcation line: Natural |
| [Pattern] | 600mm x 150mm x 80mm thick Tobermore Manhattan paviours to BS EN 1338:2003 |
| [Pattern] | 240 x 120 x 60mm Concrete Blocks to BS EN 1338:2003 Colour: Charcoal |

- NOTES**
- All street lights in verge to have 150mm concrete collar surround
 - Tree root barrier required to any tree within 5m of the carriageway/footway
 - Permeable paving to be laid at 45° herringbone pattern. Stretcher course should be used when pattern can't be continued. 1 No stretcher course channel either side of road
 - No doors or windows are to open onto the highway at any level. No gas boxes or porches are to be located within highway land
 - All private footways to be side hung so no runoff into public highway
 - No railings or fences to be in highway or 600mm from front face of kerb

| | | | | |
|--------------------------------------|-------|-------|-------------------|------------|
| PO2 | SNN | APL | New Site Layout | 19/04/23 |
| PO1 | RSI | MBD | Initial Issue | 16/11/22 |
| REV | DRAWN | CHECK | REVISION COMMENTS | ISSUE DATE |
| DRAWING TITLE | | | | SHEET NO. |
| Surface Finishes & Kerb Types Design | | | | 1/1 |

PROJECT
Building 10
Oxford Technology Park
Kidlington, Oxon

CLIENT

HILL STREET HOLDINGS

Infrastruct CS Ltd

SCALE @ A1
1:200

PROJECT NUMBER: 5214 | STATUS: S2 | ISSUE PURPOSE: INFORMATION

ENGINEER: MBD | DRAFT: SNN | APPROVED: RJW

| PROJECT | ORIGIN | PHASE | LEVEL | TYPE | ROLE | NO. | REVISION |
|---------|--------|-------|-------|------|------|------|----------|
| OTP | ICS | 010 | XX | DR | C | 0300 | P02 |