

- IF THIS DRAWING HAS BEEN RECEIVED ELECTRONICALLY IT IS THE RECIPIENT'S RESPONSIBILITY TO PRINT THE DOCUMENT TO THE CORRECT SCALE.
- ALL DIMENSIONS ARE IN MILLIMETRES UNLESS STATED OTHERWISE. IT IS RECOMMENDED THAT INFORMATION IS NOT SCALED OFF THIS DRAWING.
- THIS DRAWING SHOULD BE READ IN CONJUNCTION WITH ALL OTHER RELEVANT DRAWINGS AND SPECIFICATIONS.

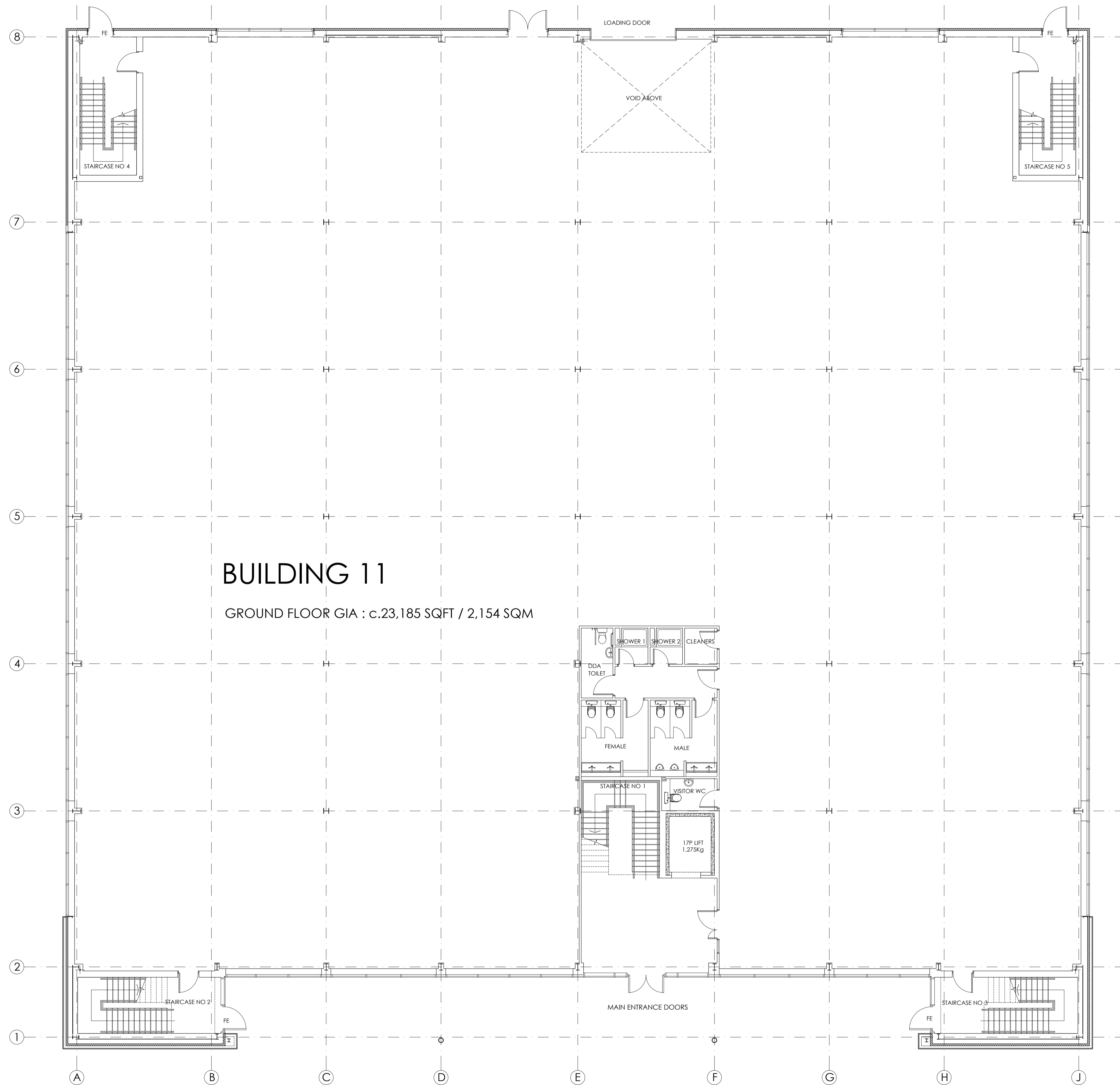

BUILDING 11

GROUND FLOOR GIA : c.23,185 SQFT / 2,154 SQM

PLANNING ISSUE

PL4	PLANNING ISSUE 4	LT	09.02.23	MD
PL3	PLANNING ISSUE 3	LT	27.01.23	MD
PL2	PLANNING ISSUE 2	LT	10.11.22	MD
PL1	PLANNING ISSUE 1	LT	11.10.22	MD

REV. AMENDMENT DRAWN DATE AUTHD

client: HILL STREET HOLDINGS

project: OXFORD TECHNOLOGY PARK

site: LANGFORD LANE
KIDLINGTON, OXFORDSHIRE

content: BUILDING 11
GROUND FLOOR PLAN

date: OCT 2022

scale: 1 : 100 @ A1

ALL DIMENSIONS TO BE CHECKED ON SITE

GARRETT | MCKEE
ARCHITECTS

RILEY HOUSE
RILEY ROAD
MARLOW
BUCKINGHAMSHIRE
T: 01628 907000
www.garrettmckee.co.uk

drg.no: 2788 - 10 revision: PL4

GROUND FLOOR PLAN
SCALE 1:100

