

1. IF THIS DRAWING HAS BEEN RECEIVED ELECTRONICALLY IT IS THE RECIPIENT'S RESPONSIBILITY TO PRINT THE DOCUMENT TO THE CORRECT SCALE.
2. ALL DIMENSIONS ARE IN MILLIMETRES UNLESS STATED OTHERWISE. IT IS RECOMMENDED THAT INFORMATION IS NOT SCALED OFF THIS DRAWING.
3. THIS DRAWING SHOULD BE READ IN CONJUNCTION WITH ALL OTHER RELEVANT DRAWINGS AND SPECIFICATIONS.

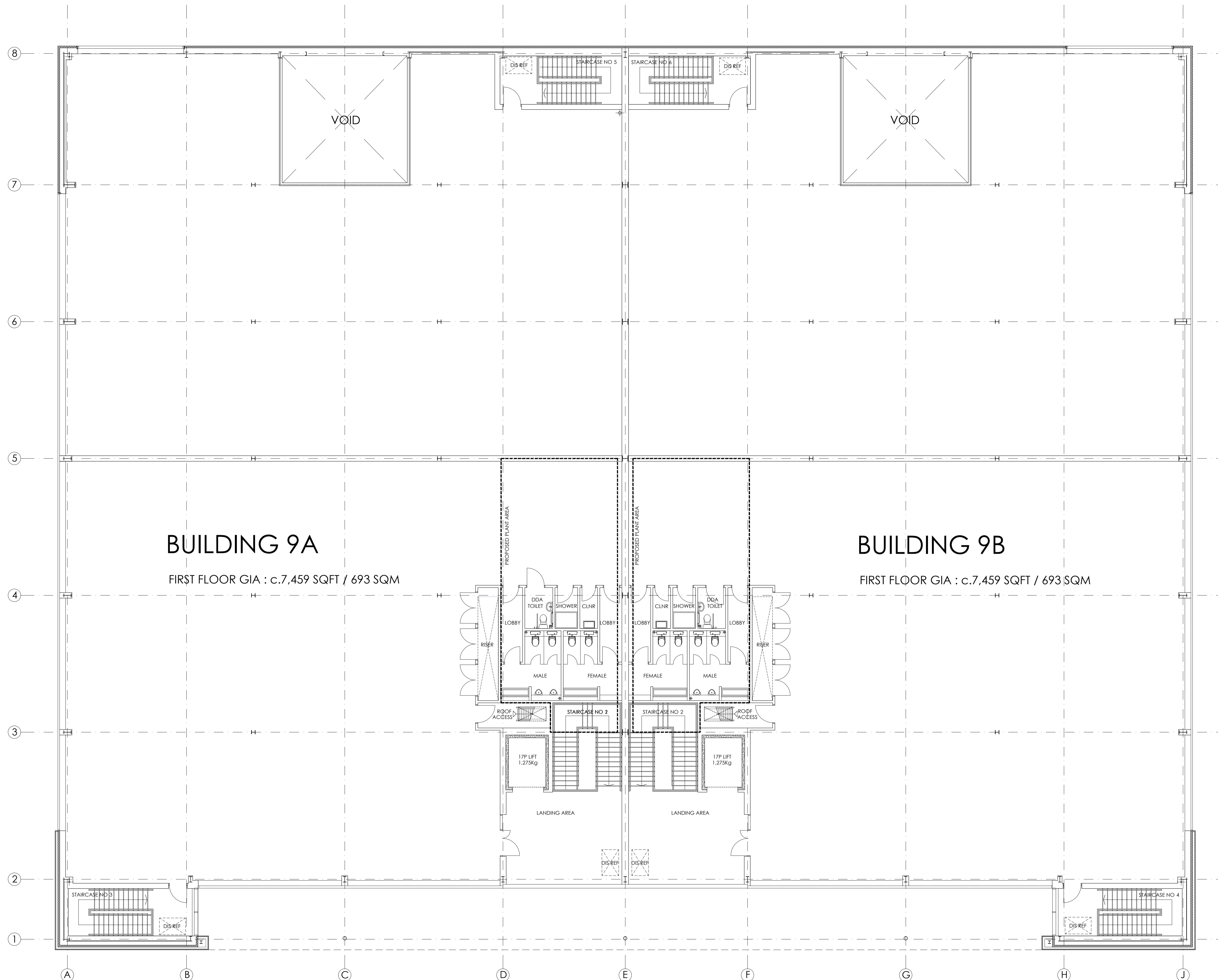

BUILDING 9A

FIRST FLOOR GIA : c.7,459 SQFT / 693 SQM

BUILDING 9B

FIRST FLOOR GIA : c.7,459 SQFT / 693 SQM

PLANNING ISSUE

PL4	PLANNING ISSUE 4	LT	09.02.23	MD
PL3	PLANNING ISSUE 3	LT	30.01.23	MD
PL2	PLANNING ISSUE 2	LT	28.08.22	MD
PL1	PLANNING ISSUE 1	LT	19.07.22	MD
REV.	AMENDMENT	DRAWN	DATE	AUTH'D

client: HILL STREET HOLDINGS

project: OXFORD TECHNOLOGY PARK

site: LANGFORD LANE
KIDLINGTON, OXFORDSHIRE

content: BUILDING 9A & 9B
PROPOSED FIRST FLOOR PLAN

date: JULY 2022

scale: 1 : 100 @ A1

ALL DIMENSIONS TO BE CHECKED ON SITE

GARRETT | MCKEE
ARCHITECTS
RILEY HOUSE
RILEY ROAD
MARLOW
BUCKINGHAMSHIRE
T: 01628 907000
www.garrettmckee.co.uk

drg.no: 2760 - 11 revision: PL4

FIRST FLOOR PLAN
SCALE 1 : 100

