

- IF THIS DRAWING HAS BEEN RECEIVED ELECTRONICALLY IT IS THE RECIPIENT'S RESPONSIBILITY TO PRINT THE DOCUMENT TO THE CORRECT SCALE.
- ALL DIMENSIONS ARE IN MILLIMETRES UNLESS STATED OTHERWISE. IT IS RECOMMENDED THAT INFORMATION IS NOT SCALED OFF THIS DRAWING.
- THIS DRAWING SHOULD BE READ IN CONJUNCTION WITH ALL OTHER RELEVANT DRAWINGS AND SPECIFICATIONS.

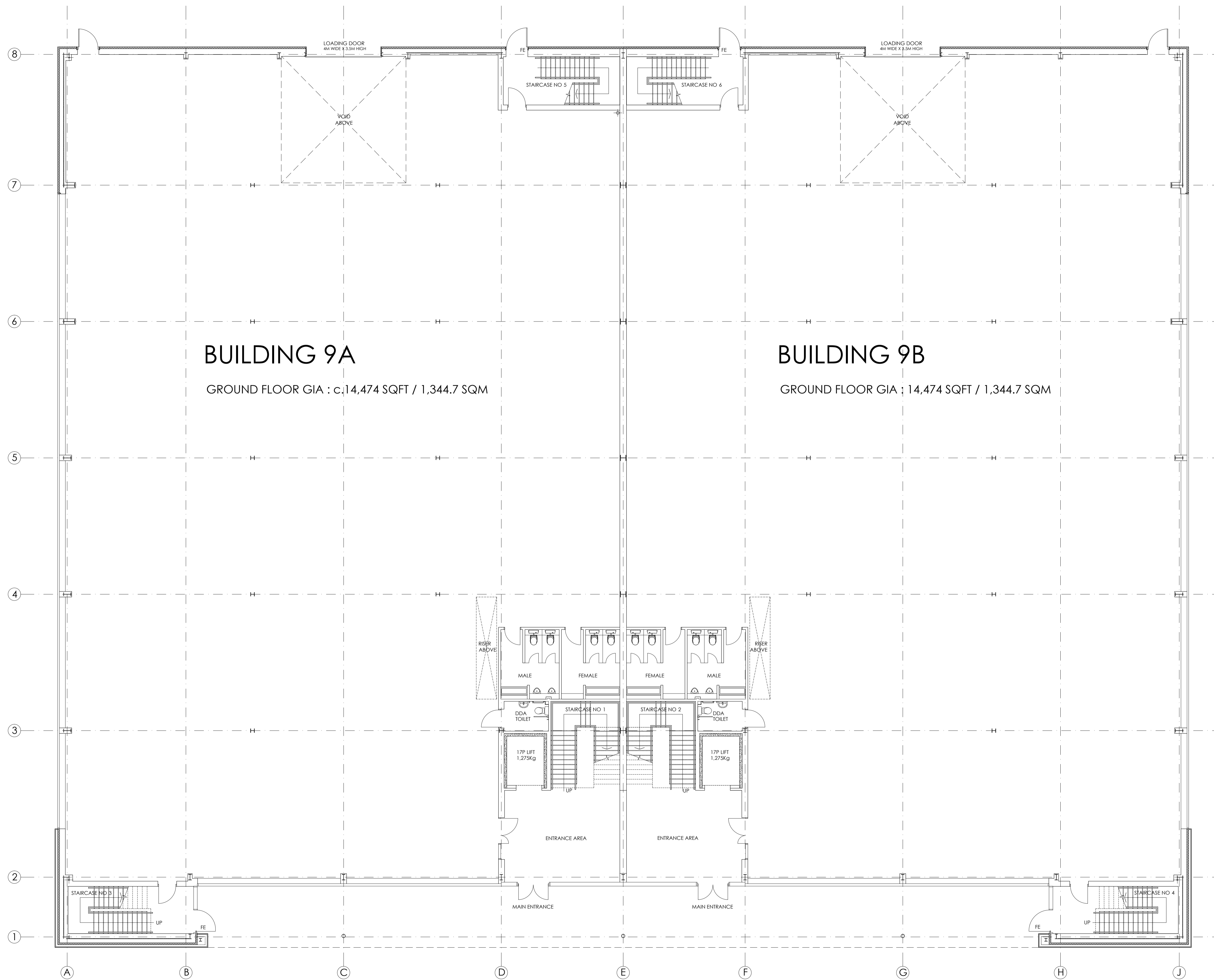

**BUILDING 9A**

GROUND FLOOR GIA : c.14,474 SQFT / 1,344.7 SQM

**BUILDING 9B**

GROUND FLOOR GIA : 14,474 SQFT / 1,344.7 SQM

**PLANNING ISSUE**

PL5	PLANNING ISSUE 5	LT	09.02.23	MD
PL4	PLANNING ISSUE 4	LT	31.01.23	MD
PL3	PLANNING ISSUE 3	LT	10.11.22	MD
PL2	PLANNING ISSUE 2	LT	28.07.22	MD
PL1	PLANNING ISSUE 1	LT	19.07.22	MD

REV. AMENDMENT DRAWN DATE AUTHD

client: HILL STREET HOLDINGS

project: OXFORD TECHNOLOGY PARK

site: LANGFORD LANE  
KIDLINGTON, OXFORDSHIRE

content: BUILDING 9A & 9B  
PROPOSED GROUND FLOOR PLAN

date: JULY 2022

scale: 1 : 100 @ A1

ALL DIMENSIONS TO BE CHECKED ON SITE

**GARRETT | MCKEE**  
ARCHITECTS  
RILEY HOUSE  
RILEY ROAD  
MARLOW  
BUCKINGHAMSHIRE  
T: 01628 907000  
www.garrettmckee.co.uk

drg.no: 2760 - 10 revision: PL5

**GROUND FLOOR PLAN**  
SCALE 1: 100

