

50m JIB

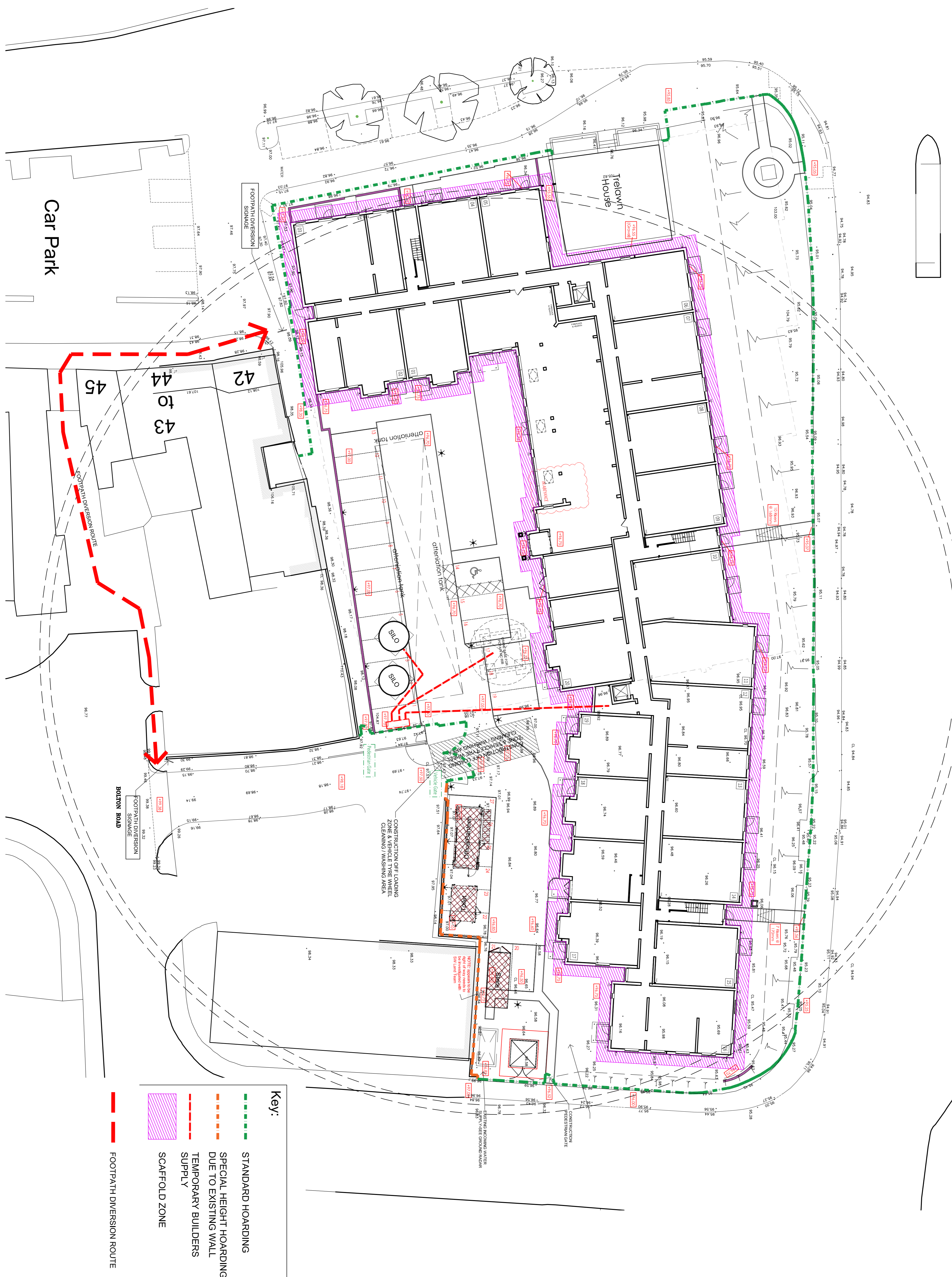

- Key:**
- STANDARD HOARDING
  - SPECIAL HEIGHT HOARDING DUE TO EXISTING WALL
  - TEMPORARY BUILDERS SUPPLY
  - SCAFFOLD ZONE
  - FOOTPATH DIVERSION ROUTE

Revisions	Date	By
Rev. P1 COMMENTS ADDED FROM BUDGET MEETING	03.05.23	CW
A UPDATED TO INCLUDE LPA COMMENTS - washing area	01.06.23	UP
2. Construction pedestrian access points		
3. Footpath diversion sign-off		

F.F.L. = 96.75  
S.S.L. = 96.70

TO BE READ IN CONJUNCTION WITH STRUCTURAL ENGINEER'S DRAWINGS

CONSTRUCTION ISSUE	
Checked by	Date
Approved by	

**COPYRIGHT ACT APPLIES**

NOTE: WHERE ANY CORRECTED OR AMENDED SPECIFICATION IS REQUIRED BY THE ARCHITECT, DRAWING LINES OVERLAP IN WRITING.

ALL DIMENSIONS TO BE CHECKED ON THE WORK TO INCLUDE DIMENSIONS ONLY. REPORT DISCREPANCIES TO THE ARCHITECT AT THE TIME OF THE INSPECTION.

**planning issues**  
ARCHITECTURAL DESIGN

**Cedric M. Tunnicliffe**  
Design Manager  
Churchill Retirement Living  
Birmingham, West Midlands B40 3DQ  
Tel: 0121 707 8288  
Fax: 0121 707 8288  
Email: cedric@churchillretirement.co.uk

**Churchill Retirement Living**

Churchill Retirement Living  
The Churchyard, Sandringham  
Birmingham, West Midlands B40 3DQ  
Tel: 0121 707 8288  
Fax: 0121 707 8288  
Email: enquiries@churchillretirement.co.uk

Project title  
Retirement Living Apartments  
Bolton Road  
Bournville

Drawing title  
Site Setup

Scale	1:200	Date	MARCH 2023
Drawn by	CM	Checked by	ESP
Drawn by No.		Rev.	A
CRL	1011688	202	