



SCALE 1:50 @ A1; 1:100 @A3

Please Note:
 These plans must not be acted upon until the appropriate
 Planning and Building Regulation approvals have been granted.
 Should the works be undertaken prior to the above approvals
 being in place, it is done so entirely at the clients own risk.

Check and verify all dimensions prior to commencement
 of work. This drawing should be read in conjunction
 with all other contract documents including those by
 other consultants.

The survey information shown this drawing is based
 on a survey prepared by a third party and CDS Ltd
 accept no responsibility for the accuracy or
 completeness of the survey. Any discrepancies to be
 reported to CDS Ltd immediately.

This drawing is copyright of and shall remain the
 property of: **Creative Design and Structure Ltd**

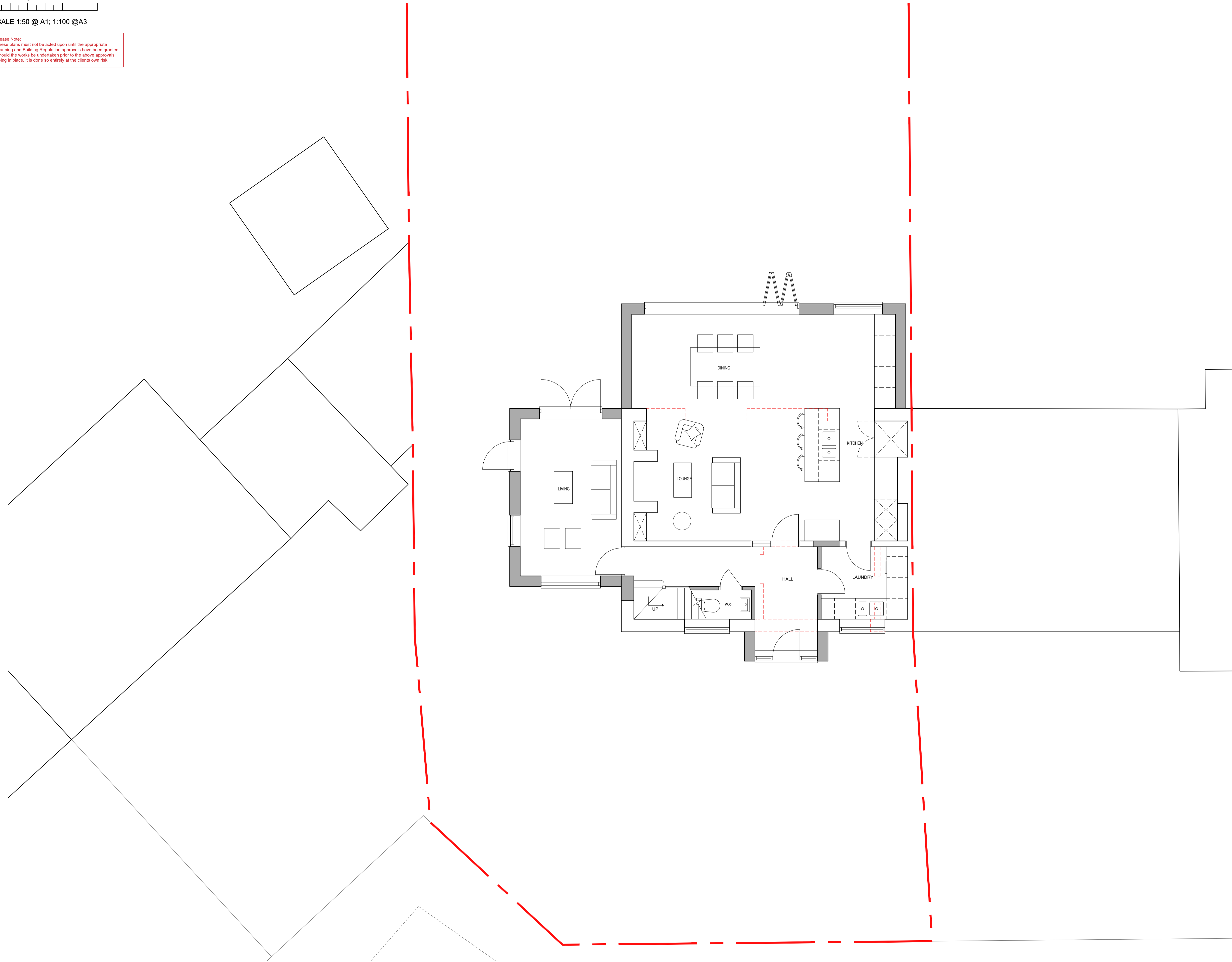

Status: Planning

Project
 12 Jerome Way
 Shipton-on-Cherwell
 KIDLINGTON
 OX5 1JT

Drawing Title
 PROPOSED GROUND
 FLOOR PLAN

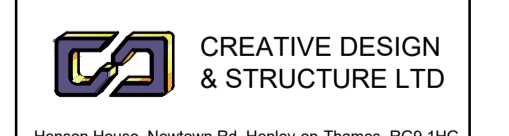

Henson House, Newtown Rd, Henley-on-Thames, RG9 1HG
 T:01491 411922 W: www.creativedesignandstructure.co.uk

Drawn	ED	Scale	1:50 @ A1
Date	FEB 2023		1:100 @ A3

Drawing No.	30222-04	Rev.	
-------------	----------	------	--