

This drawing is the copyright of ngarchitecture. It may not be copied or disclosed to any third party for any purpose except as authorised in writing by ngarchitecture.

Do not scale this drawing. Figured dimensions only are to be used in preference to small scale drawings. All dimensions are to be checked on site before work proceeds. Any errors or omissions are to be reported to ngarchitecture. If in doubt ask.

The contractor is to provide full sized setting out drawings based on information contained in this drawing for ngarchitecture to approve prior to commencing manufacture.

This drawing is to be read in conjunction with all the relevant consultants and / or specialist drawings or documents and any discrepancies or variations are to be notified to ngarchitecture before the affected work commences.

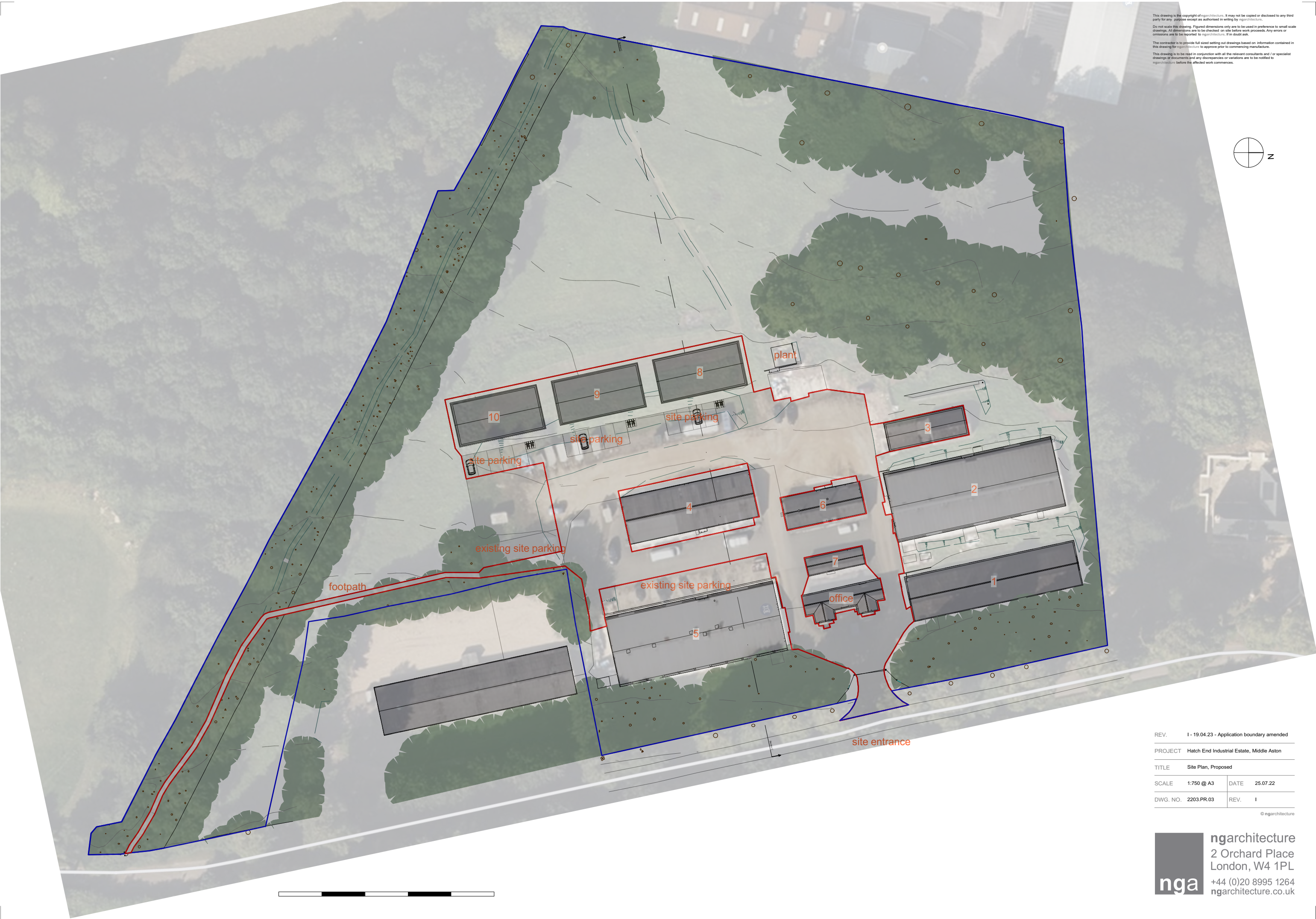

REV.	I - 19.04.23 - Application boundary amended		
PROJECT	Hatch End Industrial Estate, Middle Aston		
TITLE	Site Plan, Proposed		
SCALE	1:750 @ A3	DATE	25.07.22
DWG. NO.	2203.PR.03	REV.	I

© ngarchitecture