

- Notes**
- Do not scale.
 - All levels and dimensions are to be checked on site before any work commences. All dimensions are in metres unless stated otherwise.
 - This drawing has been based upon survey information supplied by 1st Horizon & Oak Surveys and Motion cannot guarantee the accuracy of the data provided.
 - Any discrepancies should be reported to the engineer immediately, so that clarification can be sought prior to the commencement of works.
 - This drawing should be read in conjunction with all other relevant engineering details, drawings and specification.
 - All works to be in accordance with the Specification for Highway Works.
 - Refer to Statutory Undertakers records for details of apparatus present within the construction areas. Chambers are to be adjusted where required to match new levels. The main contractor is to coordinate all diversionary works.
 - It is the responsibility of the main contractor to undertake traffic management in accordance with Chapter 8 of The Traffic Signs Manual and "Safety at Street Works and Road Works". The main contractor is to agree traffic management for the contract with OCC Highway Department prior to commencement of the Works.
 - All supply alterations are to be arranged by the main contractor.
 - All items of street furniture are to remain unless shown otherwise.
 - PCC Kerbs and channels to be in accordance with BS EN 1340:2003 unless otherwise stated.
 - The minimum length for any cut kerb shall be 450mm (Half kerb).
 - Any chamber covers in existing footway which are to become within proposed carriageway are to be reinforced / replaced.
 - On completion the contractor is required to carry out an as-built survey of the completed highway works.
 - For construction details refer to Motion drawing series 2109087-S278-0-0801.
 - Discussion to be held on-site with OCC Engineer at commencement of construction regarding tie-in extent to ensure this does not coincide with unsuitable existing surfacing. Areas shown on the plan considered minimum extent.

Legend

	Existing Highway Boundary
	New Carriageway Asphalt
	Resurface / Regulate Carriageway
	New Footway Asphalt
	New Verges
	PCC HB2 kerb, 125mm upstand
	PCC EF kerb
	Dropped kerb including transitions, 0-6mm upstand
	Buff coloured tactile paving
	Buff coloured corduroy paving

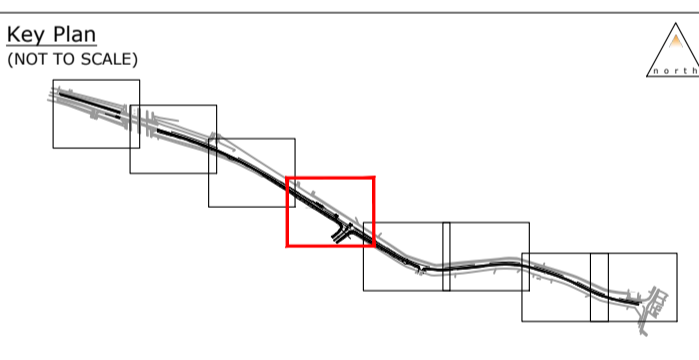

D	Note 16 added	KL	RS	RM	25/07/2022
C	Updated in accordance with OCC comments	RW	RS	RM	10/06/2022
B	Updated drawing following RSA	RW	RS	RM	25/03/2022
A	First Issue	RW	RS	RM	11/03/2022
Revision Notes:		Dm	Chk	App	Date

Drawing Status:
FOR APPROVAL
NOT FOR CONSTRUCTION

motion

84 North Street Guildford Surrey GU1 4AU	9 Greyfriars Road Reading Berkshire RG1 1NU	Golden Cross House 8 Duncannon Street London WC2N 4JF
01483 531300	0118 206 2930	020 7031 8141

www.motion.co.uk

Client: Great Lakes UK Ltd	
Project: Great Wolf Lodge, Bicester	
Title: S278 Highways Works Site Access / A4095 Highway Improvements Construction Areas - Sheet 4 of 8	
Scale: 1:250	Size: A1
Drawing: 2109087-S278-1-0704	Project No: 2109087
Revision:	D

Chesterton Belt

Any longitudinal joints within carriageway surfacing are to be constructed to widths as to be covered by white lining to minimise risk of vehicle tracking. No joints within wheel tracks.

84.7m

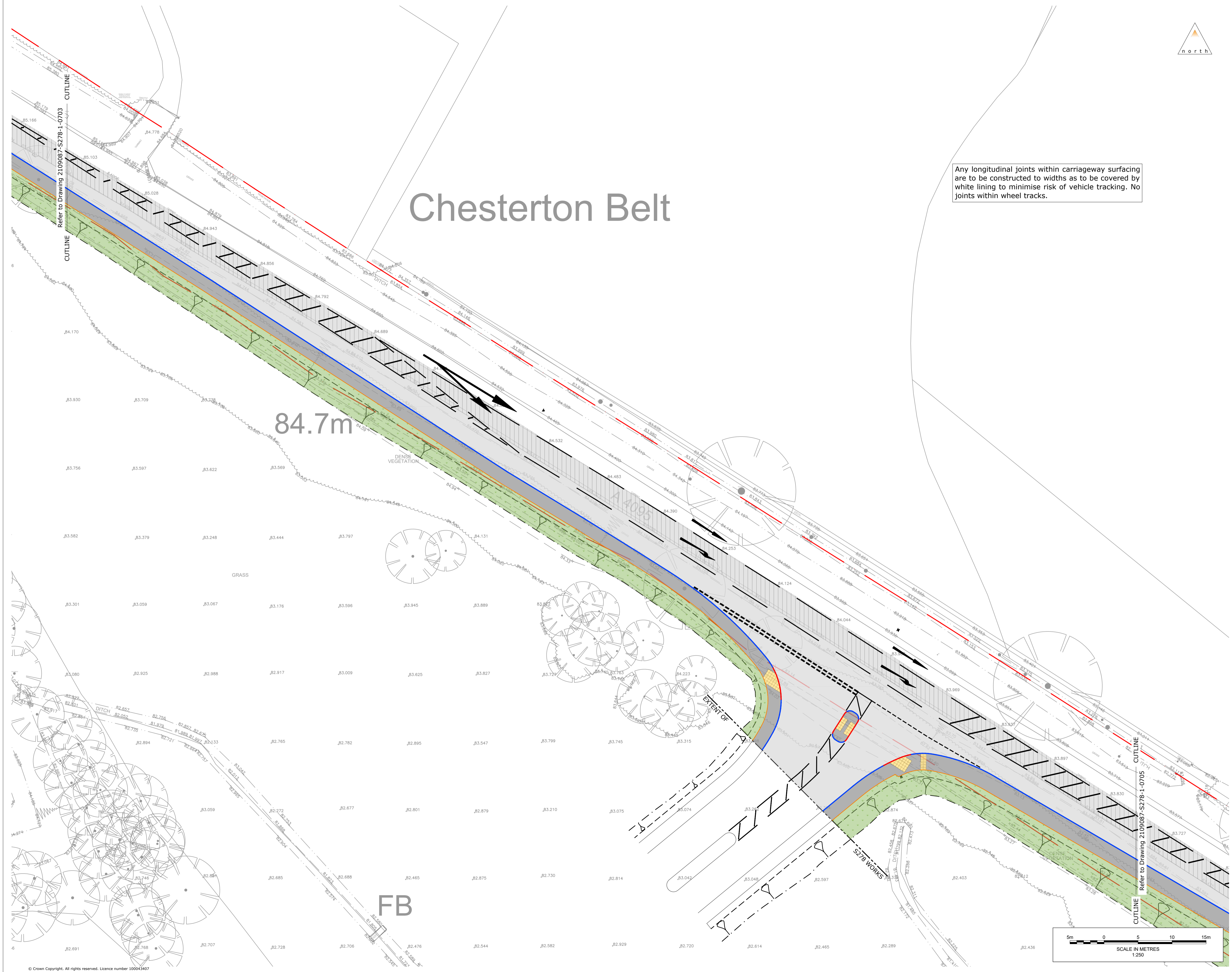

C:\Users\j\OneDrive\Documents\2109087\Drawings\S278-1-0704\Construction Areas.dwg