

Unit 8+9 External Works Layout 1:250

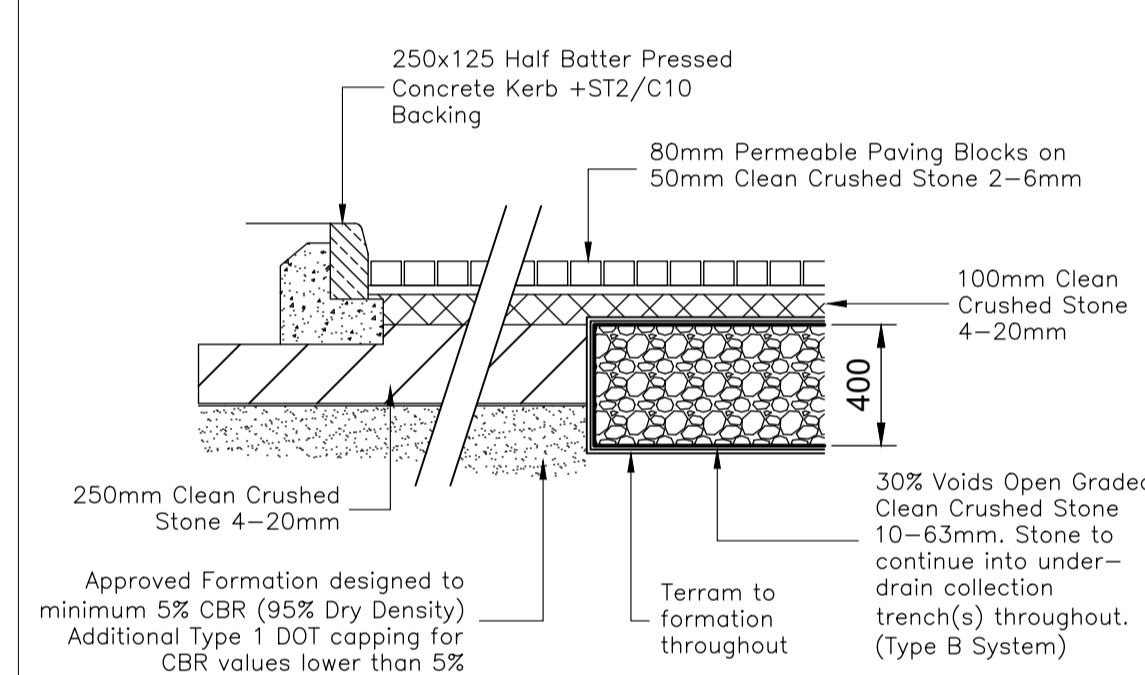

Permeable Block Carpark 1:25

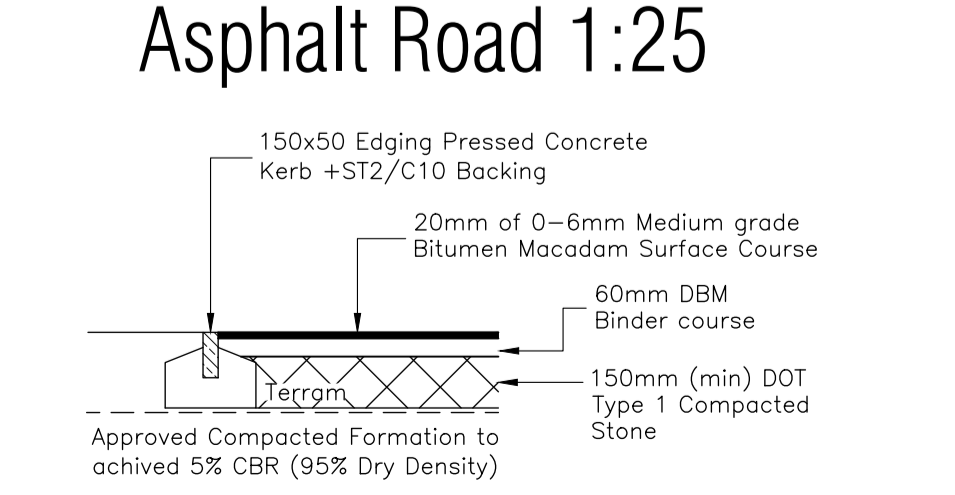
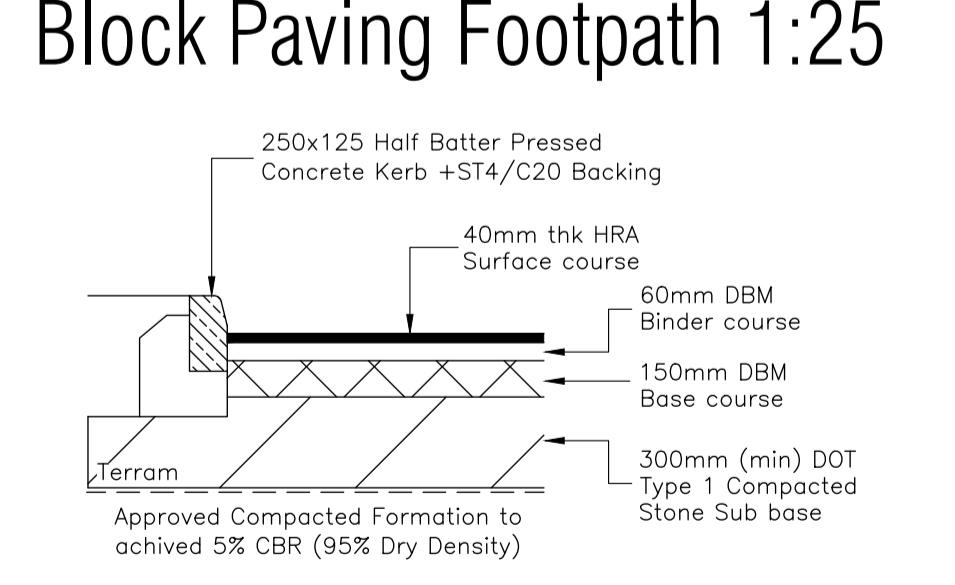
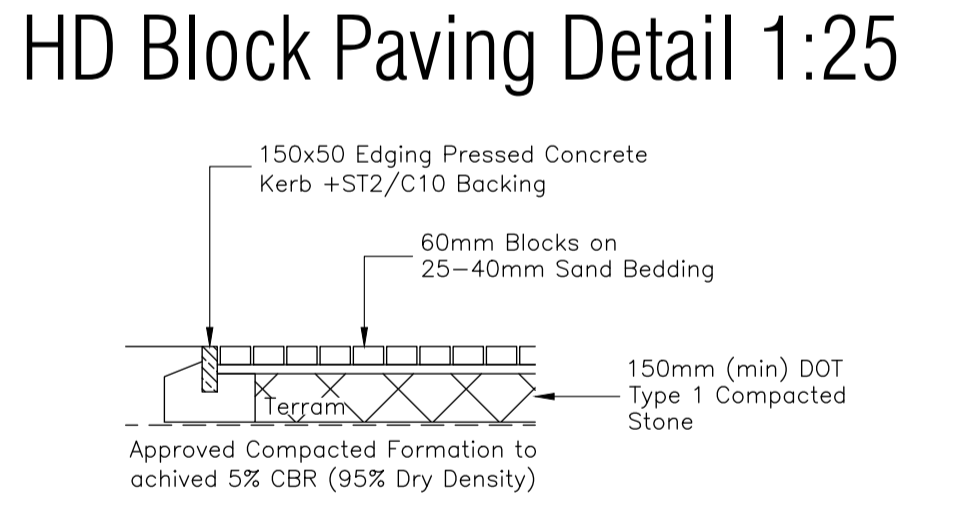
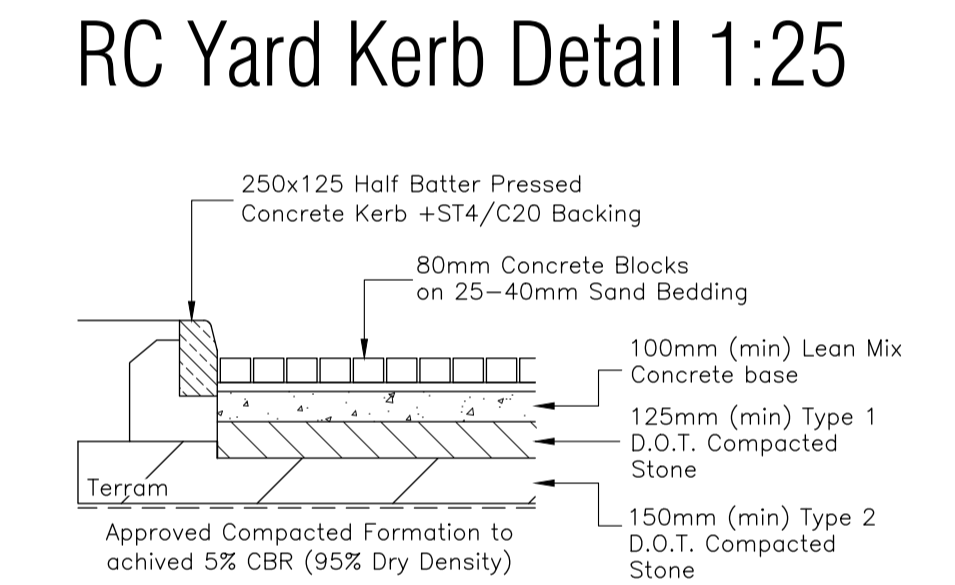
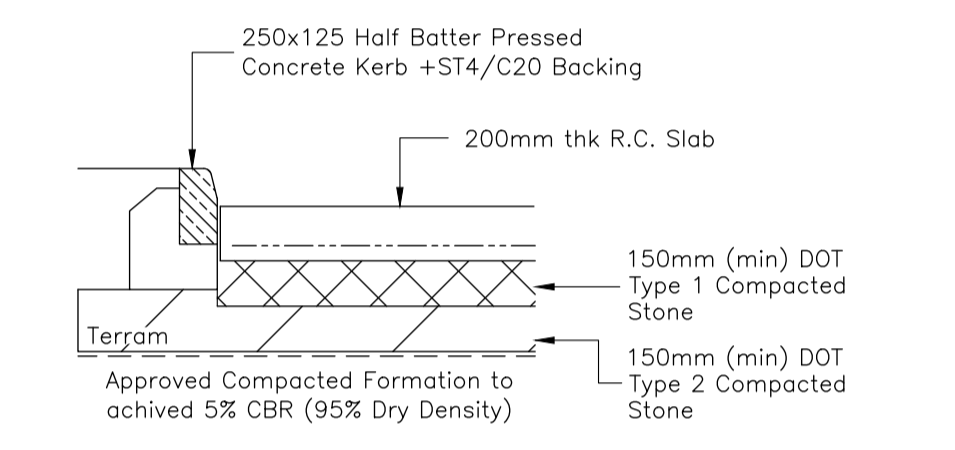
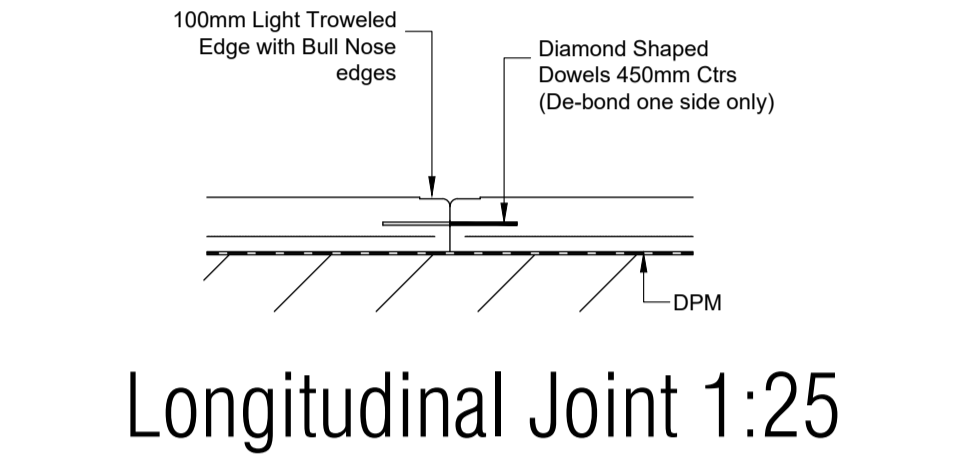
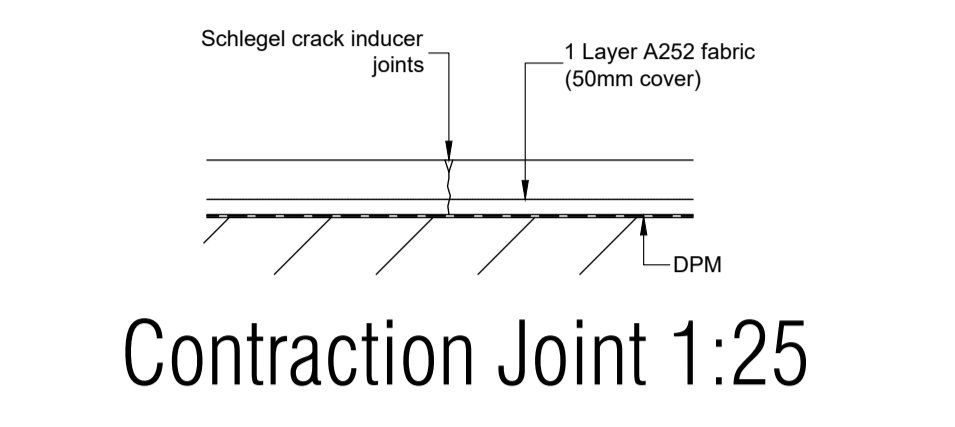
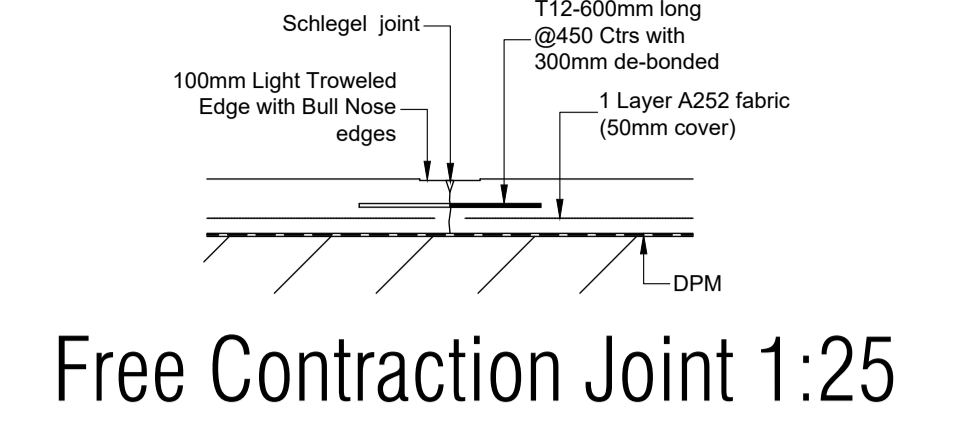
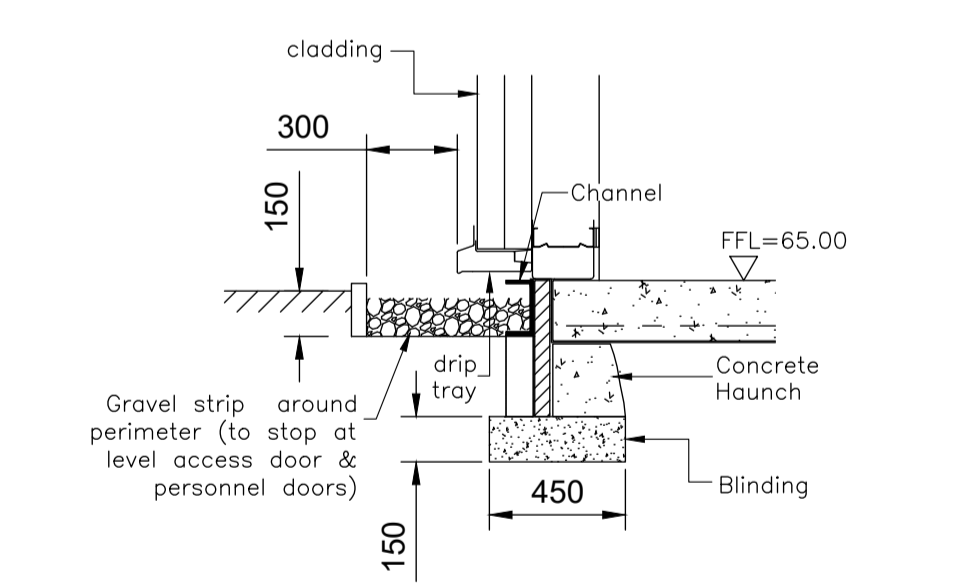

Gravel Strip Detail 1:25

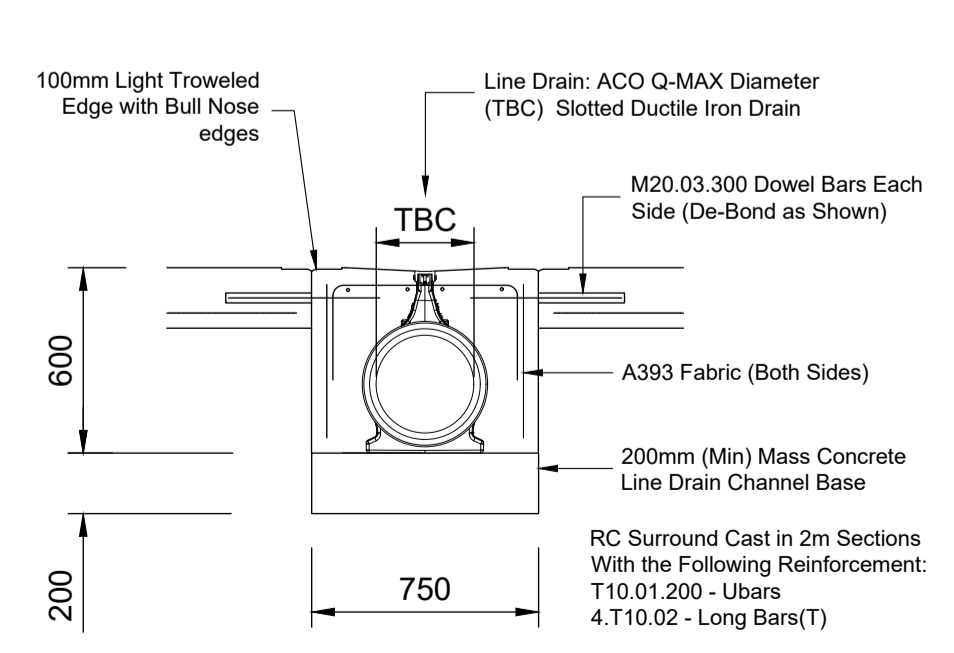

ACO Qmax Detail 1:25

- NOTES**
1. This drawing is to be read in conjunction with all relevant Architects and Bailey Johnson Hayes drawings and specifications.
 2. Do not scale. Work only to figured dimensions.
 3. All dimensions to be confirmed on site prior to commencement of work.
 4. Proposed Site and Finishes Plan from Cornish Architects:- Drawing Ref: 22011 - TP - 001 - E
 5. Topographical Survey by MK Surveys Limited: Drawing Ref: 25646 (Rev 1) - Topographical Survey
 6. Soft Landscaping and planting to be as per Reform (Phase 1) and Laird Bailey (Phases 2) plans and schedules.

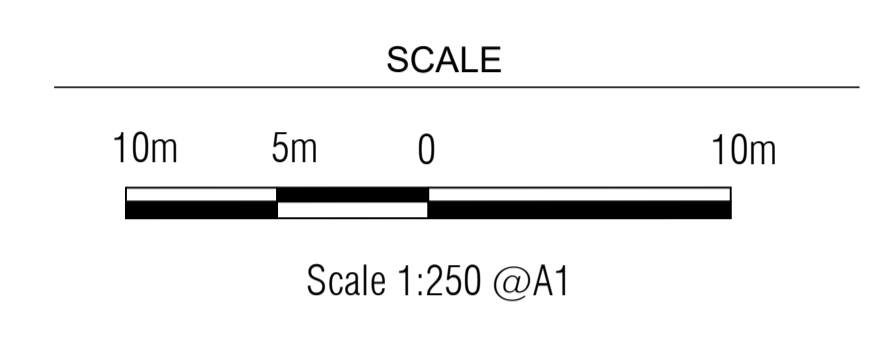

- LEGEND**
- New Office/Production Building
 - 200mm thk RC Yard Slab
 - 80mm HD Block Paving
 - 80mm Permeable Block Paving
 - 60mm Footpath Block Paving
 - Asphalt Estate Road
 - Bitmac Footways

TOWN PLANNING

Rev	Date	Revision Description
A	17.01.23	Minor Revs to LLFA comments

Revision Schedule

Project Title
Catalyst Bicester
Wendlebury Road, Bicester



Drawing Title
PHASE 2
Unit 8-9 External Works

BAILEY JOHNSON HAYES
Consulting Engineers

Scale	1:250 @A1	Drawing Number	S1358-PH2-10 A
Date	24.11.22		
Drawn	DC		

ST ALBANS: Suite 4, Phoenix House, 63 Campfield Rd, ST ALBANS, Herts AL1 5FL
MANCHESTER: Grange House, John Dalton Street, MANCHESTER, M2 6FW