

WHY TREE PROTECTION IS NEEDED

- 1) **Soil compaction kills roots**- caused by plant movement and storage of materials within protected areas.
- 2) **Trenching severs roots**- many small roots grow within the top 600mm of soil. Even the removal of the top 200mm can cause damage.
- 3) **Soil pollution kills roots**- Dripping fuel storage or cement washings can contaminate the soil resulting in root death.
- 4) **Raising & lowering levels kills roots**- the soil used to increase levels can compact the underlying soil (see point 1). Lowering levels will remove roots causing damage to the tree.
- 5) **Bark and branch damage**- bark removal and branch damage can allow disease and fungi into the tree.

The impact of any of the above can take years to show- trees can have huge reserves of food and water.

CONSTRUCTION EXCLUSION ZONE

Root protection areas (RPA) of retained trees within which all construction activity is restricted.

All trees that are being retained on site must be protected by barriers and/or ground protection before any materials or machinery are brought onto the site, and before any demolition, development or stripping of soil commences. Where all activity can be excluded from the RPA, vertical barriers must be erected to create a construction exclusion zone. Where, due to site constraints, construction activity cannot be fully or permanently excluded in this manner from all or part of a tree's RPA, appropriate ground protection can be installed.

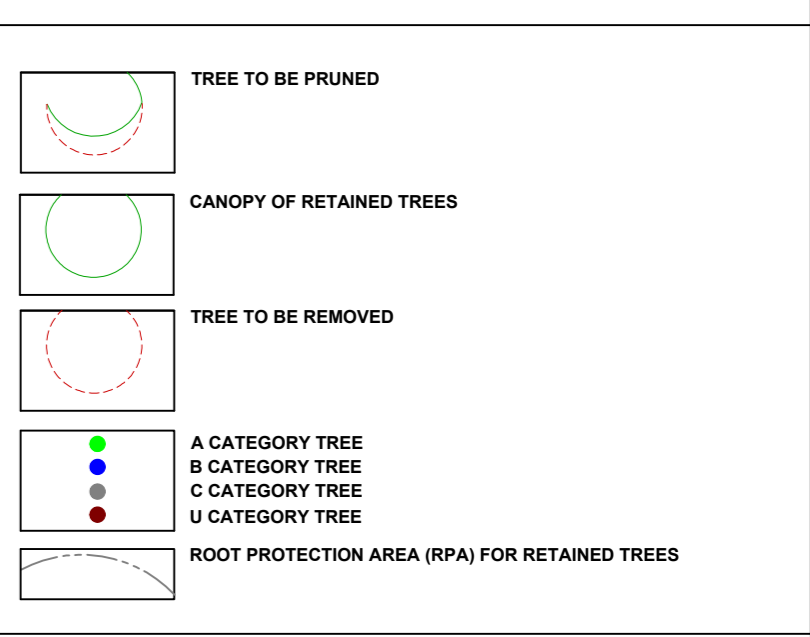
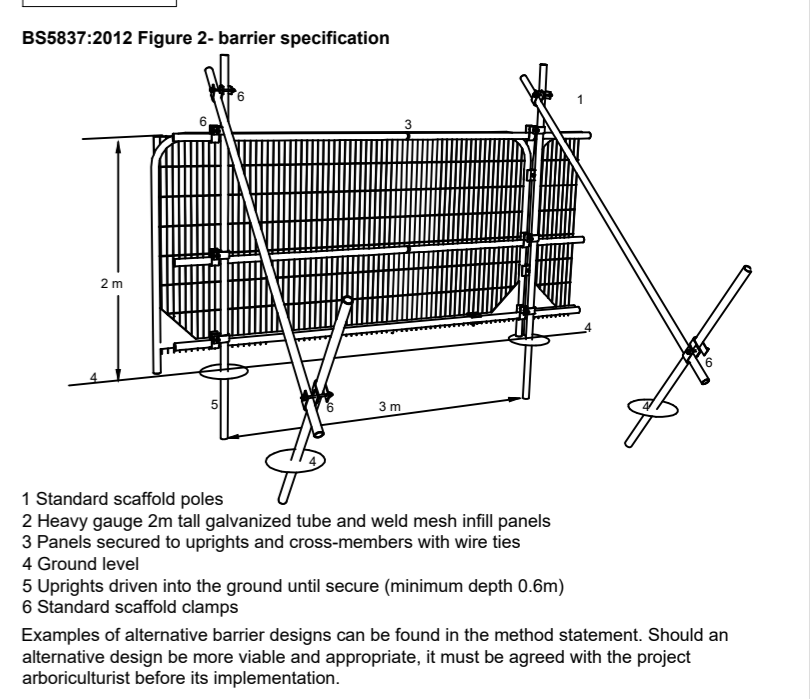

The original of this drawing was produced in colour- a monochrome copy should not be relied upon.

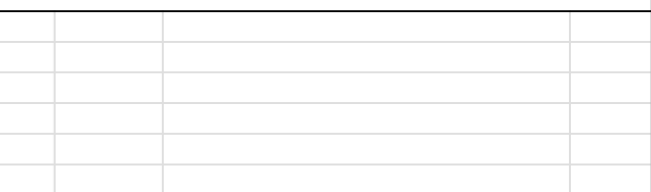

A Rev	Date	Revised layout Details	CJC Drawn

ACD ENVIRONMENTAL

HEAD OFFICE
 Rodbourne Rail Business Centre, Grange Lane,
 Malmesbury, SN16 0ES
 Tel: 01666 825646

4 & 5 The Old Mill, Fry's Yard, Bridge Street,
 Godalming GU7 1HP
 Tel: 01483 425714

Suite 6, Crescent House, Yonge Close,
 Eastleigh, SO50 9SX
 Tel: 02382 026500

email: mail@acdenv.co.uk
 www.acdenvironmental.co.uk

Copyright of ACD. All rights described in Chapter IV of the Copyright, Designs and Patents Act 1988 have been generally asserted. 2015. Copyright of this plan remains with ACD until all fees have been paid in full.

scheme: Land off Berry Hill Road, Aderbury Banbury
 client: Hayfield Homes
 drawing: Tree Protection Plan
 date: March 2022
 scale: 1:500@A1
 dwg no: HAY23648-03A
 drawn: CJC checked: AJB