

Manhole Number	Cover Level	Connections	Pipe			Manhole Size	Types		
			Code	Inverts	Diams Inv-soff		Manhole	Cover	
S19	123.600	1	1	From tank	121.450	300	1800	Type 2	D400
	1.850			0	20.000	121.450			
S19a	123.670	1	2	20.000	121.393	300	1200	Type 2	D400
	1.977			0	21.000	121.393			

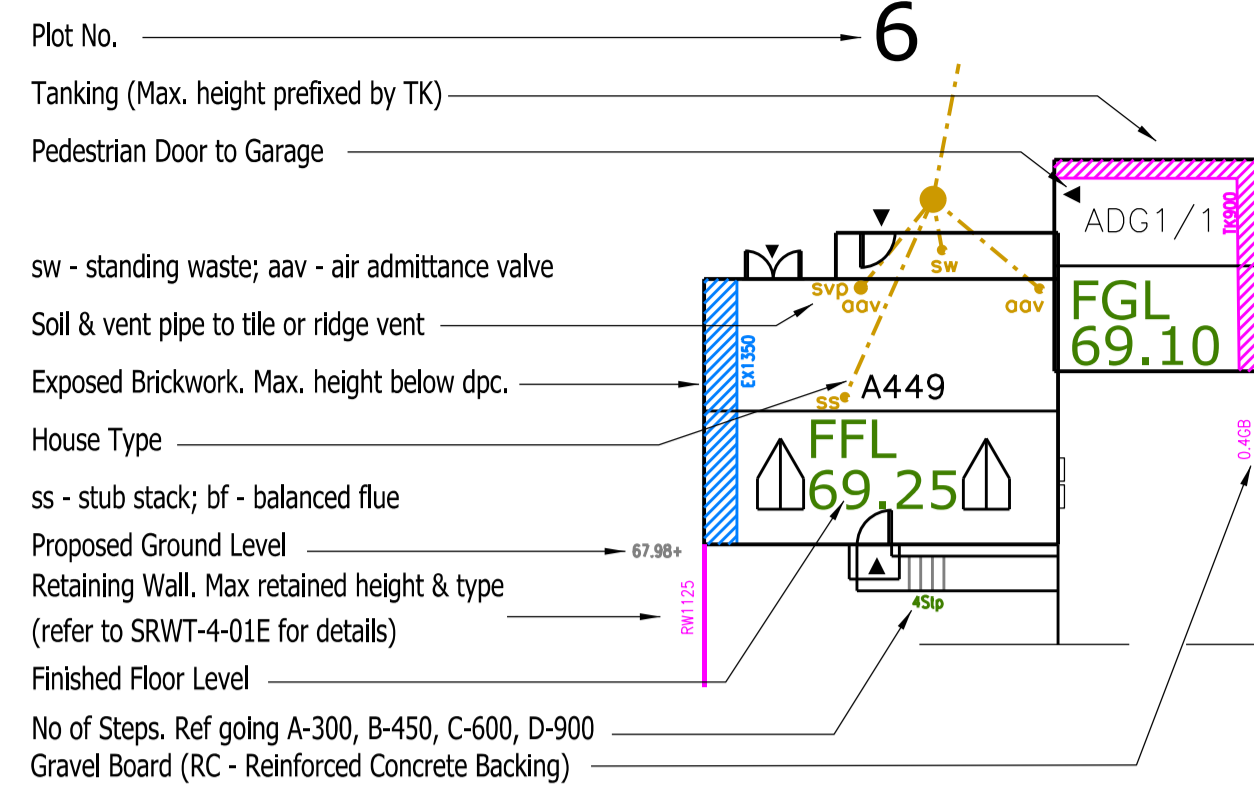

FOR LOCATION OF POSITION AND DESIGN OF THE GREEN-TECH ARBORRAFT SYSTEM, REFER TO LIZ LAKES DRAWING 1619 SC 01

- NOTES**
- Contractors must check all dimensions on site. Only figured dimensions are to be worked from. Discrepancies must be reported to the architect or engineer before proceeding. © This drawing is copyright.
 - Reproduced from OS Sitemap © by permission of Ordnance Survey® on behalf of The Controller of Her Majesty's Stationery Office. © Crown copyright 2008. All rights reserved. Licence number 100007126.
 - Until technical approval has been obtained from the relevant authorities, all drawings are issued as preliminary and not for construction. Should the contractor commence site work prior to approval being given it is entirely at his own risk.
- KEY**
- Existing Adoptable Foul Sewer
 - Existing Adoptable Surface Water Sewer
 - Private Foul I.C. (4500) Non Entry neck of 330mm dia. where Depth to invert 1000mm+
 - Private Storm I.C. (4500) Non Entry neck of 330mm dia. where Depth to invert 1000mm+
 - Rodding Eye
 - Proposed gully
 - Drainage Channel to be ACO MultiDrain MD or similar approved
 - Slab on Edge used in place of Gravel Board due to aesthetics
 - Existing Lighting columns unless described otherwise

UNTIL TECHNICAL APPROVAL/ ACCEPTANCE OF THE FOOTPATH ALTERATIONS HAVE BEEN OBTAINED FROM THE RELEVANT AUTHORITIES, ALL DRAWINGS ARE ISSUED AS PRELIMINARY AND NOT FOR CONSTRUCTION. SHOULD THE CONTRACTOR COMMENCE WORKS IN THESE AREAS PRIOR TO APPROVAL BEING GIVEN IT IS ENTIRELY AT HIS OWN RISK.

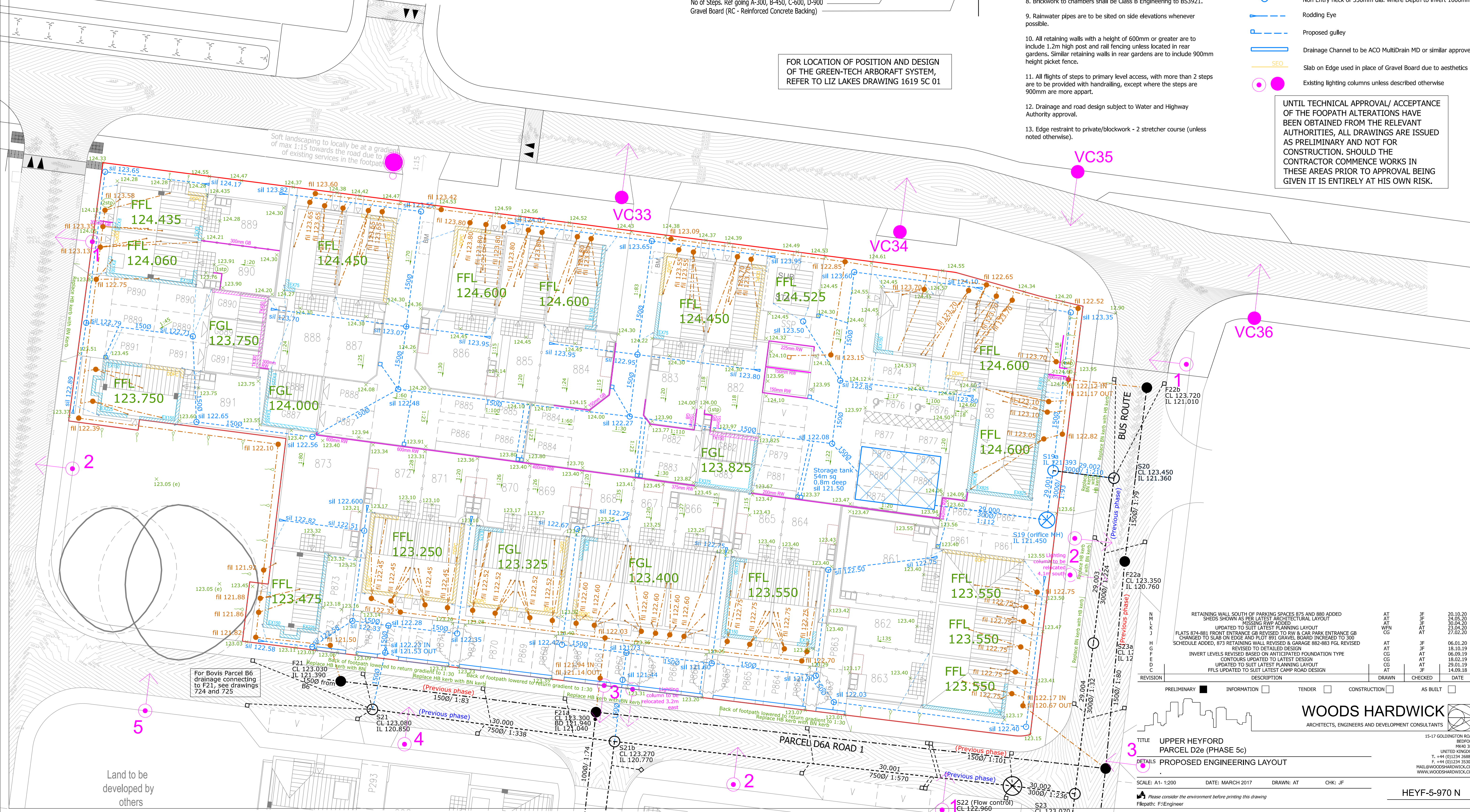

REVISION	DESCRIPTION	DRAWN	CHECKED	DATE
AT	JF	20.10.20		
AT	JF	24.05.20		
AT	JF	30.04.20		
AT	WFN	23.04.20		
AT	CG	22.02.20		
AT	JF	06.01.20		
AT	JF	18.10.19		
AT	CG	06.09.19		
AT	CG	18.02.19		
AT	CG	29.01.19		
AT	JF	14.09.18		

WOODS HARDWICK
ARCHITECTS, ENGINEERS AND DEVELOPMENT CONSULTANTS

15-17 GILDINGTON ROAD
BEDFORD
MK40 3JH
UNITED KINGDOM
T. +44 (0)1234 268862
F. +44 (0)1234 353034
MAIL@WOODSHARDWICK.COM
WWW.WOODSHARDWICK.COM

TITLE: UPPER HEYFORD
PARCEL D2e (PHASE 5c)
DETAILS: PROPOSED ENGINEERING LAYOUT

SCALE: A1-1:200 DATE: MARCH 2017 DRAWN: AT CHK: JF

Please consider the environment before printing this drawing
Filepath: F:\Engineer

HEYF-5-970 N