

Design Data.

- Material: mild & Carbon steel
- Finish: Galvanised
- Fasteners: A4 Stainless steel
- Mod, fixings: A4 stainless steel
- Wind loading: 45metres per second

Suitable for solar panels up to a width of 1062mm
Supplied c/w M6 & M8 module mounting fasteners.

Modular design allows for up to 12 modules per structure, using the 2 module extensions. The maximum number of modules per structure will depend upon the suitability of the ground level.

Ground poles to be installed using a suitable post hammer.

Concrete foundation version also available.

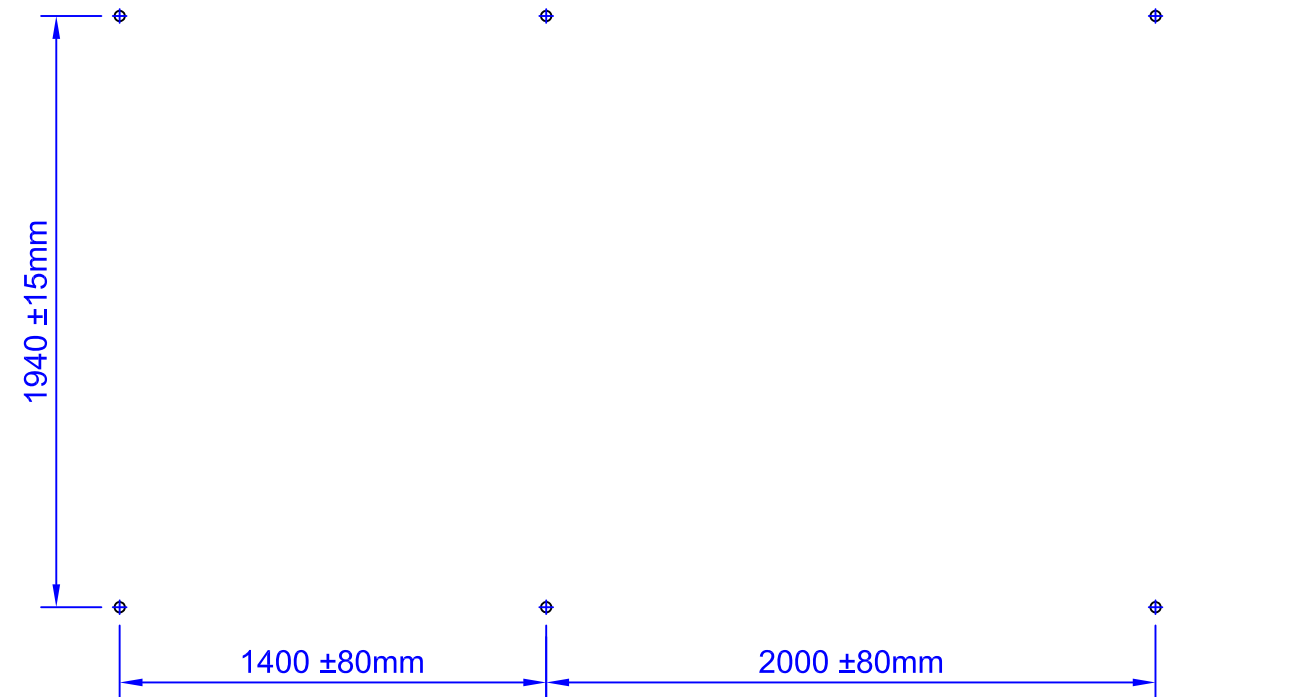
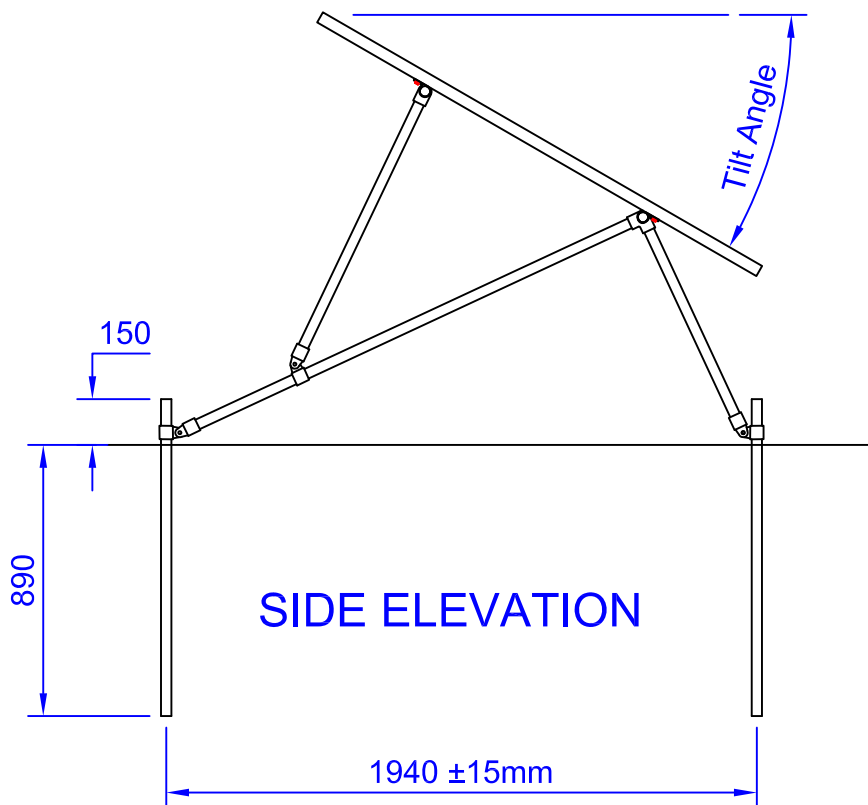

PLAN

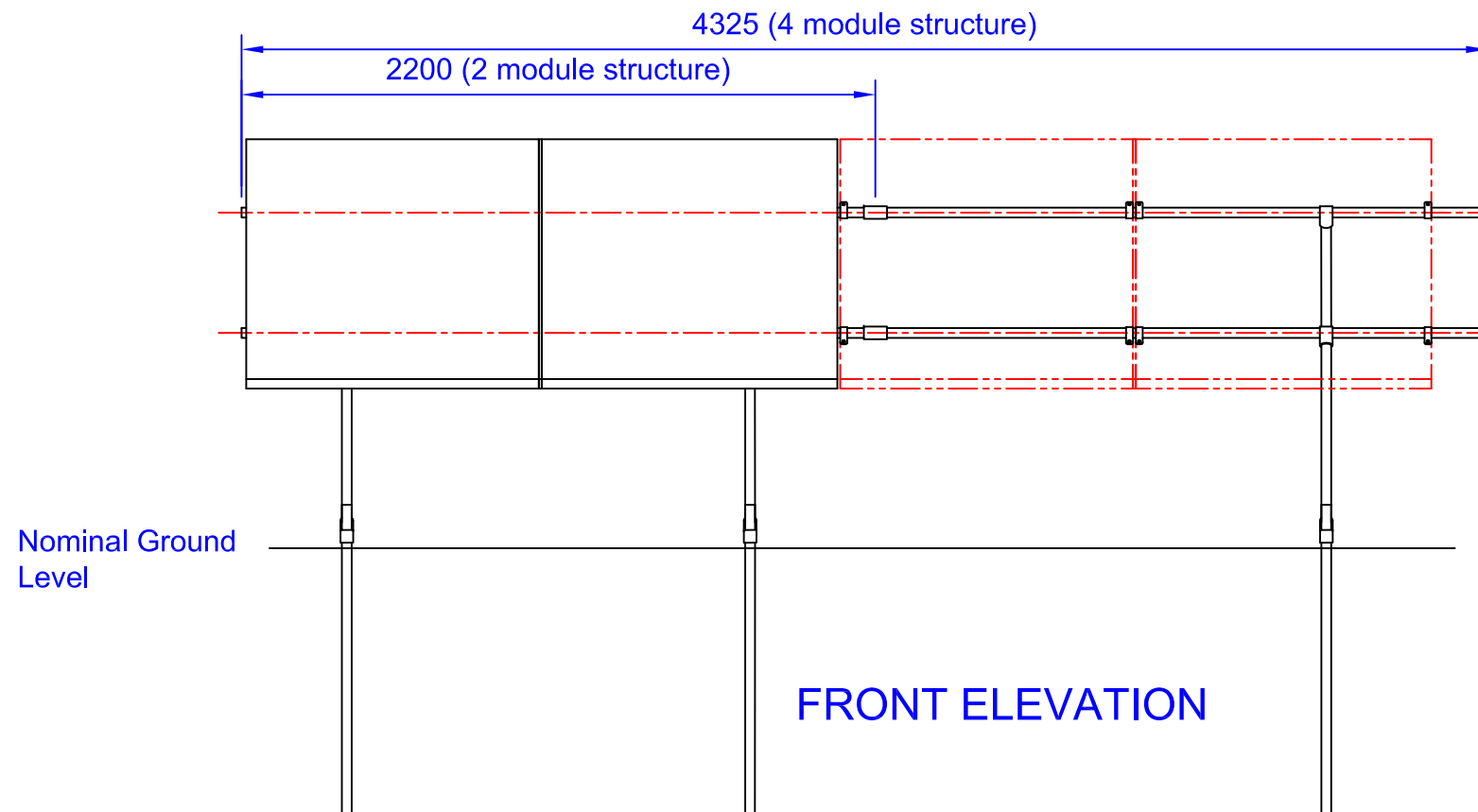

FRONT ELEVATION

Nominal Ground Level

Tolerances.
NO D.Point ±1mm
1 D.Point ±0.5mm
2 D.Points ±0.2mm

1	T Brooks	25.06.2021	Production Issue
ISSUE	DRAWN BY	DATE	CHANGE

DO NOT SCALE

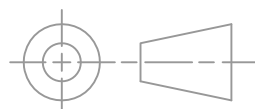

© 2021

This drawing is copyright and the property of BDS, it must not be copied in whole or in part, used for manufacture or otherwise disclosed without prior consent of BDS.

Material.

Finish.

**Tm Type low level
Modular
Ground Mount Structure Kit**
NON-FOUNDATION VERSION

Product Type
Tm Type

No.
001 059