

**Sketch Plan**

Showing:

1 White Horses Close

2 White Horses Close

3 White Horses Close—known as  
Maplewood

**The Walnut Tree we wish to have  
reduced is shown in green, and la-  
belled A.**

Other trees on our property are  
shown as blue circles.

Some of the other trees in neigh-  
bouring properties are shown in  
yellow.

I estimate the diameter of the tree  
canopy to be approximately 12 me-  
tres—though the diameter varies,  
depending on branches.

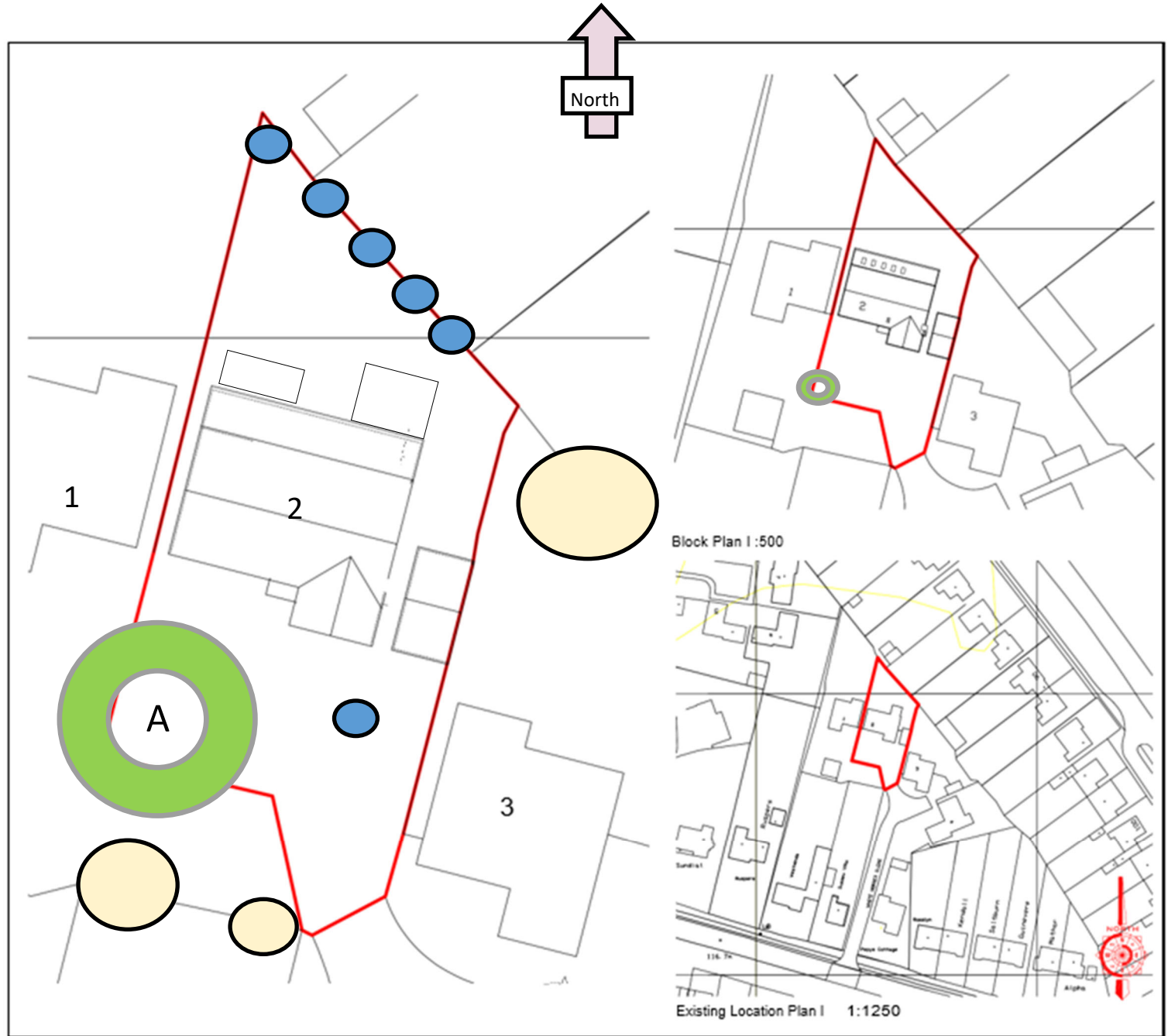

View of the Walnut tree, 2 White Horses Close.

Our property is the house on the right of the picture. The tree overhangs our neighbour's garden and drive.

Bottom left of the picture is our neighbour's car (Number 1 White Horses Close.)

We have been concerned, in windy weather, about debris falling on his car. We have had fairly sizeable branches dropped in the autumn.

When we last applied for and had the tree pruned, in the summer of 2007, we were advised by a visitor from the council that it was in decline, though though it might take a number of years.

If it were considered appropriate, we are happy to have the tree removed and plant another tree.

