

Appendix 1 Introduction

- 1.1 Site Location**
- 1.2 Parameter Plans**
- 1.3 Project Teams**



Information contained within this drawing is the sole copyright of Atelier Gooch Ltd. and is not to be reproduced without express permission. No implied licence exists. This drawing not to be used for land transfer or valuation purposes. All dimensions & levels are to be checked on site by the contractor. Issued for purposes indicated only. Drawing errors and omissions to be reported to the architect.

Key Plan

KEY

- Site Boundary
- Site by others
- Existing Buildings
- Existing Water tanks/ Reservoirs
- Existing Concrete hardstanding
- Existing Services
(Substation, Generators, Thames water pump)

GENERAL NOTE

Site Area : 311,088m² (76.87 Acres / 31.11 Hactare)

- P7 28/04/2022 DRAFT FOR PLANNING (OUTLINE)
- P6 10/03/2022 FOR PLANNING (DEMO)
- DRAFT 09/03/2022 DRAFT FOR COMMENTS
- P5 17/09/2021 DRAFT FOR PRE-APP
- P4 26/02/2021 PRE-APP ELL SITE ADDED
- P3 04/11/2020 SITE BOUNDARY FINALISED
- P2 20/05/2020 SITE BOUNDARY UPDATED
- P1 15/05/2020 FOR INFORMATION

Revisions

ateliergooch

Rivington House · 82 Great Eastern Street · London · EC2A 3JF
+44 (0) 7985 524 080
studio@ateliergooch.com
ateliergooch.com

Client
Graven Hill Purchaser Ltd
Project
Graven Hill D1 Site, Bicester
Project No.
410

Drawing Title
Site Location Plan

Status	Drawn	Checked
PLANNING	JH	GO
Scale	Date	
1:2500 @A1	May 2020	
Drawing Number	Revision	
410_S-00	P7	

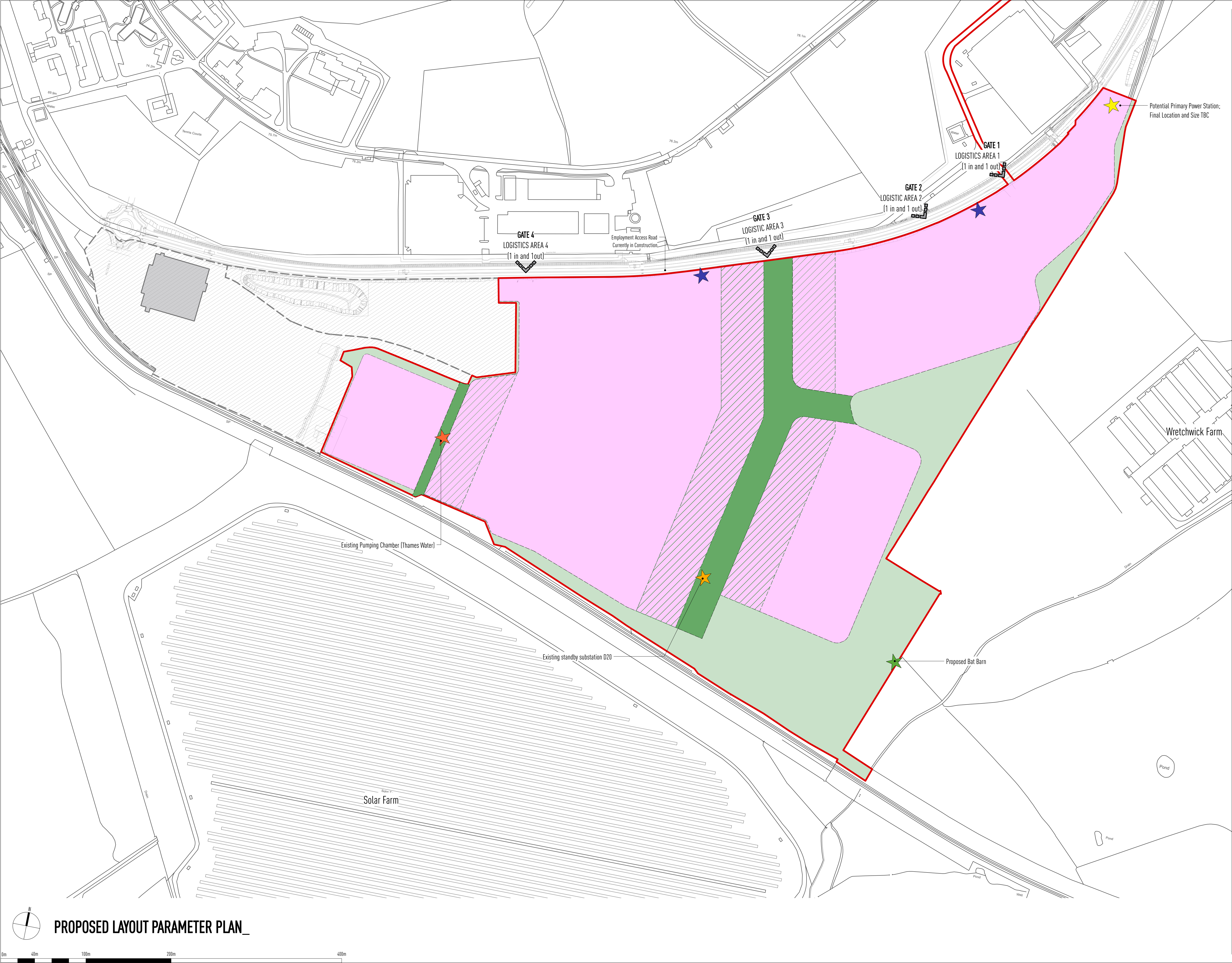

Information contained within this drawing is the sole copyright of Atelier Gooch Ltd. and is not to be reproduced without express permission. No implied licence exists. This drawing not to be used for land transfer or valuation purposes. All dimensions & levels are to be checked on site by the contractor. Issued for purposes indicated only. Drawing errors and omissions to be reported to the architect.

KEY

- Site Boundary
- Extent of Employment Allocated Land
- Structural Landscape planting including Existing woodlands, Proposed Amenity and Sustainable Drainage System (SuDS)
- Indicative route of Green fingers/ wildlife corridors; Final location /extent to be determined at Reserved Matters Stage
- Parameter of Green fingers/ wildlife corridors; Final location /extent to be determined at Reserved Matters Stage
- Development Area; including roads, parking and service yards; Max. 20m Ridge Height Details at Reserved Matters Stage 227,511m² (2,448,908 ft²)
- Existing D20 Substation
- Existing Thames Water Pumping Station
- New Sub-stations (as part of EAR Dev.)
- New Bat Barn
- Indicative location for Potential Primary Power Station

Refer to 410_S-50 Indicative Proposed Plan and ABA's Transport Report for detailed Gate/ Entrance Layout

P2 10/05/2022 FOR COMMENTS
P1 09/05/2022 FOR DISCUSSION

Revisions

ateliergooch
Rivington House · 82 Great Eastern Street · London · EC2A 3JF
+44 (0) 7985 524 080
studio@ateliergooch.com
ateliergooch.com

Client
Graven Hill Purchaser Ltd
Project
Graven Hill D1 Site, Bicester
Project No.
410

Drawing Title
PROPOSED LAYOUT PARAMETER PLAN

Status	Drawn	Checked
PRELIMINARY	JH	GO
Scale	Date	
1:2000 @A1	MAY 2022	
Drawing Number	Revision	
410_S-51	P2	

FOR CONTINUATION, SEE DRAWING 1923/50/011

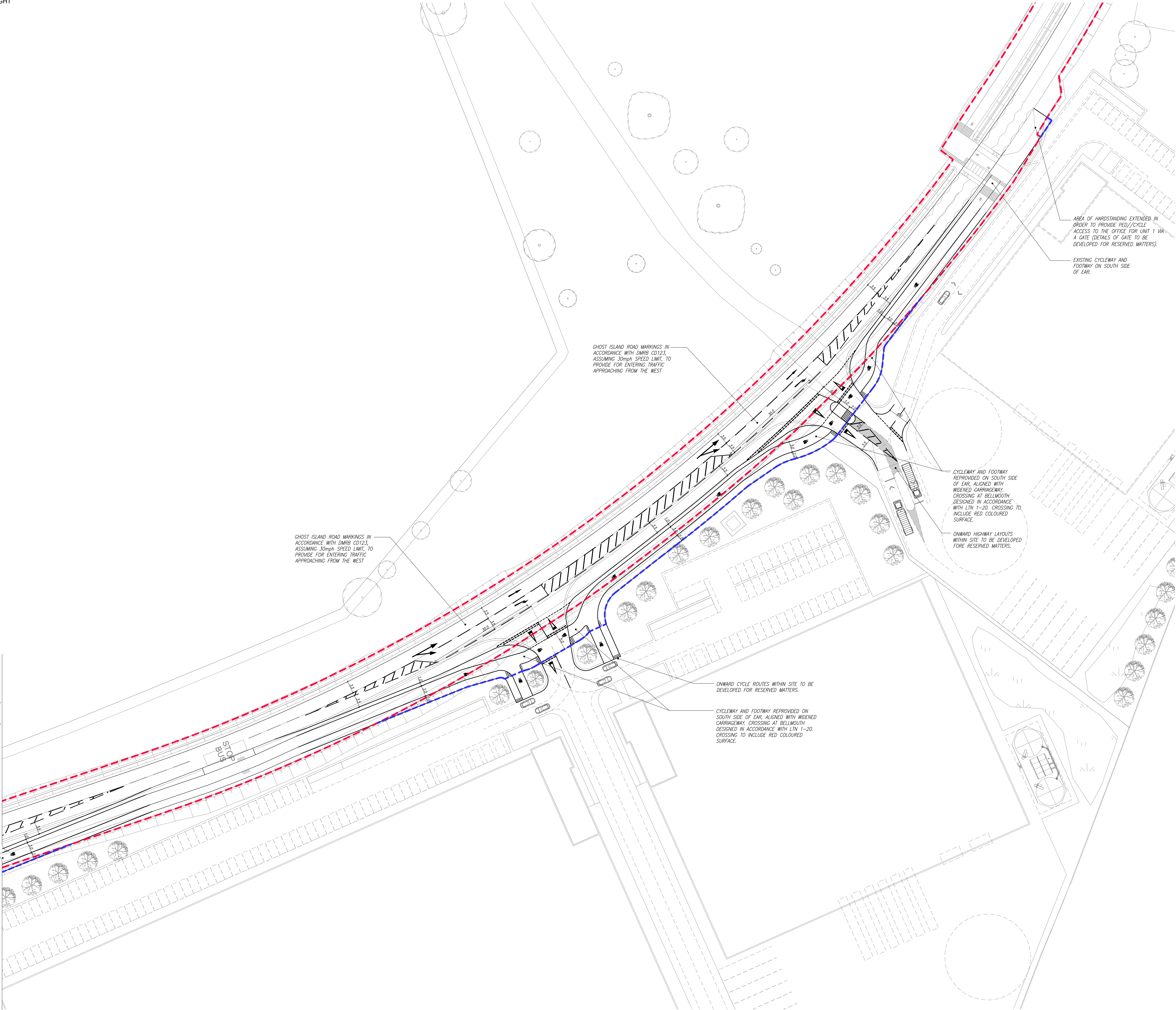

- notes
- THIS DRAWING IS TO BE READ IN CONJUNCTION WITH ALL RELEVANT ARCHITECT'S AND ENGINEER'S DRAWINGS AND THE SPECIFICATION.
 - DO NOT SCALE FROM THIS DRAWING.
 - KEY:
 - EXISTING EAR ADOPTION BOUNDARY.
 - SUGGESTED ADDITIONAL ADOPTION BOUNDARY.

FOR INFORMATION ONLY

D	01.06.22	BACKGROUND UPDATED.	MBr
C	13.05.22	ROAD MARKINGS UPDATED.	MBr
B	22.04.22	BACKGROUND UPDATED.	MBr
A	01.04.22	CYCLEWAY AMENDED.	MBr
	23.03.22	ISSUED FOR INFORMATION.	MBr

job
GRAVEN HILL,
BICESTER

title
EMPLOYMENT ACCESS ROAD,
GATE 1 & 2 HIGHWAY IMPROVEMENTS,
FUTURE SCENARIO

drawn UJ	checked MBr
date MAR'22	scale (original - A1) 1:500

Alan Baxter

75 Cowcross Street London EC1M 6EL
tel 020 7250 1555
email aba@alanbaxter.co.uk

www.alanbaxter.co.uk

dig. no. 1923/050/010	rev. D
--------------------------	-----------

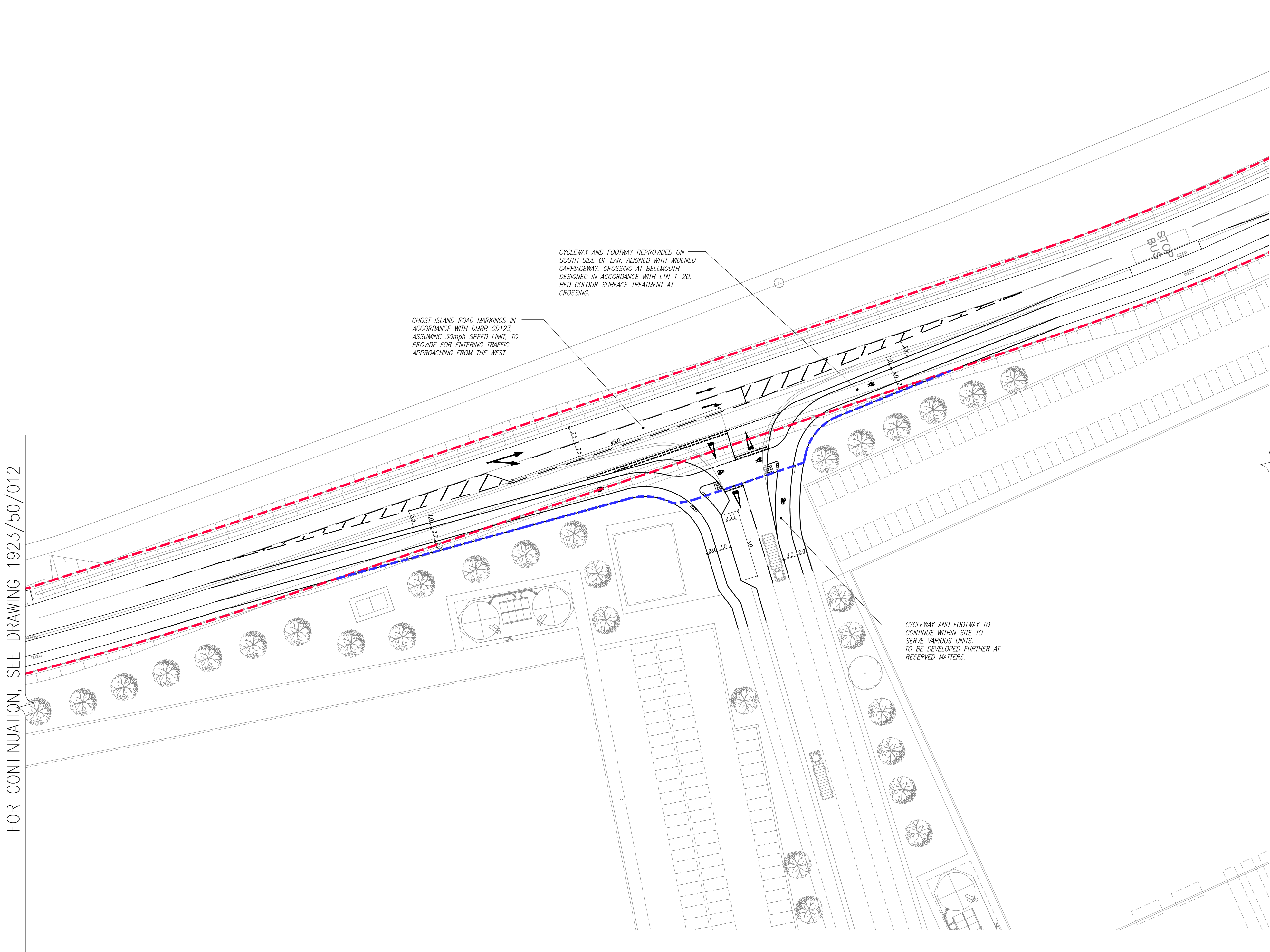

- notes
- THIS DRAWING IS TO BE READ IN CONJUNCTION WITH ALL RELEVANT ARCHITECT'S AND ENGINEER'S DRAWINGS AND THE SPECIFICATION.
 - DO NOT SCALE FROM THIS DRAWING.
 - KEY:
 - EXISTING EAR ADOPTION BOUNDARY.
 - SUGGESTED ADDITIONAL ADOPTION BOUNDARY.

FOR INFORMATION ONLY

C	01.06.22	BACKGROUND UPDATED.	MBr
B	22.04.22	BACKGROUND UPDATED.	MBr
A	01.04.22	CYCLEWAY AMENDED.	MBr
	23.03.22	ISSUED FOR INFORMATION.	MBr

job
**GRAVEN HILL,
BICESTER**

title
**EMPLOYMENT ACCESS ROAD,
GATE 3 HIGHWAY IMPROVEMENTS,
FUTURE SCENARIO**

drawn UJ	checked MBr
date MAR'22	scale (original - A1) 1:500

Alan Baxter

75 Cowcross Street London EC1M 6EL
tel 020 7250 1555
email aba@alanbaxter.co.uk

www.alanbaxter.co.uk

dig. no. 1923/050/011	rev. C
---------------------------------	------------------

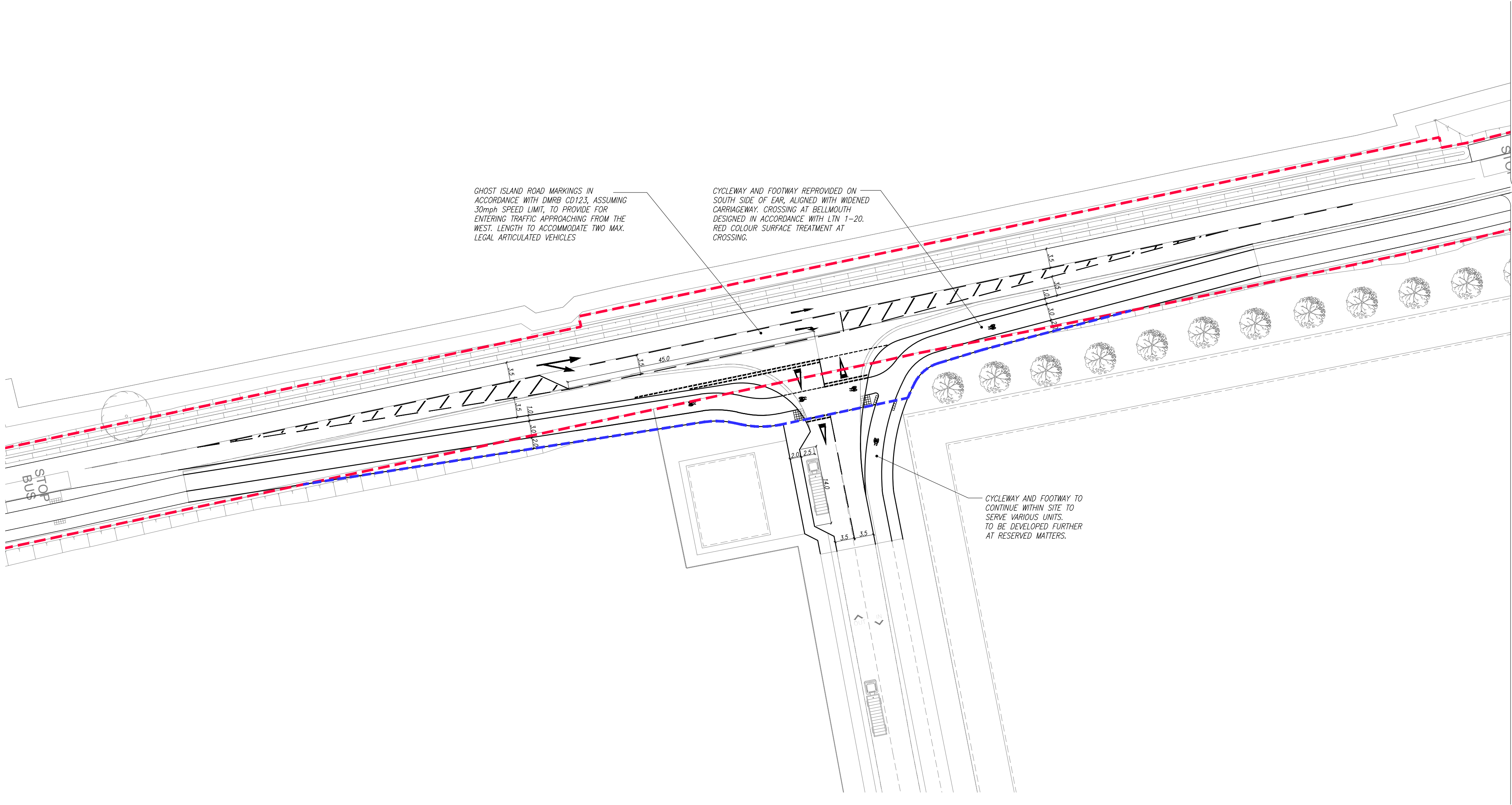

FOR CONTINUATION, SEE DRAWING 1923/50/011

- notes
- THIS DRAWING IS TO BE READ IN CONJUNCTION WITH ALL RELEVANT ARCHITECT'S AND ENGINEER'S DRAWINGS AND THE SPECIFICATION.
 - DO NOT SCALE FROM THIS DRAWING.
 - KEY:
 - EXISTING EAR ADOPTION BOUNDARY.
 - SUGGESTED ADDITIONAL ADOPTION BOUNDARY.

FOR INFORMATION ONLY

C	01.06.22	BACKGROUND UPDATED.	MBr
B	22.04.22	BACKGROUND UPDATED.	MBr
A	01.04.22	CYCLEWAY AMENDED.	MBr
	23.03.22	ISSUED FOR INFORMATION.	MBr

job
GRAVEN HILL,
BICESTER

title
EMPLOYMENT ACCESS ROAD,
GATE 4 HIGHWAY IMPROVEMENTS,
FUTURE SCENARIO

drawn UJ	checked MBr
date MAR'22	scale (original - A1) 1:500

Alan Baxter

75 Cowcross Street London EC1M 6EL
tel 020 7250 1555
email aba@alanbaxter.co.uk

www.alanbaxter.co.uk

dig. no. 1923/050/012	rev. C
--------------------------	-----------

Appendix 1.3: EIA Team Expertise and Qualifications

This Appendix provides information necessary to demonstrate compliance with Regulation 18(5) of the 2017 EIA Regulations, which requires:

- Developers to “ensure that the environmental statement is prepared by competent experts”; and,
- ES to be accompanied by a statement from the developer “outlining the relevant expertise or qualifications of such experts”.

The relevant expertise and qualifications of the competent experts, defined in the context of the EIA Regulations and for their contributions to the EIA, who have prepared this ES are documented through the pen profiles provided in provided in **Tables A1.1** (for individuals) and **Table A1.2** (for the organisations) below.

Table A1.1 Individual Pen Profiles

Company	Individual	Pen Profile	Role
Stantec UK Ltd	Neil Young	<u>Qualifications:</u> BSc (Hons), MSc, CEnv <u>Relevant Experience and Expertise:</u> Neil has over 12 years of consultancy experience providing a broad range of environmental support to projects. He has considerable experience in leading project teams and has a thorough understanding of the various environmental issues that affect a lighting on a wide variety of development and infrastructure projects, from planning through to construction.	EIA Co-ordinator

Company	Individual	Pen Profile	Role
H Planning Ltd	Matt Humphreys	<p><u>Qualifications:</u> BSc (Hons), Dip TP, MSc, MRTPI</p> <p><u>Relevant Experience and Expertise:</u> Matt is a Chartered Town Planner having read Town Planning at University College London (UCL), Bartlett School.</p> <p>Matt is a Director at H Planning Ltd with over 20 years planning experience in both the public and private sectors. He has acted on numerous major planning applications including the 1,100 dwelling (approx. 1,000,000 sq. ft) 'Clarendon Square' in North London. This was also an Outline Planning Application supported by an EIA and Parameter Plans.</p> <p>He has worked on many high profile development projects in London and the South East, including the 200,000 sq. ft London School of Economics (LSE) 'Centre Buildings' project by Rogers Stirk Harbour + Partners (RSHP).</p> <p>Matt regularly conducts site appraisals and Policy Assessments and manages the Planning Application process on behalf of his clients. Matt has acted as an expert witness at Planning Hearings and has delivered CPD Training Courses to a variety of built environment professionals.</p>	Planning Policy Lead Author
RPS	Katy Thomas	<p><u>Qualifications:</u> BSc (Hons) Zoology, MSc Wildlife Management and Conservation, ACIEEM</p> <p><u>Relevant Experience and Expertise:</u> Katy is an ecologist with over 9 years' experience working in the professional sector. She is experienced in a wide range of ecological surveys, particularly relating to ornithology and bats, and has worked on a broad range of projects covering small-scale developments to major residential developments and input into Environmental Statements. Katy holds Natural England licences for bats, great crested newts and barn owl.</p>	Ecology and Nature Conservation Lead Author
Waterman IE	Sally Hales	<p><u>Qualifications:</u> BA (Hons), MA, MCIfA</p> <p><u>Relevant Experience and Expertise:</u> Sally is a Technical Director with Waterman, she has 27 years as a heritage professional. Sally is experienced in the management of archaeology and heritage inputs to Environmental Statements and is a Member of the Chartered Institute for Archaeologists. Sally manages cultural heritage input to feasibility studies, options appraisals, archaeological risk assessments, desk-based assessments and relevant sections within management plans and Environmental Statements. She designs, implements and manages programmes of archaeological investigation from initial evaluation including geophysical survey, field walking and trial trenching through to large</p>	Historic Environment Lead Author

Company	Individual	Pen Profile	Role
		scale area excavation. She has worked extensively on large infrastructure projects providing heritage advice to design teams.	
RPS	Corinna Demmar	<p><u>Qualifications:</u> BA (Hons) DipLA (Hons) CMLI</p> <p><u>Relevant Experience and Expertise:</u> Corinna is a Chartered Landscape Architect and is one of RPS' leading landscape consultants with over 30 years' experience in landscape architecture and landscape planning. During her career she has gained considerable experience in the preparation of Landscape and Visual Impact Assessments for Environmental Statements. She has also undertaken impact assessments for seascapes and historic landscapes for nationally Significant Infrastructure Projects. These include more than 20 years' experience on energy projects, in addition to other work on schemes for leisure, residential, commercial, NHS and mineral extraction projects. She is an expert witness in landscape and visual matters and has given evidence at many successful hearings, public inquiries and DCO Examinations.</p>	Landscape and Visual Effects Lead Author
RPS	Anna Velkov	<p><u>Qualifications:</u> MEng (Water Resources Engineering); GrCert (Natural Resource Management); BSc (Civil Engineering); MCIWEM C.WEM</p> <p><u>Relevant Experience and Expertise</u> Anna has extensive experience in the water management sector with focus on flood risk, including modelling aspects. Anna worked on a wide range of flood risk and water management projects for the government and local authorities as well as private clients in UK and Australia. Her experience includes supervising and checking hydrological analysis and results analyses and providing technical input for the Flood Risk Management Plans and Surface Water Management Plans. She has also been heavily involved in provision of flood risk assessments to support development applications.</p>	Hydrology & Flood Risk Lead Author
RPS	Liz Williams	<p><u>Qualifications:</u> BSc (Hons), MSc</p> <p><u>Relevant Experience and Expertise:</u> A geo-environmental consultant with over 20 years experience working in multi disciplinary consultancies Liz has considerable experience in ground investigation and assessment for geotechnical and environmental purposes. As a ground conditions specialist she frequently prepares Environmental Statement Chapters for large scale developments including industrial, residential and commercial schemes as well as Nationally Significant Infrastructure Projects.</p>	Hydrogeology, Geology and Ground Conditions Author
RPS	Graham Moore	<u>Qualifications:</u>	Hydrogeology, Geology and

Company	Individual	Pen Profile	Role
		<p>BSc (Hons), MSc, Chartered Geologist, Specialist in Land Condition (SiLC) with NQMS accreditation</p> <p><u>Relevant Experience and Expertise</u> Graham is a Chartered Geologist and Specialist in Land Condition and has over twenty years' experience in geoenvironmental and geotechnical consultancy, including extensive experience of undertaking land quality assessments, particularly for the regeneration of brownfield sites for commercial residential and mixed use development. Graham works as an Associate Director and is a project manager and technical lead on a wide variety of projects on a range of schemes including commercial, residential and mixed use developments, primary infrastructure and nuclear licensed sites. Graham has substantial experience of providing technical advice and oversight on EIA schemes including residential and mixed use developments, commercial and industrial developments, energy from waste plants, mineral extraction schemes and education facility development projects.</p>	Ground Conditions Author
Alan Baxter Ltd	Michael Bredin	<p><u>Qualifications:</u> BSc, MSc (Hons)</p> <p><u>Relevant Experience and Expertise:</u> Michael is a transport consultant at Alan Baxter Ltd. He has a wide range of experience on projects including masterplans, town centre regeneration schemes, brownfield developments, urban extensions and rural estates. His work has included transport strategies, transport assessments, transport modelling, travel plans, civils design for public realm, highways and cycle infrastructure, and transport research.</p>	Traffic and Transport Lead Author
Waterman IE	Innes Urbanski	<p><u>Qualifications:</u> BSc (Hons), MSc, MIOA</p> <p><u>Relevant Experience and Expertise:</u> Innes has over 20 years' experience in the field of acoustics with extensive experience in undertaking EIAs of B8 warehouse uses and large residential-led mixed use projects which form part of the proposed urban extensions, regenerations and development of brownfield sites.</p>	Noise and Vibration Lead Author
Ridge & Partners	Kat Adair	<p><u>Qualifications:</u> BSc (Hons), MSc, PIEMA</p> <p><u>Relevant Experience and Expertise:</u> Kat has seven years' experience in the field of sustainability and climate change consultancy with both public and private sector clients. Kat has extensive experience of large-scale developments including industrial, residential, and commercial schemes.</p>	Climate Change Lead Author
Waterman IE	Andrew Fowler	<p><u>Qualifications:</u> CEnv, BSc (Hons), Member of IAQM, Full member of the Institution of Environmental Sciences (IES)</p>	Air Quality Lead Author

Company	Individual	Pen Profile	Role
		<u>Relevant Experience and Expertise:</u> Andy has been responsible for the technical delivery of a wide range of air quality EIA projects for a variety of clients in both the public and private sector. These projects include consideration of emissions from both transportation and industrial sources, through both monitoring and modelling, and therefore he has an in depth understanding of the regulatory requirements for these sources and the published technical guidance for their assessment.	
Quod	Emilie Paine	<u>Qualifications:</u> BA (Hons) degree in Geography from UCL MSc (Distinction) in Spatial Planning from the Bartlett, UCL <u>Relevant Experience and Expertise:</u> Emilie has six years' experience in the development sector including undertaking socio-economic assessment for major development projects. She is an Associate Member of IEMA.	Socio-economics Lead Author

The Applicant is of the opinion that the information provided in **Tables A1.1** and **Table A1.2** demonstrates that this ES has been prepared by competent experts in accordance with the 2017 EIA Regulations.

Company	Pen Profile	Role
Stantec	<p><u>Core Competencies:</u> Stantec is a founder member of the Institute of Environmental Management and Assessment's (IEMA) EIA Quality Mark scheme for quality in EIA. Stantec has a dedicated EIA team that specialises in leading the EIA process for development projects, including land development, regeneration, energy and infrastructure projects. Stantec typically leads 10-20 EIA projects each year. Each of Stantec's EIA team have suitable academic and professional qualifications, with professional qualifications including Principal EIA Practitioner, Practitioner and Associate membership of IEMA, member of Royal Town Planning Institute and Chartered Environmentalist.</p> <p><u>Relevant Accreditations:</u> IEMA EIA Quality Mark (renewed 2018), ISO9001 & ISO14001</p>	EIA Co-Ordinator
Alan Baxter Ltd	<p><u>Core Competencies:</u> Alan Baxter is a leading firm of civil and structural engineers, urban designers and heritage experts, 80 strong and based in central London. Close collaboration between creative design professionals and our clients has formed part of our founding philosophy since 1974 and remains at the core of our work today.</p> <p>Our projects are wide ranging and challenging, and we have a long history of undertaking drainage and transport design for large developments similar to the submitted application. Our urban design and movement work includes major projects for the growth and regeneration of towns, cities and villages across the UK and internationally. Our structural, civil and transport engineering work is similarly wide ranging, including state-of-the-art new bridges and large commercial developments, sensitive alterations to historic structures, deep basements and redeveloping major transport hubs.</p> <p>Social and economic sustainability is a central part of our philosophy and we design places and streets that prioritise sustainable movement. We hold long-established values that champion the reuse of existing structures, the use of high-quality new materials and the adaptability of structural designs to future uses.</p>	Traffic and Transport
Waterman IE	<p><u>Core Competencies:</u> Waterman is a leading environmental consultancy, specialising in a broad range of services, with a focus on understanding our clients' business needs and advising how best to mitigate the risks they face on their projects to meet their strategic objectives. From complex and contentious urban regeneration projects, through to international corporate acquisitions, Waterman is the go to consultancy to ensure environmental, health and safety risks are fully understood in the commercial context.</p> <p><u>Relevant Accreditations:</u> BS EN ISO 9001: 2015, BS EN ISO 14001: 2015 and BS EN ISO 45001:2018. Each of Waterman's EIA team have suitable academic and professional accreditation (Associate or Member of the Institute of Acoustics, Associate or Member of the Institute of Environmental Science, Associate or Member of the Institute of Air Quality Management, CEEQUAL Assessor), together with a wealth of EIA experience.</p>	Noise and Vibration, Historic Environment and Air Quality

Ridge & Partners	<p><u>Core Competencies:</u> Ridge & Partners is a multi-discipline property and construction consultancy, established in 1946, originally as a surveying practice. Ridge now employs over 750 people, working across 12 locations in the UK.</p> <p>Ridge's dedicated sustainability department provides independent advice to public and private sector clients in relation to creating sustainable developments, which includes but is not limited to climate change, energy efficiency, assessment methods and health and wellbeing.</p> <p><u>Relevant Accreditations:</u> ISO9001 & ISO14001</p> <p>Each of Ridge's team have suitable academic qualifications and a wealth of relevant experience.</p>	Climate Change
RPS	<p><u>Core Competencies:</u> Founded in 1970, RPS is a leading global professional services firm located in 125 countries across all six continents. We work across six sectors: property, energy, transport, water, resources, defence and government services and provide a wide range of services including environmental, planning, water, management consulting, design and development, exploration and development, health, safety and risk, laboratories and project and programme management. As part of its environmental and planning businesses, RPS has substantial experience of EIA / DCO projects for a wide range of projects including residential, wind farm, energy, commercial and industrial, mineral extraction and infrastructure developments. This includes EIA co-ordination, undertaking consultations with stakeholders and development of appropriate EIA chapters to support planning applications.</p> <p><u>Relevant Accreditations</u> Each of RPS' technical team have appropriate academic qualifications and a number of senior staff members have achieved chartership or are Practitioner Members of relevant professional institutions. RPS is also ISO9001 and ISO14001 accredited.</p>	Ecology and Nature Conservation, Hydrology and Flood Risk, Landscape and Visual, Hydrogeology, Geology and Ground Conditions
Quod	<p><u>Core Competencies:</u> Quod is an independent consultancy at the cutting edge of planning, development economics, socio-economics and environmental planning based in London and Leeds. Quod's socio-economic team specialise in identifying and assessing the social and economic impacts of development.</p> <p><u>Relevant Accreditations:</u> Quod is IEMA accredited having been awarded the EIA Quality Mark in March 2017. Several members of Quod's Socio-Economic and EIA teams are also individual IEMA-accredited members. As part of Quod's ISO 9001 quality management system accreditation, there is a strong commitment to knowledge sharing across the company. This includes raising awareness both internally and externally of EIA-related topics.</p>	Socio-economics

