

**VIEWPOINT 13 - EXISTING VIEW**

View looking north-west from Oxfordshire Way  
 north of Church Street.

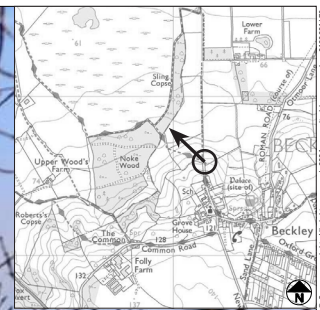

**VIEWPOINT 13 - PHOTOMONTAGE VIEW (YEAR 1)**

View looking north-west from Oxfordshire Way  
 north of Church Street.

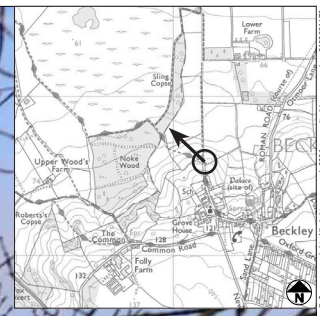

**VIEWPOINT 13 - PHOTOMONTAGE VIEW (YEAR 10)**

View looking north-west from Oxfordshire Way  
 north of Church Street.

## **Appendix D: Detailed Landscape Design**



IMPLEMENTATION AND MAINTENANCE GUIDELINES

- 1.01 All plants shall conform to BS 2758 and be in accordance with the National Plant Specification...
1.02 The contractor shall ensure that all plants are supplied to the site in accordance with the National Plant Specification...
1.03 The contractor shall ensure that all plants are supplied to the site in accordance with the National Plant Specification...

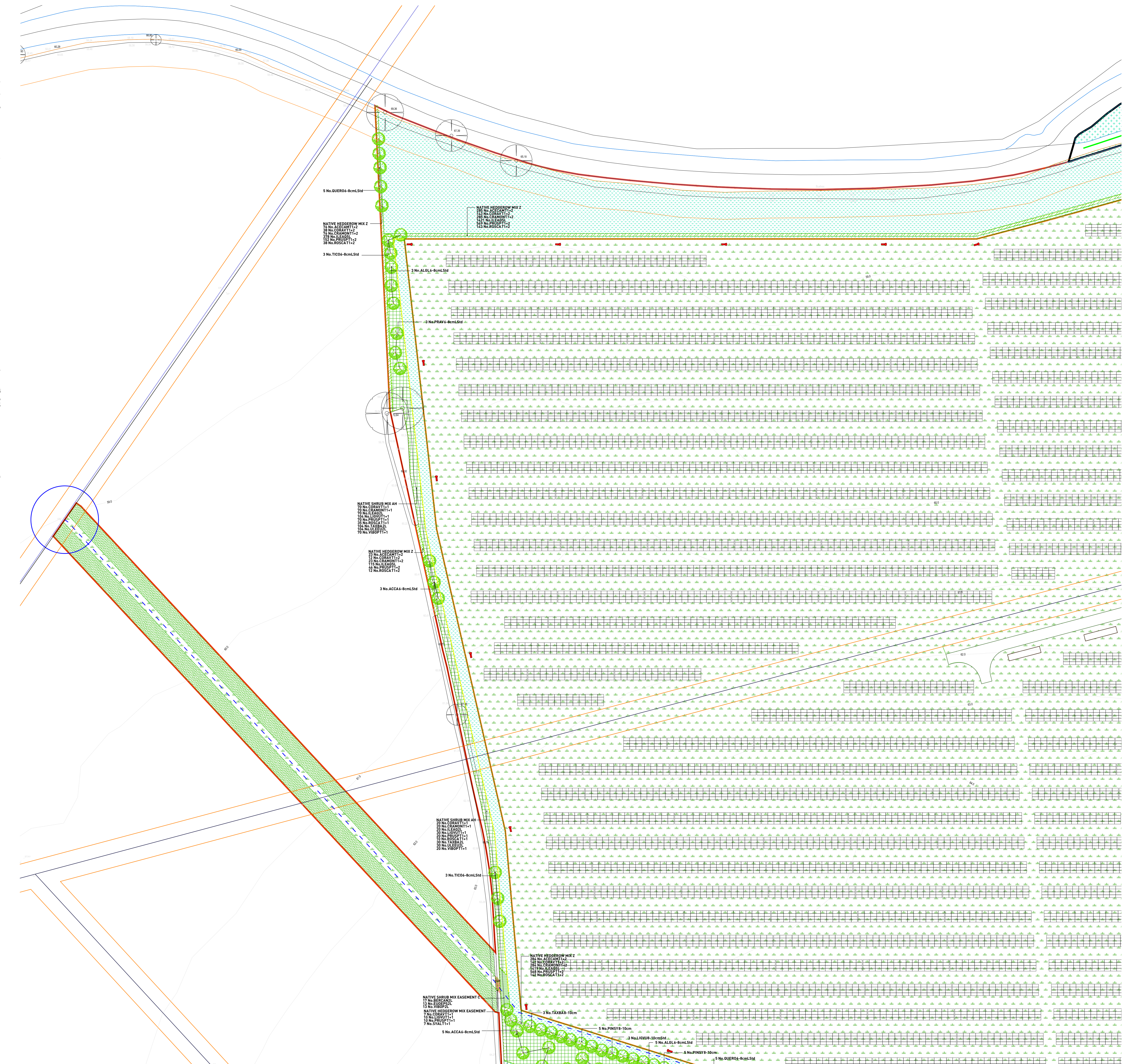

PLANT SCHEDULE table with columns for species, common name, supply specification, height, etc. Includes sections for Proposed Trees, Proposed Native Hedgerow Mixes, Proposed Native Shrub Mixes, Proposed Wildflower Meadows, Meadow Grass Mixtures, Fine Grassland Mixtures, Proposed Turtle Dove Mixture, and Proposed Native Hedgerow Mixes. Also includes a KEY with symbols for site boundary, existing trees, fencing, solar modules, etc.

All arisings will remain on site, excavations from the horse field areas will be relocated to the southern boundary of the solar farm in Noke field (top soil stripped, sub-soil added and topsoil reinstated).

