

IMPLEMENTATION AND MAINTENANCE GUIDELINES

- 14.01** All plants and materials shall be specified in accordance with the National Plant Specification. Suppliers names shall be specified in the Bill of Materials (BOM) and shall be approved by the client. The client shall be notified of any proposed substitutions to the BOM at least 14 days prior to the start of the project. The client shall be notified of any proposed substitutions to the BOM at least 14 days prior to the start of the project. The client shall be notified of any proposed substitutions to the BOM at least 14 days prior to the start of the project.
- 14.02** All plants and materials shall be specified in accordance with the National Plant Specification. Suppliers names shall be specified in the Bill of Materials (BOM) and shall be approved by the client. The client shall be notified of any proposed substitutions to the BOM at least 14 days prior to the start of the project. The client shall be notified of any proposed substitutions to the BOM at least 14 days prior to the start of the project. The client shall be notified of any proposed substitutions to the BOM at least 14 days prior to the start of the project.
- 14.03** All plants and materials shall be specified in accordance with the National Plant Specification. Suppliers names shall be specified in the Bill of Materials (BOM) and shall be approved by the client. The client shall be notified of any proposed substitutions to the BOM at least 14 days prior to the start of the project. The client shall be notified of any proposed substitutions to the BOM at least 14 days prior to the start of the project. The client shall be notified of any proposed substitutions to the BOM at least 14 days prior to the start of the project.
- 14.04** All plants and materials shall be specified in accordance with the National Plant Specification. Suppliers names shall be specified in the Bill of Materials (BOM) and shall be approved by the client. The client shall be notified of any proposed substitutions to the BOM at least 14 days prior to the start of the project. The client shall be notified of any proposed substitutions to the BOM at least 14 days prior to the start of the project. The client shall be notified of any proposed substitutions to the BOM at least 14 days prior to the start of the project.
- 14.05** All plants and materials shall be specified in accordance with the National Plant Specification. Suppliers names shall be specified in the Bill of Materials (BOM) and shall be approved by the client. The client shall be notified of any proposed substitutions to the BOM at least 14 days prior to the start of the project. The client shall be notified of any proposed substitutions to the BOM at least 14 days prior to the start of the project. The client shall be notified of any proposed substitutions to the BOM at least 14 days prior to the start of the project.
- 14.06** All plants and materials shall be specified in accordance with the National Plant Specification. Suppliers names shall be specified in the Bill of Materials (BOM) and shall be approved by the client. The client shall be notified of any proposed substitutions to the BOM at least 14 days prior to the start of the project. The client shall be notified of any proposed substitutions to the BOM at least 14 days prior to the start of the project. The client shall be notified of any proposed substitutions to the BOM at least 14 days prior to the start of the project.
- 14.07** All plants and materials shall be specified in accordance with the National Plant Specification. Suppliers names shall be specified in the Bill of Materials (BOM) and shall be approved by the client. The client shall be notified of any proposed substitutions to the BOM at least 14 days prior to the start of the project. The client shall be notified of any proposed substitutions to the BOM at least 14 days prior to the start of the project. The client shall be notified of any proposed substitutions to the BOM at least 14 days prior to the start of the project.
- 14.08** All plants and materials shall be specified in accordance with the National Plant Specification. Suppliers names shall be specified in the Bill of Materials (BOM) and shall be approved by the client. The client shall be notified of any proposed substitutions to the BOM at least 14 days prior to the start of the project. The client shall be notified of any proposed substitutions to the BOM at least 14 days prior to the start of the project. The client shall be notified of any proposed substitutions to the BOM at least 14 days prior to the start of the project.
- 14.09** All plants and materials shall be specified in accordance with the National Plant Specification. Suppliers names shall be specified in the Bill of Materials (BOM) and shall be approved by the client. The client shall be notified of any proposed substitutions to the BOM at least 14 days prior to the start of the project. The client shall be notified of any proposed substitutions to the BOM at least 14 days prior to the start of the project. The client shall be notified of any proposed substitutions to the BOM at least 14 days prior to the start of the project.
- 14.10** All plants and materials shall be specified in accordance with the National Plant Specification. Suppliers names shall be specified in the Bill of Materials (BOM) and shall be approved by the client. The client shall be notified of any proposed substitutions to the BOM at least 14 days prior to the start of the project. The client shall be notified of any proposed substitutions to the BOM at least 14 days prior to the start of the project. The client shall be notified of any proposed substitutions to the BOM at least 14 days prior to the start of the project.
- 14.11** All plants and materials shall be specified in accordance with the National Plant Specification. Suppliers names shall be specified in the Bill of Materials (BOM) and shall be approved by the client. The client shall be notified of any proposed substitutions to the BOM at least 14 days prior to the start of the project. The client shall be notified of any proposed substitutions to the BOM at least 14 days prior to the start of the project. The client shall be notified of any proposed substitutions to the BOM at least 14 days prior to the start of the project.
- 14.12** All plants and materials shall be specified in accordance with the National Plant Specification. Suppliers names shall be specified in the Bill of Materials (BOM) and shall be approved by the client. The client shall be notified of any proposed substitutions to the BOM at least 14 days prior to the start of the project. The client shall be notified of any proposed substitutions to the BOM at least 14 days prior to the start of the project. The client shall be notified of any proposed substitutions to the BOM at least 14 days prior to the start of the project.
- 14.13** All plants and materials shall be specified in accordance with the National Plant Specification. Suppliers names shall be specified in the Bill of Materials (BOM) and shall be approved by the client. The client shall be notified of any proposed substitutions to the BOM at least 14 days prior to the start of the project. The client shall be notified of any proposed substitutions to the BOM at least 14 days prior to the start of the project. The client shall be notified of any proposed substitutions to the BOM at least 14 days prior to the start of the project.
- 14.14** All plants and materials shall be specified in accordance with the National Plant Specification. Suppliers names shall be specified in the Bill of Materials (BOM) and shall be approved by the client. The client shall be notified of any proposed substitutions to the BOM at least 14 days prior to the start of the project. The client shall be notified of any proposed substitutions to the BOM at least 14 days prior to the start of the project. The client shall be notified of any proposed substitutions to the BOM at least 14 days prior to the start of the project.
- 14.15** All plants and materials shall be specified in accordance with the National Plant Specification. Suppliers names shall be specified in the Bill of Materials (BOM) and shall be approved by the client. The client shall be notified of any proposed substitutions to the BOM at least 14 days prior to the start of the project. The client shall be notified of any proposed substitutions to the BOM at least 14 days prior to the start of the project. The client shall be notified of any proposed substitutions to the BOM at least 14 days prior to the start of the project.
- 14.16** All plants and materials shall be specified in accordance with the National Plant Specification. Suppliers names shall be specified in the Bill of Materials (BOM) and shall be approved by the client. The client shall be notified of any proposed substitutions to the BOM at least 14 days prior to the start of the project. The client shall be notified of any proposed substitutions to the BOM at least 14 days prior to the start of the project. The client shall be notified of any proposed substitutions to the BOM at least 14 days prior to the start of the project.
- 14.17** All plants and materials shall be specified in accordance with the National Plant Specification. Suppliers names shall be specified in the Bill of Materials (BOM) and shall be approved by the client. The client shall be notified of any proposed substitutions to the BOM at least 14 days prior to the start of the project. The client shall be notified of any proposed substitutions to the BOM at least 14 days prior to the start of the project. The client shall be notified of any proposed substitutions to the BOM at least 14 days prior to the start of the project.
- 14.18** All plants and materials shall be specified in accordance with the National Plant Specification. Suppliers names shall be specified in the Bill of Materials (BOM) and shall be approved by the client. The client shall be notified of any proposed substitutions to the BOM at least 14 days prior to the start of the project. The client shall be notified of any proposed substitutions to the BOM at least 14 days prior to the start of the project. The client shall be notified of any proposed substitutions to the BOM at least 14 days prior to the start of the project.
- 14.19** All plants and materials shall be specified in accordance with the National Plant Specification. Suppliers names shall be specified in the Bill of Materials (BOM) and shall be approved by the client. The client shall be notified of any proposed substitutions to the BOM at least 14 days prior to the start of the project. The client shall be notified of any proposed substitutions to the BOM at least 14 days prior to the start of the project. The client shall be notified of any proposed substitutions to the BOM at least 14 days prior to the start of the project.
- 14.20** All plants and materials shall be specified in accordance with the National Plant Specification. Suppliers names shall be specified in the Bill of Materials (BOM) and shall be approved by the client. The client shall be notified of any proposed substitutions to the BOM at least 14 days prior to the start of the project. The client shall be notified of any proposed substitutions to the BOM at least 14 days prior to the start of the project. The client shall be notified of any proposed substitutions to the BOM at least 14 days prior to the start of the project.

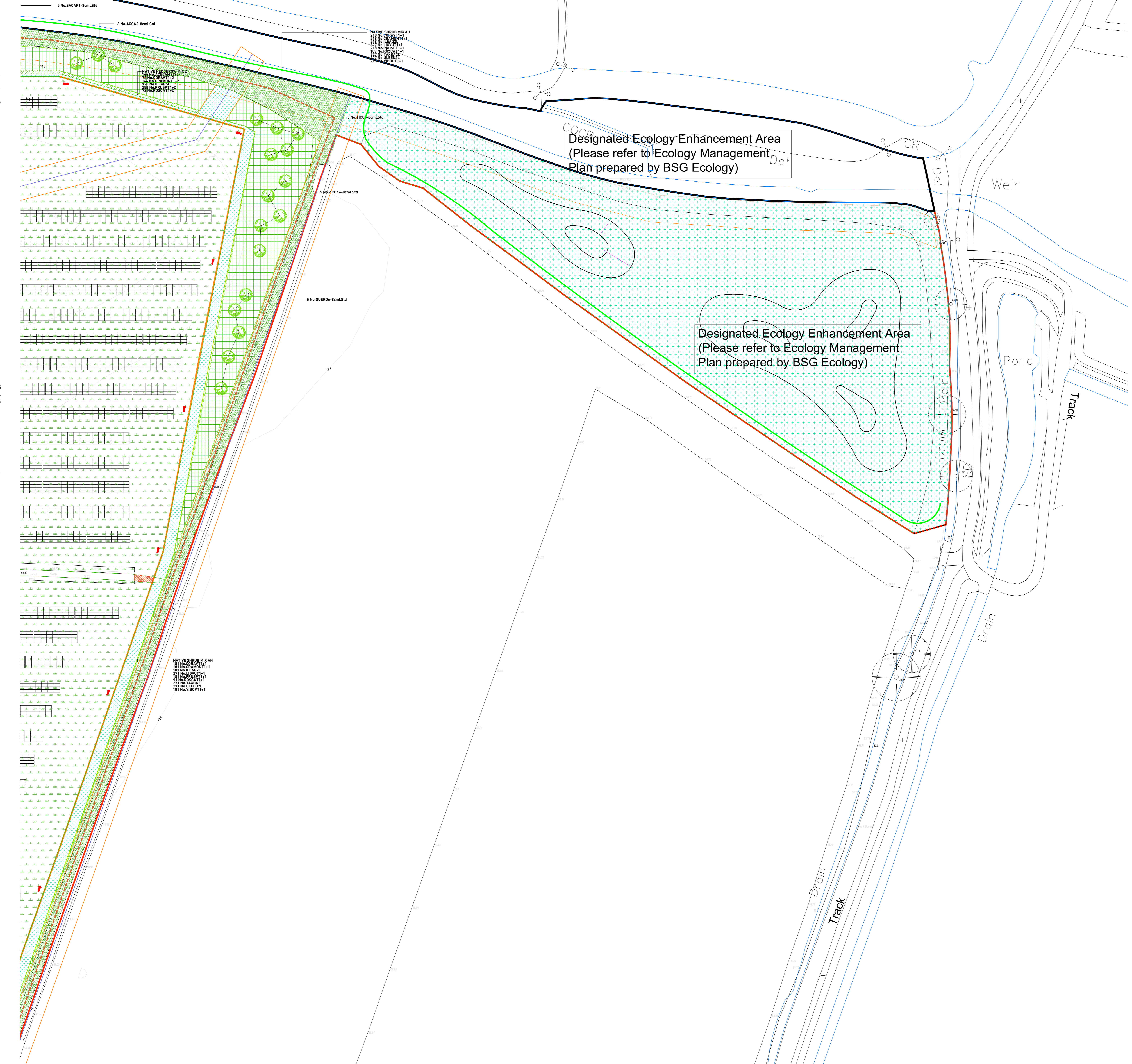

PLANT SCHEDULE

| PROPOSED TREES | ABBV | SPECIES | COMMON NAME | SUPPLY SPECIFICATION | HEIGHT (CM) | BIRTH | DTY (%) |
|----------------|------|------------------|--------------------|----------------------|-----------------|-------|---------|
| ACCA | ACCA | Acacia greggiana | Common Wattle | L50 | 200-250cm 6-8cm | 77 | - |
| ALG | ALG | Alnus glutinosa | Common Alder | L50 | 200-250cm 6-8cm | 43 | - |
| ALU | ALU | Alnus incana | Common Alder | L50 | 200-250cm 6-8cm | 29 | - |
| PRUS | PRUS | Prunus avium | Sweet Cherry | L50 | 200-250cm 6-8cm | 14 | - |
| PRUS | PRUS | Prunus spinosa | Spinous Blackthorn | L50 | 200-250cm 6-8cm | 67 | - |
| PRUS | PRUS | Prunus spinosa | Spinous Blackthorn | L50 | 200-250cm 6-8cm | 35 | - |
| TAXA | TAXA | Taxus baccata | Common Yew | L50 | 200-250cm 6-8cm | 38 | - |
| TIL | TIL | Tilia cordata | Littleleaf Linden | L50 | 200-250cm 6-8cm | 69 | - |

| PROPOSED NATIVE MEADOWS / INFILL MIXES | MIX NAME | ABBV | SPECIES | SUPPLY HEIGHT (CM) | CENTRES (M) | MIX % | DTY (%) |
|--|----------|------|---------------------|--------------------|-------------|-------|---------|
| NATIVE MEADOW MIX EASEMENT | EM3 | EM3 | 100% Meadow Mixture | 100 | 100 | 100 | 100 |
| NATIVE MEADOW MIX EASEMENT | EM4 | EM4 | 100% Meadow Mixture | 100 | 100 | 100 | 100 |
| NATIVE MEADOW MIX EASEMENT | EM5 | EM5 | 100% Meadow Mixture | 100 | 100 | 100 | 100 |

| PROPOSED NATIVE SHRUB MIXES | MIX NAME | ABBV | SPECIES | SUPPLY HEIGHT (CM) | HABIT | CENTRES (M) | MIX % | DTY (%) |
|-----------------------------|----------|----------|--------------------|--------------------|-------|-------------|-------|---------|
| NATIVE SHRUB MIX AH | SHRUB AH | SHRUB AH | 100% Shrub Mixture | 100 | 100 | 100 | 100 | 100 |
| NATIVE SHRUB MIX Z | SHRUB Z | SHRUB Z | 100% Shrub Mixture | 100 | 100 | 100 | 100 | 100 |

KEY

- Site boundary
- Existing trees and vegetation to be retained
- Existing trees and vegetation to be removed
- Existing grassland to be retained
- Soft landscape proposals
- Existing public right of way
- Existing electricity pylons and powerlines (11kv)
- Existing electricity pylons and powerlines (33kv)
- Existing waterbodies
- Proposed perimeter fencing 2.1m high
- Proposed 4m wide EM3 meadow mixture buffer around perimeter fencing
- Proposed 1m wide EM3 meadow mixture buffer around perimeter fencing
- Proposed location of solar modules
- Proposed operational service tracks - access from NOKE village utilising existing agricultural access track
- Spares cabin
- Inverters and associated infrastructure
- CCTV cameras
- Grid connection point
- Underground DNO cable route
- Permissive footpath route
- Indicative permanent wetland habitat
- Timber footbridge

(The max depth to be 600mm and depths vary throughout between the islands at varying depths, the gradient to be 1:20, subject to engineer's detailed design)

1m wide hardwood timber footbridge with handrails and anti slip surface to comply with BS 5400, BS 5268 & BS 6100:2011. Bridge span to be determined by bridge engineer. As supplied by CTS bridges or similar approved manufacturer.



SHEET LOCATION PLAN
NTS