

**IMPLEMENTATION AND MAINTENANCE GUIDELINES**

1. **DESIGN:**
  - 1.1 All plants and materials to be used shall be in accordance with the National Plant Species Database. Suppliers must provide a list of all plants and materials to be used in the project. The list must include the botanical name, common name, height, spread, and any other relevant information. The list must also include the supplier's name and contact details. The list must be submitted to the client for approval before any work begins.
  - 1.2 All plants and materials to be used shall be of a quality that is suitable for the site conditions. The plants must be healthy and free from any signs of disease or pest infestation. The materials must be of a quality that is suitable for the site conditions and must be free from any contaminants.
  - 1.3 All plants and materials to be used shall be of a size that is suitable for the site conditions. The plants must be able to be planted in the site conditions and must be able to survive in the site conditions. The materials must be of a size that is suitable for the site conditions and must be able to be used in the site conditions.
2. **TYPING:**
  - 2.1 All drawings shall be typed on A3 paper. The drawings shall be clear and legible. The drawings shall be submitted to the client for approval before any work begins.
  - 2.2 All drawings shall be submitted to the client for approval before any work begins. The drawings shall be submitted to the client for approval before any work begins.
3. **PLANTING:**
  - 3.1 All plants shall be planted in accordance with the manufacturer's instructions. The plants shall be planted in the site conditions and must be able to survive in the site conditions.
  - 3.2 All plants shall be planted in accordance with the manufacturer's instructions. The plants shall be planted in the site conditions and must be able to survive in the site conditions.
  - 3.3 All plants shall be planted in accordance with the manufacturer's instructions. The plants shall be planted in the site conditions and must be able to survive in the site conditions.
4. **MATERIALS:**
  - 4.1 All materials shall be of a quality that is suitable for the site conditions. The materials must be of a quality that is suitable for the site conditions and must be free from any contaminants.
  - 4.2 All materials shall be of a size that is suitable for the site conditions. The materials must be of a size that is suitable for the site conditions and must be able to be used in the site conditions.
  - 4.3 All materials shall be of a quantity that is suitable for the site conditions. The materials must be of a quantity that is suitable for the site conditions and must be able to be used in the site conditions.
5. **MAINTENANCE:**
  - 5.1 All plants and materials shall be maintained in accordance with the manufacturer's instructions. The plants and materials shall be maintained in the site conditions and must be able to survive in the site conditions.
  - 5.2 All plants and materials shall be maintained in accordance with the manufacturer's instructions. The plants and materials shall be maintained in the site conditions and must be able to survive in the site conditions.
  - 5.3 All plants and materials shall be maintained in accordance with the manufacturer's instructions. The plants and materials shall be maintained in the site conditions and must be able to survive in the site conditions.

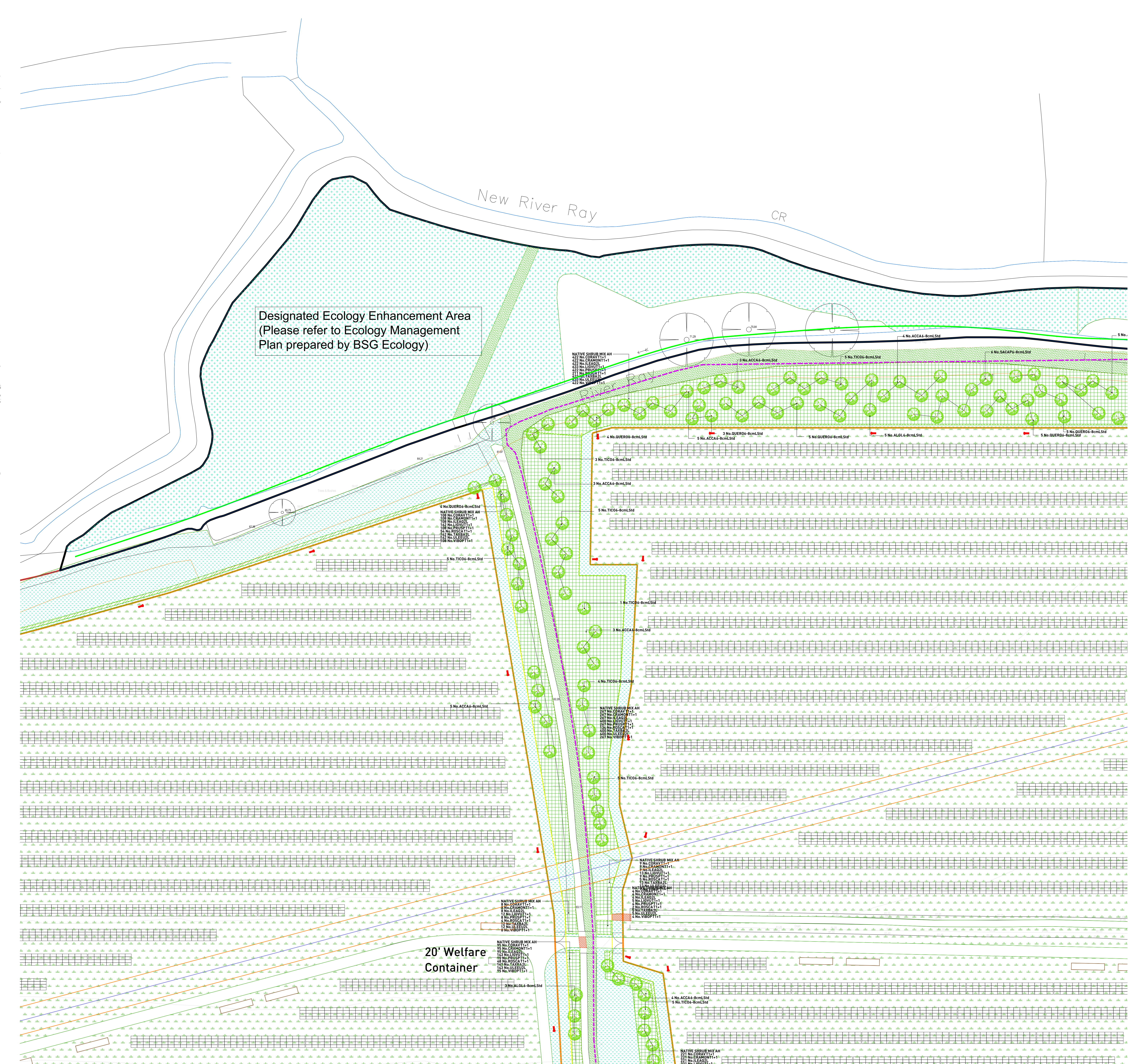

### PLANT SCHEDULE

ABBV	SPECIES	COMMON NAME	SUPPLY SPECIFICATION	HEIGHT (CM)	BIRTH	QTY (No)
ACCA	Acacia campylocha	Common Wattle	L50	200-250cm 6-8cm	77	2
ALG	Alnus glutinosa	Common Alder	L50	200-250cm 6-8cm	43	2
LGU	Ligustrum vulgare	Privet	S14	200-250cm 6-8cm	29	2
PRNS	Prunus sylvatica	Scots Pine	RB	200-250cm 8-10cm	38	2
PRNS	Prunus sylvatica	Common Wild Cherry	L50	200-250cm 6-8cm	14	2
QUER	Quercus robur	Common Oak	L50	200-250cm 6-8cm	67	2
SACA	Salix caprea	Goat willow	L50	200-250cm 6-8cm	35	2
TABA	Taxus baccata	Common Yew	RB	200-250cm 6-8cm	38	2
TICO	Tilia cordata	Littleleaf Linden	L50	200-250cm 6-8cm	69	2

MIX NAME	SPECIES	SUPPLY HEIGHT (CM)	CENTRES (M)	MIX %	QTY (No)
NATIVE HEDEGEW MIX EASTERN	CORVA	11+1	60-80cm	0.30%	Double Staggered of 0.25m offset 208
NATIVE HEDEGEW MIX EASTERN	LGU	11+1	60-80cm	0.30%	Double Staggered of 0.25m offset 208
NATIVE HEDEGEW MIX EASTERN	PRUS	11+1	60-80cm	0.30%	Double Staggered of 0.25m offset 208
NATIVE HEDEGEW MIX Z	ACCA	11+2	175-200cm	0.30%	Double Staggered of 0.25m offset 105
NATIVE HEDEGEW MIX Z	CORVA	11+2	175-200cm	0.30%	Double Staggered of 0.25m offset 105
NATIVE HEDEGEW MIX Z	CRAMA	11+2	175-200cm	0.30%	Double Staggered of 0.25m offset 105
NATIVE HEDEGEW MIX Z	LEAG	11+2	175-200cm	0.30%	Double Staggered of 0.25m offset 105
NATIVE HEDEGEW MIX Z	PRUS	11+2	175-200cm	0.30%	Double Staggered of 0.25m offset 208
NATIVE HEDEGEW MIX Z	ROSCA	11+2	175-200cm	0.30%	Double Staggered of 0.25m offset 55

MIX NAME	SPECIES	SUPPLY HEIGHT (CM)	HABIT	CENTRES (M)	MIX %	QTY (No)
NATIVE SHRUB MIX AH	CORVA	11+1	60-80cm	Transplant 10x	10%	2454
NATIVE SHRUB MIX AH	CRAMA	11+1	60-80cm	Transplant 10x	10%	2454
NATIVE SHRUB MIX AH	LEAG	11+1	60-80cm	Transplant 10x	10%	2454
NATIVE SHRUB MIX AH	LGU	11+1	60-80cm	Transplant 10x	10%	2454
NATIVE SHRUB MIX AH	PRUS	11+1	60-80cm	Transplant 10x	10%	2454
NATIVE SHRUB MIX AH	ROSCA	11+1	60-80cm	Transplant 10x	10%	2454
NATIVE SHRUB MIX AH	TABA	11+1	60-80cm	Transplant 10x	10%	2454
NATIVE SHRUB MIX AH	LEEU	11+1	60-80cm	Transplant 10x	10%	2454
NATIVE SHRUB MIX AH	VBOP	11+1	60-80cm	Transplant 10x	10%	2454
NATIVE SHRUB MIX EASEMENT C	BERCA	2L	30-40cm	10x	408	24
NATIVE SHRUB MIX EASEMENT C	EUOPS	2L	40-60cm	10x	305	26
NATIVE SHRUB MIX EASEMENT C	VBOP	2L	60-80cm	10x	305	26

MIX NAME	SEED MIX SUPPLIER	AREA	DENSITY
EM3 - Special Gen. Purpose Meadow	Emergo Seeds	26362.0243m <sup>2</sup>	4g/m <sup>2</sup>
MEADOW GRASS MIXTURE FOR WET SOILS	Emergo Seeds	30900.2264m <sup>2</sup>	5g/m <sup>2</sup>
MEADOW MIXTURE FOR CLAY SOILS	Emergo Seeds	329415.647m <sup>2</sup>	4g/m <sup>2</sup>

MIX NAME	SEED MIX SUPPLIER	AREA	DENSITY
EM4 - Meadow Mixture for Clay Soils	Emergo Seeds	329415.647m <sup>2</sup>	4g/m <sup>2</sup>

**PROPOSED TURTLE ODGE MIXTURE (or similar approved) SPECIES:**

- Early English common chick 20%
- Early red fescue 20%
- Early white clover 20%
- Early red clover 10%
- Plantain 10%

SEED MIX SUPPLIER: www.kingspross.co.uk  
AREA: 160.136 sqm  
DENSITY: 5g/m<sup>2</sup>

**KEY**

- Site boundary
- Existing trees and vegetation to be retained
- Existing trees and vegetation to be removed
- Existing grassland to be retained
- Soft landscape proposals
- Existing public right of way
- Existing electricity pylons and powerlines (11kv)
- Existing electricity pylons and powerlines (33kv)
- Existing waterbodies
- Proposed perimeter fencing 2.1m high
- Proposed 4m wide EM3 meadow mixture buffer around perimeter fencing
- Proposed 1m wide EM3 meadow mixture buffer around perimeter fencing
- Proposed location of solar modules
- Proposed operational service tracks - access from NOKE village utilising existing agricultural access track
- Spares cabin
- Inverters and associated infrastructure
- CCTV cameras
- Grid connection point
- Underground DNO cable route
- Permissive footpath route
- Indicative permanent wetland habitat
- Timber footbridge

(The max depth to be 600mm and depths vary throughout between the islands at varying depths, the gradient to be 1:20, subject to engineer's detailed design)

1m wide hardwood timber footbridge with handrails and anti slip surface to comply with BS 5400, BS 5268 & BS 6180:2011. Bridge span to be determined by bridge engineer. As supplied by CTS bridges or similar approved manufacturer.