

High Rock

1. THIS DRAWING SHALL BE READ IN CONJUNCTION WITH ALL RELEVANT ENGINEER'S DRAWINGS. ANY DISCREPANCIES FOUND BETWEEN INFORMATION SHOWN ON THIS OR ANY OTHER DRAWING SHALL BE REPORTED TO THE ENGINEER IMMEDIATELY AND PRIOR TO ANY WORKS COMMENCING ON SITE.

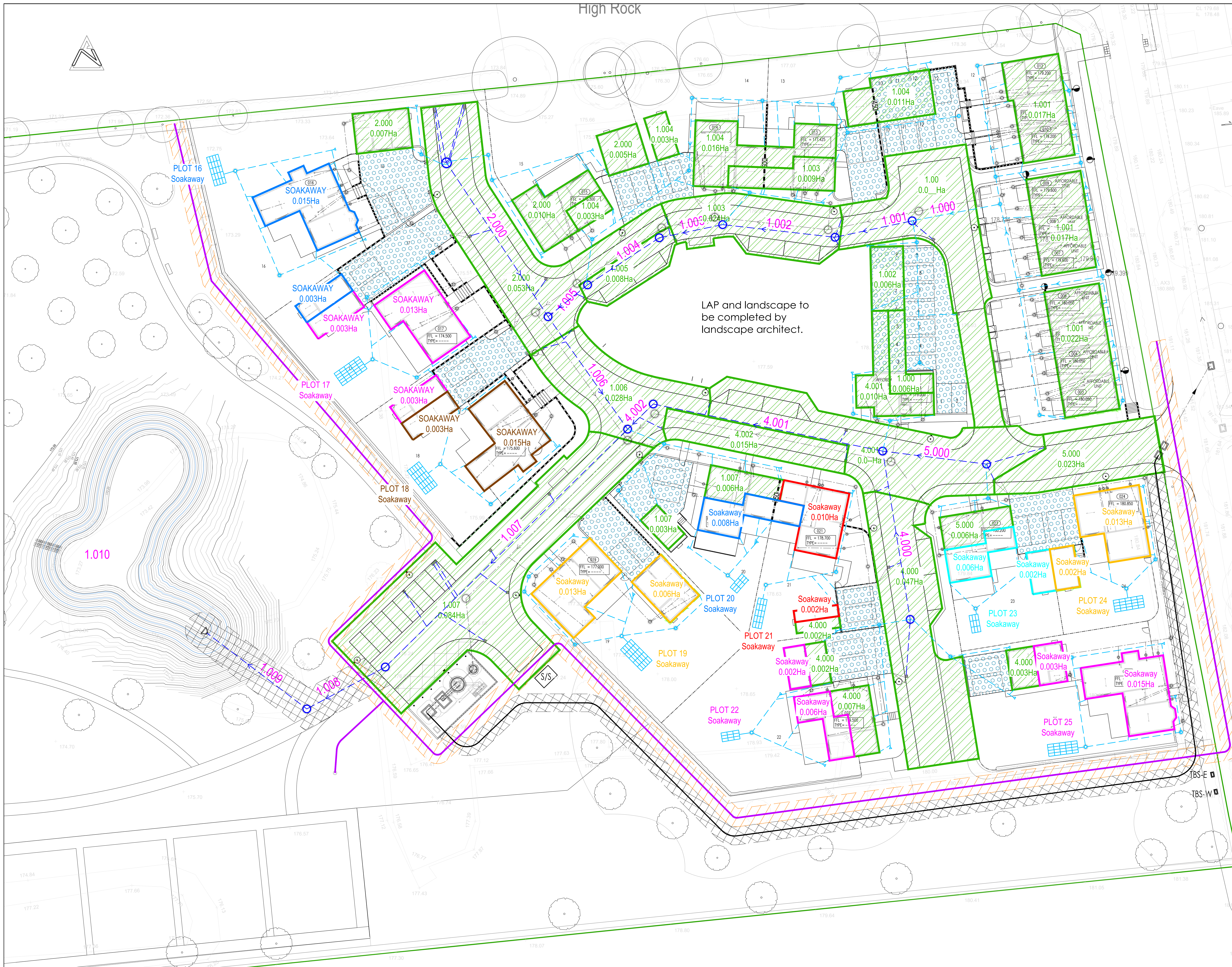

- PIPELINE REFERENCE / DRAINED AREA**
- 1.000 - 0.032ha
 - 1.001 - 0.056ha
 - 1.002 - 0.030ha
 - 1.003 - 0.033ha
 - 1.004 - 0.033ha
 - 1.005 - 0.008ha
 - 2.000 - 0.075ha
 - 3.000 - 0.013ha
 - 1.006 - 0.015ha
 - 4.000 - 0.062ha
 - 5.000 - 0.029ha
 - 4.001 - 0.056ha
 - 4.002 - 0.015ha
 - 6.000 - 0.030ha
 - 1.007 - 0.063ha
 - 1.008 - 0.000ha
 - 1.009 - 0.000ha
 - 1.010 - 0.000ha
- SOAKAWAY REFERENCE DRAINED AREA**
- PLOT 16 - 0.018ha
 - PLOT 17 - 0.019ha
 - PLOT 18 - 0.018ha
 - PLOT 19 - 0.019ha
 - PLOT 20 - 0.008ha
 - PLOT 21 - 0.012ha
 - PLOT 22 - 0.008ha
 - PLOT 23 - 0.008ha
 - PLOT 24 - 0.015ha
 - PLOT 25 - 0.018ha
- ROOF AREAS INCLUDE 10% URBAN CREEP ALLOWANCE**

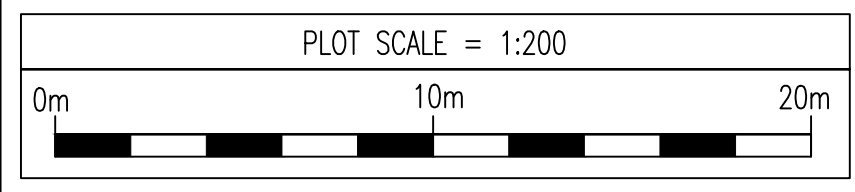

| | | | | |
|-----|--------|------------------------------------|----|-----|
| P2 | Sep 22 | DRAINED AREAS ADDED FOR SOAKAWAYS. | NJ | - |
| P1 | May 22 | PLANNING ISSUE. | - | - |
| REV | DATE | DESCRIPTION | BY | CHK |

TENDER

This drawing is the property and copyright of the Consulting Engineer and shall not be used without written consent for construction on a third party.



SIBFORD FERRIS BANBURY

Surface Water Drained Areas and Pipeline Reference Plan

SDP CONSULTING ENGINEERS

Head Office, Suite 3, Sals Hall, Campfield Road, St Albans, Hertfordshire, AL1 5HT. Tel: 01727 844606 Fax: 01727 830771 Email: info@sdpe.co.uk

Southern Office, 21a Bargarates, Chesham, Bucks HP83 1QD. Tel: 01727 844606 Fax: 01292 490401 Email: sdpsouth@sdpe.co.uk

| | | | | | |
|-------------|---------------|------|-----|-------|--------|
| SCALE | 1:200 | DATE | AJV | ISSUE | May 22 |
| DRAWING NO. | E21-077-152.3 | REV. | | | P2 |