

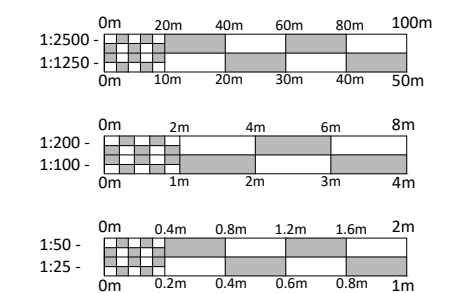





General Notes:

- This drawing is copyright (C). The reproduction of this drawing is expressly prohibited by Walker Graham Architects Limited.
- Dimensions and conditions shall be verified on site. Any discrepancies between this drawing and site conditions shall be brought to the attention of Walker Graham Architects Limited for resolution prior to placing orders or construction.
- This drawing should not be scaled.

Walker Graham Architects Limited 2021.



**KEY**

-  Existing construction
-  Proposed construction
-  To be demolished
-  Existing door
-  Proposed door

Rev	Date	Notes
-	-	-



Project:  
**PROPOSED DEVELOPMENT**  
HOME FARM, WOODWAY ROAD, SIBFORD FERRIS

For:  
**Mr and Mrs Crossley**

Drawing:  
**PROPOSED SECOND FLOOR & ROOF PLAN - HOUSE**

Drawing scale: 1:100 at A3  
Drawing date: APRIL 2021

Drawing no. \_\_\_\_\_ Revision \_\_\_\_\_

**WG1069-013** -

[www.walkergraham.co.uk](http://www.walkergraham.co.uk)  
Email: [architecture@walkergraham.co.uk](mailto:architecture@walkergraham.co.uk)

**03** ROOF PLAN  
1:100

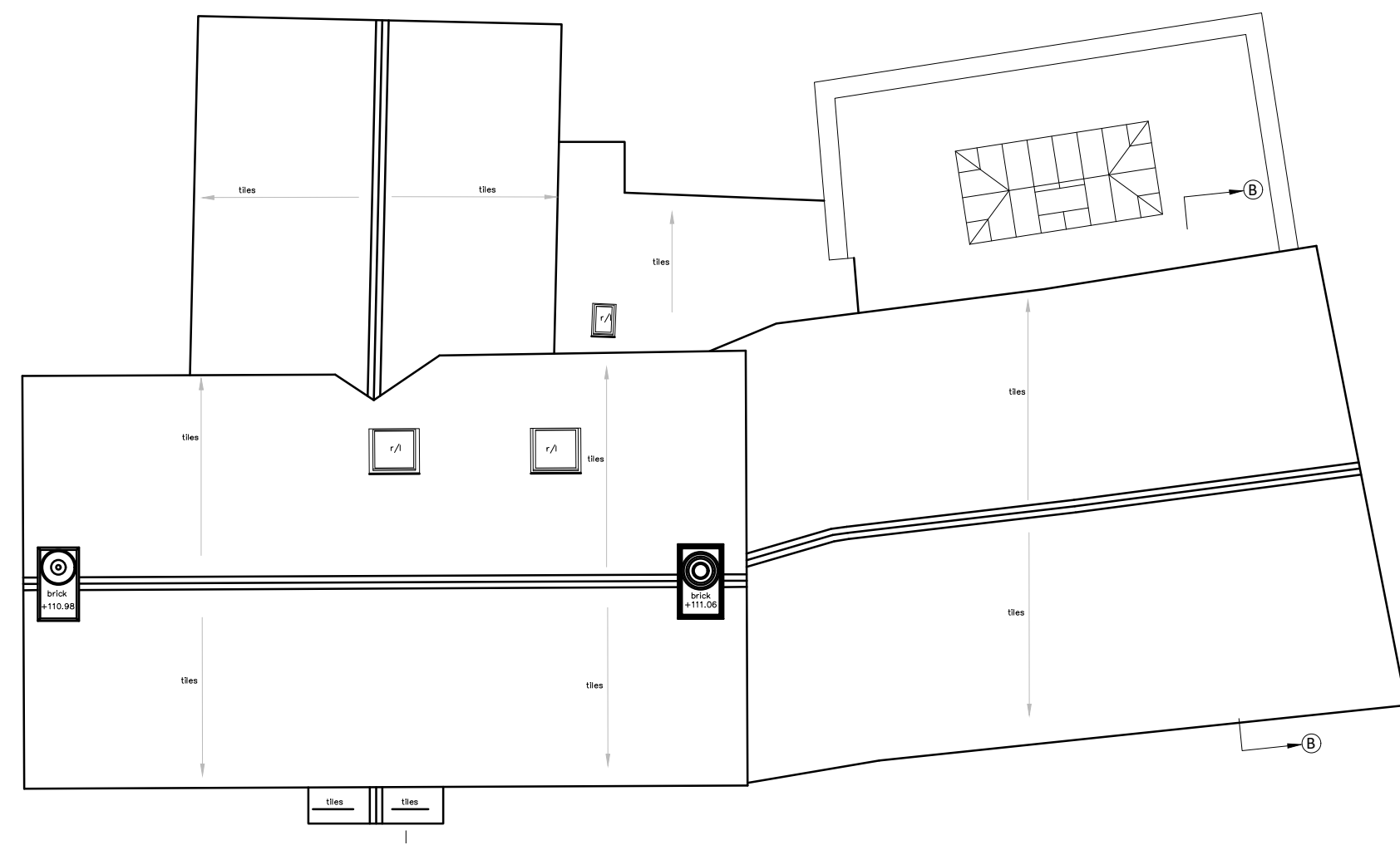

**02** SECOND FLOOR PLAN  
1:100

