

Trees highlighted in grey hatch have either fallen or are recommended for removal and root protection not required

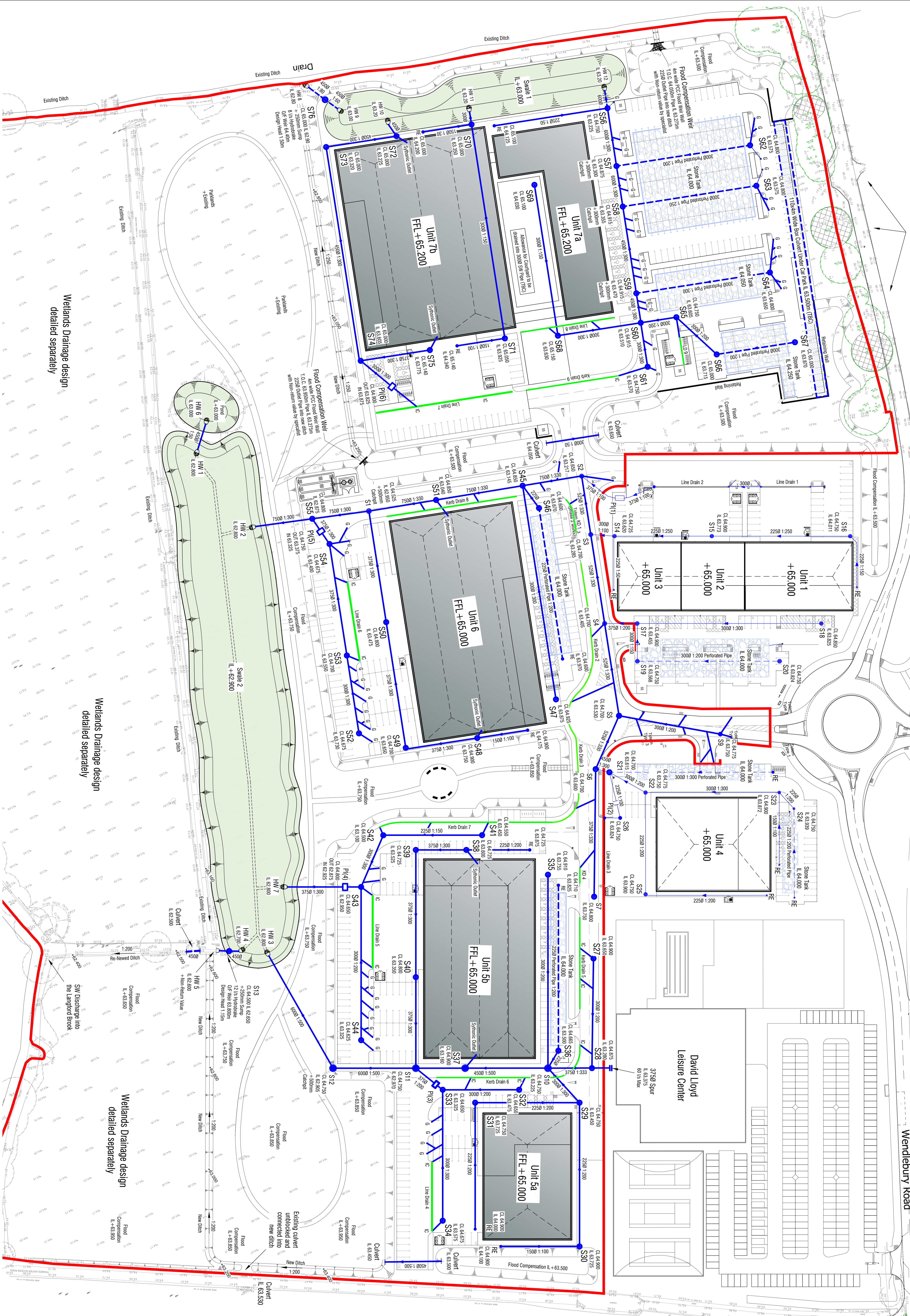

NOTE: ALL PHASE 1 WORKS (WHICH INCLUDE MANHOLES S1-S26) HAVE BEEN CONSTRUCTED AS SHOWN

NOTE: DRAINAGE IS A MIXTURE OF INVERT & SLOPE MANHOLE DESIGN. SEE B4H MANHOLE DETAILS FOR SPECIFIC PIPE INLET/OUTLET LEVELS

NOTE: ALL PERMEABLE PAVING SURGRADE DESIGN & COLLECTOR PIPE LOCATIONS TO BE CONFIRMED

NOTE: ALL RWP PIPE POSITIONS TO BE AGREED WITH THE ARCHITECT

NOTE: DAVID LLOYD SITE DRAINAGE DESIGNED BY OTHERS. STORAGE VOLUME TO BE PROVIDED TO SUIT MAXIMUM 80 L/SEC OUTLET

**NOTES**

**DRAINAGE**

- 1 THIS DRAWING IS TO BE READ IN CONJUNCTION WITH ALL OTHER RELEVANT ARCHITECTS & ENGINEERS DRAWINGS & SPECIFICATIONS
- 2 BRANS TO BE HERENTH SUPERSEDED OR NAVIGATOR TO BE HERENTH TABLE 4 OR TO BE SUPERSEDED BY APPENDIX D.
- 3 ALL TRENCHES WITHIN TRAFFICKED AREAS TO BE BACKFILLED WITH 75MM DOWNGRADED STONE FILL, PAVED & COMPACTED IN LAYERS OF 150MM.
- 4 ALL PRESIN ROADWAYS & PARKING LESS THAN 150MM TO BE CONSTRUCTED TO 300MM CENTRES.
- 5 MANHOLES TO BE CONSTRUCTED OF PRECAST CONCRETE RINGS TO BS EN 1245-1. RINGS TO BE BEDDED IN SEALANT MORTAR.
- 6 ALL CONNECTIONS TO RAIN WATER SYSTEMS TO BE PROVIDED WITH ROOFING ACCESS.
- 7 ROAD GULLIES TO BE HERENTH ROAD GULLIES REFER 213 WITH 150MM DIAMETER OUTLET OR SIMILAR APPROVED GULLIES TO BE ENCASED IN 150MM MINIMUM CONCRETE.
- 8 DRAWINGS TO BE ISSUED TO EA & LOCAL AUTHORITY WELL IN ADVANCE OF COMMENCEMENT OF DRAINAGE LEVELS CONFIRMED PRIOR TO DRAINAGE.
- 9 EXISTING MANHOLES IN ROADS TO HAVE INVERT LEVELS CONFIRMED PRIOR TO DRAINAGE.
- 10 ROADS TO BE REINSTATED TO STANDARD REQUESTED BY LOCAL AUTHORITY WHERE DRAINAGE CROSSES.
- 11 ALL PIPE RUNS WITHIN FLOOD COMPENSATION ZONES TO HAVE A MINIMUM COVER OF 600MM. TEMPORARY PROTECTION OF PIPES TO BE PROVIDED DURING CONSTRUCTION FOR LARGE VEHICLES TRAVELLING OVER IT.
- 12 ALL SURFACE WATER DRAINAGE TO BE CONSTRUCTED USING CONCRETE TO CLASS S4 (NORMAL S7 MAX) USING APPROVED CONCRETE TO CLASS S4 (SPRICKM).

**KEY:**

- INDICATES GULLIES
- INDICATES SURFACE WATER MANHOLES
- INDICATES LINEAR DRAINAGE CHANNELS
- INDICATES EXISTING MANHOLES
- INDICATES NEW PIPE RUNS
- ALL PIPES CONNECTED DIRECTLY INTO GULLIES TO BE 150MM DIAMETER

**PRELIMINARY**

Rev	Date	Description
A	04.03.22	Updated to latest Drainage/Architect Plan
B	11.03.22	Minor Revis to Drainage Design

Revision Schedule  
 Project Title: Catalyst Bicester  
 Wendlebury Road, Bicester

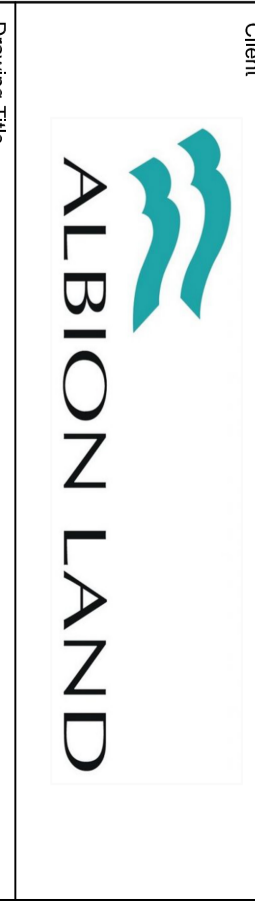

PHASE 2  
 SW Drainage Layout

BAILEY JOHNSON HAYES  
 Consulting Engineers  
 57 ALBION, Sula & Pines Walk, 63 Cambridge Rd, ALBION, Warwick, CV35 9EF  
 BAILEYJOHNSONHAYES.CO.UK  
 15300 @A0  
 11.02.22  
 Drawn: JNG  
 S1358-PH2-01 B

**Phase 2 SW Drainage Layout 1:500**

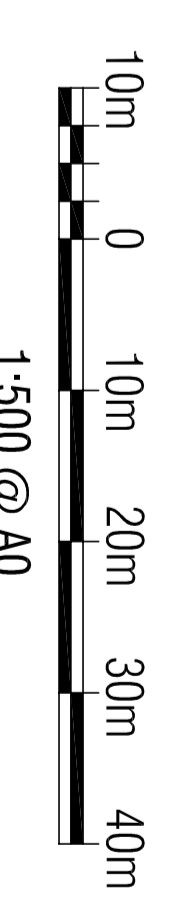

Wetlands Drainage design detailed separately

Wetlands Drainage design detailed separately

Wetlands Drainage design detailed separately