

This drawing is the property of Bradley Murphy Design Ltd. Copyright is reserved by them and the drawing is issued on the condition that it is not copied, reproduced, retained nor disclosed to any unauthorized person either wholly or in part without the consent of Bradley Murphy Design Ltd.

NOTES:

- THIS DRAWING IS BASED ON TOPOGRAPHICAL SURVEY CG 03/08/08 AND LAYOUT BMD 19 01/06/10-104
- THIS DRAWING IS TO BE READ IN CONJUNCTION WITH ALL OTHER LANDSCAPE DRAWINGS AND DOCUMENTS
- THIS DRAWING IS NOT INTENDED FOR CONSTRUCTION
- DO NOT SCALE FROM THIS DRAWING
- ANY DISCREPANCIES BETWEEN THIS DRAWING AND ANY OTHER INFORMATION IS TO BE REPORTED TO BMD FOR CLARIFICATION

**KEY**

- ROBUST AND IMMOVABLE BARRIER
- AREAS FOR PRUNING
- TREES TO BE RETAINED
- TREES TO BE REMOVED

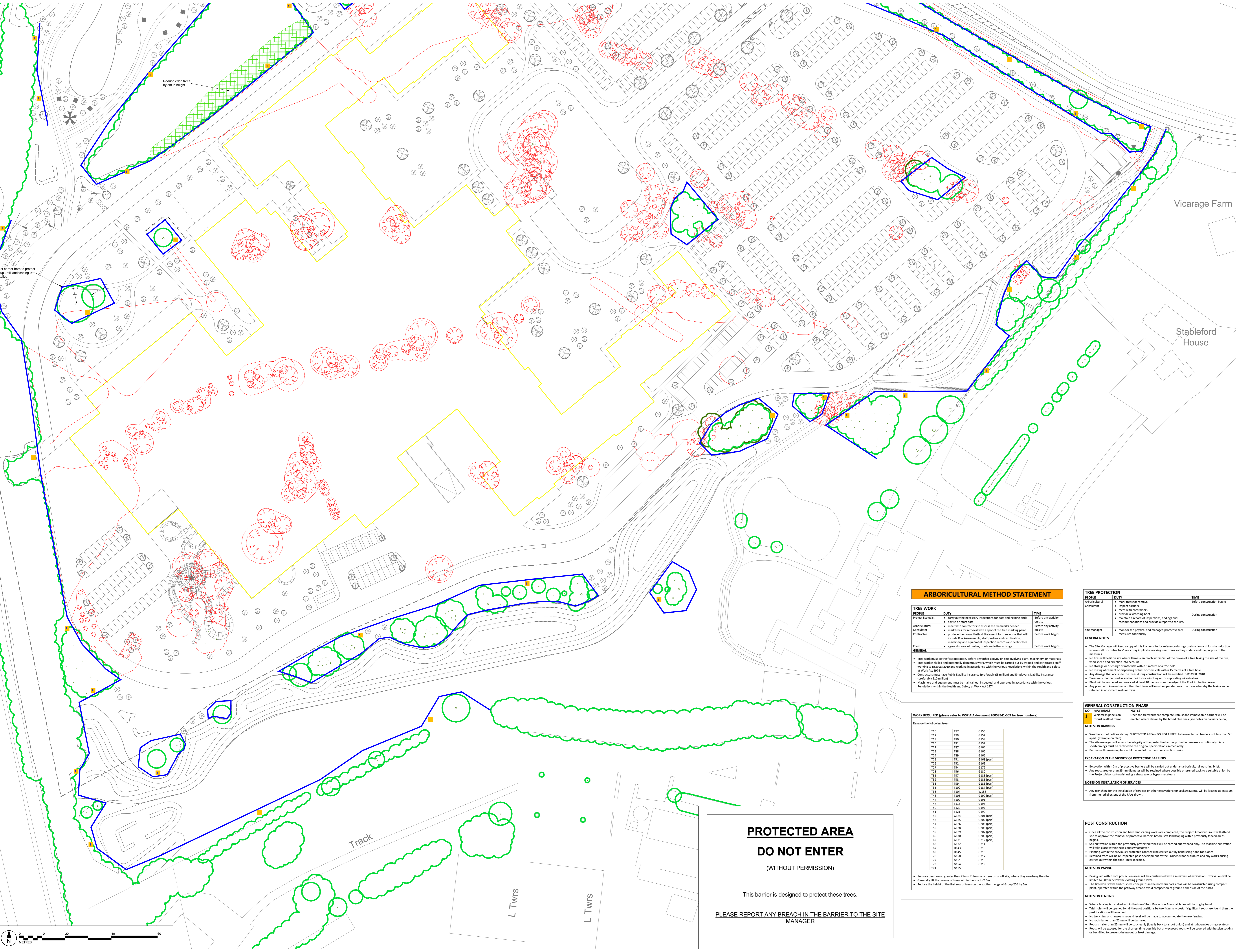

**ARBORICULTURAL METHOD STATEMENT**

PEOPLE	DUTY	TIME
Project Ecologist	<ul style="list-style-type: none"> <li>carry out the necessary inspections for bats and nesting birds</li> <li>submit on start date</li> </ul>	Before any activity on site
Arboricultural Consultant	<ul style="list-style-type: none"> <li>meet with contractors to discuss the tree works needed</li> <li>mark trees for removal with a spot of red tree marking paint</li> </ul>	Before any activity on site
Contractor	<ul style="list-style-type: none"> <li>produce their own Method Statement for tree works that will include Risk Assessment, staff profiles and certification, machinery and equipment inspection records and certificates</li> <li>agree disposal of timber, trash and other arisings</li> </ul>	Before work begins

Client: \_\_\_\_\_

**GENERAL**

- Tree work must be the first operation, before any other activity on site involving plants, machinery, or materials.
- Tree work is skilled and potentially dangerous work, which must be carried out by trained and certificated staff working to BS3900: 2010 and working in accordance with the various Regulations within the Health and Safety at Work Act 1974.
- Contractors must have Public Liability Insurance (preferably £5 million) and Employer's Liability Insurance (unfavorably £20 million).
- Machinery and equipment must be maintained, inspected, and operated in accordance with the various Regulations within the Health and Safety at Work Act 1974.

**TREE PROTECTION**

PEOPLE	DUTY	TIME
Arboricultural Consultant	<ul style="list-style-type: none"> <li>mark trees for removal</li> <li>inspect barriers</li> <li>meet with contractors</li> <li>provide a watching brief</li> <li>maintain a record of inspections, findings and recommendations and provide a report to the JPA</li> </ul>	Before construction begins
Site Manager	<ul style="list-style-type: none"> <li>monitor the physical and managed protective tree measures continually</li> </ul>	During construction

**GENERAL NOTES**

- The Site Manager will keep a copy of this Plan on site for reference during construction and for site induction where staff or contractor's work may impinge working near trees or they understand the purpose of the measures.
- No fire will be lit on site where flumes can reach within 5m of the crown of a tree taking the size of the fire, wind speed and direction into account.
- No storage or discharge of materials within 5 metres of a tree bole.
- No mixing of cement or dispersing of fuel or chemicals within 15 metres of a tree bole.
- Any damage that occurs to the trees during construction will be notified to BS3900: 2010.
- Trees must not be used as anchor points for winching or for supporting wires/cables.
- Plants will be handled and carried at least 10 metres from the edge of the Root Protection Areas.
- Any plant with known fuel or other fluid leaks will only be operated near the trees whereby the leaks can be retained in absorbent mats or trays.

**WORK REQUIRED (please refer to WSP AIA document 70058541-009 for tree numbers)**

Remove the following trees:

NO.	COORDINATES	NO.	COORDINATES
T10	177	G156	
T11	179	G157	
T12	180	G158	
T13	181	G159	
T14	182	G160	
T15	183	G161	
T16	184	G162	
T17	185	G163	
T18	186	G164	
T19	187	G165	
T20	188	G166	
T21	189	G167	
T22	190	G168	(part)
T23	191	G169	
T24	192	G170	
T25	193	G171	
T26	194	G172	
T27	195	G173	
T28	196	G174	
T29	197	G175	
T30	198	G176	(part)
T31	199	G177	
T32	200	G178	
T33	201	G179	
T34	202	G180	
T35	203	G181	
T36	204	G182	
T37	205	G183	
T38	206	G184	
T39	207	G185	
T40	208	G186	
T41	209	G187	
T42	210	G188	
T43	211	G189	
T44	212	G190	
T45	213	G191	
T46	214	G192	
T47	215	G193	
T48	216	G194	
T49	217	G195	
T50	218	G196	
T51	219	G197	
T52	220	G198	
T53	221	G199	
T54	222	G200	
T55	223	G201	
T56	224	G202	
T57	225	G203	
T58	226	G204	
T59	227	G205	
T60	228	G206	
T61	229	G207	
T62	230	G208	
T63	231	G209	
T64	232	G210	
T65	233	G211	
T66	234	G212	
T67	235	G213	
T68	236	G214	
T69	237	G215	
T70	238	G216	
T71	239	G217	
T72	240	G218	
T73	241	G219	
T74	242	G220	

**GENERAL CONSTRUCTION PHASE**

NO.	MATERIALS	NOTES
1	Wooden panels on robust scaffold frame	Once the tree works are complete, robust and immovable barriers will be erected where shown by the broad blue lines (see notes on barriers below)

**NOTES ON BARRIERS**

- Weather proof notice stating: "PROTECTED AREA - DO NOT ENTER" to be erected on barriers not less than 5m apart. (Example on plan)
- The site manager will assess the integrity of the protective barrier measures continually. Any shortcomings must be notified to the original specifications immediately.
- Barriers will remain in place until the end of the main construction period.

**EXCAVATION IN THE VICINITY OF PROTECTIVE BARRIERS**

- Excavation within 2m of protective barriers will be carried out under an arboricultural watching brief.
- Any roots greater than 25mm diameter will be retained where possible or pruned back to a suitable union by the Project Arboriculturalist using a sharp saw or bypass secateurs.

**NOTES ON INSTALLATION OF SERVICES**

- Any trenching for the installation of services or other excavations for sidewalks etc. will be located at least 1m from the radial extent of the RPA's drawn.

**POST CONSTRUCTION**

- Once all the construction and hard landscaping works are completed, the Project Arboriculturalist will attend site to approve the removal of protective barriers before soft landscaping within previously fenced areas begins.
- Soil cultivation within the previously protected areas will be carried out by hand only. No machine cultivation will take place within these zones whatsoever.
- Planting within the previously protected zones will be carried out by hand using hand tools only.
- Retained trees will be re-inspected post-development by the Project Arboriculturalist and any works arising carried out within the time limits specified.

**NOTES ON PAVING**

- Paving laid within root protection areas will be constructed with a minimum of excavation. Excavation will be limited to 10mm below the existing ground level.
- The Breckon Gravel and crushed stone paths in the northern park area will be constructed using compact plant, operated within the pathway area to avoid compaction of ground either side of the paths.

**NOTES ON FENCING**

- Where fencing is installed within the trees' Root Protection Areas, all holes will be dug by hand.
- No holes will be opened for all the post positions before being any post. If significant roots are found then the post locations will be moved.
- No trenching or changes to ground level will be made to accommodate the new fencing.
- No roots larger than 25mm will be damaged.
- Roots smaller than 25mm will be cut cleanly (slightly back to a root union) and an 8mm angle using secateurs.
- Roots will be exposed for the shortest time possible but any exposed roots will be covered with heaviest sacking or burlap to prevent drying-out or frost damage.

**PROTECTED AREA**  
**DO NOT ENTER**  
(WITHOUT PERMISSION)

This barrier is designed to protect these trees.

**PLEASE REPORT ANY BREACH IN THE BARRIER TO THE SITE MANAGER**

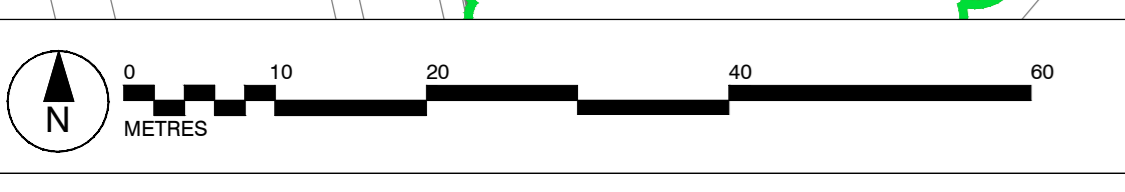

Rev | Description | Date

A | Enhanced Method Statement | 11.11.22

**PLANNING**

Bradley Murphy Design Ltd  
S The Courtyard  
Hutton Technology Park  
Dark Lane  
Hutton  
Warrwickshire  
CV35 9XB

t: 01926 679490  
e: info@bradleymurphydesign.co.uk  
www.bradleymurphydesign.co.uk

Client:  
**Great Lakes UK Limited**

Project:  
**Great Wolf Lodge, Chesterton, Bicester**

Drawing Title:  
**TREE PROTECTION PLAN - SOUTH**

Drawn	Checked	Approved	Date
AMB	TC	AMB	11.11.2022

JOB No. | Scale | Sheet Size | Revision

18.010 | 1:500 | A0 | A

Drawing Number:  
BMD 19 0110 DR.003.2