

REFUSE VEHICLE TRACKING

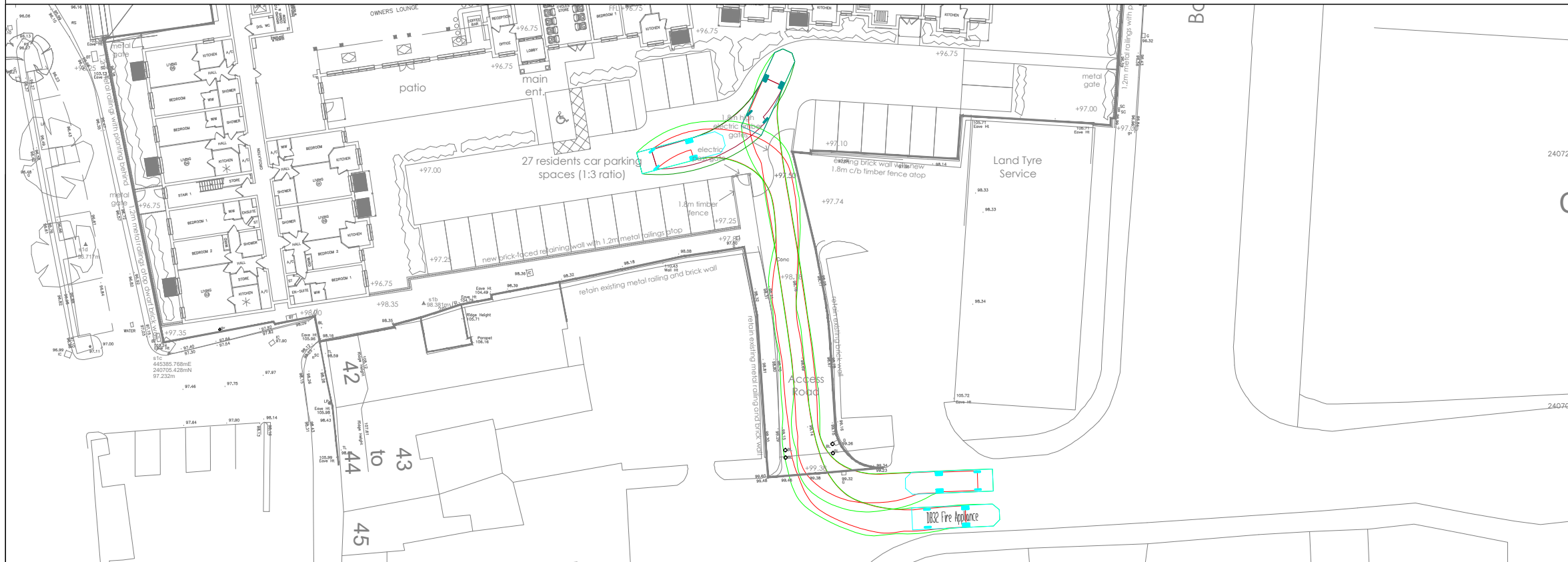

FIRE TENDER VEHICLE TRACKING

GENERAL NOTES

- THIS DRAWING IS INTENDED TO BE VIEWED IN COMBINATION WITH ALL RELEVANT ARCHITECTS, ENGINEERS, SERVICES AND SPECIALIST DRAWINGS AND SPECIFICATION.
- ANY VARIATIONS OR DISCREPANCIES BETWEEN THESE DRAWINGS IN TERMS OF DIMENSIONS OR DETAILS SHOULD BE DRAWN TO THE ATTENTION OF THE ARCHITECT AND/OR THE ENGINEER FOR CLARIFICATION.
- PAUL BASHAM ASSOCIATES ACCEPTS NO RESPONSIBILITY FOR THE ACCURACY OF BACKGROUND INFORMATION PRODUCED BY THIRD PARTIES – THIS MUST BE TREATED AS INDICATIVE ONLY.
- ALL DIMENSIONS AND LEVELS ARE IN METRES. DO NOT SCALE THIS DRAWING, PRINT, PLOT OR DISK.
- THIS DRAWING SHOULD ONLY BE USED FOR CONSTRUCTION IF THE PROJECT PHASE IN THE TITLE FRAME BELOW IS SHOWN AS "CONSTRUCTION". PAUL BASHAM ASSOCIATES TAKE NO RESPONSIBILITY FOR CONSTRUCTION WORKS UNDERTAKEN TO DRAWINGS WHICH ARE NOT MARKED UNDER THIS PHASE.

VEHICLE PROFILE

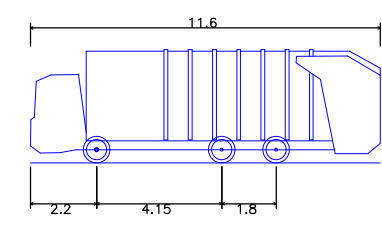

Oxfordshire County Council 11.6m Refuse Vehicle
 Overall Length 11.600m
 Overall Width 2.530m
 Overall Body Height 3.756m
 Min Body Ground Clearance 0.309m
 Track Width 2.530m
 Lock to lock time 4.00s
 Kerb to Kerb Turning Radius 9.450m

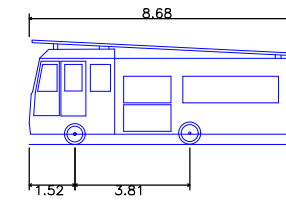

DB32 Fire Appliance
 Overall Length 8.680m
 Overall Width 2.180m
 Overall Body Height 3.452m
 Min Body Ground Clearance 0.337m
 Max Track Width 2.121m
 Lock to lock time 6.00s
 Kerb to Kerb Turning Radius 7.910m

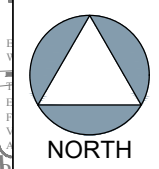

| Rev | Description | Date | By | Chkd |
|-----|---------------------|----------|----|------|
| D | UPDATED SITE LAYOUT | 04.03.22 | HC | JR |
| C | UPDATED SITE LAYOUT | 07.12.21 | JH | HC |
| B | UPDATED SITE LAYOUT | 08.10.11 | JH | HC |
| A | UPDATED SITE LAYOUT | 11.10.21 | JH | HC |

Project Name
 Buzz Bingo, Bolton Road
 Banbury

Project Phase
 PRELIMINARY

Title
 SERVICE VEHICLE TRACKING DRAWINGS



Client
 Churchill Retirement Living

Checked By
 HC

Checked Date
 06.08.2021

Drawn By
 JH

Drawn Date
 06.08.2021

Scale
 1:500
 (AT A3 SIZE)

Client Drawing No.
 -

PBA Drawing No.
 536.0037.003

Revision
 D