

LOCATION PLAN 1:5000@A1

This drawing is the property of Bradley Murphy Design Ltd. Copyright is reserved by them and the drawing is issued on the condition that it is not copied, reproduced, retained nor disclosed to any unauthorized person either wholly or in part without the consent of Bradley Murphy Design Ltd.

- NOTES:
- THIS DRAWING IS BASED ON BMD.19.010.DR.P001 OVERALL GA
 - THIS DRAWING SHOULD BE READ IN CONJUNCTION WITH ALL OTHER LANDSCAPE DRAWINGS AND DOCUMENTS
 - THIS DRAWING IS NOT INTENDED FOR CONSTRUCTION
 - DO NOT SCALE FROM THIS DRAWING
 - ANY DISCREPANCIES WITHIN THIS DRAWING OR BETWEEN THIS DRAWING AND ANY OTHER INFORMATION IS TO BE REPORTED TO BMD FOR CLARIFICATION

- STORAGE AREA WITH SHED SCREENED WITH TIMBER FENCE AND HEDGEROW
- TIMBER STAGE FOR OUTDOOR CINEMA-SCREEN & ACTIVITIES
- SEATING NEAR PLAY SPACE SET IN RESIN BOUND GRAVEL
- WOLF DEN PLAY GROUND- NATURAL PLAY AREA OUTSIDE FAMILY ENTERTAINMENT CENTRE. PLAY EQUIPMENT SHOWN INDICATIVELY. DETAILS TO COME FORWARD AT A LATER STAGE
- SEATING TERRACE OUTSIDE WATER PARK / FAMILY ENTERTAINMENT CENTRE
- STEP AND RAMP ACCESS TO WHIRLPOOL AND SEATING AREA
- EXTERNAL WHIRLPOOL AND SEATING AREA
- DRAINAGE SWALE ENHANCED WITH MARGINAL AQUATIC PLANTING

EXTENT OF ACOUSTIC BARRIER REFER TO HOARE LEA INFORMATION FOR DETAILS

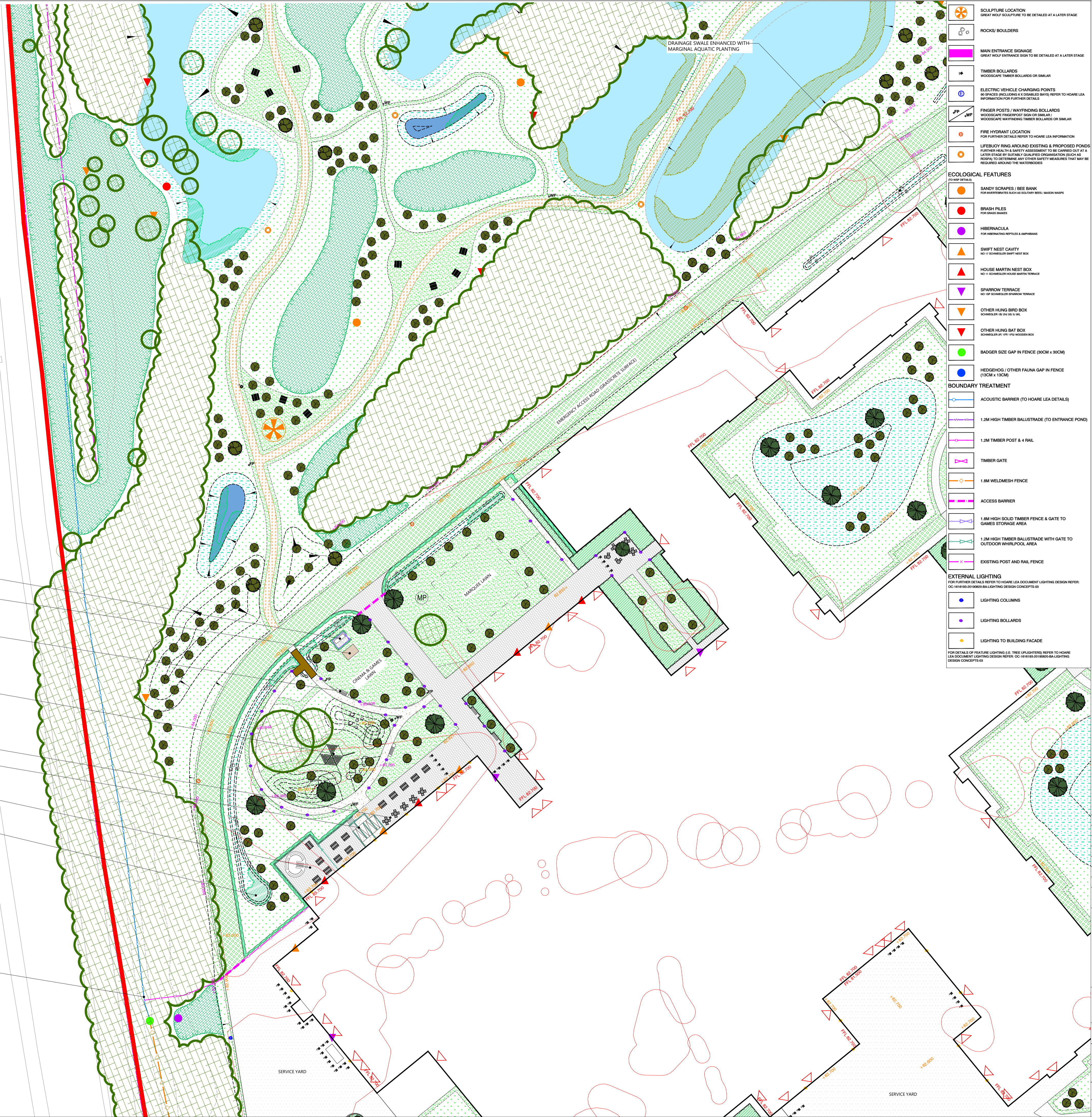
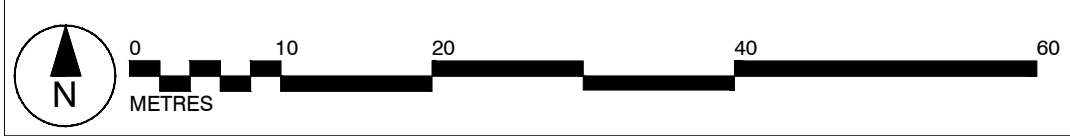

- SCULPTURE LOCATION GREAT WOLF SCULPTURE TO BE DETAILD AT A LATER STAGE
- ROCKS/BOULDERS
- MAIN ENTRANCE SIGNAGE GREAT WOLF ENTRANCE SIGN TO BE DETAILD AT A LATER STAGE
- TIMBER BOLLARDS WOODSCAPE TIMBER BOLLARDS OR SIMILAR
- ELECTRIC VEHICLE CHARGING POINTS FOR FURTHER DETAILS REFER TO HOARE LEA INFORMATION FOR FURTHER DETAILS
- FINGER POSTS / WAYFINDING BOLLARDS WOODSCAPE FINGERPOST SIGN OR SIMILAR WOODSCAPE WAYFINDING TIMBER BOLLARDS OR SIMILAR
- FIRE HYDRANT LOCATION FOR FURTHER DETAILS REFER TO HOARE LEA INFORMATION
- LIFEBUOY RING AROUND EXISTING & PROPOSED PONDS FURTHER HEALTH & SAFETY ASSESSMENT TO BE CARRIED OUT AT A LATER STAGE BY SUITABLE QUALIFIED ORGANISATION (SUCH AS HSE) TO DETERMINE ANY OTHER SAFETY MEASURES THAT MAY BE REQUIRED AROUND THE BAY/TERRACES
- ECOLOGICAL FEATURES (TO HLP DETAILS)
 - SANDY SCRAPES / BEE BANK FOR HABITATS SUCH AS SOLITARY BEES / MASON BEES
 - BRUSH PILES FOR GAMES BUNKERS
 - HIBERNACULA FOR HIBERNATING BEETLES & AMPHIBIANS
 - SWIFT NEST CAVITY NO 17 SCHEDULED SWIFT NEST BOX
 - HOUSE MARTIN NEST BOX NO 11 SCHEDULED HOUSE MARTIN NEST BOX
 - SPARROW TERRACE NO 107 SCHEDULED SPARROW TERRACE
 - OTHER HING BIRD BOX SCHEDULED BY: IFF: 1/15
 - OTHER HING BAT BOX SCHEDULED BY: IFF: 1/15 WOODBOX
 - BADGER SIZE GAP IN FENCE (30CM x 30CM)
 - HEDGEHOG / OTHER FAUNA GAP IN FENCE (10CM x 10CM)
- BOUNDARY TREATMENT (TO HOARE LEA DETAILS)
 - 1.2M HIGH TIMBER BALUSTRADE (TO ENTRANCE POND)
 - 1.2M TIMBER POST & 4 RAIL
 - TIMBER GATE
 - 1.8M WELDMESH FENCE
 - ACCESS BARRIER
 - 1.8M HIGH SOLID TIMBER FENCE & GATE TO GAMES STORAGE AREA
 - 1.2M HIGH TIMBER BALUSTRADE WITH GATE TO OUTDOOR WHIRLPOOL AREA
 - EXISTING POST AND RAIL FENCE
- EXTERNAL LIGHTING (FOR FURTHER DETAILS REFER TO HOARE LEA DOCUMENT LIGHTING DESIGN REFER: OC:181818-20190820-BA LIGHTING DESIGN CONCEPTS-03)
 - LIGHTING COLUMNS
 - LIGHTING BOLLARDS
 - LIGHTING TO BUILDING FACADE

- SITE BOUNDARY
- EXISTING EARTHWORKS
- EARTHWORKS CONTOURS
- EXISTING LEVELS
- INDICATIVE PROPOSED GROUND LEVELS / INDICATIVE FINISHED FLOOR LEVELS
- SLOPE DIRECTION
- EXISTING WATER BODIES
- PROPOSED WATER BODIES
- MUSTER POINTS
- SOFT LANDSCAPE REFER TO: BMD.19.010.DR.P001-005 PLANTING PLANS & SCHEDULE
 - EXISTING TREES & WOODLAND TO BE RETAINED
 - EXISTING TREES & WOODLAND TO BE REMOVED
 - BOULEVARD TREES
 - FEATURE PARKLAND TREES
 - ORNAMENTAL FEATURE TREES
 - CAR PARK TREES
 - PARKLAND TREES
 - WOODLAND PLANTING
 - AMENITY SHRUB PLANTING
 - NATIVE HEDGEROW
 - SINGLE SPECIES HEDGEROW
 - EXISTING MARGINAL PLANTING
 - PROPOSED MARGINAL PLANTING
 - AMENITY GRASS MIX
 - MEADOW GRASS MIX
 - WET MEADOW GRASS MIX
- HARD LANDSCAPE
 - MACADAM SURFACE
 - GRAVEL FOOTPATH
 - REINFORCED GRASS GRASSCOTTE OR SIMILAR
 - RESIN BOUND GRAVEL FOOTPATH SUPESET RESIN BOUND GRAVEL OR SIMILAR
 - SELF BOUND GRAVEL FOOTPATH BREEDCOX SELF BOUNDING GRAVEL OR SIMILAR
 - CONCRETE BASE TO STORAGE AREA
 - BLOCK PAVING WENFRESBER TUMBLER CLAY PAVERS OR SIMILAR
 - PERMEABLE PAVING MANHOLE TO LA PERMEABLE PAVING OR SIMILAR
 - TIMBER DECK PLATFORM WOODSCAPE DECKING OR SIMILAR
 - TIMBER BRIDGE BEAVER BRIDGES BOARDWALK OR SIMILAR
 - TIMBER PICNIC BENCHES WOODSCAPE STANDARD TIMBER PICNIC SET OR SIMILAR WOODSCAPE MOVABLE PICNIC SET OR SIMILAR ARTFORM CHAMPAN TABLE AND CHAIRS OR SIMILAR
 - TIMBER BENCHES WOODSCAPE TOTTING BACKREST SEAT OR SIMILAR
 - BINS WOODSCAPE ROUND LOCKABLE LITTER BIN OR SIMILAR

E	UPDATED TO LATEST ARCHITECT LAYOUT	07.12.21
D	UPDATES TO EXTERNAL FEC & PROW	19.11.21
C	UPDATED TO LATEST ARCHITECTS LAYOUT	05.11.21
B	UPDATED TO LATEST ARCHITECTS LAYOUT	08.11.19
A	CYCLE PARKING AND EV POINTS ADDED	02.10.19
Rev	Description	Date

PLANNING
 Purpose of Issue
 Bradley Murphy Design Ltd
 6 The Courtyard
 Hatton Technology Park
 Dark Lane
 Hatton
 Warwickshire
 CV35 8XB
 t: 01926 676496
 e: info@bradleymurphydesign.co.uk
 www.bradleymurphydesign.co.uk
 Client



GREAT LAKES UK LIMITED			
Project PROPOSED GREAT WOLF LODGE, CHESTERTON, BICESTER			
Drawing Title LANDSCAPE GENERAL ARRANGEMENT SHEET 2 OF 4			
Drawn AW	Checked MP	Approved RW	Date 15/08/2019
Job No. 19.010	Scale 1:500	Sheet Size A1	Revision
Drawing Number BMD.19.010.DR.P102			E