

Do not scale from this drawing. All dimensions to be checked on site. All omissions and discrepancies to be reported to the Architect immediately

This work is copyright and shall not be reproduced or used for any other purpose without the written permission of Squire and Partners.

--- Site Boundary

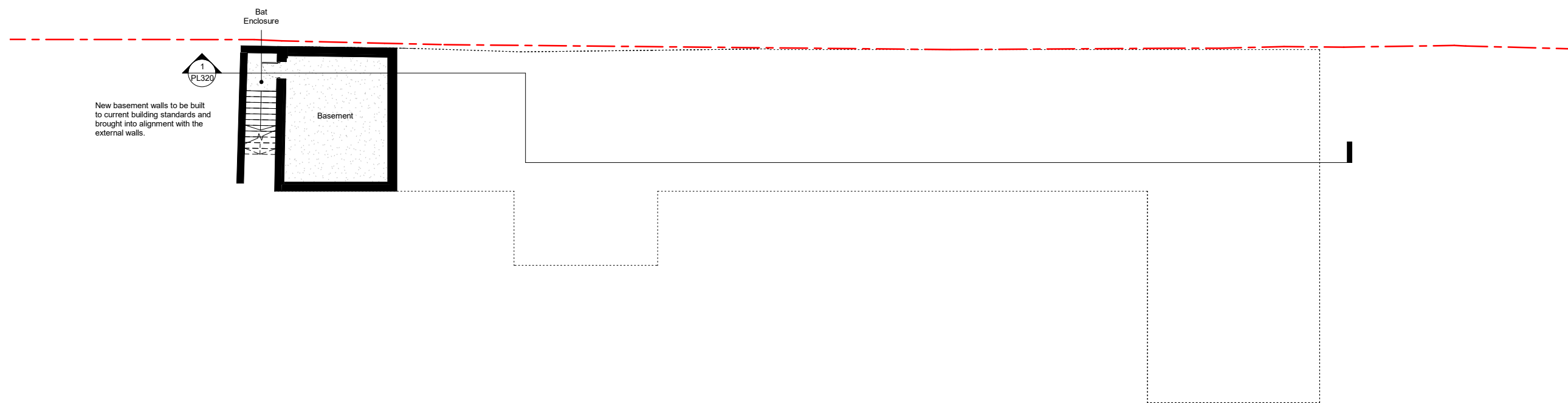

New basement walls to be built to current building standards and brought into alignment with the external walls.

Bat Enclosure

Basement

1  
PL320

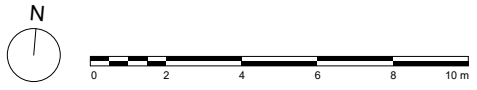

Planning Addendum	28/11/21	P1
Description	Date	Chk Rev

## SQUIRE & PARTNERS

Squire and Partners LLP  
The Department Store  
248 Ferndale Road, London SW9 8FR  
T: 020 7278 5555

info@squireandpartners.com  
www.squireandpartners.com

Project

Wincote  
Steeple Aston

Title

Planning  
Proposed  
Basement Floor Plan

Status

Planning

Drawn	Date	Scale @ ISO A1	Job Number
DOL	26/11/21	1 : 100	20064

Drawing Number	Revision
20064-SQP-ZZ-B1-DR-A-PL125	P1