

NO.	DESCRIPTION OF HAZARD	CONTROL MEASURES	ACTION BY
1	UNPROTECTED SERVICES AND SERVICES IDENTIFIED BY AIRCDS LOCATION	IDENTIFICATION OF EXISTING UNDERGROUND SERVICES USING AIRCDS DRAWING AND CAT (SOUNDING OF DRUM)	CONTRACTOR
		CAREFUL EXCAVATION USING SLOT TRENCHES AND CAT (SOUNDING OF DRUM)	

- NOTES**
- THIS DRAWING SHALL BE READ IN CONJUNCTION WITH ALL OTHER ENGINEERING SERVICES CONSULTANCY LIMITED DRAWINGS
 - THE EXTERNAL LIGHTING SHALL BE DESIGNED TO ENSURE THAT REQUIRED LIGHTING LEVELS ARE ACHIEVED WHILST MINIMISING GLARE AND LIGHT SPILLAGE TO THE SURROUNDING AREAS AND TO ENSURE THERE IS NO DIRECT CONTRIBUTION TO UPWARD LIGHT POLLUTION.
 - THE EXTERNAL LIGHTING SCHEME SHALL BE PROVIDED IN ACCORDANCE WITH THE LOCAL PLANNING AUTHORITIES REQUIREMENTS/RESTRICTIONS.
 - WHERE COLUMNS ARE POSITIONED NEAR TO NEIGHBOURING PROPERTIES, OR LOCATED ON THE PERIMETER OF THE SITE, THEY SHALL BE COMPLETE WITH SUITABLE BACK-SHIELDS TO PREVENT LIGHT SPILL.
 - ALL COLUMNS SHALL HAVE A FLEXIBLE DUCT PASSING INTO THE BASE, THROUGH THE CONCRETE, TO ENSURE THAT FUTURE REWIRING OF THE CIRCUITS IS POSSIBLE.
 - WHERE LUMINAIRES ARE FIXED DIRECTLY TO THE EXTERNAL BUILDING FABRIC, THE LUMINAIRES SHALL BE THE SAME RAL COLOUR AS THE CLADDING PANELS. ALL LUMINAIRE FIXING BOLTS ETC. SHALL BE THE SAME COLOUR AS THE LUMINAIRE.
 - GENERALLY, THE COLUMNS SHALL BE GALVANISED STEEL CONSTRUCTION. THE ELECTRICAL CONTRACTOR SHALL Liaise WITH THE ARCHITECT TO ASCERTAIN THE RAL COLOUR OF THE COLUMNS. THE COLUMN HEADS SHALL MATCH THE RAL COLOUR OF THE COLUMN.
 - WHERE SERVICES NEED TO BE INSTALLED WITHIN DUCTS / TRENCHES, THE ELECTRICAL CONTRACTOR SHALL SUPPLY THE MAIN CONTRACTOR WITH DETAILS OF REQUIRED DUCT ROUTES AND DRAW FIT LOCATIONS.
 - DURING INSTALLATION OF THE EXTERNAL LIGHTING A DRAW WIRE SHALL BE PULLED THROUGH WITH THE CABLING TO PROVIDE A MEANS OF INSTALLING FUTURE SERVICES

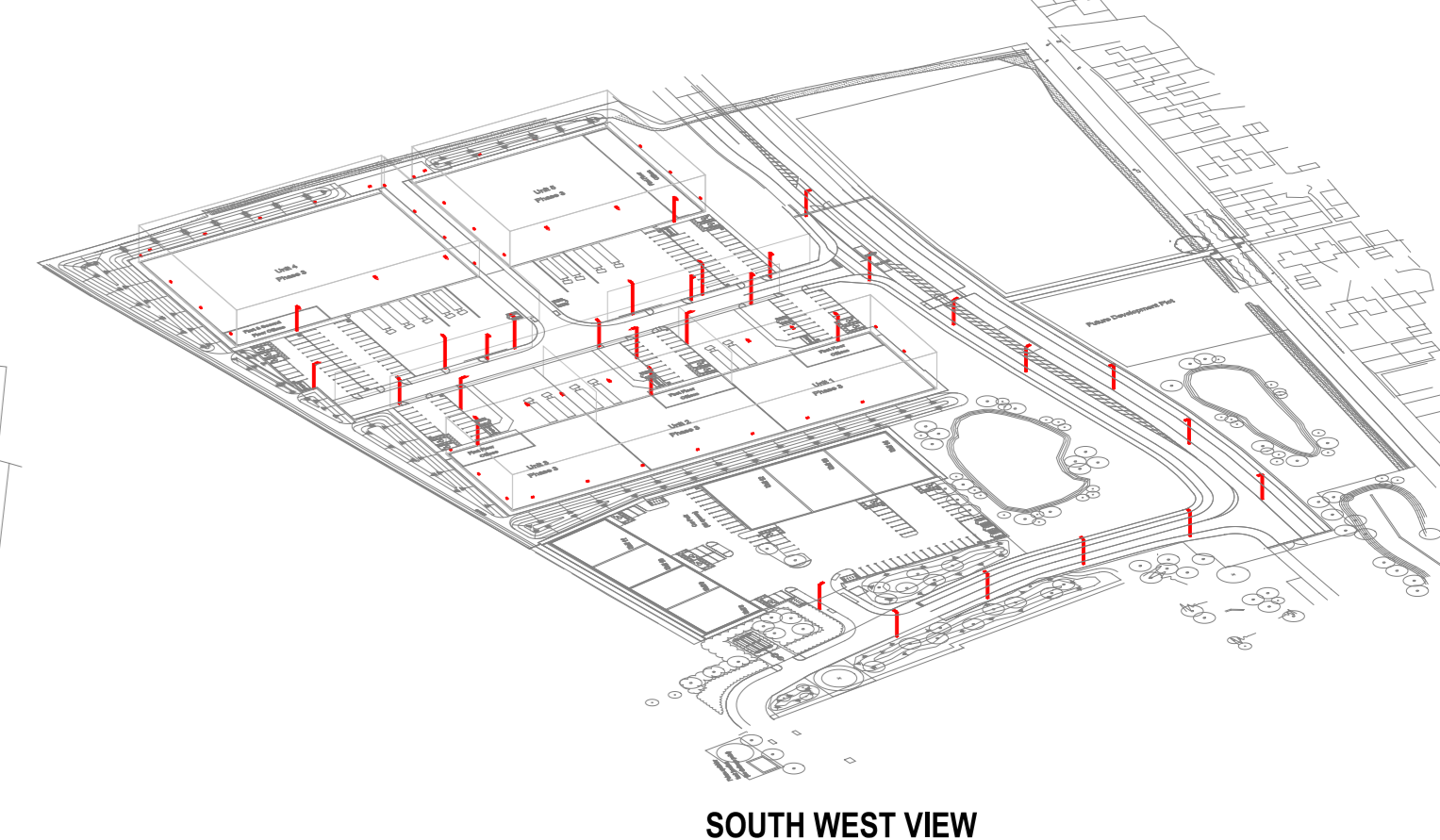

Statistics

Description	Symbol	Avg	Min	Max/Avg
Access Road - 200.250u	+	20 lux	5 lux	0.25
Unit 1-3 - Rear Walkways	+	10 lux	2 lux	0.20
Unit 1 - Car Park 200.250u	+	30 lux	15 lux	0.50
Unit 1 - Service Yard 500.400u	+	58 lux	32 lux	0.55
Unit 2 - Car Park 200.250u	+	20 lux	5 lux	0.25
Unit 2 - Service Yard 500.400u	+	50 lux	17 lux	0.54
Unit 3 - Car Park 200.250u	+	25 lux	7 lux	0.28
Unit 3 - Service Yard 500.400u	+	52 lux	16 lux	0.31
Unit 4 - Car Park 200.250u	+	20 lux	3 lux	0.15
Unit 5 - Rear Walkways	+	10 lux	3 lux	0.30
Unit 4 - Rear Walkways	+	10 lux	3 lux	0.30
Unit 4 - Service Yard 500.400u	+	50 lux	23 lux	0.46
Unit 5 - Car Park 200.250u	+	27 lux	7 lux	0.26
Unit 5 - Service Yard 500.400u	+	50 lux	23 lux	0.46
SPILL	+	0 lux	0 lux	N/A

Schedule

Symbol	Label	Quantity	Manufacturer	Catalog Number	Description	Wattage
A1	A1	7	HOLOPHANE EUROPE LIMITED	DSX2.2LA364.FW on 10m Column	D-Series 2 Luminaire	328
AW	AW	4	HOLOPHANE EUROPE LIMITED	DSX2.2LA364.FW on Wall Bracket at 10m AFFL	D-Series 2 Luminaire	328
B1	B1	2	HOLOPHANE EUROPE LIMITED	1 x DSX1.2LA224.FW on 10m Column	D-Series 1 Luminaire	208
BW	BW	5	HOLOPHANE EUROPE LIMITED	1 x DSX1.2LA224.FW on Wall Bracket at 10m AFFL	D-Series 1 Luminaire	208
C1	C1	0	HOLOPHANE EUROPE LIMITED	1 x DSX1.2LA164.FW on 8m Column	D-Series 1 Luminaire	131
D1	D1	12	HOLOPHANE EUROPE LIMITED	1 x DSX1.2LA164AY on 8m Column	D-Series 1 Luminaire	131
D1s	D1s	3	HOLOPHANE EUROPE LIMITED	1 x DSX1.2LA164AY.BLS on 8m Column and Backlight Shield	D-Series 1 Luminaire with Back Light Shield	131
E1	E1	2	HOLOPHANE EUROPE LIMITED	1 x DSX1.2LA114.FW on 8m Column	D-Series 1 Luminaire	105
EW	EW	0	HOLOPHANE EUROPE LIMITED	DSX1.2LA114.FW on Wall Bracket at 8m AFFL	D-Series 1 Luminaire	105
F1	F1	3	HOLOPHANE EUROPE LIMITED	DSX0.1LA104.FW.BLS on 8m Column	D-Series 0 Area luminaire	81
G	G	35	HOLOPHANE EUROPE LIMITED	DWL_1LA014.HN.W007	Denver 0 Wall	6.5
H	H	0	HOLOPHANE EUROPE LIMITED	WAP_1LA094.FW at 8m WALLPACK AFFL	WALLPACK	81
XD1	XD1	2	HOLOPHANE EUROPE LIMITED	EXISTING DSX2.2LA164AY on 8m Column	D-Series 1 Luminaire	131

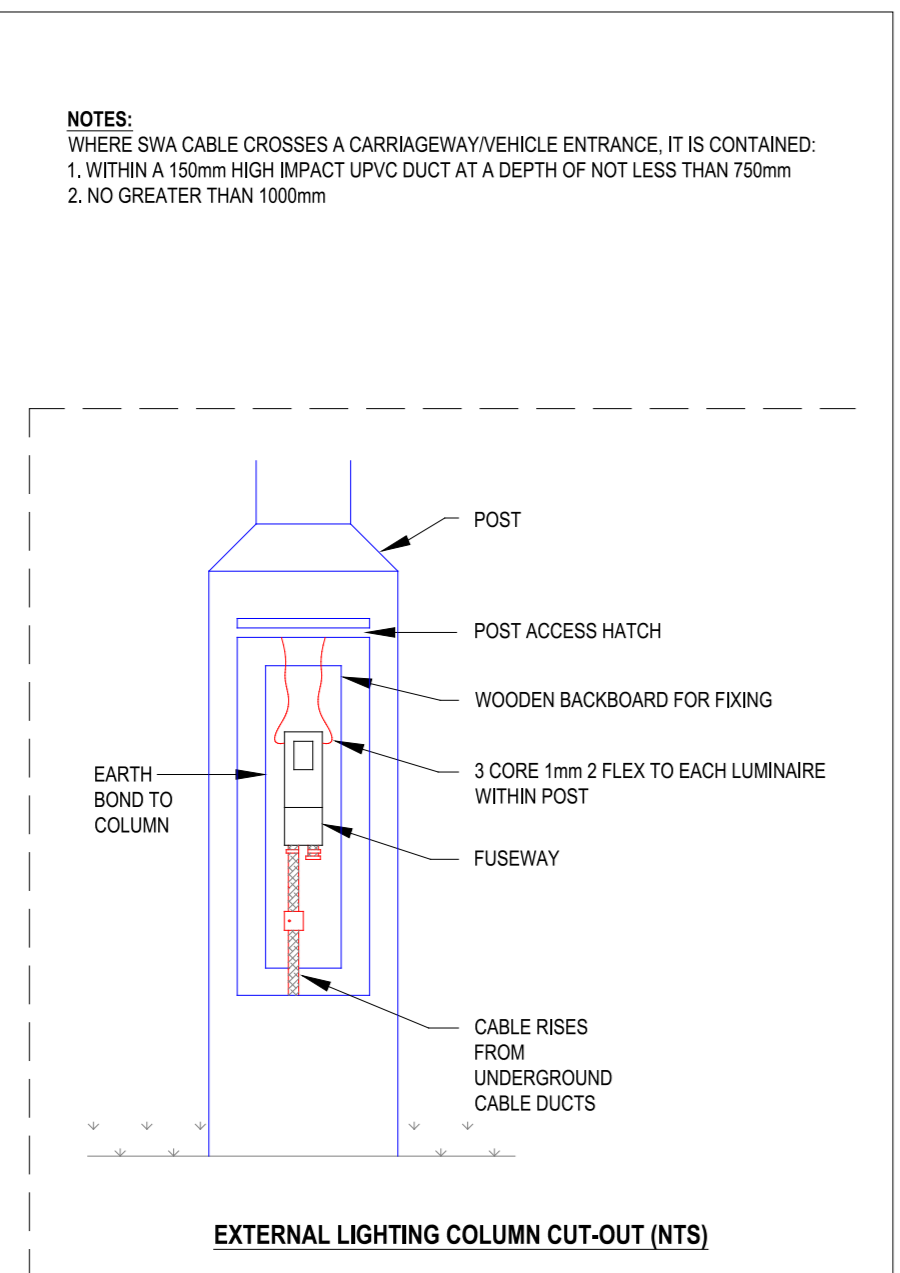
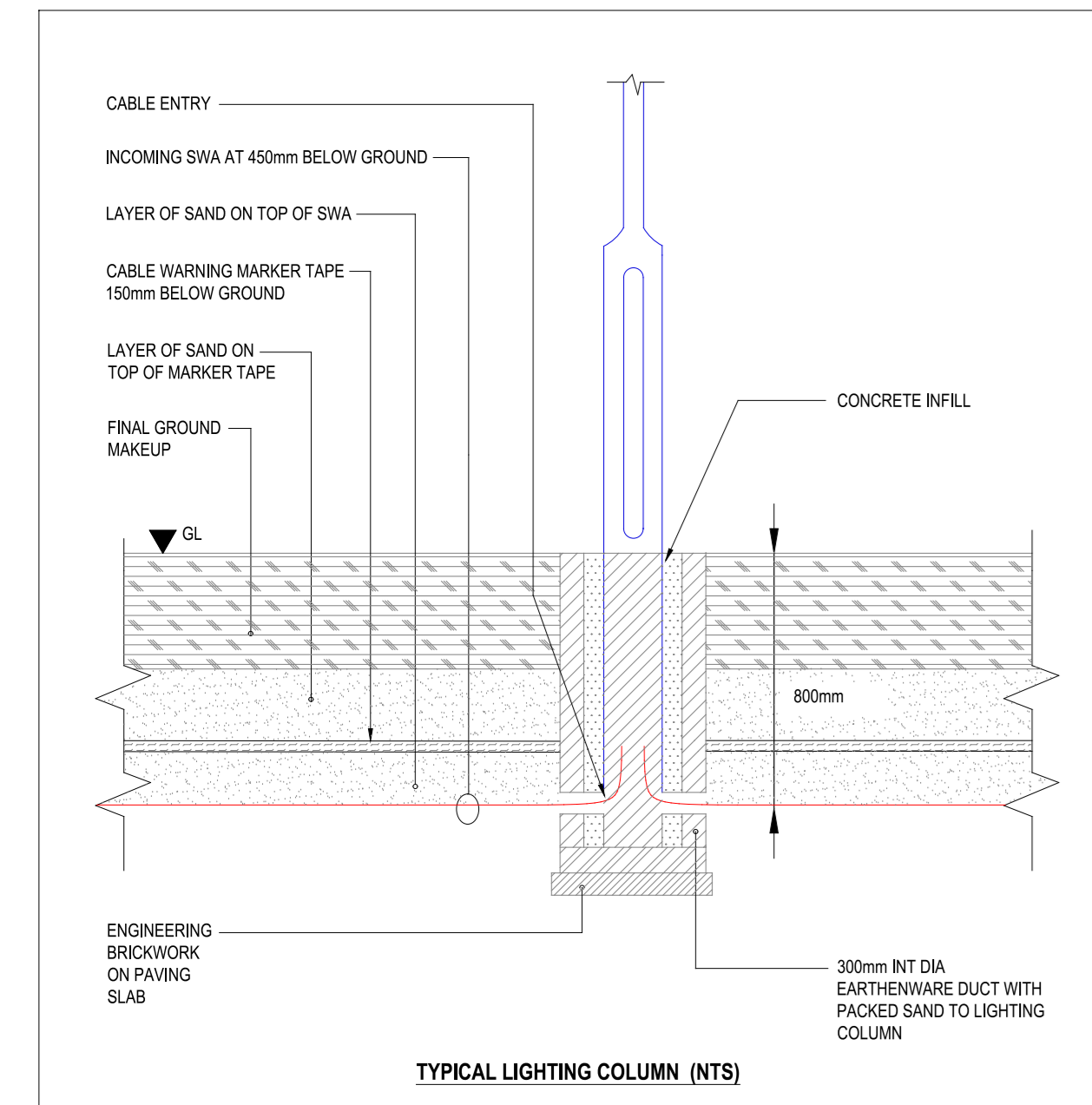

NOTES
WHERE SWIA CABLE CROSSES A CARRIAGEWAY/VEHICLE ENTRANCE, IT IS CONTAINED 1. WITHIN A 150mm HDPE IMPACT UPVC DUCT AT A DEPTH OF NOT LESS THAN 150mm 2. NO GREATER THAN 100mm

THIS DRAWING IS FOR INFORMATION ONLY TO DEMONSTRATE DESIGN INTENT AND REPRESENTS THE AGREED SERVICING STRATEGY AND MINIMUM STANDARDS TO BE ACHIEVED. WHERE ADDITIONAL DETAILS HAVE BEEN SHOWN, THIS HAS BEEN PROVIDED IN ORDER TO CONVEY GREATER UNDERSTANDING OF THE CONCEPTUAL REQUIREMENTS AND SHALL NOT BE TAKEN AS DETAILED DESIGN.

IT HAS NOT BEEN PRODUCED TO ACCURATE DESIGN CALCULATIONS AND SHALL NOT BE USED FOR INSTALLATION PURPOSES.

THE CONTRACTOR WILL BE RESPONSIBLE FOR THE DESIGN OF THE ENGINEERING SERVICES IN ACCORDANCE WITH THE DESIGN AND BUILD CONTRACT. PLANT SIZES ARE INDICATIVE AND THE CONTRACTOR SHALL BE FULLY RESPONSIBLE FOR THE DETAILED DESIGN OF ALL PLANT AND EQUIPMENT

THIS DRAWING SHALL BE READ IN CONJUNCTION WITH ALL CONTRACT DOCUMENTS, PROJECT SPECIFICATIONS AND DRAWINGS

P3 16.03.23 Issued for planning CP
 P2 03.08.21 Issued for planning CP
 P1 03.08.21 Issued for planning CP
 Rev. Date Details Initials
 Engineering Services Consultancy Ltd
 Giffen House
 19 Lodgepole Hill
 Berrington
 B3 10W
 T: 0121 214 8998
 F: 0121 214 9999
 W: www.escuk.com
 Client:

ALBION LAND
 Project
Axis J9 Phase 3
 Drawing Title
External Lighting Layout
 Purpose
PLANNING
 Drawn: DM Engineer: CP Approved: CP
 Project No.: 1746 Date: Aug 2021 Scale: @ A3
 Drawing No.: 1746-ESC-00-ZZ-DR-E-2100 Revision: P3