

The Water Supply (Water Quality) Regulations. 2016.	DWI
Prioritisation & Categorisation Procedure for Sites Which May Be Contaminated (CLR Report No6)	Department of the Environment, Contaminated Land Research Report
Code of Practice for the Investigation & Mitigation of Possible Petroleum-Based Land Contamination. 1993.	The Institute of Petroleum
Piling & Penetrative Ground Improvement Methods on Land Affected by Contamination: Guidance on Pollution Prevention. 2001.	Environment Agency
DISPOSAL OF SOIL	
Guidance on the Classification and Assessment of Waste. Technical Guidance WM3. 1 st Ed. 2015.	SEPA, NIEA, Natural Resources Wales & Environment Agency
Waste Sampling and Testing for Disposal to Landfill. 2013.	Environment Agency
BURIED SERVICES	
Guidance for the Selection of Water Supply Pipes to be Used in Brownfield Sites. (10/WM/03/21). 2011.	UK Water Industries Research
PAVEMENT DESIGN	
Interim Advice Note 73/06 Rev 1, 2009. Design Guidance for Road Pavement Foundations (Draft HD25)	Highways Agency
PLANNING	
DCLG:2012 National Planning Policy Framework and Practice Guidance	Department for Communities and Local Government
HEALTH & SAFETY ASPECTS	
A Guide for Safe Working on Contaminated Sites (Report 132)	CIRIA
Protection of Workers and the General Public During the Development of Contaminated Land (HSG66)	Health & Safety Executive
Construction (Design & Management) Regulations 2015 (CDM)	Health & Safety Executive
Control of Substances Hazardous to Health Regulations 2002	Health & Safety Executive
Workplace Exposure Limits. EH40/2005	Health & Safety Executive
Trenching Practice. Guidance on Groundwater Control (Report 97)	CIRIA
Control of Groundwater for Temporary Works (Report 113)	CIRIA
Asbestos in Soil and Made Ground: A Guide to Understanding and Managing Risks. C733. 2014.	CIRIA

APPENDIX A

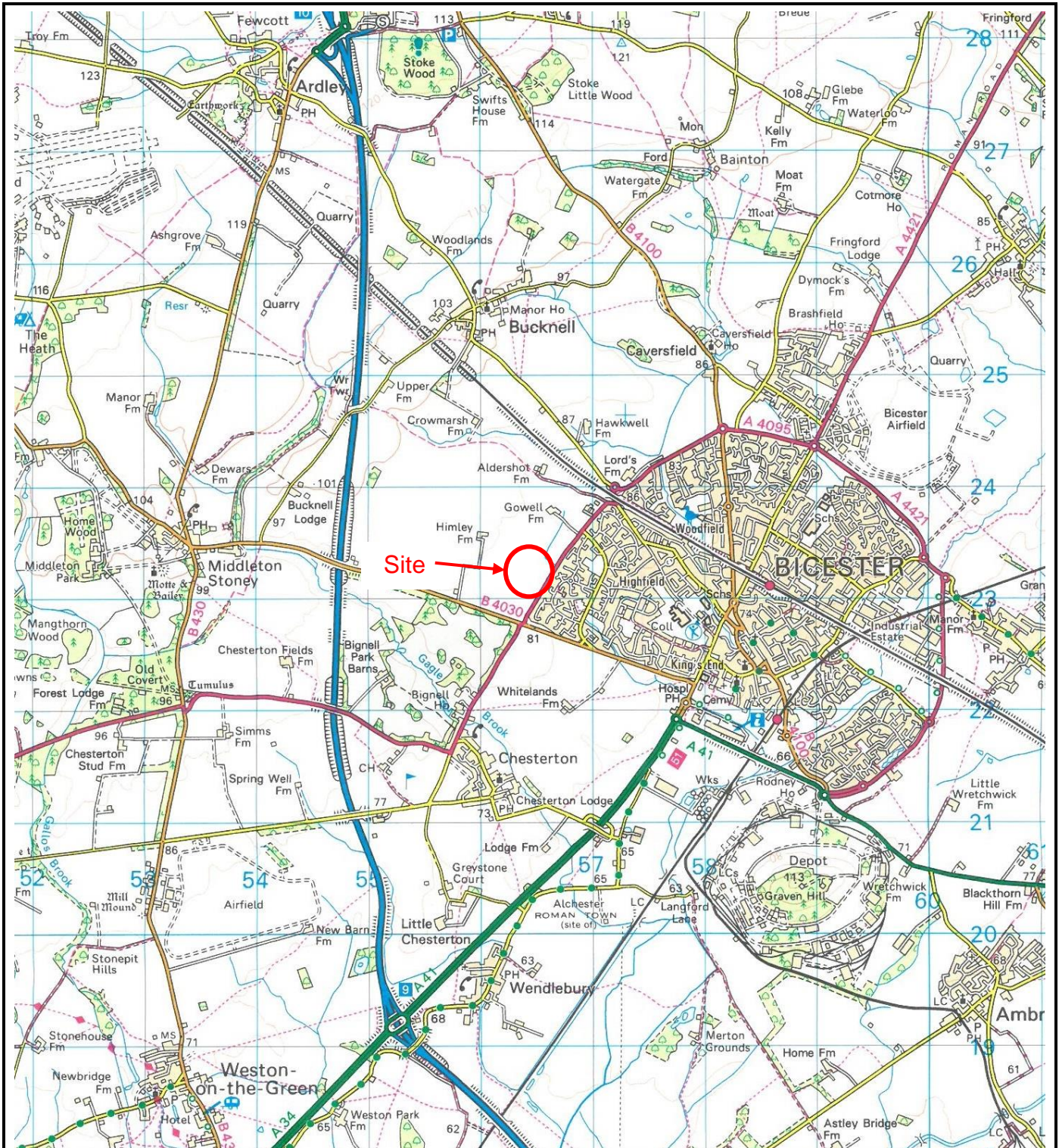

Reproduced from the Ordnance Survey Map with permission of the Controller of Her Majesty's Stationery Office, Crown Copyright* LICENCE No: 100055022

<h1>APPLIED GEOLOGY</h1> <p>Unit 23 Abbey Park Stareton Kenilworth CV8 2LY</p> <p>Tel: 02476 511822 email: admin@appliedgeology.co.uk</p>			Client:		ALBION LAND TWO LTD
			Project:		HOWES LANE, BICESTER
Drawn By:	Checked By:	Paper Size:	Title:		
JLC	AP	A4			
Scale:	Date:	NGR:			
1:50,000	10.08.2018	456381 223088	SITE LOCATION PLAN		
Drawing No:		Revision:			
AG2873-18-01		0			

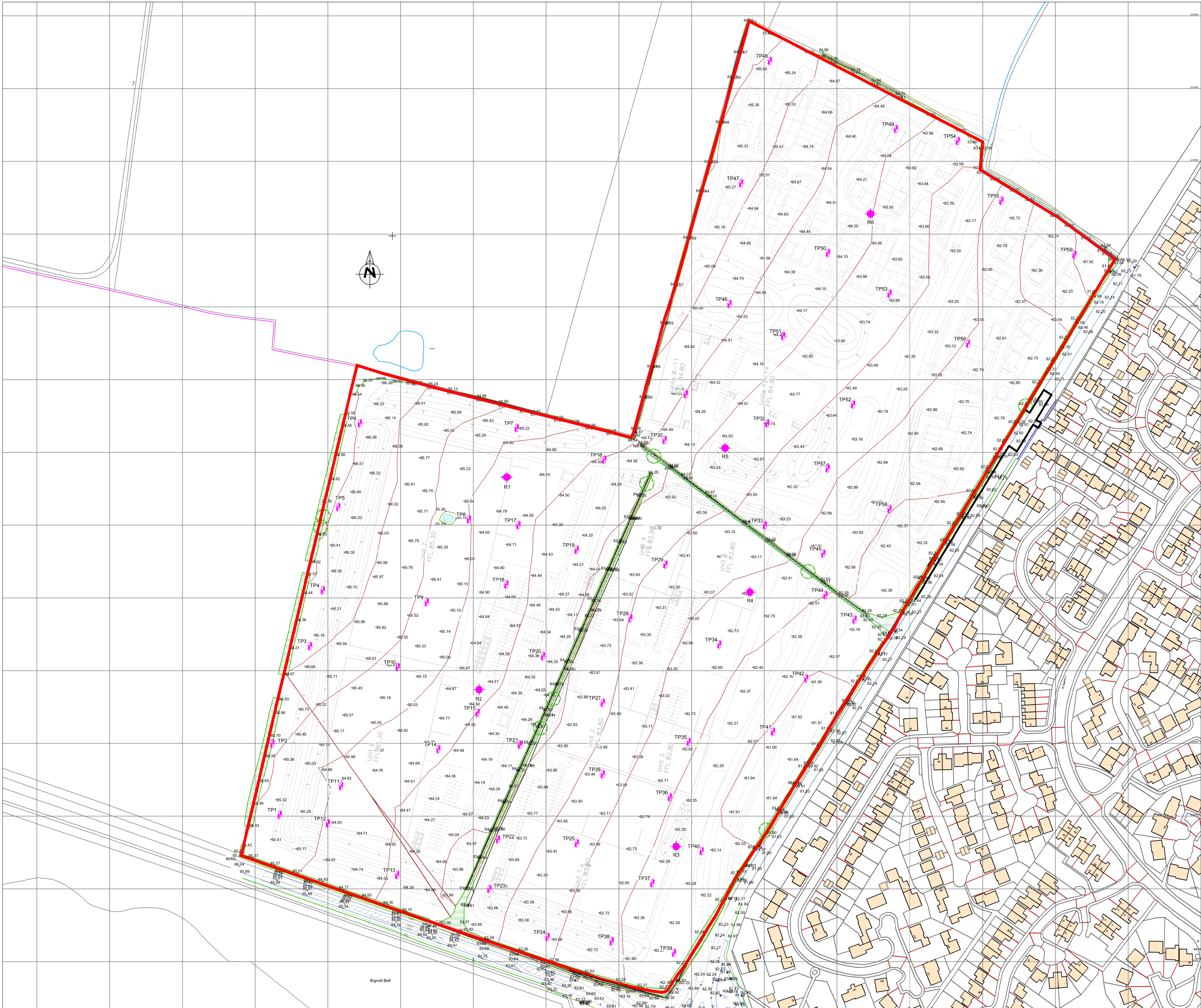

KEY:

	Trial Pit
TP1	
	Rotary Boreholes
R1	
	Site Boundary

Drawing based on Blue Plan, Job No:1553 dated 12/01/2012 and Bailey Johnson Hayes, drawing No.S1209-P07C dated 20/10/2017.

Rev	Notes	Date	By
3	Updated Proposed Layout	21.01.2019	ST
2	Rotary Boreholes re-numbered and the Trial Pit colour changed	10.01.2019	ST
1	Site Boundary updated	03.01.2019	ST

APPLIED GEOLOGY

Unit 23
Abbey Park
Stareton
Kantilworth
CV8 2LY

Tel: 02476 511822
email: admin@appliedgeology.co.uk

Client: ALBION LAND TWO LTD

Project: HOWES LANE, BICESTER

Title: EXPLORATORY HOLE LOCATION PLAN

Drawn By: JS Checked By: ST Paper Size: A1

Scale: 1:1250 Date: 19/09/2018

Drawing No: AG2873-18-02 Revision: 3

SOUTH WEST

SITE BOUNDARY

NORTH EAST

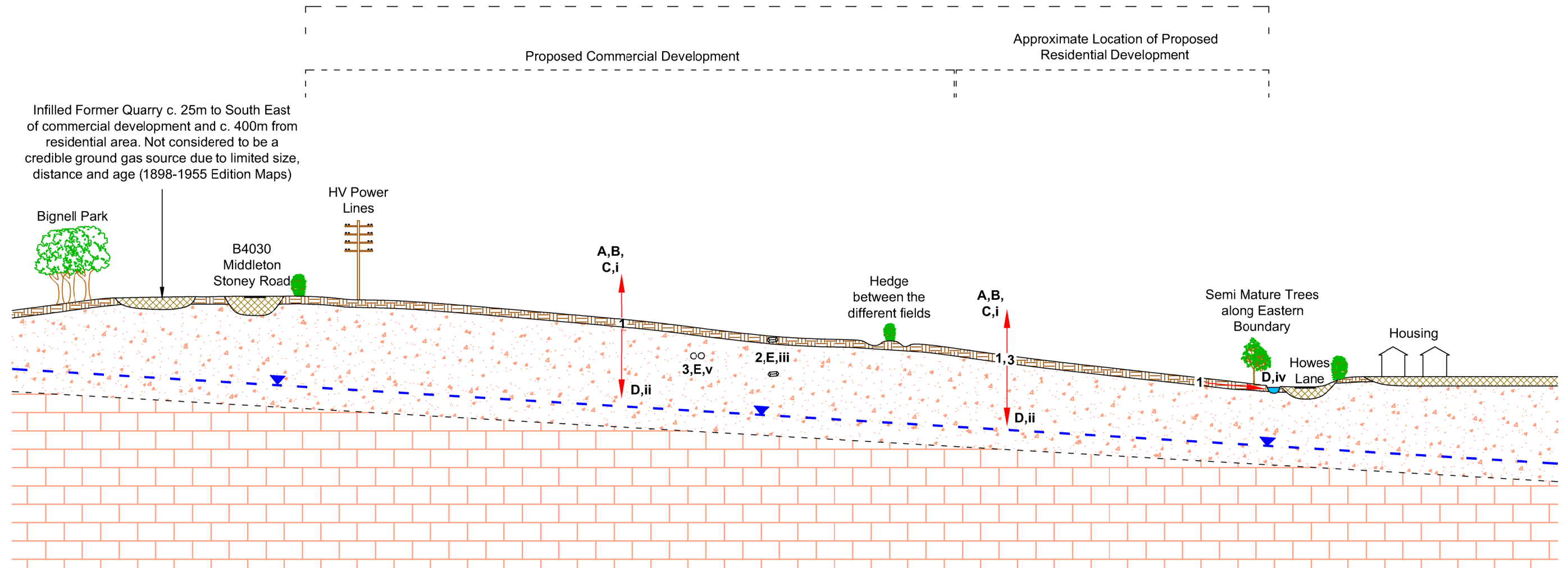

SOURCES

- 1. Topsoil (possible pesticides)
- 2. Elevated sulphates
- 3. Hydrocarbons

PATHWAYS

- A. Inhalation
- B. Ingestion
- C. Dermal contact
- D. Leaching/migration
- E. Direct contact

RECEPTORS

- i. End users
- ii. Aquifer
- iii. Buried concrete
- iv. Watercourse
- v. Water supply services/pipes

Key:

	Topsoil		Weathered Cornbrash Formation (Secondary A Aquifer)
	Made Ground		Cornbrash Formation - Limestone (Secondary A Aquifer)
			Groundwater

APPLIED GEOLOGY

Unit 23
Abbey Park
Stareton
Kenilworth
CV8 2LY

Tel: 02476 511822
email:
admin@appliedgeology.co.uk

Client:
ALBION LAND TWO LTD

Project:
HOWES LANE, BICESTER

Title:
CONCEPTUAL SITE MODEL

Drawn By: JS	Checked By: ST	Paper Size: A3
Scale: NTS	Date: 22.10.2018	
Drawing No: AG2873-18-03	Revision: 0	