

- DW 18/08/21: First Issue
- Rev 01 DW 25/08/21 Updates to design layout to include art consultant's proposal
- 02 RS10/09/21 Issued for stage 3
- 03 DW 13/10/21 Amendments to academic building perimeter. Academic Building cycle storage unit relocated.

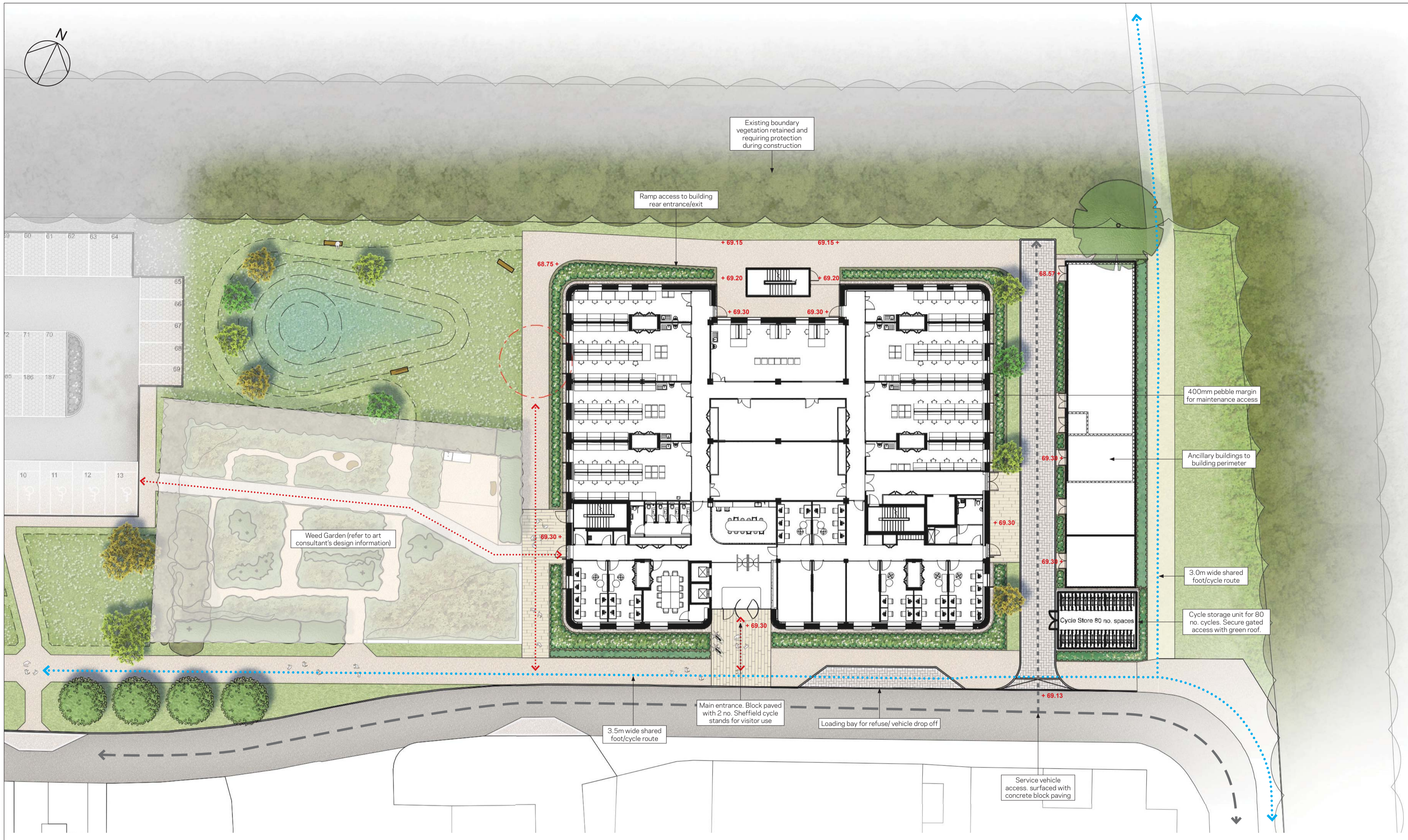

**Hard Landscape**

- Entrance paving: exposed aggregate concrete block paving
- Service routes: herringbone exposed aggregate concrete block paving
- Roads: standard bituminous macadam surface
- bituminous macadam seeded with buff aggregate to foot/cycle paths
- Naturally durable hardwood benches with powder coated steel sides
- Cycle store: 80 no. per store with Sheffield stands at grade and storage racks above
- Cycle hoops to main entrances (4 spaces for Academic Building)

**Soft Landscape**

- Existing woodland belt to be retained and protected during construction
- Existing trees and hedges on site to be retained and protected during construction
- Proposed avenue trees: 20-25cm girth
- Multistem trees: 3.5m-4m
- Lawn areas
- Species rich meadow grasses with mown paths

- Rain gardens
- Attenuation basin and semi dry/wet species mixes
- Shrub planting: 6 plants per m<sup>2</sup> minimum
- Clipped formal hedges
- Existing trees to be removed

**Movement**

- Key pedestrian connections (minimum width 1.8m)
- Shared pedestrian cycleway (width varies 3.0-3.5m)
- Vehicular circulation
- Service vehicle routes

**STAGE 3**

project:  
Begrroke Science Park

job number:  
LP2264

drawing title:  
Reserved Matters Academic Building Landscape General Arrangement

drawing number:  
LP2264-FIR-00-ZZ-DR-L-0005

revision	scale	date
03	1:250 @ A1	30/07/21

for information	drawn	auth	date
	RS	VP	30/07/21

for construction

