

PLANNING

Revised: A 18/12/20 RS Rooflight added to two storey extension for Planning.
 B 19/02/21 RS Site survey updated (standards: 11/02/21)
 C 06/08/21 DM General amendments for planning

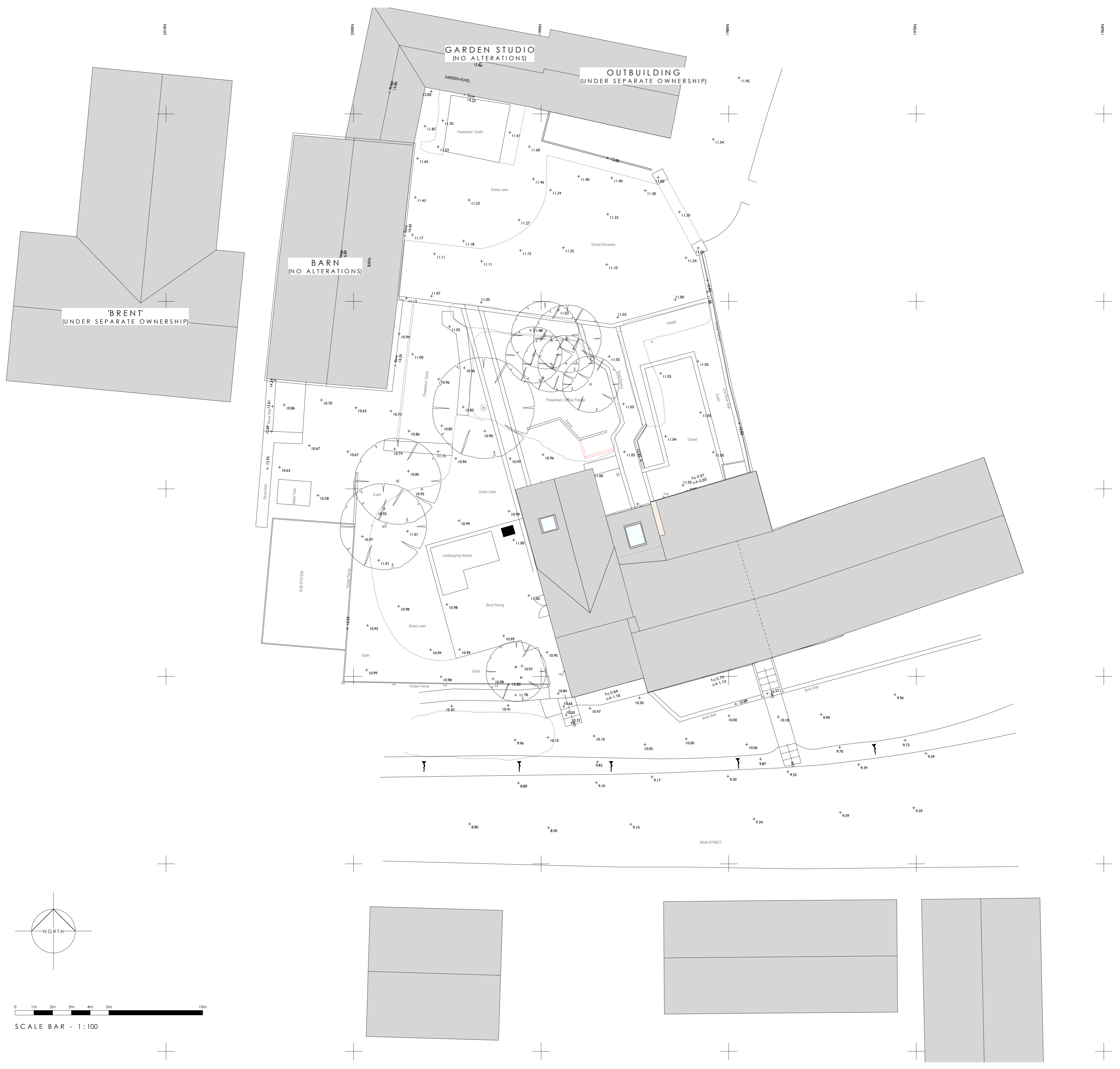

hsa
 Hayward Smart architects

The Coach House
 3a New Street, Shipston-on-Stour
 Warwickshire, CV34 4EW
 01608 661000
 studio@hsarchitects.co.uk

Client	Mr N. Mattinson	
Project	Alterations at West Farm Cottage, Sibford Gower	
Drawing	Proposed Site / Roof Plan	
Date	December '20	
Scale	1:100 @ A1	Drawn: RS
Job No	19-076	Drawing No: 101 C
architecture + interiors		