

GENERAL NOTES:

This drawing remains the property of Locksley Architects Ltd, reproduction shall only be allowed with written permission.

This drawing is not to be scaled for construction purposes, use written dimensions only. Any discrepancies to be reported to the architect. All dimensions to be checked on site. The contractor is responsible for all dimensions and setting out of the work on site. The contractor must ensure that all elements of the work comply with current building regulations.

PROJECT NOTES:

- ① Stained timber boarding
- ② Natural Stone
- ③ Plain tiles
- ④ Roof-lights
- ⑤ Cast Stone Quoins
- ⑥ Black UPVC rainwater g
- ⑦ metal framed dark grey double glazed windows
- ⑧ new lead roof
- ⑨ metal framed double glazing
- ⑩ new stone to match existing
- ⑪ timber louvres

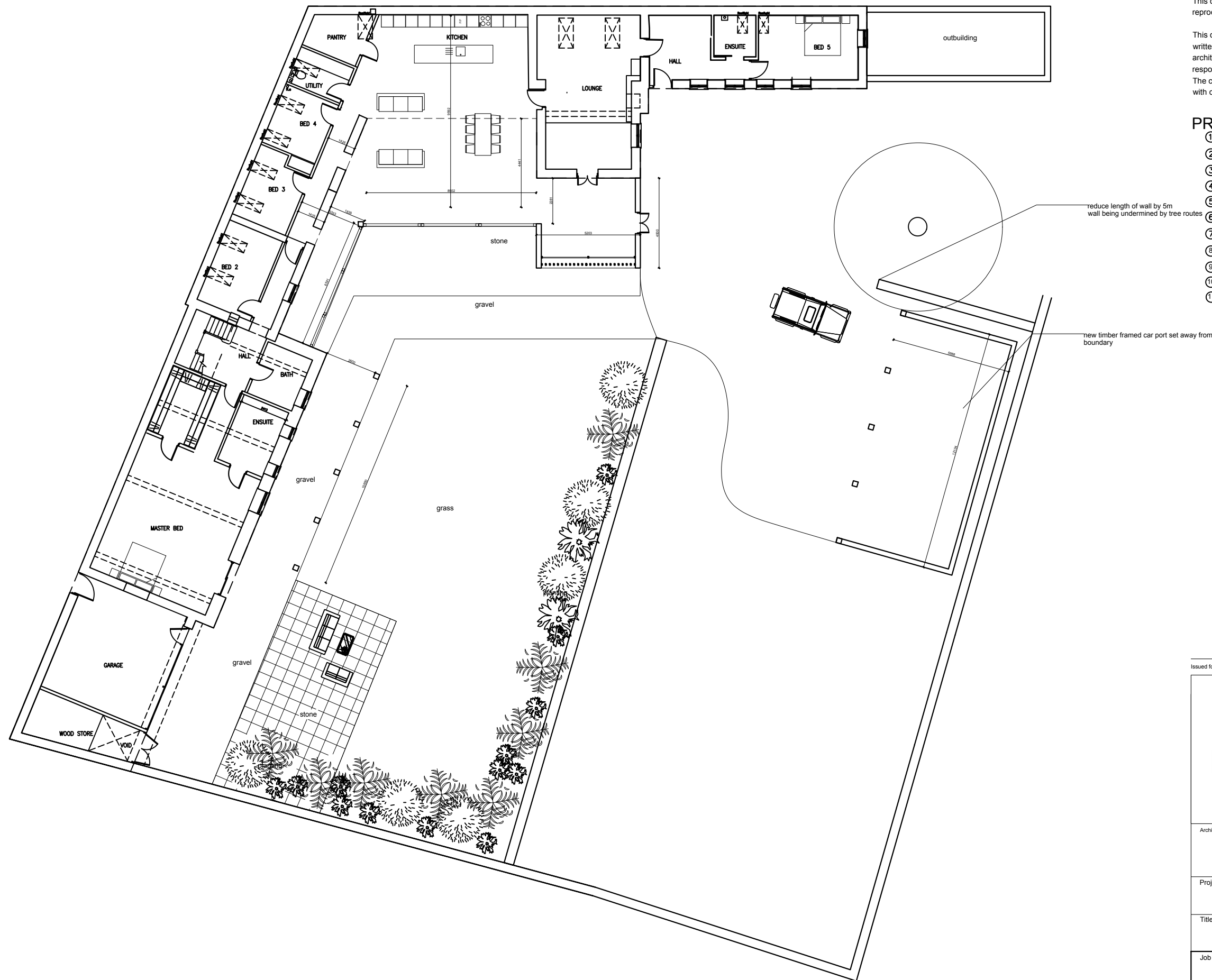

Issued for Planning 27/05/2021 A



Architect Details
 Westbourne Studios, Notting Hill, London W10 5JJ
 info@locksleyarchitects.com
 0207 206 2727

Project
The Bothy

Title
Proposed Ground Floor

Job No	1060	Drwg No	P01	Revision	A
--------	------	---------	-----	----------	---